



**HANSON RIVET**

**& SUPPLY CO.**  
13241 Weidner Street  
Pacoima, CA 91331

See pages D42-D47 for  
installation tools

Phone: 818-485-0500

FAX: 818-485-0540

Outside CA: 1-800-RRRIVET

www.hansonrivet.com



# HIGH STRENGTH BLIND RIVETS



**HR RIVETS®** offer high strength with a large blind-side footprint for use in thin sheet or brittle material applications. High clamp-up and excellent mandrel retention ensures a vibration resistant joint.

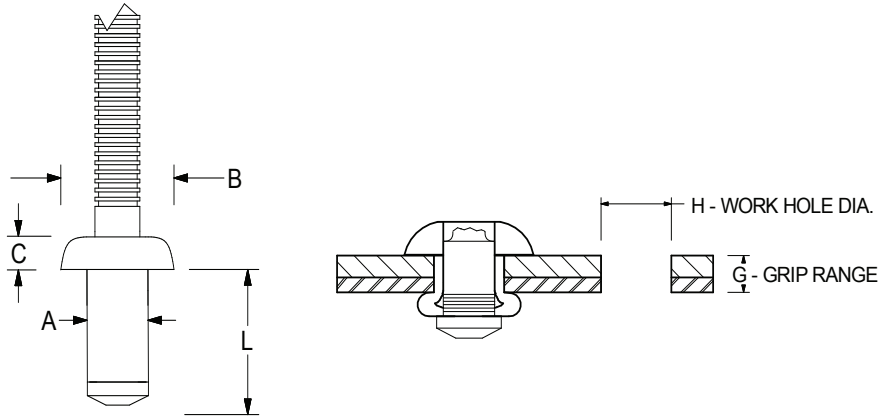

## HR RIVETS

A SPECIAL NOSEPIECE AND JAW PUSHER ARE REQUIRED FOR INSTALLATION OF THESE RIVETS

RIVET MATERIAL MANDREL MATERIAL	HEAD STYLE	PART NUMBER	BODY DIAMETER "A"	WORK HOLE AND DRILL SIZE		GRIP RANGE "G"	BODY LENGTH (MAX.) "L"	HEAD DIAMETER "B"	HEAD HEIGHT "C"	TYPICAL ULTIMATE STRENGTHS IN LBS. (SEE NOTE)	
				"H"	"H"					SHEAR	TENSILE
 <p><b>STEEL MANDREL</b></p> <p><b>STEEL RIVET</b></p>	DOME HEAD	SD42HR SD43HR SD44HR	.124/.132	.133/.141	.036-.125 .125-.187 .187-.250	.315 .378 .440	.240/.263	.039/.051	325	382	
		SD52HR SD53HR SD54HR	.155/.164	.165/.173	.063-.125 .125-.187 .187-.250	.354 .417 .480	.303/.326	.055/.066	449	584	
		SD62HR SD63HR SD64HR SD65HR	.187/.195	.196/.212	.063-.125 .125-.187 .187-.250 .250-.312	.362 .425 .488 .551	.362/.396	.066/.082	696	764	
		SD83HR SD85HR	.250/.259	.250/.258	.047-.187 .187-.312	.444 .570	.492/.531	.090/.106	876	1202	
	LARGE FLANGE	SD62HRLF SD63HRLF SD64HRLF SD65HRLF	.187/.195	.196/.212	.063-.125 .125-.187 .187-.250 .250-.312	.362 .425 .488 .551	.606/.645	.070/.086	696	764	
		SD83HRLF SD85HRLF	.250/.259	.250/.258	.047-.187 .187-.312	.444 .570	.610/.649	.110/.126	876	1202	
	120° COUNTERSUNK	SK42HR SK43HR SK44HR	.124/.132	.133/.138	.078-.125 .125-.187 .187-.250	.315 .378 .440	.196/.220	.023/.039	213	269	
		SH52HR SK54HR SK56HR	.155/.164	.165/.169	.078-.125 .125-.187 .187-.250	.354 .417 .480	.240/.263	.031/.047	292	449	
		SK63HR SK64HR	.187/.195	.196/.205	.093-.187 .187-.250	.425 .488	.307/.338	.043/.059	696	764	
		SSD42SSHR SSD43SSHR SSD44SSHR	.124/.132	.134/.142	.063-.126 .126-.189 .189-.252	.315 .378 .441	.240/.264	.039/.051	427	562	
	DOME HEAD	SSD52SSHR SSD53SSHR SSD54SSHR	.155/.164	.165/.173	.063-.126 .126-.189 .189-.252	.354 .417 .480	.303/.327	.055/.066	630	855	
		SSD62SSHR SSD63SSHR SSD64SSHR	.187/.195	.196/.212	.063-.125 .125-.187 .187-.250	.362 .425 .488	.362/.396	.066/.082	1056	1124	
120° COUNTERSUNK	SSK42SSHR SSK43SSHR SSK44SSHR	.124/.132	.134/.142	.079-.125 .126-.189 .189-.252	.441 .504 .567	.196/.200	.023/.039	315	450		
	SSK63SSHR SSK64SSHR	.187/.195	.196/.205	.094-.187 .187-.250	.425 .488	.307/.388	.043/.059	831	1124		

NOTE: Values for typical ultimate strengths are a guide only and may vary greatly depending upon the application.



# HANSON RIVET

& SUPPLY CO.  
13241 Weidner Street  
Pacoima, CA 91331

See pages D42-D47 for  
installation tools

Phone: 818-485-0500  
FAX: 818-485-0540

Outside CA: 1-800-RRRIVET  
www.hansonrivet.com



## HIGH STRENGTH BLIND RIVETS



**Hemlok® Rivets** offer high strength with a large blind-side footprint for use in thin sheet or brittle material applications. The mandrel has a mechanical lock and breaks close to flush with the rivet head.

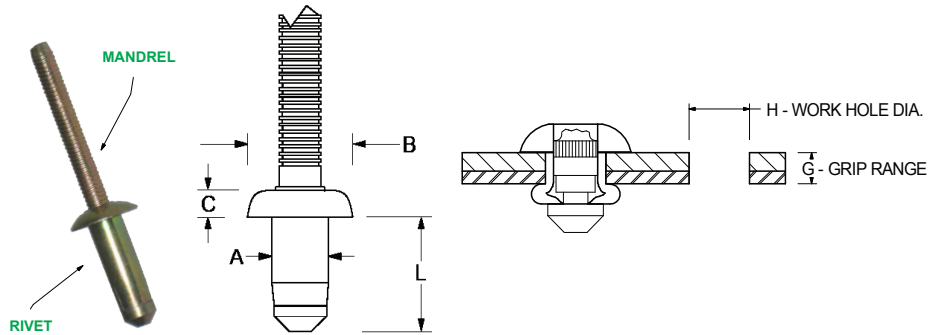

**Both Avibulb® and Avinox II® Rivets** offer high strength with a large blind-side footprint for use in thin sheet or brittle material applications. High clamp-up and positive mandrel retention ensures a vibration resistant joint.

### HEMLOK® STRUCTURAL RIVETS

RIVET MATERIAL MANDREL MATERIAL	HEAD STYLE	PART NUMBER	BODY DIAMETER "A"	WORK HOLE DIAMETER "H"	GRIP RANGE "G"	BODY LENGTH (MAX.) "L"	HEAD DIAMETER (NOM.) "B"	HEAD HEIGHT (MAX.) "C"	TYPICAL ULTIMATE STRENGTHS IN LBS. (SEE NOTE)	
									SHEAR	TENSILE
 <b>STEEL RIVET</b> <b>STEEL MANDREL</b>	PROTRUDING HEAD	2221-0812	.254/.258	.264/.272	.068-.138	.488-.539	.515	.105	3820	2090
		2221-0813								
		2221-0814								
		2221-0815								
		2221-0817								
		2221-0818								
		2221-0819								
		2221-0821								
<b>ALUMINUM RIVET</b> <b>ALUMINUM MANDREL</b>	PROTRUDING HEAD	2241-0812	.254/.258	.264/.272	.068-.138	.488-.539	.515	.105	1500	700
		2241-0813								
		2241-0814								
		2241-0815								
		2241-0817								
		2241-0818								
		2241-0819								
		2241-0821								

### AVIBULB® RIVETS

RIVET MATERIAL MANDREL MATERIAL	HEAD STYLE	PART NUMBER	BODY DIAMETER "A"	WORK HOLE DIAMETER "H"	GRIP RANGE "G"	BODY LENGTH (MAX.) "L"	HEAD DIAMETER (NOM.) "B"	HEAD HEIGHT (MAX.) "C"	TYPICAL ULTIMATE STRENGTHS IN LBS. (SEE NOTE)		
									SHEAR		TENSILE
									STEM INSIDE SHEAR PLANE	STEM OUTSIDE SHEAR PLANE	
 <b>STEEL RIVET</b> <b>STEEL MANDREL</b>	LO-PROFILE HEAD	OBN01-0408	.122/.130	.130/.134	.039-.118	.343	.248	.055	270	N/A	310
		OBN01-0411									
		OBN01-0414									
		OBN01-0509	.153/.160	.161/.169	.039-.118	.400	.303	.059	539	416	629
		OBN01-0512									
		OBN01-0516									
		OBN01-00611	.185/.192	.193/.201	.059-.138	.480	.366	.059	809	742	854
		OBN01-00614									
		OBN01-00618									

### AVINOX II® RIVETS

RIVET MATERIAL MANDREL MATERIAL	HEAD STYLE	PART NUMBER	BODY DIAMETER "A"	WORK HOLE DIAMETER "H"	GRIP RANGE "G"	BODY LENGTH (MAX.) "L"	HEAD DIAMETER (NOM.) "B"	HEAD HEIGHT (MAX.) "C"	TYPICAL ULTIMATE STRENGTHS IN LBS. (SEE NOTE)		
									SHEAR		TENSILE
									STEM INSIDE SHEAR PLANE	STEM OUTSIDE SHEAR PLANE	
 <b>STAINLESS RIVET</b> <b>STAINLESS MANDREL</b>	LO-PROFILE HEAD	OBE61-00408	.122/.130	.130/.134	.039-.118	.350	.248	.043	360	360	450
		OBE61-00411									
		OBE61-00414									
		OBE61-00509	.153/.160	.161/.169	.039-.118	.400	.303	.059	1169	629	899
		OBE61-00512									
		OBE61-00516									
		OBE61-00611	.183/.191	.193/.201	.059-.138	.510	.366	.059	1236	877	1124
		OBE61-00614									
		OBE61-00618									