

SAW Filter 1232.0MHz
Part No: MP08170

Model: TA1680A
Rev No: 1

A. MAXIMUM RATING:

Electrostatic Sensitive Device (ESD)

1. Input Power Level: 10dBm
2. DC Voltage: 3V
3. Operating Temperature: -50°C to +70°C
4. Storage Temperature: -50°C to +95°C

B. ELECTRICAL CHARACTERISTICS:

Item	Unit	Min.	Typ.	Max.
Center frequency Fc	MHz	-	1232	-
Min. Insertion Loss IL min	dB	-	2.1	5
Bandwidth @-3dB	MHz	10	23.5	-
Amplitude Ripple (1227 ~ 1237MHz)	dB	-	0.7	3
VSWR (1227 ~ 1237MHz)	-	-	1.7	2.3
Attenuation (Reference level from 0dB)				
800 ~ 1150MHz	dB	40	58	-
1150 ~ 1180MHz	dB	20	51	-
1265 ~ 2000MHz	dB	35	50	-
Temperature Coefficient of Frequency	ppm/°C	-	-36	-

C. MEASUREMENT CIRCUIT:

HP Network analyzer

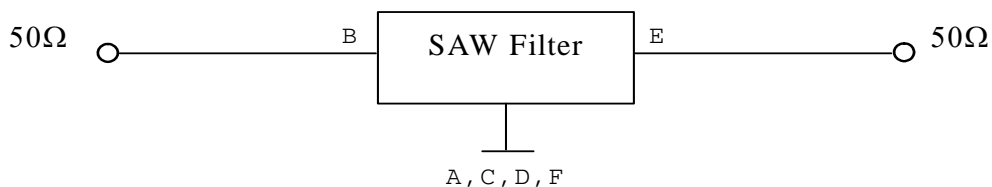

SAW Filter 1232.0MHz
Part No: MP08170

Model: TA1680A
Rev No: 1

D. OUTLINE DRAWING:

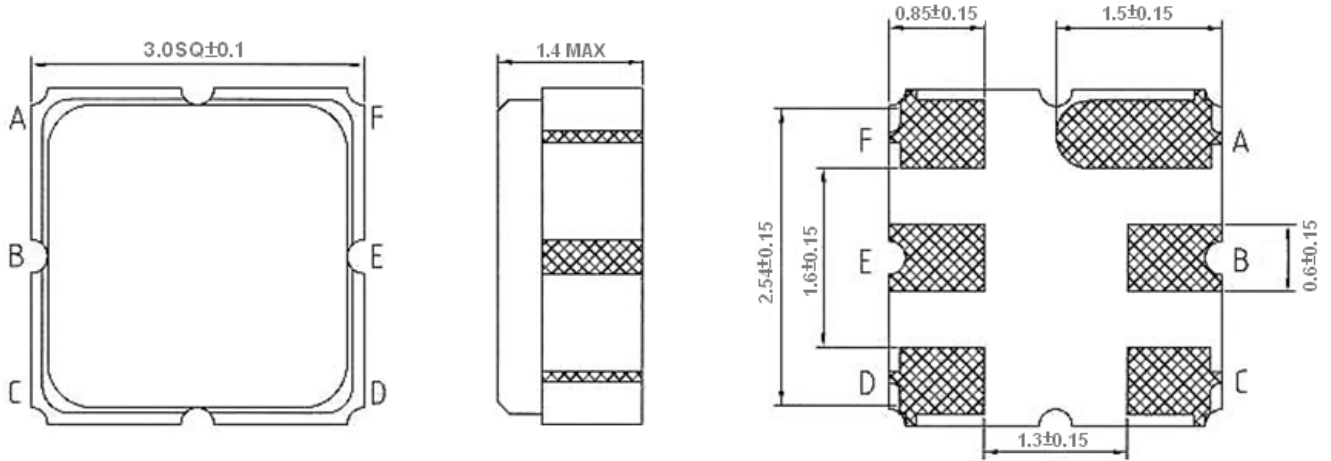

B: Input
E: Output
A, C, D, F: Ground
Unit: mm

E. PCB FOOTPRINT:

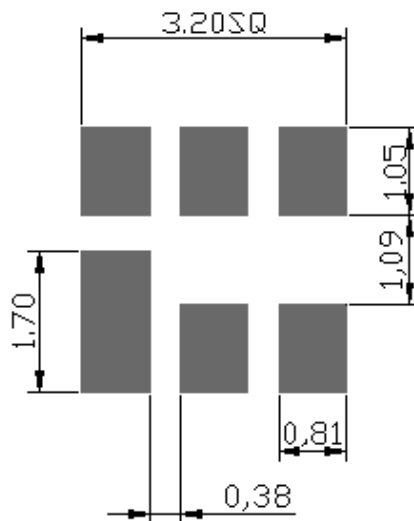

SAW Filter 1232.0MHz
Part No: MP08170

Model: TA1680A
Rev No: 1

F. FREQUENCY CHARACTERISTICS:

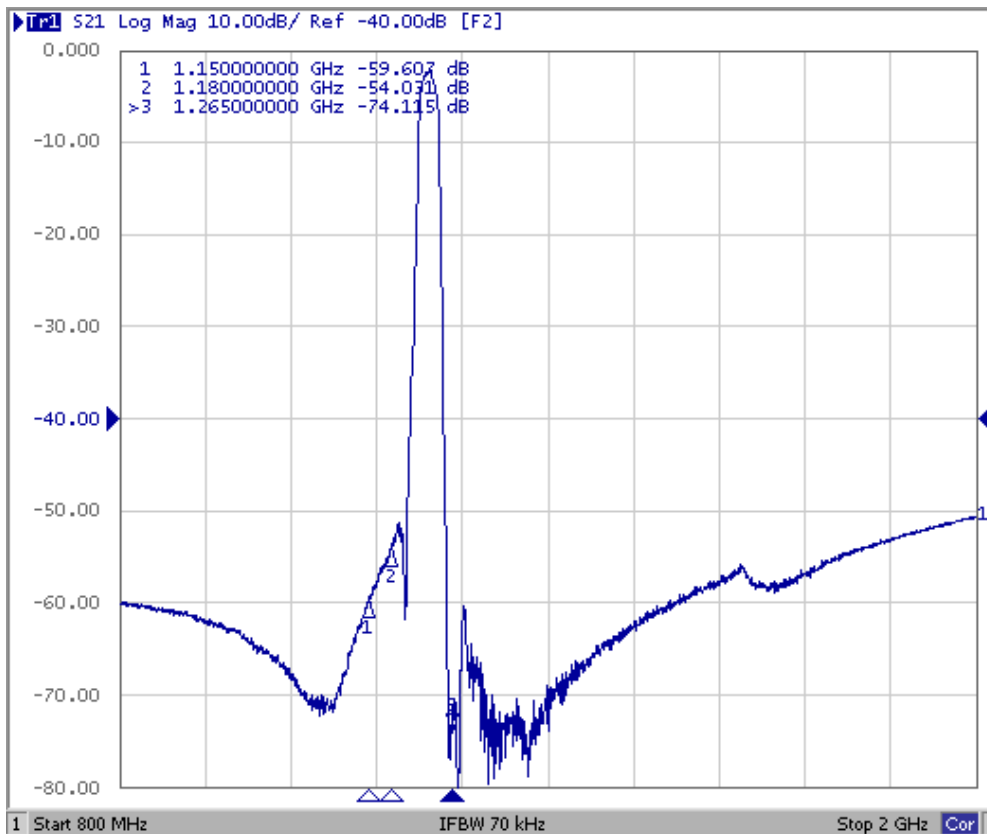
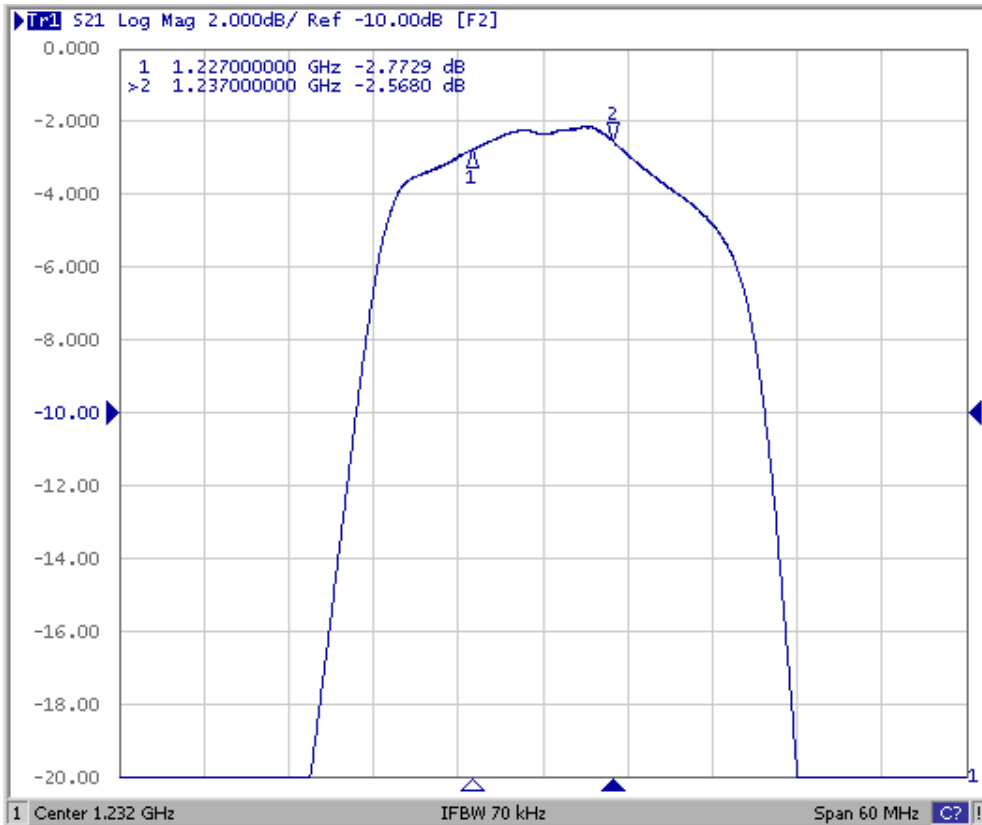

SAW Filter 1232.0MHz
Part No: MP08170

Model: TA1680A
Rev No: 1

Reflection Functions

S11



S22



SAW Filter 1232.0MHz
Part No: MP08170

Model: TA1680A
Rev No: 1

G. PACKING:

1. Reel Dimension

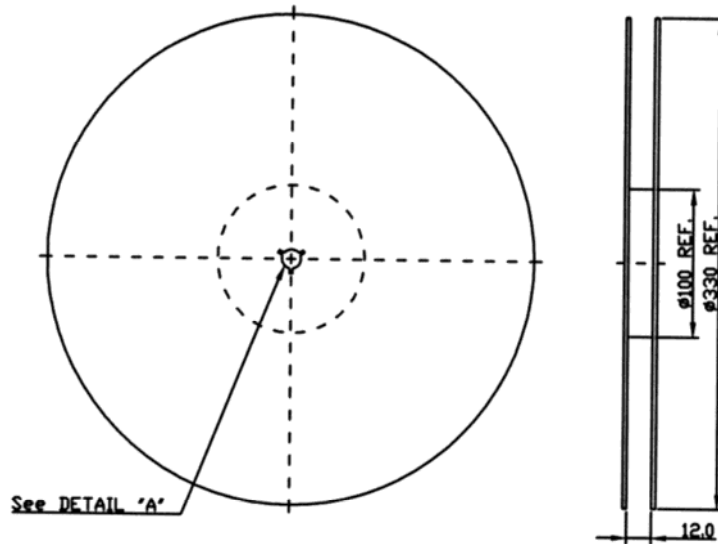

2. Tape Dimension

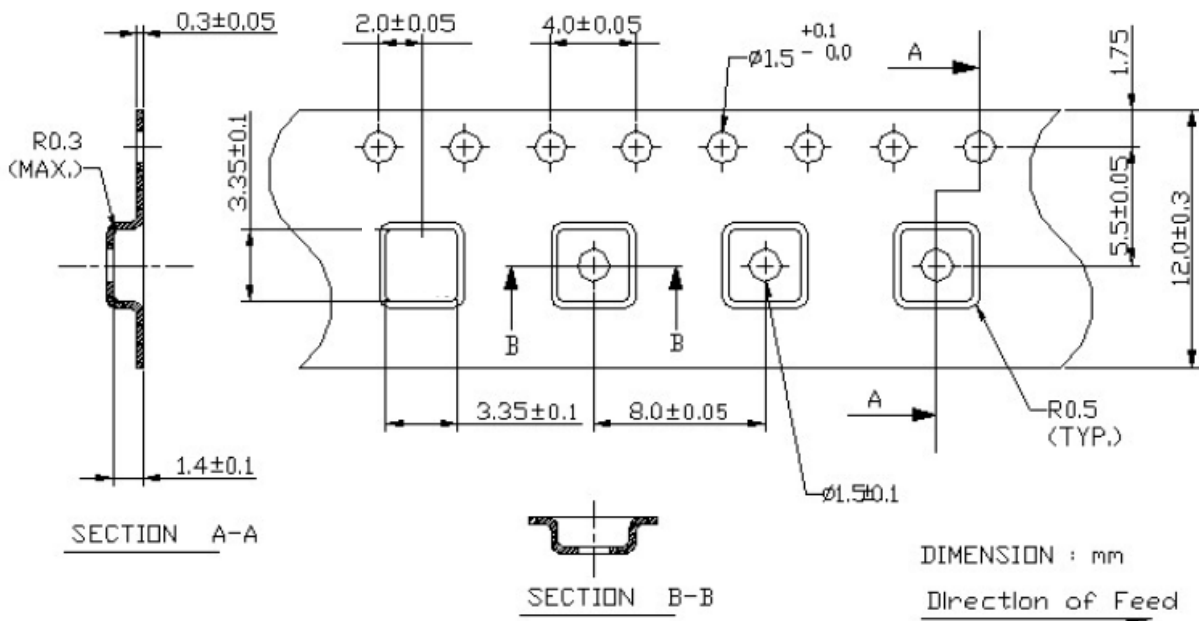

SAW Filter 1232.0MHz
Part No: MP08170

Model: TA1680A
Rev No: 1

H. RECOMMENDED REFLOW PROFILE:

