

# Product End-of-Life Instructions

**Rack Enclosures and Accessories**

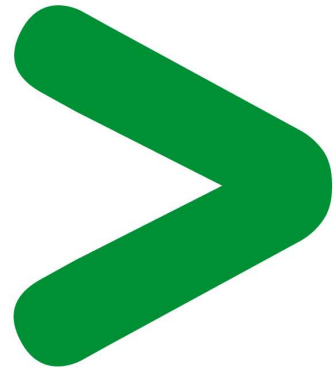

# Product End-of-Life Instructions – EoLI

## Product overview

**Product Range:** Rack Rail Enclosures and Accessories

**Marketing Model/Name:** AR3100 NetShelter SX 42U

**Size:** H x L x D in mm = 1991 x 600 x 1070

**Weight in g = 144,550g** (for the AR3100 NetShelter SX 42U)

The mass of the product range as complete units is from 91,001 g and 500,321 g including packaging. Individual rack parts sold separately range from 14 g and 25,885 g including packaging.

The product range includes models AR1XX, AR2XXX, AR3XXX, AR4XX, AR7XXX and AR8XXX where XXX is any number.

## Purpose

The product family must be disposed according to the legislation of the country. This document is intended for use by end of life recyclers or treatment facilities. It provides the basic information to assure an appropriate end of life treatment for the components and materials of the product.

## Operations recommended for the end of life treatment

There are several steps to process the products at the end of life so as to recover components, materials or energy :

**Reuse → Separation for special treatment → Other dismantling → Shredding**

### CAUTION:

**The components of the products that optimize the recycling performances are listed, identified and located hereunder.**

### Disassembly Instructions:

1. Remove electronics and other equipment from the rack per the manufacturers' instructions.
2. Disassemble remaining rack components and place into the appropriate recycling waste stream.

## Product End-of-Life Instructions – EoLI

The components of the products that optimize the recycling performances are listed, identified and located hereunder.

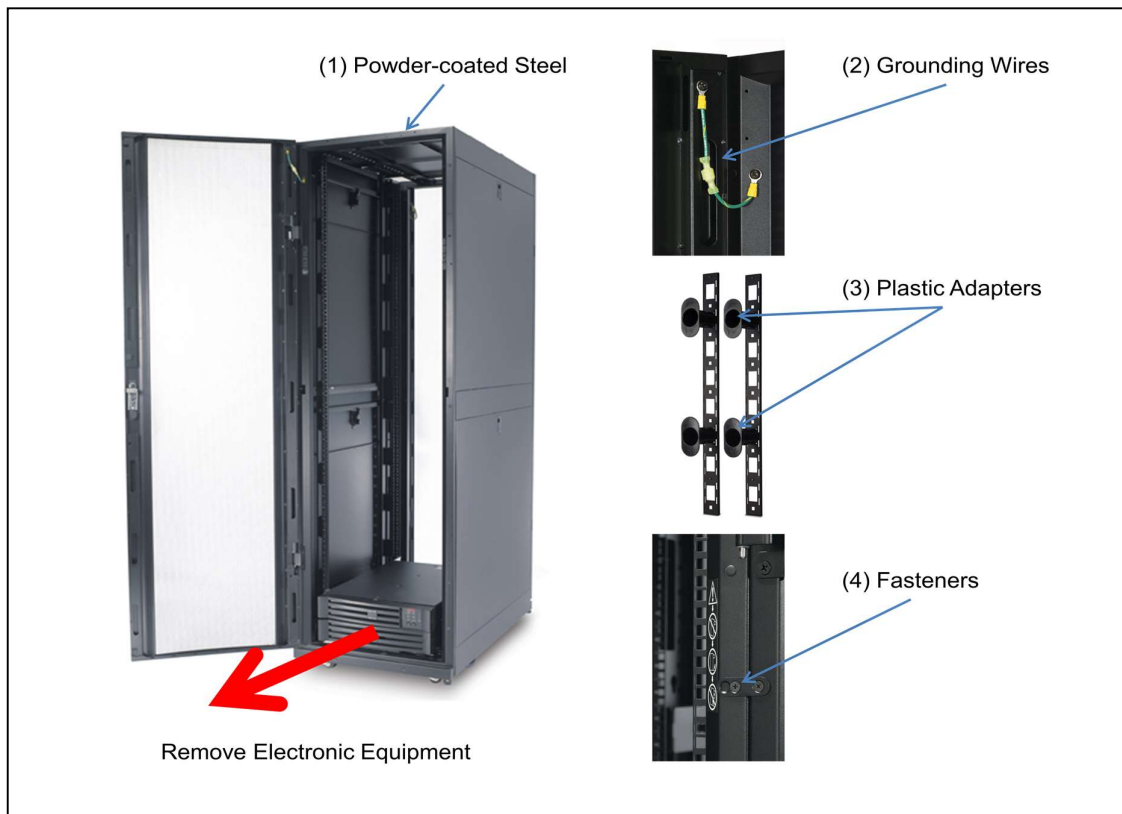

Recommendation	Number on drawing	Components	Weight (in g)	Comment
Special treatment	(1)	Plated or powder-coated metal rails	500 – 2970 each	Cold Rolled Steel
Special treatment	(2)	Cable	50 – 150 each	Brominated flame retarded (BFR) nylon moulded connectors.

EoLI achieved with Schneider-Electric TT03 V5 procedure

### Schneider Electric Industries SAS

35, rue Joseph Monier  
 CS 30323  
 F- 92506 Rueil Malmaison Cedex  
 RCS Nanterre 954 503 439  
 Capital social 896 313 776 €

[www.schneider-electric.com](http://www.schneider-electric.com)