

## Vacuum/pressure switch

### VS-V-PNP M8-4

Part no.:10.06.02.00027

<https://www.schmalz.com/10.06.02.00027>

Homepage > Vacuum Technology for Automation > Vacuum Components > Switches and System Monitoring > Electronic Vacuum and Pressure Switches > Vacuum Switches VS-V > VS-V-PNP M8-4

## Vacuum/pressure switch with digital and analogue output signal



Measuring range: -1.0 ... 0.0 bar  
 Type: Switches to plus  
 Electrical connection:  
 Male connect M8, 4 pole  
 Inputs/outputs: 1 anal./1 dig 1...5V

## Design Data

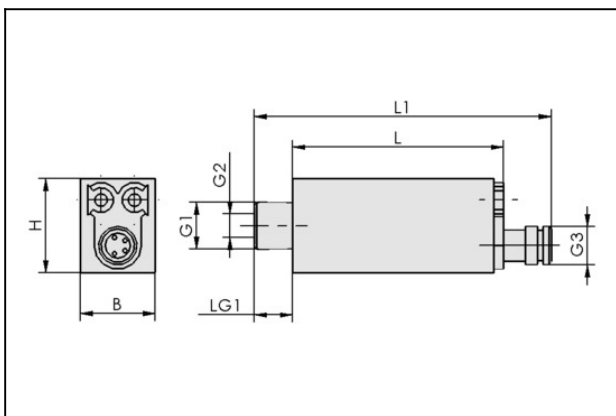

Attribute	Value
B	15.7 mm
G1	G1/8"-M
G2	M5-F
G3	M8x1-M
H	19.7 mm
L	44 mm
L1	62 mm
LG1	8 mm

## Technical Data

## Vacuum/pressure switch

### VS-V-PNP M8-4

Part no.:10.06.02.00027

<https://www.schmalz.com/10.06.02.00027>

Attribute	Value
Construction shape vacuum switch	Switches to +
Measured medium	Non-aggressive gases; dry, oil-free air
Measuring range	-1.0...0.0 bar
Overpressure resistance	5 bar
Repeatability	± 1% of full-scale value
Hysteresis	Adjustable: 3 to 25% of set value
Switching capacity (max)	125 mA
On time	5 ms
Indication	LED
Electrical connection	Male connect M8, 4 pole
Voltage	10.8-30V DC
Connection	G1/8"-M + M5-F
Current consumption	30 mA
Protection type IP	IP 40/65 (with hose)
Temperature influence	± 3% of full-scale value
Operating temperature	0 ... 50 °C
Weight	18 g
Construction shape vacuum switch	PNP
Inputs/outputs	1 anal./1 dig 1...5V
Measuring range	-1...0

---

## Accessories

## Vacuum/pressure switch

### VS-V-PNP M8-4

Part no.:10.06.02.00027

<https://www.schmalz.com/10.06.02.00027>



#### **ASK B-M8-4 5000 K-4P**

Part no.10.06.02.00031

Connection cable

Interface Connection cable:

Fem connect M8, 4 pol

Cable length: 5000 mm

Interface Connection cable: Cable 4

Material: PUR-Cable



#### **ASK WB-M8-4 5000 K-4P**

Part no.10.06.02.00032

Connection cable

Interface Connection 1:

Elbow fem con M8, 4 pol

Cable length: 5000 mm

Interface Connection 2: Cable 4

Material: PUR-Cable