



LCD monitor, LED backlight with PowerSensor

- S Line
- 27" (68.6 cm)
- Full HD display

271S4LPYEB/00

## Sustainable eco design display

with PowerSensor saves energy bills

The Philips PowerSensor LED display using 25% recycled materials and PVC, BFR-free housing is ideal for eco-friendly productivity

### Benefits

#### Sustainable Eco-design

- PowerSensor saves up to 80% energy costs
- 25% recycled material with EPEAT Gold
- PVC-BFR free housing

#### Great performance

- LED technology ensures natural colours
- DisplayPort delivers high bandwidth for ultra-fine images
- SmartContrast gives enhanced rich black details

#### Designed for people

- SmartErgoBase enables user-friendly ergonomic adjustments
- Low bezel-to-table height for maximum reading comfort

#### Easy to experience

- SmartImage presets for easy optimised image settings
- SmartControl for easy performance tuning

**PHILIPS**

## Features

### PowerSensor

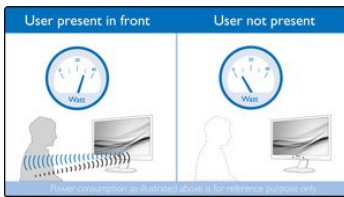

PowerSensor is a built-in 'people sensor' that transmits and receives harmless infrared signals to determine if the user is present and then automatically reduces monitor brightness when the user steps away from the desk, cutting energy costs by up to 80 percent and prolonging monitor life.

### EPEAT Gold

Philips EPEAT GOLD certified monitors ensure protection for human health and the environment, and are highly energy efficient ensuring low emissions of climate changing greenhouse gases. The EPEAT programme helps purchasers evaluate, compare and select Monitors based on 51 environmental criteria supported by the US EPA. GOLD certification ensures that at least 30% of plastic used is Post-Consumer Resin, which ensures reduction in the use of toxic and hazardous materials. EPEAT Gold is valid only where Philips registers the product. Please visit [www.epeat.net](http://www.epeat.net) for the registration status in your country.

### PVC-BFR free housing

This Philips monitor housing is free from brominated flame retardant and polyvinyl chloride (PVC-BFR free).

### LED technology

White LED's are solid state devices which light up to full, consistent brightness faster saving startup time. LED's are free from mercury content, which allows for eco-friendly recycling and disposal process. LED's allow for better dimming control of the LCD backlight, resulting in a super high contrast ratio. It also gives superior colour reproduction thanks to consistent brightness across the screen.

### DisplayPort

DisplayPort is a digital link from PC to monitor without any conversion. With higher capabilities than DVI standard, it is fully capable to support up to 15 metre cables and 10.8 Gbps/sec data transfer. With this high performance and zero latency, you get the fastest imaging and refresh rates — making DisplayPort the best choice for not only general office or home use, but also for the more demanding gaming and films, video editing and more. It also keeps interoperability in mind via the use of various adapters.

### SmartContrast



SmartContrast is a Philips technology that analyses the contents you are displaying, automatically adjusting colours and controlling backlight intensity to dynamically enhance contrast for the best digital images and videos or when playing games where dark hues are displayed. When Economy mode is

selected, contrast is adjusted and backlighting fine-tuned for just-right display of everyday office applications and lower power consumption.

### SmartErgoBase



The SmartErgoBase is a monitor base that delivers ergonomic display comfort and provides cable management. The user-friendly height, swivel, tilt and rotation angle adjustments of the base allow the monitor to be positioned for maximum comfort to help ease the physical strains of a long workday. In addition, cable management reduces cable clutter and keeps the workspace neat and professional.

### Low bezel-to-table height



Thanks to its advanced SmartErgoBase, the Philips monitor can be lowered down almost to desk level for a comfortable viewing angle. Low bezel-to-table height is the perfect solution if you use bifocals, trifocals or progressive lens glasses for your computing work. Additionally, it allows users of different heights to use the monitor at their preferred angle and height settings, helping them to reduce fatigue and strain.

### SmartImage

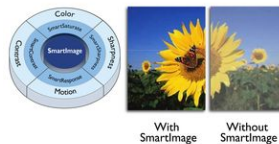

SmartImage is an exclusive leading edge Philips technology that analyses the content displayed on your screen and optimises your display performance. This user-friendly interface allows you to select various modes, like Office, Photo, Movie, Game, Economy etc., to fit the application in use. Based on the selection, SmartImage dynamically optimises the contrast, colour saturation and sharpness of images and videos for ultimate display performance. The Economy mode option offers you major power savings. All in real time at the touch of a single button!

### SmartControl for easy tuning

PC software for fine tuning display performance and settings. Philips offers users two choices for display setting adjustment. Either navigate the multi-level On-Screen Display menu through buttons on the display itself or use the Philips SmartControl software to easily adjust the various display settings in a familiar way.

## Specifications

Please note that this is a pre-sales leaflet. The contents of this leaflet reflect the best of our knowledge per date and country mentioned above. The contents of this leaflet are subject to change without notice. Philips does not accept any liability as to the contents of this leaflet.

### Picture/Display

LCD panel type	TFT-LCD
Backlight type	W-LED system
Panel Size	27 inch/68.6 cm

Effective viewing area	597.6 (H) x 336.15 (V)
Aspect ratio	16:9
Optimum resolution	1920 x 1080 @ 60 Hz

Response time (typical)	5 ms
Brightness	300 cd/m <sup>2</sup>
Contrast ratio (typical)	1000:1
SmartContrast	20,000,000:1
Pixel pitch	0.311 x 0.311 mm
Viewing angle	170° (H)/160° (V) @ C/R > 10
Picture enhancement	SmartImage
Display colours	16.7 M
Scanning Frequency sRGB	30–83 kHz (H)/56–75 Hz (V) Yes

#### Connectivity

Signal Input	DisplayPort DVI-D (digital, HDCP) VGA (Analogue)
Sync Input	Separate Sync Sync on Green

#### Convenience

User convenience	SmartImage PowerSensor Brightness Menu Power On/Off
Control software OSD Languages	SmartControl Premium English French German Italian Portuguese Russian Simplified Chinese Spanish
Other convenience	Kensington lock VESA mount (100 x 100 mm)
Plug and Play Compatibility	DDC/CI Mac OS X sRGB Windows 8/7/Vista

#### Stand

Height adjustment	150 mm
Pivot	90 degree
Swivel	-65/65 degree
Tilt	-5/20 degree

#### Power

ECO mode	14 W (typ.)
On mode	21.3 W (typ.) (EnergyStar 6.0 test method)
Standby mode	0.3 W (typ.)
Off mode	0.1 W (typ.)
Power LED indicator	Operation - White Standby mode - White (flashing)
Power supply	100-240 VAC, 50-60 Hz Built-in

#### Dimensions

Product with stand (max height)	639 x 580 x 242 mm
---------------------------------	--------------------

Product without stand (mm)	639 x 405 x 64 mm
Packaging in mm (W x H x D)	750 x 234 x 490 mm

#### Weight

Product with stand (kg)	7.50 kg
Product without stand (kg)	5.10 kg
Product with packaging (kg)	10.35 kg

#### Operating conditions

Temperature range (operation)	0°C to 40°C °C
Temperature range (storage)	-20°C to 60°C °C
Relative humidity	20–80% %
Altitude	Operation: +12,000 ft (3658 m), Non-operation: +40,000 ft (12,192 m)
MTBF	30,000 hour(s)

#### Sustainability

Environmental and energy	EnergyStar 6.0 PowerSensor EPEAT Gold* RoHS
Recyclable packaging material	100 %
Recycled material	25%
Specific Substances	PVC/BFR free housing Mercury free Lead free

#### Compliance and standards

Regulatory Approvals	BSMI CE Mark FCC Class B GOST SASO SEMKO TCO 6.0 TUV Ergo TUV/GS UL/cUL WEEE
----------------------	--

#### Cabinet

Front bezel	Black
Rear cover	Black
Foot	Black
Finish	Texture

#### What's in the box?

Monitor with stand	yes
Cables	VGA, DVI, Power
User Documentation	yes

\* EPEAT Gold is valid only where Philips registers the product. Please visit [www.epeat.net](http://www.epeat.net) for registration status in your country.



data subject to change  
2017, July 28

Version: 2.1.1  
EAN: 8712581704179

© 2017 Koninklijke Philips N.V.  
All rights reserved.

Specifications are subject to change without notice. Trademarks are the property of Koninklijke Philips N.V. or their respective owners.

[www.philips.com](http://www.philips.com)