



LCD monitor with PowerSensor

- P Line
- 24.1" (61 cm)
- WUXGA (1920 x 1200)

240P4QPYEB/00

## Sustainable eco design display

with PowerSensor saves energy bills

This professional Philips PowerSensor display with IPS LED gives you brilliant wide-angle images. With features like multi-connectivity, USB hub and super-ergonomic base, it's ready for eco-friendly productivity.

### Benefits

#### Sustainable Eco-design

- PowerSensor saves up to 80% energy costs
- PVC-BFR free housing
- Zero power consumption with 0 watt hard switch

#### Brilliant performance

- IPS technology for full colours and wide viewing angles
- DisplayPort delivers high bandwidth for ultra-fine images
- Built-in stereo speakers for multimedia

#### Designed for people

- SmartErgoBase enables user-friendly ergonomic adjustments
- Low bezel-to-table height for maximum reading comfort

#### Easy to experience

- SmartImage pre-sets for easy optimised image settings
- USB Hub with four ports for easy connections

**PHILIPS**

## Features

### PowerSensor

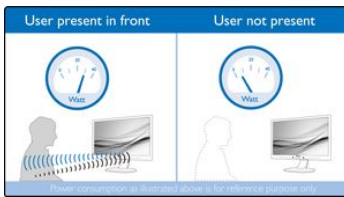

PowerSensor is a built-in 'people sensor' that transmits and receives harmless infrared signals to determine if the user is present and then automatically reduces monitor brightness when the user steps away from the desk, cutting energy costs by up to 80 percent and prolonging monitor life.

### IPS technology



IPS displays use advanced technology that gives you extra-wide viewing angles of 178/178 degrees, making it possible to view the display from almost any angle — even in 90-degree Pivot mode! Unlike standard TN panels, IPS displays give you remarkably crisp images with vivid colours, making it ideal not only for Photos, films and web browsing, but also for professional applications that demand colour accuracy and consistent brightness at all times.

### DisplayPort

DisplayPort is a digital link from PC to monitor without any conversion. With higher capabilities than DVI standard, it is fully capable to support up to 15 metre cables and 10.8 Gbps/sec data transfer. With this high performance and zero latency, you get the fastest imaging and refresh rates — making DisplayPort the best choice for not only general office or home use, but also for the more demanding gaming and films, video editing and more. It also keeps interoperability in mind via the use of various adapters.

### SmartErgoBase



The SmartErgoBase is a monitor base that delivers ergonomic display comfort and provides cable management. The user-friendly height, swivel, tilt and rotation angle adjustments of the base allow the monitor to be positioned for maximum comfort to help ease the physical strains of a long workday. In addition, cable management reduces cable clutter and keeps the workspace neat and professional.

## Specifications

Please note that this is a pre-sales leaflet. The contents of this leaflet reflect the best of our knowledge per date and country mentioned above. The contents of this leaflet are subject to change without notice. Philips does not accept any liability as to the contents of this leaflet.

### Picture/Display

LCD panel type	IPS 3H hardness hard coating
Backlight type	W-LED system
Panel Size	24.1 inch / 61 cm
Effective viewing area	518.4 (H) x 324 (V)

### SmartImage

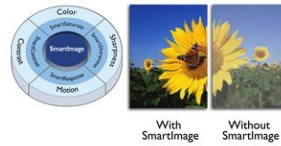

SmartImage is an exclusive leading edge Philips technology that analyses the content displayed on your screen and optimises your display performance. This user-friendly interface allows you to select various modes, like Office, Photo, Movie, Game, Economy etc., to fit the application in use. Based on the selection, SmartImage dynamically optimises the contrast, colour saturation and sharpness of images and videos for ultimate display performance. The Economy mode option offers you major power savings. All in real time at the touch of a single button!

### Built-in stereo speakers

A pair of high-quality stereo speakers built into a display device. They may be visible front firing, or invisible down firing, top firing, rear firing etc. depending on model and design.

### Low bezel-to-table height



Thanks to its advanced SmartErgoBase, the Philips monitor can be lowered down almost to desk level for a comfortable viewing angle. Low bezel-to-table height is the perfect solution if you use bifocals, trifocals or progressive lens glasses for your computing work. Additionally, it allows users of different heights to use the monitor at their preferred angle and height settings, helping them to reduce fatigue and strain.

### Four Ports USB 2.0 HUB

USB Hub allows user to conveniently connect their plug and play multimedia devices such as USB memory devices, camera, portable HDD, Web camera, PDA, Printer and many other devices which have USB connection available. The conveniently located USB 2.0 Hub on the monitor allows USB 2.0 signals to pass through to the computer. Note that many devices like cameras and HDD may need to be powered On independently, as they have higher power requirements than the monitor USB Hub can provide.

### PVC-BFR free housing

This Philips monitor housing is free from brominated flame retardant and polyvinyl chloride (PVC-BFR free)

### Zero power consumption

At the flick of the 0 watt hard switch, which is conveniently located at the back of the monitor, you can completely cut off your monitor from AC power. This results in zero power consumption, reducing your carbon footprint even further.

Aspect ratio	16:10
Optimum resolution	1920 x 1200 @ 60 Hz
Response time (typical)	5 ms (Grey to Grey)*
Brightness	300 cd/m <sup>2</sup>

data subject to change  
2017, July 12

Contrast ratio (typical)	1000:1
SmartContrast	20,000,000:1
Pixel pitch	0.270 x 0.270 mm
Viewing angle	178° (H)/178° (V) @ C/R > 10
Picture enhancement	SmartImage
Display colours	16.7 M
Scanning Frequency	30 - 83 kHz (H) / 56 - 76 Hz (V)
sRGB	Yes

#### Connectivity

Signal Input	DVI-D (digital, HDCP) VGA (Analogue) Display Port 1.2 (w/ HDCP 1.4)
USB	USB 2.0 x 4
Sync Input	Separate Sync Sync on Green
Audio (In/Out)	Headphone out PC audio-in

#### Convenience

Built-in Speakers	1.5 W x 2
User convenience	PowerSensor SmartImage Volume Menu Power On/Off
Control software	SmartControl
OSD Languages	English French German Italian Portuguese Russian Simplified Chinese Spanish
Other convenience	Kensington lock VESA mount (100 x 100 mm)
Plug and Play Compatibility	DDC/CI Mac OS X sRGB Windows 8/7/Vista

#### Stand

Height adjustment	130 mm
Pivot	90 degree
Swivel	-65/65 degree
Tilt	-5/20 degree

#### Power

ECO mode	12.3 W (typ.)
On mode	18.3 W (typ.) (EnergyStar 7.0 test method)
Standby mode	<0.3 W (typ.)
Off mode	Zero watts with Zero switch
Power LED indicator	Operation - White Standby mode - White (flashing)
Power supply	100-240 VAC, 50-60 Hz Built-in

#### Dimensions

Product with stand (mm)	555 x 550 x 244 mm
-------------------------	--------------------

Product without stand (mm)	555 x 388 x 65 mm
Packaging in mm (W x H x D)	632 x 457 x 286 mm

#### Weight

Product with stand (kg)	6.97 kg
Product without stand (kg)	4.64 kg
Product with packaging (kg)	9.80 kg

#### Operating conditions

Temperature range (operation)	0°C to 40°C °C
Temperature range (storage)	-20°C to 60°C °C
Relative humidity	20%–80% %
Altitude	Operation: +12,000 ft (3658 m), Non-operation: +40,000 ft (12,192 m) 50,000 hrs (excluded backlight)
MTBF (demonstrated)	

#### Sustainability

Environmental and energy	EnergyStar 7.0 EPEAT Gold* PowerSensor RoHS
Recyclable packaging material	100 %
Recycled material	25%
Specific Substances	PVC/BFR free housing Mercury free Lead free

#### Compliance and standards

Regulatory Approvals	BSMI CE Mark FCC Class B GOST SEMKO TUV Ergo TUV/GS UL/cUL WEEE TCO 7.0
----------------------	--

#### Cabinet

Front bezel	Black
Rear cover	Black
Foot	Black
Finish	Texture

#### What's in the box?

Monitor with stand	yes
Cables	VGA, DVI, DP, Audio, Power
User Documentation	yes

- \* EPEAT Gold is valid only where Philips registers the product. Please visit [www.epeat.net](http://www.epeat.net) for registration status in your country.
- \* "IPS" word mark / trademark and related patents on technologies belong to their respective owners.
- \* Response time value equal to SmartResponse



data subject to change  
2017, July 12

Version: 9.0.1  
EAN: 8712581663179

© 2017 Koninklijke Philips N.V.  
All rights reserved.

Specifications are subject to change without notice. Trademarks are the property of Koninklijke Philips N.V. or their respective owners.

[www.philips.com](http://www.philips.com)