

H25 PRO SERIES

Maximum Flow Rate: 20.0 gpm (75.9 l/min)
Maximum Pressure: 1000 psi (69 bar) for Metallic Pump Heads
350 psi (24 bar) for Non-metallic Pump Heads

WANNER™ HYDRA-CELL® PRO
SEAL-LESS PUMP TECHNOLOGIES

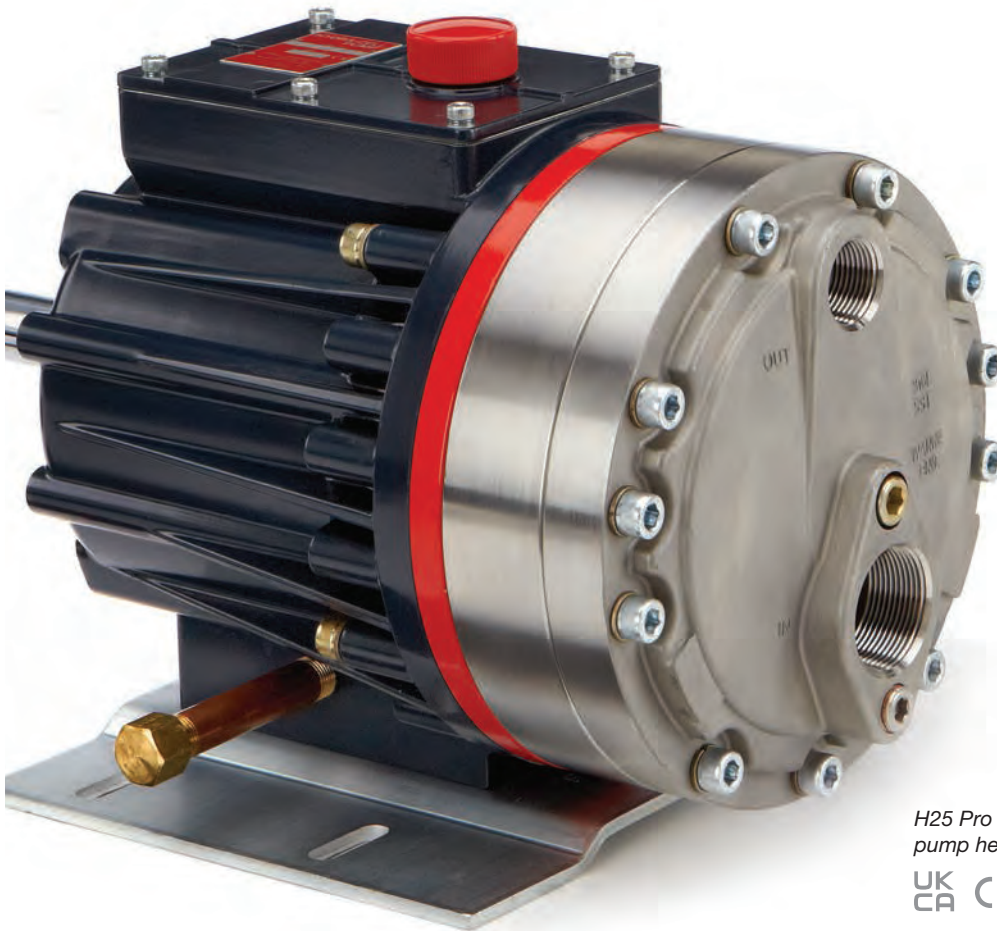

H25 Pro with 316L Stainless Steel pump head.

UK
CA CE

Versatile, reliable pumps for a wide range of applications.

- Pumps the full spectrum of low-to-high viscosity fluids.
- Features a seal-less design and horizontal disk check valves that enable the pump to handle abrasives and particulates that might damage or destroy other types of pumps.
- Simple, compact design reduces initial investment and lowers maintenance costs.
- Operational efficiencies reduce energy costs.
- Able to run dry without damage (or additional maintenance) to the pump in case of accident or operator error.
- Tolerates non-ideal operating conditions.
- Minimizes maintenance and downtime because there are no mechanical or dynamic seals, packing, or cups to leak, wear, or replace.

QUICK & DISCOUNTED PRICING
CLICK HERE
OR CALL (908) 362-9981



H25 Pro Series | Performance

Capacities

| Model | Max. Input rpm | Max. Flow Capacities @1000 psi (69 bar) | | Max. Inlet Pressure | | Max. Discharge Pressure | | | | | |
|-------|-------------------|--|-------|---------------------|-----|-------------------------|----|---------------------|----|------------|----|
| | | gpm | l/min | psi | bar | Metallic Heads | | Polypropylene Heads | | PVDF Heads | |
| H25-X | 1050 | 20.0 | 75.7 | 250 | 17 | 1000 | 69 | 250 | 17 | 350 | 24 |
| H25-E | 1150 | 20.0 | 75.9 | 250 | 17 | 1000 | 69 | 250 | 17 | 350 | 24 |
| H25-S | 1150 | 16.2 | 61.5 | 250 | 17 | 1000 | 69 | 250 | 17 | 350 | 24 |
| H25-I | 1150 | 11.8 | 44.7 | 250 | 17 | 1000 | 69 | 250 | 17 | 350 | 24 |

Performance and specification ratings apply to H25 configurations unless specifically noted otherwise.

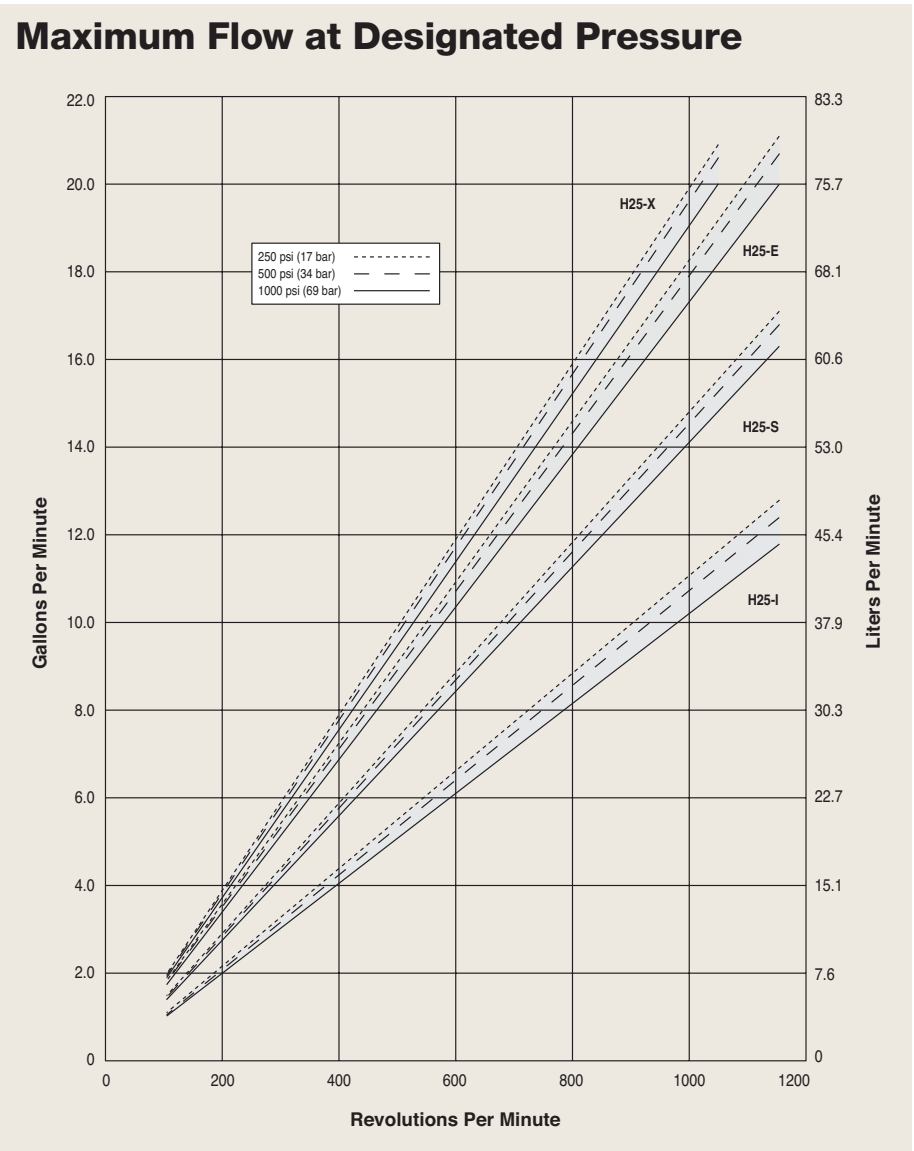

H25 Pro Series | Specifications

Flow Capacities @1000 psi (69 bar)

| Model | rpm | gpm | l/min |
|-------|------|------|-------|
| H25-X | 1050 | 20.0 | 75.7 |
| H25-E | 1150 | 20.0 | 75.9 |
| H25-S | 1150 | 16.2 | 61.5 |
| H25-I | 1150 | 11.8 | 44.7 |

Delivery @1000 psi (69 bar)

| Model | gal/rev | liters/rev |
|-------|---------|------------|
| H25-X | 0.0190 | 0.0721 |
| H25-E | 0.0174 | 0.0660 |
| H25-S | 0.0141 | 0.0535 |
| H25-I | 0.0103 | 0.0389 |

Maximum Discharge Pressure

| | |
|---------------------|--------------------------------|
| Metallic Heads: | 1000 psi (69 bar) |
| Non-metallic Heads: | 250 psi (17 bar) Polypropylene |
| | 350 psi (24 bar) PVDF |

Maximum Inlet Pressure 250 psi (17 bar)

Maximum Operating Temperature

| | |
|---------------------|--|
| Metallic Heads: | 250°F (121°C) |
| | Consult factory for correct component selection for temperatures from 160°F (71°C) to 250°F (121°C). |
| Non-metallic Heads: | 140°F (60°C) |

Maximum Solids Size 800 microns

| | |
|-------------------|--|
| Inlet Port | 1-1/2 inch NPT 150lb ANSI RF flange |
|-------------------|--|

| | |
|-----------------------|------------------------------------|
| Discharge Port | 1 inch NPT 600lb ANSI RF flange |
|-----------------------|------------------------------------|

Calculating Required Power

$$\frac{50 \times \text{rpm}}{63,000} + \frac{\text{gpm} \times \text{psi}}{1,460} = \text{electric motor hp}$$

$$\frac{50 \times \text{rpm}}{84,428} + \frac{\text{l/min} \times \text{bar}}{511} = \text{electric motor kW}$$

Attention!

When using a variable frequency drive (VFD) controller, calculate the hp or kW at minimum and maximum pump speed to ensure the correct hp or kW motor is selected. Note that motor manufacturers typically de-rate the service factor to 1.0 when operating with a VFD.

Calculating Pulley Size

$$\frac{\text{motor pulley OD}}{\text{pump rpm}} = \frac{\text{pump pulley OD}}{\text{motor rpm}}$$

| | |
|-----------------------|----------------------|
| Shaft Diameter | 1-1/8 inch (28.6 mm) |
|-----------------------|----------------------|

| | |
|-----------------------|--------------------------|
| Shaft Rotation | Reverse (bi-directional) |
|-----------------------|--------------------------|

| | |
|-----------------|-------------------------|
| Bearings | Tapered roller bearings |
|-----------------|-------------------------|

| | |
|---------------------|----------------------------|
| Oil Capacity | 3.3 US quarts (3.1 liters) |
|---------------------|----------------------------|

Weight

| | |
|---------------------|--------------------|
| Metallic Heads: | 125 lbs. (56.8 kg) |
| Non-metallic Heads: | 90 lbs. (40.9 kg) |

Net Positive Suction Head (NPSHr)

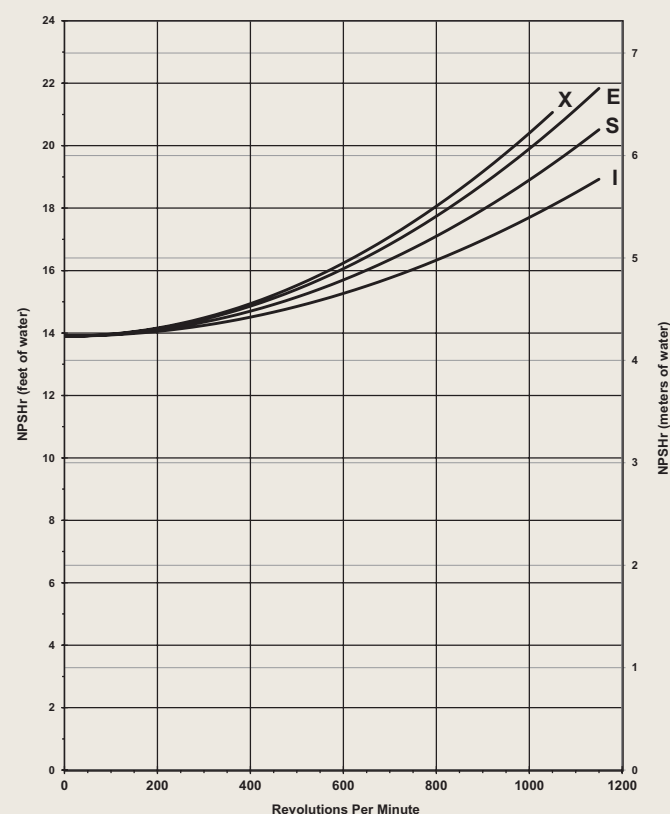

Note: Positive inlet pressure required with PTFE diaphragms.

Suction Lift

Each Hydra-Cell pump has different lift capability depending on model size, cam angle, speed, and fluid characteristics. To ensure that your specific lift characteristics are met, refer to the inlet calculations regarding friction, and acceleration head losses in your Hydra-Cell Product Manual. Compare those calculations to the NPSHr curves above.

H25 Pro Series | Representative Drawings

H25 Models with Metallic Pump Head Inches (mm)

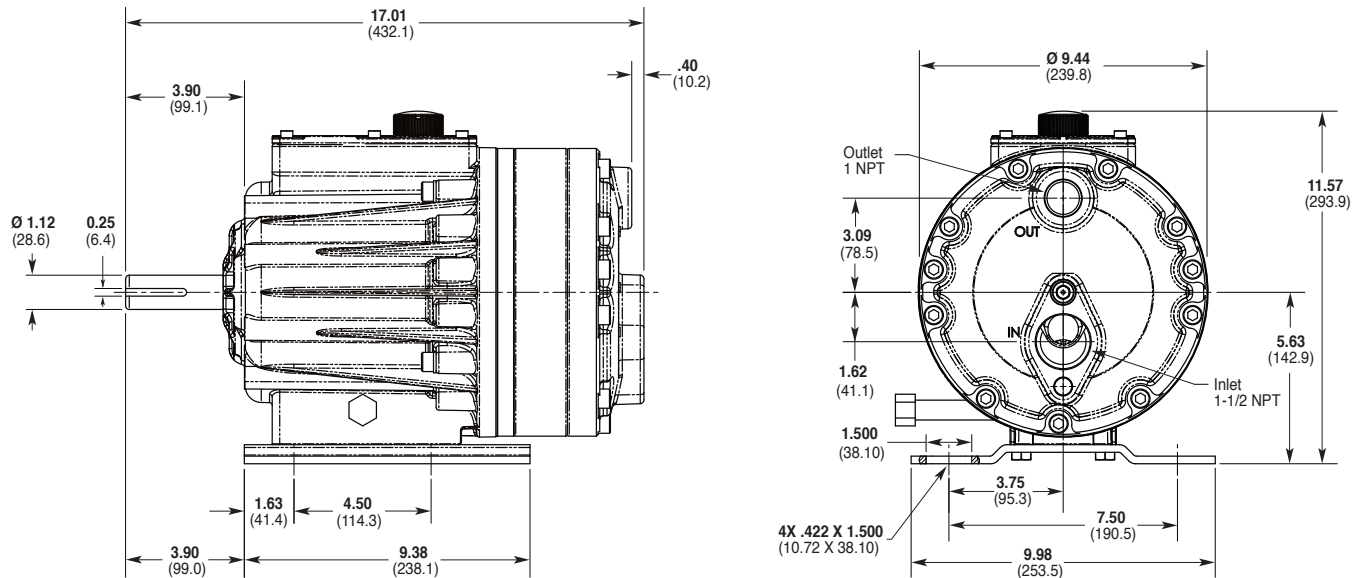

H25 Models with Non-metallic Pump Head Inches (mm)

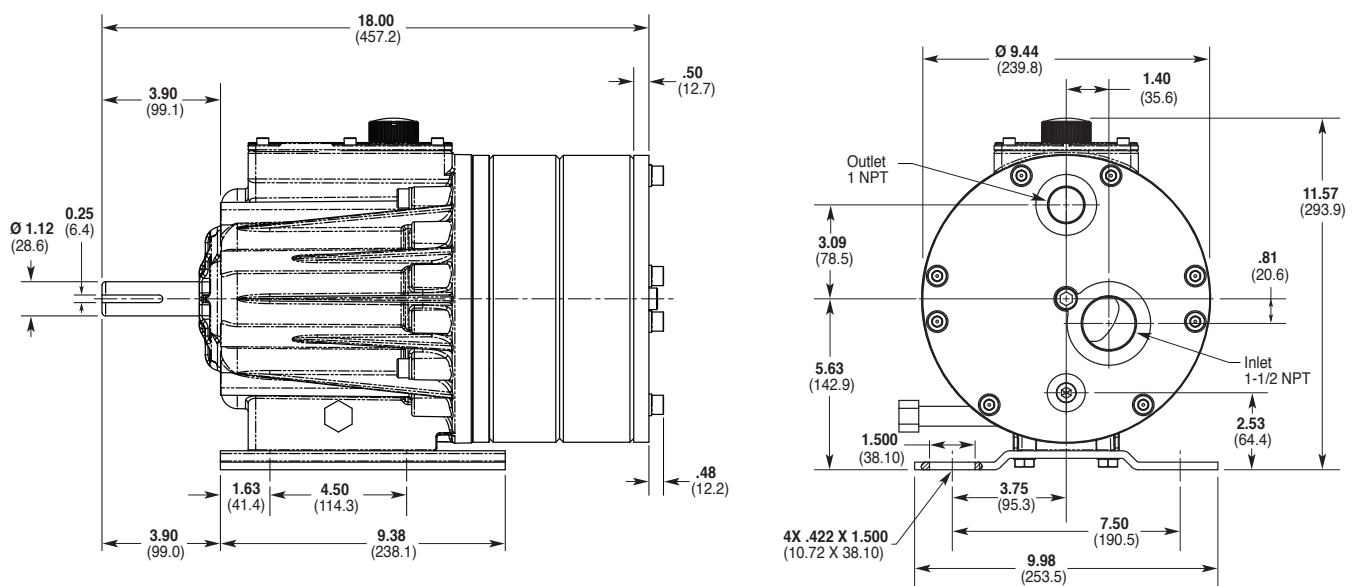

Note: Dimensions are for reference only. Contact factory for certified drawings.

H25 Pro Series | Adapters / Valves

Pump/Motor Adapter Inches (mm)

Part Number: A04-041-1200

For: 182TC, 184TC, 213, 215TC, 254 and 256TC frame motors.

Metric adapter available - consult factory.

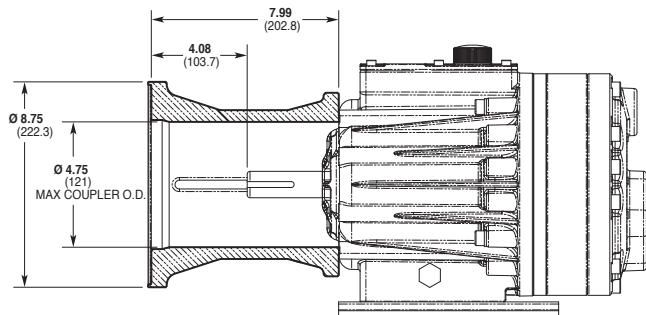

Part Number: A04-041-1202

For: 284TC and 286TC frame motors.

Metric adapter available - consult factory.

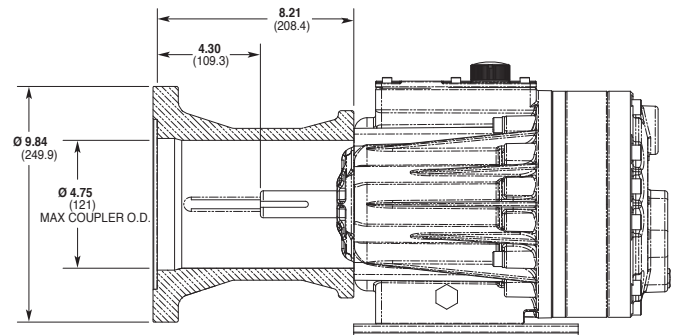

Note: Dimensions are for reference only. Contact factory for certified drawings.

Valve Selection

A seal-less **C63 Pressure Regulating Valve** is recommended for Hydra-Cell Pro H25 pumping systems, especially for high-pressure requirements or when handling dirty fluids.



A **C23 Pressure Regulating Valve** provides a capable, lower-cost alternative to C63 valves for Hydra-Cell Pro H25 pumping systems.



Skid-mounted H25 with 15hp, 3-phase motor.

For complete specifications and ordering information, consult the Hydra-Cell Master Catalog.

H25 Pro Series | How to Order

Ordering Information

A complete H25 Series Model Number contains 12 digits including 9 customer-specified design and materials options, for example: H25XKCGNNECA.

| | | | | | | | | | | | |
|---|---|---|---|---|---|---|---|---|----|----|----|
| 1 | 2 | 3 | 4 | 5 | 6 | 7 | 8 | 9 | 10 | 11 | 12 |
| H | 2 | 5 | | | | | | | | | |

| Digit | Order Code | Description |
|-------|------------|---|
| 1-3 | | Pump Configuration |
| | H25 | Shaft-driven (NPT Ports or ANSI Flanges)* <i>*Pump/motor adapters ordered separately. See previous page.</i> |
| 4 | | Hydraulic End Cam |
| | X | Max 20.0 gpm (75.7 l/min) @ 1050 rpm |
| | E | Max 20.0 gpm (75.9 l/min) @ 1150 rpm |
| | S | Max 16.2 gpm (61.5 l/min) @ 1150 rpm |
| | I | Max 11.8 gpm (44.7 l/min) @ 1150 rpm |
| 5 | | Pump Head Version |
| | K | Kel-Cell NPT Ports |
| | M | Machined housing to accept C-face adapter/gearbox |
| 6 | | Pump Head Material |
| | B | Brass |
| | C | Cast Iron (Nickel-plated) |
| | G | Duplex Alloy 2205 Stainless Steel (with Hastelloy C followers & follower screws) |
| | M | PVDF (with Hastelloy C followers & follower screws) |
| | N | Polypropylene (with Hastelloy C followers & follower screws) |
| | P | Polypropylene (with 316L Stainless Steel followers & follower screws) |
| | R | 316L Stainless Steel ANSI flange class 150 x 600 |
| | S | 316L Stainless Steel |
| | T | Hastelloy CW12MW |
| 7 | | Diaphragm & O-ring Material |
| | A | Aflas diaphragm / PTFE o-ring |
| | E | EPDM (requires EPDM-compatible oil – Digit 12 oil code C) |
| | G | FKM |
| | J | PTFE (available with E and S cams only; 1050 rpm max.) |
| | P | Neoprene |
| | T | Buna-N |
| 8 | | Valve Seat Material |
| | C | Ceramic |
| | D | Tungsten Carbide |
| | H | 17-4 Stainless Steel |
| | N | Nitronic 50 |
| | T | Hastelloy C |

| Digit | Order Code | Description |
|-------|------------|--|
| 9 | | Valve Material |
| | C | Ceramic |
| | D | Tungsten Carbide |
| | F | 17-4 Stainless Steel |
| | N | Nitronic 50 |
| | T | Hastelloy C |
| 10 | | Valve Springs |
| | E | Elgiloy |
| | H | 17-7 Stainless Steel |
| | T | Hastelloy C |
| 11 | | Valve Spring Retainers |
| | C | Celcon |
| | H | 17-7 Stainless Steel (used with metallic heads only) |
| | M | PVDF |
| | P | Polypropylene |
| | T | Hastelloy C (used with metallic heads only) |
| | Y | Nylon (Zytel) |
| 12 | | Hydra-Oil |
| | A | 10W30 standard-duty oil |
| | B | 40-wt for continuous-duty oil (use with 316L SST or Hastelloy CW12MW pump head - standard) |
| | C | EPDM-compatible oil |
| | E | Food-contact oil |
| | G | 5W30 cold-temp severe-duty synthetic oil |
| | H | 15W50 high-temp severe-duty synthetic oil |

H25 Pump Housing is standard as Cast Aluminum.

Upgrade to Ductile Iron available.

QUICK & DISCOUNTED PRICING
CLICK HERE
OR CALL (908) 362-9981

D10 Pro Series | Options

Consult the Hydra-Cell Master Catalog for:

- Motors, bases, couplings and other pump accessories
- Hydra-Oil selection and specification information
- Design considerations, installation guidelines, and other technical assistance in pump selection

QUICK & DISCOUNTED PRICING

CLICK HERE

OR CALL (908) 362-9981

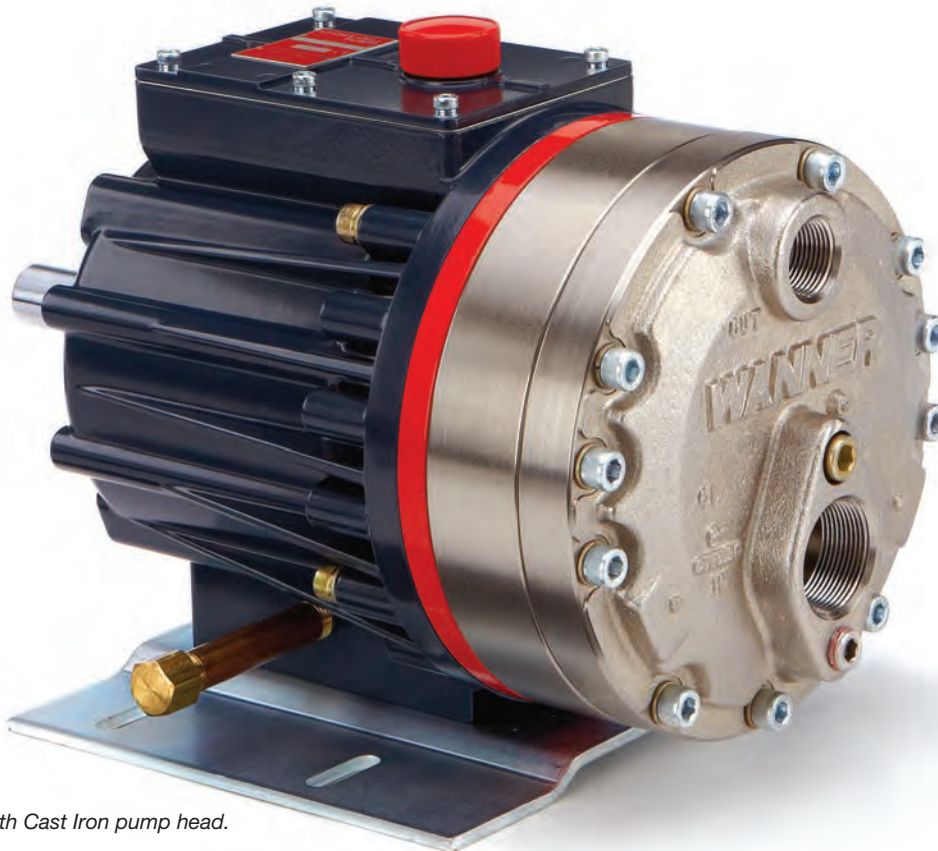

H25 Pro with Cast Iron pump head.

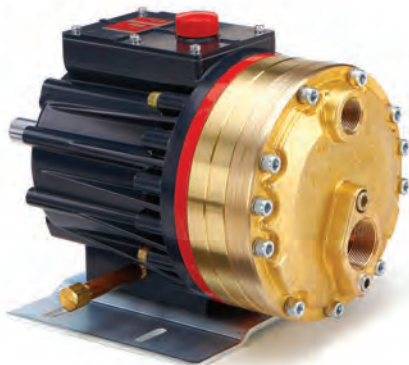

H25 Pro with Brass pump head.

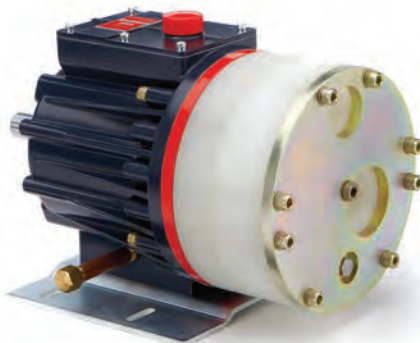

H25 Pro with Polypropylene pump head.

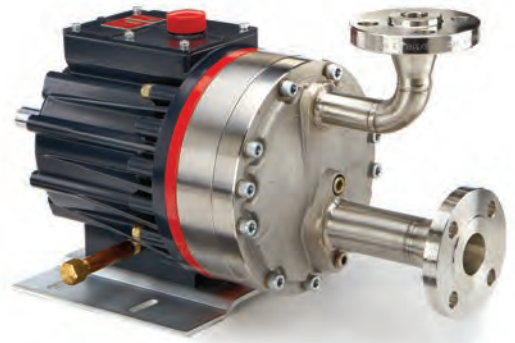

H25 Pro with 316L Stainless Steel pump head and ANSI flanges.