

MODEL:

# PDUMV20HVNET

## Switched Rackmount PDU



High Voltage  
Input/Output



24 Outlets



C13



20A Max  
Capacity



Load Meter

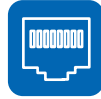

Network  
Interface



0U Rackmount



Toolless  
Mounting  
Buttons



AC Inlet  
Supports  
International  
Plugs



- A** Digital Load Meter
- B** C13 and C19 Outlets with On/Off LEDs
- C** C20 Inlet
- D** Removable Cord Retention Brackets
- E** Removable Mounting Brackets
- F** Toolless Mounting Buttons
- G** 10 ft. Detachable Input Power Cord
- H** L6-20P Twist-Lock Input Plug
- I** Durable Metal Case
- J** Network Interface
- K** RJ45 Ethernet Jack
- L** Manual Configuration Port
- M** Environmental Monitoring Port
- N** Network Interface Reset Button

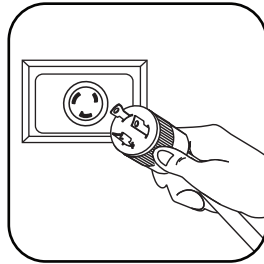

AC Input Connection: Insert L6-20P twist-lock plug into compatible L6-20R utility, generator or UPS outlet. For international applications, connect a user-supplied power cord with a country-specific plug to the C20 power inlet.

Also Includes: Cable Ties,  
Owner's Manual

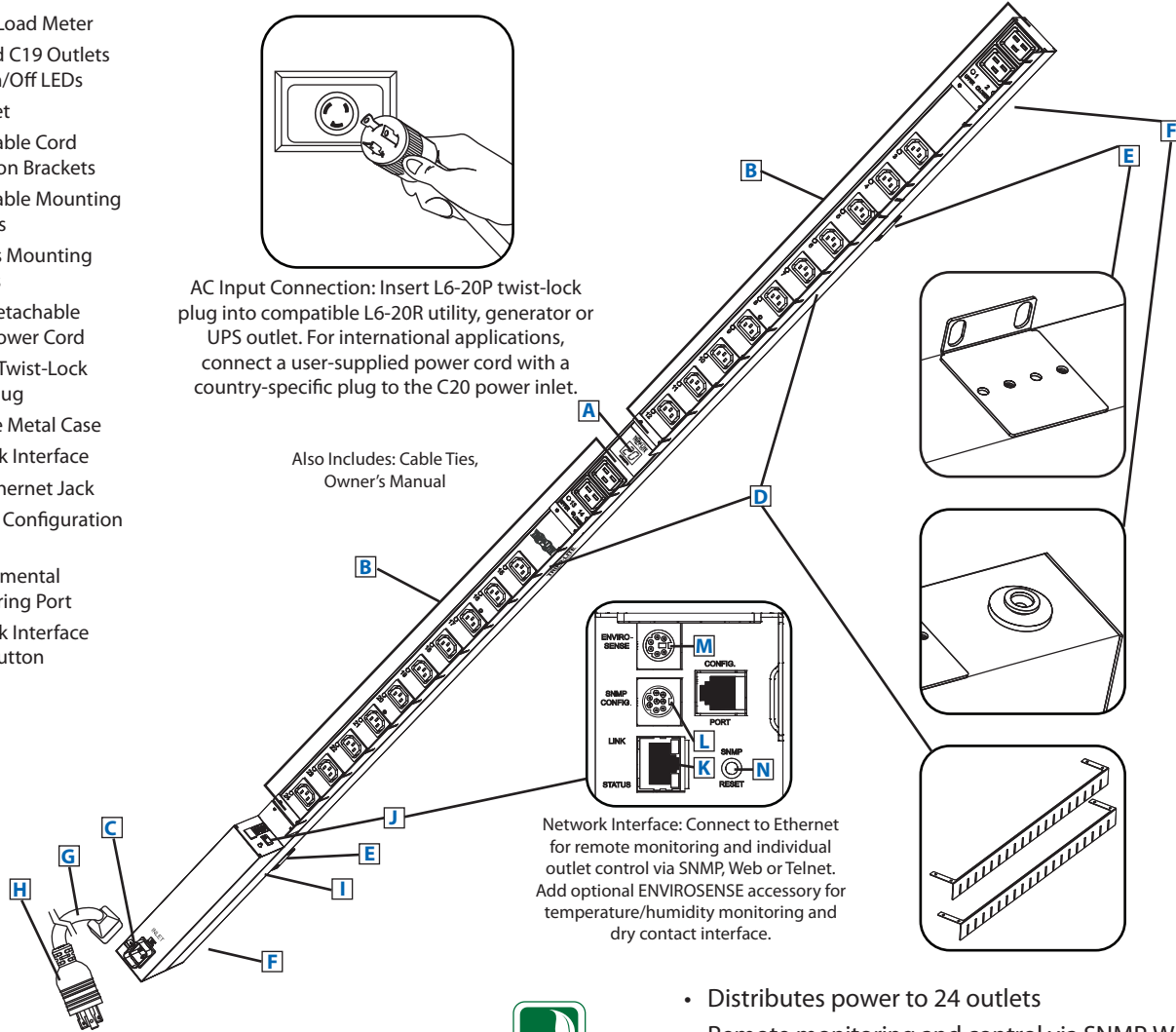

Network Interface: Connect to Ethernet for remote monitoring and individual outlet control via SNMP, Web or Telnet. Add optional ENVIROSENSE accessory for temperature/humidity monitoring and dry contact interface.

### Specifications

Model	PDUMV20HVNET
Voltage	200-250V
Frequency	50/60 Hz
Maximum Capacity	20A
Agency-Derated Capacity	16A
Input Connector	L6-20P (C20 inlet)
Cord Length	10 ft.
Outlets	24 (20 C13 / 4 C19)
Primary Mounting Option	0U (Vertical) Rackmount
Unit Weight & Dimensions	8.5 lb / 4.75 x 64 x 2.25 in. <i>See next page for detailed unit measurements.</i>
Certifications	Tested to UL 60950-1 (US & Canada), CE, NOM (Mexico), FCC & CE Class A (Emissions)

Tripp Lite has a policy of continuous improvement. Specifications are subject to change without notice.



- Distributes power to 24 outlets
- Remote monitoring and control via SNMP, Web or Telnet
- Displays total load in real time
- Perfect for rackmount server, network and telecom applications

**SEE NEXT PAGE FOR DETAILED UNIT MEASUREMENTS**



1111 W. 35th Street  
Chicago, IL 60609 USA  
773.869.1234  
www.tripplite.com

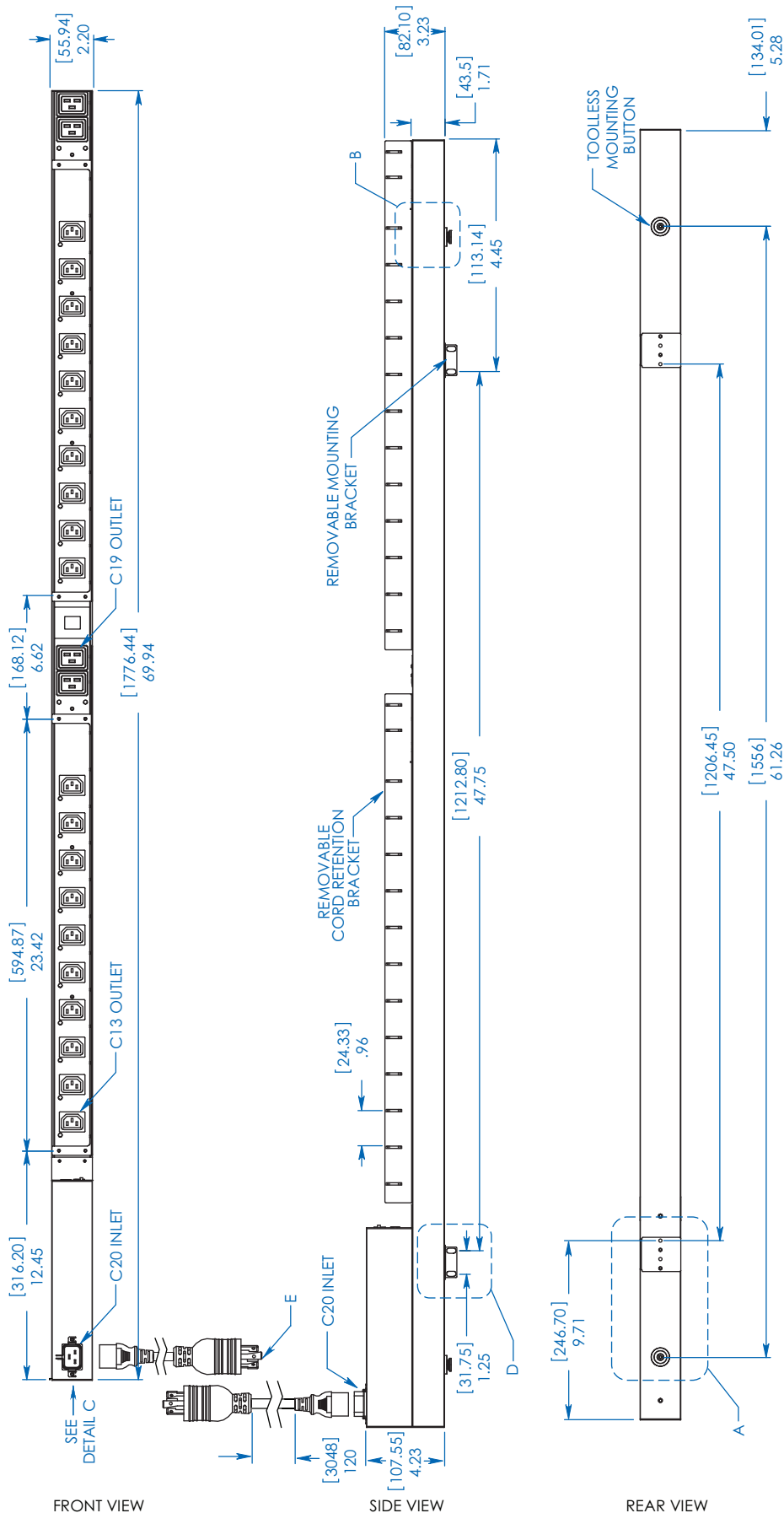

Dimensions: [mm] INCHES

Tripp Lite has a policy of continuous improvement. Specifications are subject to change without notice.

MODEL:  
**PDUMV20HVNET**



1111 W. 35th Street  
Chicago, IL 60609 USA  
773.869.1234

[www.triplite.com](http://www.triplite.com)