

MX2 LED 2" Continuous – Suspended

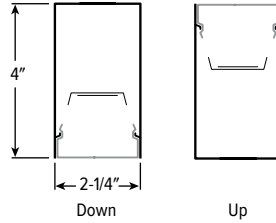

CATALOG #: _____

TYPE: _____

PROJECT: _____



FEATURES

- Create elegant spaces with a seamless, continuous row of illumination
- Specify in one inch increments to create a perfect fit
- Flat, glowing edge, drop and regressed lenses give designers a variety of looks
- Moveable mounting hardware easily slides along the length of the fixture providing variable mounting points for continuous rows
- High-performance up to 125 lm/W
- Linear extrusion contains snap-in light rails for ease of installation and maintenance
- Factory installed row alignment system creates straight rows with ease
- Versatile MX2 system includes recessed, surface, suspended and in-wall mounting, see hew.com
- Corner configurations available, see Product Builder at hew.com/product-builder
- Wireless in-fixture control solutions available
- Available with BIOS® SkyBlue® technology to support proper daytime circadian stimulus
- Made Right Here® in the USA

SPECIFICATIONS

- HOUSING – Extruded aluminum with die-cast end plates.
- SHIELDING – Extruded, flat, diffuse acrylic lens.
- FINISH – Textured matte white polyester TGIC powder coat bonded to phosphate-free, multi-stage pretreated metal. All parts painted after fabrication to facilitate installation, increase efficiency, and inhibit corrosion.
- ELECTRICAL – High-quality mid-power LED boards. Reported L70: >54,000 hours. Reported L90: 52,000 hours. Estimated L70: 170,000 hours. 25°C maximum ambient operating temperature.
- MOUNTING – Suspended. 1/16" diameter adjustable steel leveling aircraft cable and mounting hardware necessary for grid and hardpan ceiling applications provided.
- LISTINGS –
 - cCSAus certified as luminaire suitable for dry or damp locations.
 - Complies with the Buy American Act and other federal regulations. Request certification at hew.com/baa.
- WARRANTY – 5-year limited warranty, see hew.com/warranty.

ORDERING EXAMPLE: MX2D - 12'00 - L8/835 - F - AC/D48 - OPTIONS - CONTROL/DIM - UNV

SERIES
MX2D Down
MX2U Up
ILLUMINATED LENGTH
 Lengths specified in feet and inches using 1" increments, 2' minimum.
 Example: 12'00 = 12'-0"

Product Builder
 Easily build shapes & simplify ordering with the Williams Linear Product Builder at hew.com/product-builder ^[1]



LUMENS ^[2]	CRI	CCT	SHIELDING	MOUNTING (EXAMPLE: AC/D48) ^[3]
L4 400lm	8 80	27 2700K	F Flat, diffuse acrylic	Prefix Type Length
L8 800lm	9 90 ^[4]	30 3000K	FW Flat, diffuse acrylic with widespread optic	AC/ D 1" grid & hardpan 24 24"
L12 1200lm		35 3500K	FA Flat, diffuse acrylic with asymmetric optic ^[5]	N 9/16" grid 48 48"
		40 4000K	G Diffuse acrylic with glowing edge ^[6]	S Slot grid 96 96"
		50 5000K	D Diffuse acrylic with 1" drop ^[7]	MSF_ Microstem, 1/4" IPS, specify length in inches ^[9]
			R Regressed diffuse acrylic, 1" ^[8]	

OPTIONS

See page 4 for FINISH OPTIONS.

EM/10WLP Low-profile 10-watt emergency battery ^[11]
EM/10WRM Remote mount 10-watt emergency battery ^[12]
(L_) Additional lower lumen packages available ^[13]
 Example: 600 lumens = MX2D-12'00-L8/835-(L6)

CONTROL ^[10]

See page 6 for ADDITIONAL CONTROL OPTIONS.

– None
AVI-LVFA Avi-on wireless fixture control ^[14]
AVI-LVFA-CS2-PIR Avi-on wireless fixture control with PIR motion and daylight sensor ^[15]
AWN R Lutron Athena wireless node integral fixture control, RF only ^[16]
AWN S Lutron Athena wireless node integral fixture control, RF with daylight and occupancy sensing ^[17]

DRIVER

See page 7 for ADDITIONAL DRIVER OPTIONS.

DIM Driver with external dimming wires
DA Driver with 12V auxiliary power, without external dimming wires ^[18]
DSR Sensor-ready driver without external dimming wires (D4i DALI-2) ^[19]

VOLTAGE

120 120V
277 277V
UNV 120-277V
347 347V ^[20]

NOTES

- See page 4 for CORNER DETAILS.
- Lumens per foot output based on F Shielding, 80 CRI/3500K CCT. Actual performance may vary ± 5%. See page 2 for FIXTURE PERFORMANCE DATA. Additional lumen packages available, see Options.
- See page 3 for MOUNTING DETAILS.
- Extended lead times may apply. Consult factory for availability.
- MX2U only.
- Not available with corner configurations.
- MX2D only. Not available with corner configurations.
- Not available with corner configurations. Increases fixture height. See page 3 for SHIELDING DETAILS.
- Power cord does not run through microstem.
- Sensor recommended for use in downlight orientation only. Reduces portion of lit fixture, consult factory. See page 5 for AVI-ON BLUETOOTH WIRELESS CONTROL DETAILS. See page 4 for SENSOR & NODE PLACEMENT DETAILS.
- Not available with fixtures less than 4'.
- See page 3 for MOUNTING DETAILS.
- (L4) lumen package minimum. Specify in increments of 100 nominal lumens. Option must be specified with next higher lumen package.
- DA Driver only.
- DA Driver only.
- DA and DSR Drivers only.
- DA and DSR Drivers only.
- Avi-on and Lutron Athena Controls only.
- Lutron Vive and Athena Controls only.
- Not available with EM batteries, control sensors, DA, or DSR Drivers.



MX2 LED 2" Continuous – Suspended

FIXTURE PERFORMANCE DATA

	DOWN (PER FOOT)			UP (PER FOOT)		
	DELIVERED LUMENS	WATTAGE	EFFICACY (lm/W)	DELIVERED LUMENS	WATTAGE	EFFICACY (lm/W)
L4	375.8	3.4	111	416.9	3.4	123
L8	751.5	6.7	112	833.8	6.7	124
L12	1127.3	10.1	112	1250.8	10.1	124

- Photometrics tested in accordance with IESNA LM-79. Results based on F shielding, 80 CRI/3500K CCT, average wattage for 120V through 277V input, and 25°C ambient temperature. Actual performance may vary +/-5%.
- To calculate lumen output in emergency mode, multiply the battery wattage by the efficacy.
- Use multiplier table to calculate additional options.

MULTIPLIER TABLES

	COLOR TEMPERATURE	
	CCT	CONVERSION FACTOR
80 CRI	2700K	0.97
	3000K	0.99
	3500K	1.00
	4000K	1.03
	5000K	1.06
90 CRI	2700K	0.80
	3000K	0.82
	3500K	0.83
	4000K	0.86
	5000K	0.89

SHIELDING	
LENS	CONVERSION FACTOR
D	1.05
F	1.00
G	0.98
FA	0.96
FW	0.92
R	0.91

PHOTOMETRY

MX2D-4'00-L8/835-F-DIM Total Luminaire Output: 3006 lumens; 27 Watts | Efficacy: 111 lm/W | 80 CRI; 3500K CCT

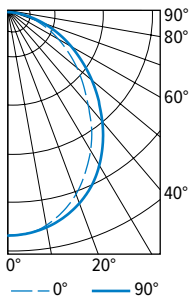

VERTICAL ANGLE	HORIZONTAL ANGLE			ZONAL LUMENS
	0°	45°	90°	
0	1329	1329	1329	
5	1319	1319	1318	125
15	1258	1246	1225	351
25	1134	1095	1050	405
35	945	888	836	557
45	730	668	613	519
55	523	475	430	428
65	338	304	276	304
75	171	157	145	168
85	42	45	46	50
90	1	4	5	

LUMEN SUMMARY	ZONE	LUMENS	% FIXTURE
	0 - 30	981	33
	0 - 40	1537	51
	0 - 60	2484	83
	0 - 90	3006	100
	0 - 180	3006	100

MX2U-4'00-L8/835-F-DIM Total Luminaire Output: 3335 lumens; 27 Watts | Efficacy: 124 lm/W | 80 CRI; 3500K CCT

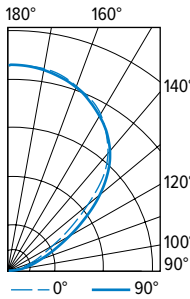

VERTICAL ANGLE	HORIZONTAL ANGLE			ZONAL LUMENS
	0°	45°	90°	
90	6	7	7	
95	49	29	25	38
105	152	117	103	132
115	310	265	225	268
125	580	552	460	478
135	884	873	832	663
145	1096	1099	1088	683
155	1229	1234	1246	570
165	1318	1320	1331	373
175	1358	1350	1359	129
180	1356	1356	1356	

LUMEN SUMMARY	ZONE	LUMENS	% FIXTURE
	90 - 120	438	13
	90 - 130	916	28
	90 - 150	2263	68
	90 - 180	3335	100
	0 - 180	3335	100

MX2D-4'00-L12/835-FW-DIM Total Luminaire Output: 4148 lumens; 40.4 Watts | Efficacy: 103 lm/W | 80 CRI; 3500K CCT

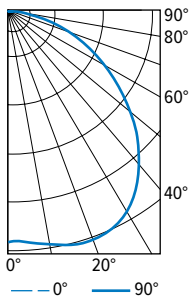

VERTICAL ANGLE	HORIZONTAL ANGLE			ZONAL LUMENS
	0°	45°	90°	
0	1372	1372	1372	
5	1386	1371	1375	131
15	1315	1372	1432	389
25	1184	1333	1428	608
35	1010	1224	1308	744
45	813	1036	1076	762
55	618	792	799	671
65	418	543	532	501
75	214	275	266	272
85	42	56	56	64
90	1	2	3	

LUMEN SUMMARY	ZONE	LUMENS	% FIXTURE
	0 - 30	1129	27
	0 - 40	1873	45
	0 - 60	3306	80
	0 - 90	4143	100
	0 - 180	4148	100

PHOTOMETRY CONTINUED ON NEXT PAGE



MX2 LED 2" Continuous – Suspended

MX2U-4'00-L8/835-FA-DIM Total Luminaire Output: 3082 lumens; 24 Watts | Efficacy: 128 lm/W | 80 CRI; 3500K CCT

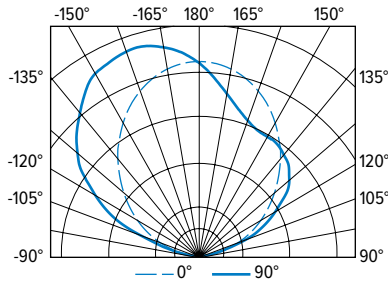

CANDLEPOWER DISTRIBUTION	VERTICAL ANGLE	HORIZONTAL ANGLE					ZONAL LUMENS
		0°	45°	90°	135°	180°	
	90	2	3	1	3	2	
	95	33	27	19	27	33	35
	105	161	188	154	188	161	130
	115	309	372	381	372	309	222
	125	455	536	563	536	455	276
	135	604	641	683	641	604	284
	145	753	699	735	699	753	256
	155	888	745	748	745	888	197
	165	988	851	819	851	988	119
	175	1044	983	962	983	1044	25
	180	1044	1044	1044	1044	1044	

LUMEN SUMMARY	ZONE	LUMENS	% FIXTURE
	0 - 40	0	0
	0 - 60	0	0
	0 - 90	0	0
	90 - 180	3082	100

SHIELDING DETAILS

DOWN

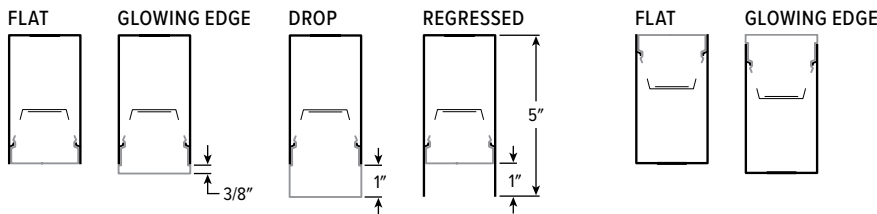

MOUNTING DETAILS

Stand-alone fixtures up to 12' in length will require two suspension cables.

MX2D BACK VIEW

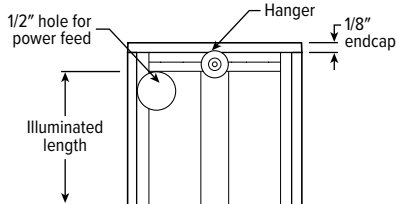

MX2U BACK VIEW

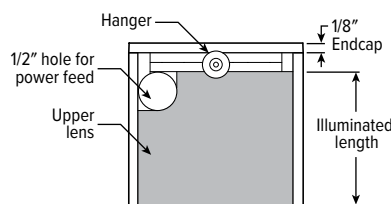

AIRCRAFT CABLE

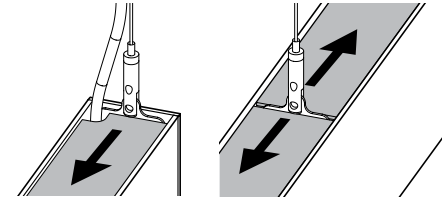

Field-adjustable standalone hanger.

Joiner hanger slides to any position along extrusion. Lens may be cut to fit hanger.

STANDARD HARDWARE FOR SUSPENDED PRODUCT (Grid and Hardpan)

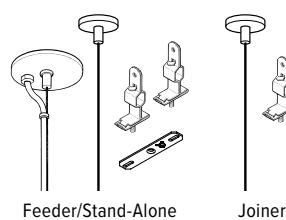

Notes:

- Fixtures are provided with adjustable length aircraft cables and mounting hardware, must specify.
- Electrical supply is brought into the feeder fixture, either as part of a row or as a stand-alone unit. Joiner fixtures complete the row.
- The feeder kits are standard with a 5" canopy to cover the junction box and a 2" canopy at the non-feed point. No J-box is required at non-feed points.

AIRCRAFT CABLE



MICROSTEM



ROW ALIGNMENT SYSTEM

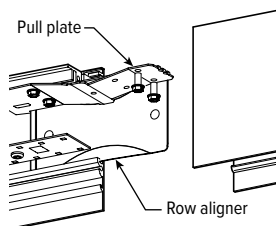

Installer friendly row aligners ensure seamless joining between fixtures while factory installed pull plate locks extrusions in place without disassembly of fixture internals.

REMOTE MOUNT BATTERY

Max remote distance 50'.

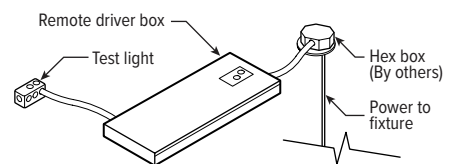

MX2 LED 2" Continuous – Suspended

CORNER DETAILS

BACK VIEW

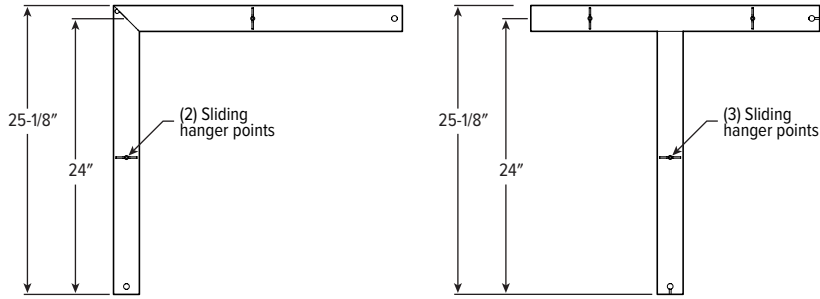

Note: Corner orientation determined in field.
Feeder corner end cap shipped separately.

FINISH OPTIONS

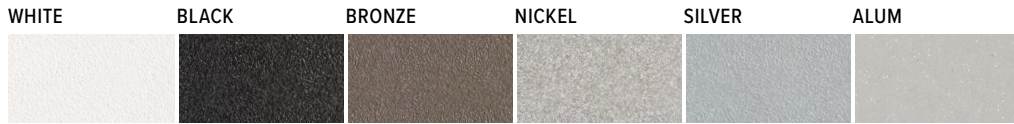

For custom color, please specify RAL code or a manufacturer code with description. All custom colors other than RAL require two sample swatches, minimum 1" square.

SENSOR & NODE PLACEMENT DETAILS

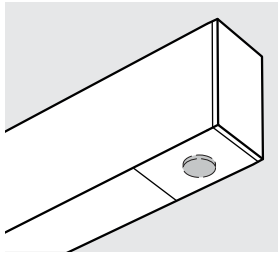

SEE NEXT PAGE FOR CONTROL DETAILS

MX2 LED 2" Continuous – Suspended

AVI-ON BLUETOOTH WIRELESS CONTROL DETAILS

FEATURES

Simple

- Gateway-free distributed control
- Factory pre-commissioning
- Contractor friendly installation
- Occupancy/vacancy/daylight sensing

Scalable

- Virtually unlimited network size
- Spans small offices to large warehouses
- Flexible control strategies

Secure

- Optional cloud connectivity
- UL IoT platinum security rating
- DLC 5.0 compliant

COMMISSIONING & INSTALLATION TOOLS

Avi-on mobile apps provide intuitive, quick installation and commissioning. Pro tools are available to qualified installers. Live commissioning training and on-site or remote support by Avi-on must be ordered separately through Avi-on.



Commissioning Mobile App



Zone Scanner Web App



Commissioning Pro App

SYSTEM COMPONENTS

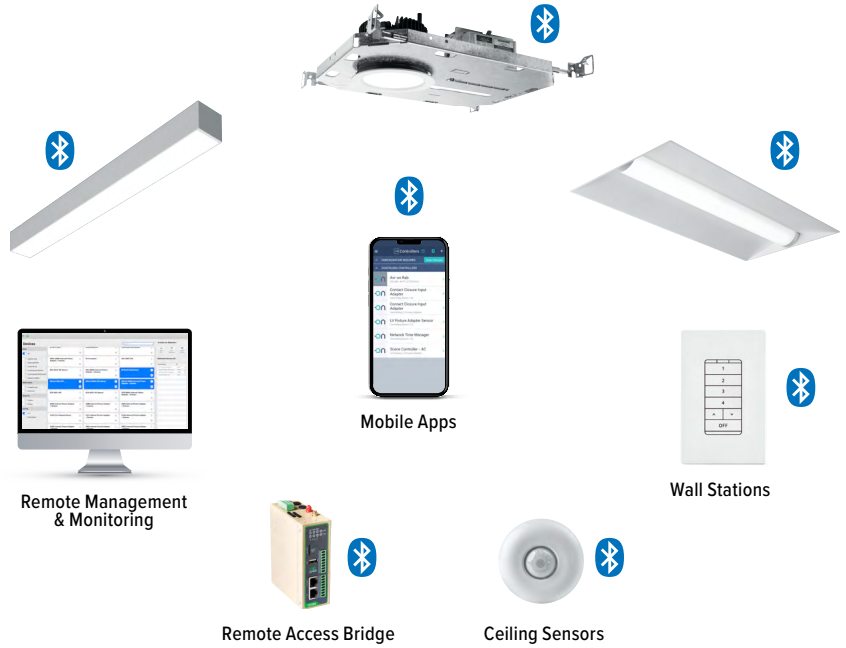

The Bluetooth® word mark and logos are registered trademarks owned by Bluetooth SIG, Inc. and any use of such marks by Avi-on is under license. Other trademarks and trade names are those of their respective owners.

ACCESSORIES

WALL STATIONS

AVI-2401AC	Scene controller - numbered 1-4, 120-277VAC
AVI-2402BAT	Scene controller - numbered 1-4, battery powered
AVI-2401AC-2	Dimmer with presets - percentages, 120-277VAC
AVI-2402BAT-2	Dimmer with presets - percentages, battery powered
AVI-2401AC-3	On/off/dimming, 120-277VAC
AVI-2402BAT-3	On/off/dimming, battery powered

NETWORK

AVI-RAB-LTE	Remote access bridge
AVI-KIT-NTM	Network time manager with battery backup

CEILING MOUNT SENSORS

AVI-KIT-SEN-DUCM	PIR motion and ultrasonic sensor kit
AVI-KIT-SEN-ICM	PIR motion and photocell sensor kit

For load controllers and additional accessory info, see hew.com/avi-on

AVI-LVFA-CS2-PIR Avi-on wireless fixture control with PIR motion and daylight sensor. DA Driver only.

SPECIFICATIONS

TYPE	PIR Motion + Daylight
MOUNTING HEIGHT	8' – 10'
DETECTION ANGLE	360°
TEMPERATURE RANGE	-30° to 50°C
RELATIVE HUMIDITY	10 to 80% non-condensing
IP RATING	IP20
MANUFACTURER	Avi-On



SENSOR COVERAGE PATTERNS

Side View

8' height: ø24' coverage

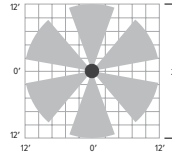
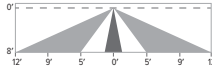

SENSOR DETAIL



Dimensions: 13/16" x 2-1/4"



MX2 LED 2" Continuous – Suspended

ADDITIONAL CONTROL OPTIONS

AWNS Lutron Athena wireless node integral fixture control, RF with daylight and occupancy sensing. DA and DSR Drivers only.

SPECIFICATIONS	
TYPE	Radio Frequency
MOUNTING HEIGHT	8' – 12'
DETECTION ANGLE	360°
TEMPERATURE RANGE	0° to 55°C
RELATIVE HUMIDITY	0 to 90%, non-condensing
COMMISSIONING	Clear Connect gateway – Type X with app (iOS or Android)
MANUFACTURER	Lutron

SENSOR COVERAGE PATTERNS

9' height: ø12' coverage

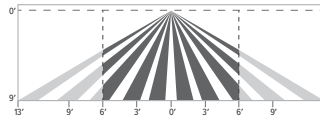

Motion Sensor Coverage

CEILING HEIGHT	COVERAGE AREA (SQ FT)
8'	114
9'	144
10'	178
12'	256

SENSOR DETAIL

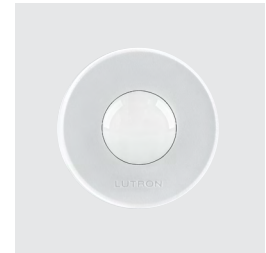

Dimensions: ø1-1/8"

ATHENA CONTROL OPTIONS

CATALOG NUMBER	DESCRIPTION
AWNDR	Lutron Athena wireless node integral fixture control, RF only, for use with D4i DALI-2 or driver with 12V auxiliary power
AWNS	Lutron Athena wireless node integral fixture control, RF with daylight and occupancy sensing, for use with D4i DALI-2 or driver with 12V auxiliary power
AWNDR-BL	Lutron Athena wireless node integral fixture control, RF only, for use with D4i DALI-2 or driver with 12V auxiliary power, black finish
AWNS-BL	Lutron Athena wireless node integral fixture control, RF with daylight and occupancy sensing, for use with D4i DALI-2 or driver with 12V auxiliary power, black finish

VDO Lutron Vive integral fixture control, RF with daylight and occupancy sensor (DFCSJ-OEM-OCC). DSR or LDE Drivers only. LDE drivers require driver interface

SPECIFICATIONS	
TYPE	PIR Motion + Daylight
MOUNTING HEIGHT	8' – 12'
DETECTION ANGLE	360°
TEMPERATURE RANGE	0° to 55°C
RELATIVE HUMIDITY	0 to 90%, non-condensing
COMMISSIONING	App (iOS or Android)
MANUFACTURER	Lutron

SENSOR COVERAGE PATTERNS

9' height: ø12' coverage

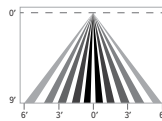

Motion Sensor Coverage

CEILING HEIGHT	COVERAGE AREA (SQ FT)
8'	114
9'	144
10'	178
12'	256

SENSOR DETAIL



Dimensions: 2-11/16" x 1"

VIVE CONTROL OPTIONS

CATALOG NUMBER	DESCRIPTION
VRF	Lutron Vive integral fixture control, RF only (DFCSJ-OEM-RF), for use with sensor-ready driver
VDO	Lutron Vive integral fixture control, RF with daylight and occupancy sensor (DFCSJ-OEM-OCC), for use with sensor-ready driver
VRF/DBI	Lutron Vive integral fixture control, RF only (DFCSJ-OEM-RF) and digital link interface, for use with Lutron Hi-lume 1% EcoSystem dimming LED driver
VDO/DBI	Lutron Vive integral fixture control, RF with daylight and occupancy sensor (DFCSJ-OEM-OCC) and digital link interface, for use with Lutron Hi-lume 1% EcoSystem dimming LED driver

OCCWS-FS-305-L6-PP-120/277 Wattstopper PIR motion and daylight hold off sensor with power pack, 120/277V

SPECIFICATIONS	
TYPE	PIR Motion + Daylight Hold Off
MOUNTING HEIGHT	8'
LENS	Indoor, non-wet location use
DETECTION ANGLE	360°
TEMPERATURE RANGE	-40° to 55°C
RELATIVE HUMIDITY	5% to 95%, non-condensing
COMMISSIONING	Dials under lens

SENSOR COVERAGE PATTERNS

8' height: ø20' coverage

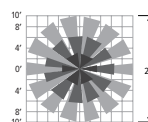
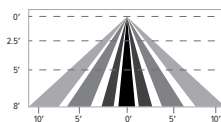

SENSOR DETAIL

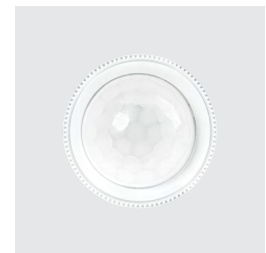

Dimensions: ø1-5/16"



MX2 LED 2" Continuous – Suspended

OCCWS-LMFS-601-PP-120/277 Wattstopper PIR motion and daylight sensor with power pack, 120/277V

SPECIFICATIONS	
TYPE	PIR Motion + Daylight
MOUNTING HEIGHT	8' – 12'
LENS	Up to 300 sq/ft coverage
DETECTION ANGLE	360°
TEMPERATURE RANGE	0° to 50°C
RELATIVE HUMIDITY	0 to 90%, non-condensing
COMMISSIONING	App (iOS or Android)

SENSOR COVERAGE PATTERNS

8' height: ø20' coverage

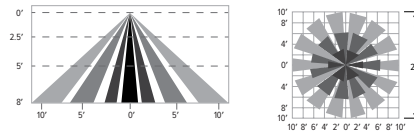

SENSOR DETAIL



Dimensions: ø1-5/16"

ADDITIONAL DRIVER OPTIONS

Note: Lumen restrictions apply, consult product builder at hew.com/product-builder.

CATALOG NUMBER	DESCRIPTION
DIM	Dimming driver prewired for 0-10V low voltage applications
DIM1	1% dimming driver prewired for 0-10V low voltage applications
DIM LINE	Line voltage dimming driver (TRIAC and ELV compatible, 120V only)
DIM TRC	Line voltage dimming driver (TRIAC compatible, 120V only)
DA	Driver with 12V auxiliary power
DSR	Sensor-ready driver (D4i DALI-2)
SD40	40% step-dimming driver
SD50	50% step-dimming driver
DALI	DALI dimming driver
LDE1	Lutron Hi-lume 1% EcoSystem dimming driver

