



Philips Brilliance
LCD monitor with
Webcam, MultiView

Quad HD
27" (68.6 cm)
2560 x 1440 display

Brilliance

272P4QPJKEB



Crystal clear images, maximum productivity

with MultiView

This professional Philips display delivers Crystalclear Quad HD 2560x1440 images. MultiView enhances productivity with active dual connect and view. Webcam enables collaboration saving time and money

Brilliant performance

- IPS technology for full colours and wide viewing angles
- CrystalClear images with Quad HD 2560x1440 pixels
- MultiView enables active dual connect and view at the same time
- Webcam with mic to connect and collaborate
- SmartConnect with HDMI, Display port and Dual link DVI
- Display Port for daisy chain multi-display usage
- USB 3.0 enables fast data transfers and smart phone charging
- Built-in stereo speakers for multimedia

Sustainable Eco-design

- PowerSensor saves up to 80% energy costs
- 65% post-consumer recycled plastics with TCO Edge

Designed for people

- SmartErgoBase enables user-friendly ergonomic adjustments
- Low bezel-to-table height for maximum reading comfort

PHILIPS

LCD monitor with Webcam, MultiView
Quad HD 27" (68.6 cm), 2560 x 1440 display

272P4QPJKEB/00

Highlights

IPS technology

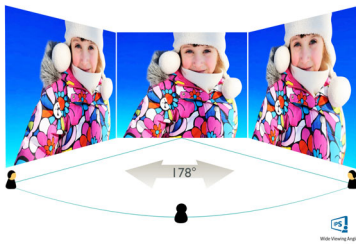

IPS displays use advanced technology that gives you extra-wide viewing angles of 178/178 degrees, making it possible to view the display from almost any angle — even in 90-degree Pivot mode! Unlike standard TN panels, IPS displays gives you remarkably crisp images with vivid colours, making it ideal not only for Photos, films and web browsing, but also for professional applications that demand colour accuracy and consistent brightness at all times.

CrystalClear images

These latest Philips screens deliver CrystalClear, Quad HD 2560x1440 or 2560x1080 pixel images. Utilising high-performance panels with a high-density pixel count, enabled by high-bandwidth sources like DisplayPort, HDMI, Dual link DVI, these new displays will make your images and graphics come alive. Whether you are a demanding professional requiring extremely detailed information for CAD-CAM solutions, using 3D graphic applications or a financial wizard working on huge spreadsheets, Philips displays will give you CrystalClear images.

PowerSensor

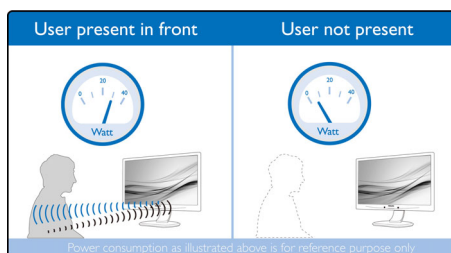

PowerSensor is a built-in 'people sensor' that transmits and receives harmless infrared signals to determine if the user is present and then automatically reduces monitor brightness

when then user steps away from the desk, cutting energy costs by up to 80 percent and prolonging monitor life

Webcam

Embedded webcam and microphone enables you to view and communicate with your colleagues and clients. This simple solution allows you to collaborate and share, saving precious time and travel-related costs.

MultiView technology

With the ultra-high resolution Philips MultiView display you can now experience a world of connectivity in comfort whether at the office or at home. MultiView enables active dual connect and view so that you can work with multiple devices like a PC and Notebook side-by-side simultaneously, making complex multi-tasking work a breeze. Watching live football feeds from your set-top box on the right-hand side, while browsing the Internet from your notebook on the left is now easy. You may want to keep an eye on the live news feed with audio in the small window, while working on your latest blog.

Display Port with Daisy Chain

This Philips display employs Display port 1.2a Multi Stream Transport (MST) technology with HBR2, which doubles the data throughput to 21.6 Gbps. This enables it to daisy chain multiple monitors, thereby dramatically increasing your efficiency. This daisy chain, multi-monitor capability makes this Philips display especially suitable for use in Finance, Banking, control rooms and other similar environments. To make use of this feature, your PC Graphics Card must be certified to DP1.2 with the MST option. For detailed information, please visit <http://www.displayport.org/>

SmartConnect

With a plethora of connectivity, these Philips displays come equipped with multi connections like Dual link DVI, Display Port and universal HDMI connector, enabling you to enjoy high-resolution uncompressed video and audio

content. The USB 3.0 option ensures that you can have super-speed data transfers while having global connectivity. Regardless of what source you use, you can rest assured that this Philips display will ensure your investment is not made obsolete any time soon!

SmartErgoBase



The SmartErgoBase is a monitor base that delivers ergonomic display comfort and provides cable management. The user-friendly height, swivel, tilt and rotation angle adjustments of the base allow the monitor to be positioned for maximum comfort to help ease the physical strains of a long workday. In addition, cable management reduces cable clutter and keeps the workspace neat and professional.

USB 3.0 super speed

Super-Speed USB 3.0 deploys a 5.0 gbit/s transfer rate, which is about 10 times faster than the USB 2.0 standard, significantly reducing data transfer time and saving you time and money. With more bandwidth, super-speed transfer rates, better power management and superior overall performance, USB 3.0 sets the latest global standard allowing you to use large-capacity storage devices. Sync-N-Go technology ensures you don't have to wait for bandwidth to be freed up any more. Your investment in USB 2.0 devices is protected as it is backwards-compatible.

Built-in stereo speakers

A pair of high-quality stereo speakers built into a display device. They may be visible front firing, or invisible down firing, top firing, rear firing etc. depending on model and design.



Specifications

Picture/Display

- LCD panel type: IPS technology
- Backlight type: W-LED system
- Panel Size: 27 inch/68.6 cm
- Effective viewing area: 596.74 (H) x 335.66 (V)
- Aspect ratio: 16:9
- Optimum resolution: 2560 x 1440 @ 60Hz
- Brightness: 300 cd/m²
- Response time (typical): 6 ms (Grey to Grey)*
- Contrast ratio (typical): 1000:1
- SmartContrast: 20,000,000:1
- Pixel pitch: 0.233 x 0.233 mm
- Viewing angle: 178° (H)/178° (V), @ C/R > 10
- Picture enhancement: SmartImage
- Display colours: 16.7 M (True 8 bit)
- Scanning Frequency: 30 - 90 kHz (H) / 56 - 75 Hz (V)
- sRGB

Connectivity

- USB: USB 3.0 x 3
- Signal Input: DVI-Dual Link (digital, HDCP), DisplayPort, HDMI x 2
- Sync Input: Separate Sync, Sync on Green
- Audio (In/Out): PC audio-in, Headphone out

Convenience

- Built-in Speakers: 2 W x 2
- Built-in webcam: 2.0 megapixel camera with microphone and LED indicator
- MultiView: PIP/PBP mode, 2 x devices
- User convenience: SmartImage, Menu, Multi-view, Power On/Off, User
- Control software: SmartControl Premium
- OSD Languages: Brazil Portuguese, Czech, Dutch, English, Finnish, French, German, Greek, Hungarian, Italian, Japanese, Polish, Portuguese, Russian, Simplified Chinese, Spanish, Swedish, Traditional Chinese, Turkish, Ukrainian
- Other convenience: Kensington lock, VESA mount (100 x 100 mm)
- Plug and Play Compatibility: DDC/CI, Mac OS X, sRGB, Windows 8/7/XP

Stand

- Height adjustment: 150 mm
- Pivot: 90 degree
- Swivel: -65/65 degree
- Tilt: -5/20 degree

Power

- ECO mode: 23 W (typ.)
- On mode: 49.8 W (typ.)
- Standby mode: 0.3 W (typ.)
- Off mode: Zero watts with Zero switch
- Power LED indicator: Operation - White, Standby mode - White (flashing)
- Power supply: 100-240 VAC, 50-60 Hz, Built-in

Dimensions

- Product with stand (max height): 639 x 580 x 242 mm
- Product without stand (mm): 639 x 405 x 64 mm
- Packaging in mm (W x H x D): 750 x 234 x 490 mm

Weight

- Product with stand (kg): 8.5 kg
- Product without stand (kg): 5.7 kg
- Product with packaging (kg): 11.35 kg

Operating conditions

- Temperature range (operation): 0°C to 40°C °C
- Temperature range (storage): -20°C to 60°C °C
- Relative humidity: 20–80% %
- Altitude: Operation: +12,000 ft (3658 m), Non-operation: +40,000 ft (12,192 m)
- MTBF: 30,000 hour(s)

Sustainability

- Environmental and energy: PowerSensor, EnergyStar 6.0, RoHS, TCO edge
- Recyclable packaging material: 100 %
- Post-consumer recycled plastic: 65%
- Specific Substances: PVC/BFR free housing, Mercury free, Lead free

Compliance and standards

- Regulatory Approvals: BSMI, CE Mark, FCC Class B, GOST, SASO, SEMKO, TUV Ergo, TUV/GS, UL/cUL, WEEE

Cabinet

- Front bezel: Black
- Rear cover: Black
- Foot: Black
- Finish: Texture

What's in the box?

- Monitor with stand
- Cables: DVI, DP, Audio, USB, Power
- User Documentation



Issue date 2016-12-22

Version: 7.0.1

12 NC: 8670 000 96713
EAN: 87 12581 66390 2

© 2016 Koninklijke Philips N.V.
All Rights reserved.

Specifications are subject to change without notice.
Trademarks are the property of Koninklijke Philips N.V.
or their respective owners.

www.philips.com

* "IPS" word mark / trademark and related patents on technologies
belong to their respective owners.

* Response time value equal to SmartResponse