

Signet Measurement and Instrumentation

Price List effective January 1, 2015



Conveyance

Pipe, Fittings, Joining Technology // PVC/CPVC // PPro-Seal™ PP // PROGEF® PP // SYGEF® PVDF // Contain-It™ // Double-See™ // Fuseal® Special Waste // COOL-FIT® ABS // ecoFIT PE

Measurement

Chlorine // Dissolved Oxygen // Turbidity // Flow/Batch // pH // ORP // Conductivity // Pressure // Temperature // Level

Control

Ball Valves // Butterfly Valves // Diaphragm Valves // Pressure Regulating Valves // Electric Actuation // Pneumatic Actuation



Table of contents

	Page
Instruments	1
Chlorine	9
Turbidity	15
Dissolved Oxygen	16
Flow	17
pH/ORP	34
Conductivity/Resistivity	41
Temperature, Pressure, Level	46
Other Products	48
Installation and Weld-on Fittings	52

Instruments

Multi-Parameter Instruments

8900

8900 Multi-Parameter Controller Base units, required - choose one

G

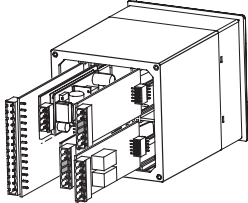

Instruments:

- Display: Backlit LCD, 2x16 alphanumeric characters
- Sensor Input: Up to 6 inputs, Analog or Digital (S³L) or Pulse (2 max for pulse)
- Analog Output: Up to Four, 4-20mA isolated, passive/active option or 0-5VDC or 0-10VDC
- Relay/Solid-State Output: Up to 4 Internal and up 2 or 4 more external contact relays (via 8059)
- Compatible Sensors: All Signet Digital/Pulse Output Flow Sensors, 2250, 2350, 2450, 2750, 2850, 8058-x

MFR #	*	Description	code	USD
3-8900	Required	Base Unit with LCD	159 000 868	477.00
3-8900.401-1	Required	Two inputs, no outputs	159 000 870	197.00
3-8900.401-2	Required	Two inputs, two passive 4 to 20mA outputs	159 000 871	328.00
3-8900.401-3	Required	Two inputs, two active 4 to 20mA outputs	159 000 872	414.00
3-8900.401-4	Required	Two inputs, two 0 to 5/10 VDC outputs	159 000 873	597.00
3-8900.401-5	Required	Four inputs, no outputs	159 000 874	472.00
3-8900.401-6	Required	Four inputs, two passive 4 to 20mA outputs	159 000 875	621.00
3-8900.401-7	Required	Four inputs, two active 4 to 20mA outputs	159 000 876	716.00
3-8900.401-8	Required	Four inputs, two 0 to 5/10 VDC outputs	159 000 877	743.00
3-8900.401-9	Required	Six inputs, no outputs	159 000 968	616.00
3-8900.401-11	Required	Six inputs, two active 4 to 20mA outputs	159 000 970	860.00
3-8900.401-12	Required	Six inputs, two 0 to 5/10 VDC outputs	159 000 971	888.00
3-8900.402-1	Required	85 to 264 VAC power	159 000 878	230.00
3-8900.402-2	Required	12 to 24 VDC power	159 000 879	151.00
3-8900.403-1	Optional	Two dry-contact relays	159 000 880	137.00
3-8900.403-2	Optional	Two solid-state relays	159 000 881	143.00
3-8900.405-1	Optional	Two passive 4 to 20mA outputs	159 000 883	214.00
3-8900.405-2	Optional	Two active 4 to 20mA outputs	159 000 884	291.00

8900 Multi-Parameter Controller Accessories and Replacement Parts

G



Instruments:

- Display: Backlit LCD, 2x16 alphanumeric characters
- Sensor Input: Up to 6 inputs, Analog or Digital (S³L) or Pulse (2 max for pulse)
- Compatible Sensors: All Signet Digital/Pulse Output Flow Sensors, 2250, 2350, 2450, 2750, 2850, 8058-x
- Analog Output: Up to Four, 4-20mA isolated, passive/active option or 0-5VDC or 0-10 VDC
- Relay/Solid-State Output: Up to 4 Internal and up 2 or 4 more external contact relays (via 8059)

MFR #	Description	code	USD
3-8900.614	14-terminal plug (for I/O Module)	159 000 902	28.00
3-8900.604	4-terminal plug (for Power Module)	159 000 903	8.00
3-8900.606	6-terminal plug (for Dry-contact Relays)	159 000 937	16.00
3-8900.391	Rear Panel w/ Captive Screws	159 000 918	Call
3-8900.561	Front Face Panel Gasket	159 000 919	8.00
3-8900.602	2-terminal plug, 2 ea. (for SSR & Outputs 3 & 4)	159 000 904	8.00

9900 9900 SmartPro™ Transmitter

G



Instruments:

- Large auto-sensing backlit display with at-a-glance visibility
- "Dial-type" digital bar graph
- Optional field upgradeable relays
- Custom 13-character label capabilities for the channel type
- Intuitive and "user-friendly" interface consistent with legacy Signet ProPoint® and ProcessPro® devices

MFR #	Description	code	USD
3-9900-1P	9900 Panel Mount	159 001 695	568.00
3-9900-1	9900 Field Mount	159 001 696	568.00

9900 Modules Relay Module

G



- Dry-contact relays are electromechanical switches with a moving contact armature. They are suitable for many general purpose applications, AC or DC, including loads up to 250 V. Install RC Filter kits (3-8050.396) on relays used to switch motor or inductive loads. This module adds two programmable dry-contact relays to the standard Open Collector out-put on the base unit.

MFR #	Description	code	USD
3-9900.393	Relay Module - 2 DCR (Dry-contact relays)	159 001 698	111.00

9900 Modules Conductivity/Resistivity Module

G



- The Direct Conductivity/Resistivity Module interfaces Signet 2819-2823 and 2839-2842 Conductivity electrodes directly to the 9900. The module also provides filtering and conditioning. (Conductivity/Resistivity and Salinity measurements may also be performed via the 2850 Sensor Electronics connected through the 9900 Digital (S³L) inputs.)

MFR #	Description	code	USD
3-9900.394	Direct Conductivity/Resistivity Module	159 001 699	227.00

9900 Modules H COMM Module

G



- The H COMM Module enables communication between the 9900 and a HART® enabled device. The HART (Highway Addressable Remote Transducer) Protocol superimposes dig-ital signals on top of the 4 to 20 mA analog signal.

MFR #	Description	code	USD
3-9900.395	H COMM Module	159 001 697	294.00



i-Go™ 8058 Signal Converter

G

- Features: Connects with level, temperature, pressure and multi-parameter Signet instruments
- Up to two 4 to 20 mA sensor inputs
- Connects additional measurement parameters to Signet Multi-Parameter instruments
- Wire or DIN rail mountable

MFR #	Description	code	USD
3-8058-1	Single input wire-mount with short cable	159 000 966	250.00
3-8058-2	Two input DIN rail mount	159 000 967	371.00

4 to 20 mA Output Module

G

Instruments:

- The 4 to 20 mA Output Module adds a second 4 to 20 mA Output to the 9900 Transmitter (Generation III and newer). Each of the outputs can be used to output the primary and/or secondary measurement. Outputs have individual settings available.



MFR #	Description	code	USD
3-9900.398-1	4 to 20 mA Output Module	159 001 784	140.00

9900-1BC 9900-1BC Batch Controller System

G

Instruments:

- Customize 10 batch names for easy distinction between batches
- Store up to 10 batch sizes for batching or blending a variety of liquid volumes
- Remote control wiring with start, stop & resume terminals for remote batch control
- 3 programmable relays
- Two-stage control to prevent overflowing or to minimize water hammer
- Enter 10 different K-Factors - one per batch for when different liquids are batched



MFR #	Description	code	USD
3-9900-1BC	Batch Controller System	159 001 770	1,126.00

9900-1BC Batch Module

G

Instruments:

- The Batch Module adds batch capability to the 9900 Transmitter (Generation II or later). It is compatible with all Signet flow sensors. Up to 10 batch sizes can be stored in one 9900 with customized names and K-Factors available for each batch.



MFR #	Description	code	USD
3-9900.397	Batch Module	159 310 163	468.00

9900 Transmitter Accessories and Replacement Parts

G

MFR #	Description	code	USD
3-9900.393	Relay Module - 2 DCR (Dry-contact relays)	159 001 698	111.00
3-9900.395	H COMM Module	159 001 697	294.00
3-9900.394	Direct Conductivity/Resistivity Module	159 001 699	227.00
3-9900.397	Batch Module	159 310 163	468.00
6682-0204	Conductivity Module Plug, 4 Pos, Right Angle	159 001 709	23.00
6682-1102	DC Power Plug, 2 Pos, Right Angle	159 001 710	18.00
6682-1103	Relay Module Plug, 3 Pos, Right Angle	159 001 711	18.00
6682-1104	Loop Power Plug, 4 Pos, Right Angle	159 001 712	23.00
6682-3004	Terminal Block Plug	159 001 725	45.00
6682-3104	Freq/S3L Plug, 4 Pos, Right Angle	159 001 713	23.00
3-8050	Universal Mount Kit	159 000 184	66.00
3-8050.396	RC Filter Kit	159 000 617	25.00
3-8051	Integral Adapter	159 000 187	66.00
3-8052	3/4 in. Integral Mount Kit	159 000 188	76.00
3-8058-1	Single input wire-mount with short cable	159 000 966	250.00
3-8058-2	Two input DIN rail mount	159 000 967	371.00
3-9000.392-1	NPT (1 pc.)	159 000 839	25.00
3-9900.390	Standard Connector Kit, Right Angle	159 001 714 *	45.00
3-9900.391	Optional Connector Kit, In-Line	159 001 715	106.00
3-9900.392	Wall Mount Accessory Kit	159 001 700	256.00
3-9900.396	Angle Adjustment Adapter Kit (for Field Mounting)	159 001 701	28.00
3-0251	PC COMM configuration tool	159 001 724	256.00
7310-1024	24 VDC Power Supply, 10W, 0.42 A	159 873 004	108.00
7310-2024	24 VDC Power Supply, 24W, 1.0 A	159 873 005	146.00
7310-4024	24 VDC Power Supply, 40W, 1.7 A	159 873 006	170.00
7310-6024	24 VDC Power Supply, 60W, 2.5 A	159 873 007	256.00
7310-7024	24 VDC Power Supply, 96W, 4.0 A	159 873 008	329.00

Digital Display Instruments

Type 8550 ProcessPro Flow Transmitter

G



Instruments:

- Display: LCD, 2x16 alphanumeric characters
- Sensor Input: Up to 2 inputs
- Power Input: 12-24 Volts, DC, regulated
- Current Output(s): Up to 2, 4-20 mA outputs, isolated, passive
- Relay/O.C. Output(s): Up to 2 SPDT Relays or Open Collector Outputs
- Compatible with all Signet sensors with frequency output

MFR #	Mount	Inputs	Current O/P	Relays	O.C.	code	USD
3-8550-3	Field	2	2		2	159 000 051	958.00
3-8550-3P	Panel	2	2		2	159 000 052	958.00

Type 8150 Battery Powered Flow Totalizer

G



Instruments:

- Display: 4-digit upper line and 8-digit lower line
- Sensor Input: 1 input
- Power Input: Two 3.6V Lithium Thionyl Chloride, AA size, 4 years nominal battery life
- Relay/O.C. Output: None
- Current Output: None
- Compatible Sensors: 515, 525 Flow Sensors

MFR #	Integral Sensor	code	code	USD
3-8150-1	N/A		159 000 929	638.00
3-8150-1P	N/A		159 000 930	638.00
3-8150-P0	3-8510-P0	-X0	159 000 931	994.00
3-8150-P1	3-8510-P1	-X1	159 000 932	1,019.00
3-8150-T0	3-8510-T0	-X0	159 001 011	1,339.00

Needle Dial/LCD Display Instruments

Type 5090 Sensor-Powered Flow Monitor

G



Instruments:

- Display: Analog Dial with reversible dial kits
- Sensor Input: 1 input
- Power Input: None
- Relay/O.C. Output: None
- Current Output: None
- Compatible Sensors: 515 sensor only

MFR #	Description	code	USD
3-5090	Sensor-Powered Flow Monitor	198 825 000	435.00

Digital Display Instruments Type 8750 pH/ORP Transmitter

G



Instruments:

- Display: LCD, 2x16 alphanumeric characters
- Sensor Input: 1 input
- Current Output(s): Up to 2, 4-20 mA outputs, isolated, passive
- Relay/O.C. Output: 2 SPDT Relays
- Compatible Sensors: 27xx pH/ORP Electrodes
- Compatible Preamplifiers: 2760

MFR #	Mount	Inputs	Current O/P	Relays	O.C.	code	USD
3-8750-3	Field	1	2		2	159 000 057	1,049.00
3-8750-3P	Panel	1	2		2	159 000 058	1,049.00

Digital Display Instruments Type 8850 Conductivity Transmitter

G



Instruments:

- Display: LCD, 2x16 alphanumeric characters
- Simulate function
- Programmable temperature compensation
- Two open collectors
- Dual output option allows temperature and process signal transmission
- Compatible with all Signet conductivity electrodes

MFR #	Mount	O.C.	Inputs	Current O/P	code	USD
3-8850-3	Field	2	1	2	159 000 232	997.00
3-8850-3P	Panel	2	1	2	159 000 233	997.00

Type 8860 Two-Channel Conductivity Controller

G



Instruments:

- Sensor Input: 2 inputs
- Power Input: 12-24 Volts, DC, regulated
- Current Output(s): 3, 4-20 mA outputs, isolated, passive
- Relay/O.C. Output(s): 4 Relays, 3 Open Collector Outputs (switch-selectable)
- Compatible with all Signet conductivity electrodes
- Display: LCD, 2x16 alphanumeric characters

MFR #	Inputs	Relays/O.C.	Current O/P	code	USD
3-8860	2	4/3	3	159 000 677	1,324.00
3-8860-AC	2	4/3	3	159 000 678	1,401.00

Digital Display Instruments

Type 8350 Temperature Transmitters

G



Instruments:

- Digital (S³L) input for stable and reliable reading
- Dual sensor input
- Sensor Input: Up to 2 inputs
- Field scaleable dual 4 to 20 mA output
- Dual open collector output
- Compatible Sensor(s): 2350 only

MFR #	Inputs	Current O/P	O.C.	code	USD
3-8350-3	2	2	2	159 000 196	958.00
3-8350-3P	2	2	2	159 000 197	958.00



Type 8450 ProcessPro Pressure Transmitters

G

Instruments:

- Digital (S³L) input for stable and reliable reading
- Dual sensor input
- Power Input: 12-24 Volts, DC, regulated
- Field scaleable dual 4 to 20 mA output
- Dual open collector output
- Compatible Sensor(s): 2250, 2450, 4-20 mA signal via 8058-x

MFR #	Inputs	Current O/P	O.C.	code	USD
3-8450-3	2	2	2	159 000 045	958.00
3-8450-3P	2	2	2	159 000 046	958.00

Instrument Accessories and Replacement Parts

Power Supply, RC Filter, Batteries, Converter

G

MFR #	Description	For Type	code	USD
3-8050.396	RC Filter Kit	8900	159 000 617	25.00
7400-0011	Lithium Repl. Battery	8150	159 000 935	20.00
3-8058-1	Single input wire-mount with short cable		159 000 966	250.00
3-8058-2	Two input DIN rail mount		159 000 967	371.00

Liquid Tight Connector Kits

G

MFR #	Description	For Type	code	USD
3-9000.392	For rear cover (3 pc.)	All instruments	159 000 368	61.00
3-9000.392-1	NPT (1 pc.)	All instruments	159 000 839	25.00
3-9000.392-2	PG13.5 (1 pc.)	All instruments	159 000 841	25.00

G

Instrument mounting and accessories, 5000 Series

MFR #	Description	For Type	code	USD
3-5000.395	Splashproof rear cover kit	5000 series	198 840 227	57.00
3-5000.399	5 x 5 in. adapter plate	5000 series	198 840 224	31.00
3-5000.397	Window kit	5000 series	159 000 326	47.00
3-8050.392	Model 200 retrofit adapter	5000 series, 8900	159 000 640	74.00
3-5000.598	mount bracket	All instruments	198 840 225	39.00
3-0000.596	Heavy duty wall mnt bracket	All instruments	159 000 641	74.00
3-0000.596-1	Wall mount	5000, 8000 series	159 000 892	76.00

Instrument mounting 8000 series

G

MFR #	Description	For Type	code	USD
3-8050	Universal Mount Kit	8000 series	159 000 184	66.00
3-8050-1	Universal Mount Junction Box	8000 series	159 000 753	106.00
3-8050.395	Splashproof rear cover	8000 series	159 000 186	60.00
3-8050.396	RC Filter Kit	8000	159 000 617	25.00
3-0000.596-2	Wall mount	8860, 8900	159 000 893	118.00
3-8052	3/4 in. Integral Mount Kit	8150, 8350, 8450, 8850	159 000 188	76.00
3-8052-1	3/4 in. Junction Box	8150, 8350, 8450, 8850	159 000 755	106.00
3-0000.596-1	Wall mount	5000, 8000 series	159 000 892	76.00
3-8050.390-1	Retaining nut replacement kit, Valox K4530		159 001 702	26.00

Chlorine

H

4630 Chlorine Analyzer System

Chlorine:

- Reagent free measuring
- Complete panel system allows for quick and easy installation
- Built-in flow regulator maintains constant flow and pressure to the sensors regardless of inlet pressure

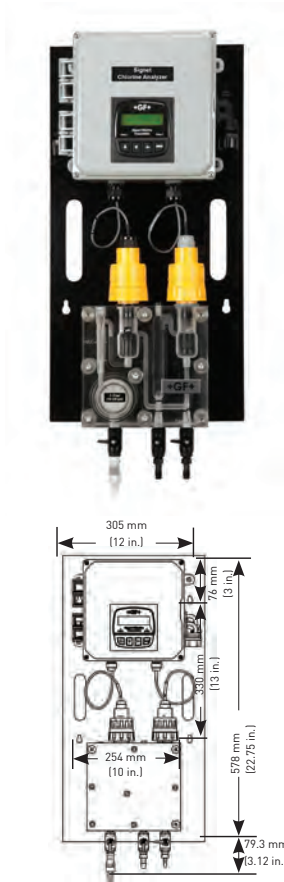

MFR #	Description	code	USD
3-4630-10	Chlorine pnl, trnsmttr, free chlorine sensor (0 to 2 ppm)/w/electronics (no pH sensor)	159 001 748	3,448.00
3-4630-20	Chlorine pnl, trnsmttr, free chlorine sensor (0 to 5 ppm)/w/electronics (no pH sensor)	159 001 691	3,448.00
3-4630-30	Chlorine pnl, trnsmttr, free chlorine sensor (0 to 20ppm) w/electronics (no pH sensor)	159 001 750	3,448.00
3-4630-11	Chlorine pnl, trnsmttr, free chlorine sensor (0 to 2 ppm)/w/electronics w/pH sensor)	159 001 749	3,893.00
3-4630-21	Chlorine pnl, trnsmttr, free chlorine sensor (0 to 5 ppm)/w/electronics w/pH sensor)	159 001 692	3,893.00
3-4630-31	Chlorine pnl, trnsmttr, free chlorine sensor (0 to 20ppm) w/electronics w/pH sensor)	159 001 751	3,893.00

4632 Chlorine Dioxide Analyzer System

H

Chlorine:

- Reagent free measuring
- Panel includes a 100-240 VAC power supply, two 4 to 20 mA outputs and two mechanical relays
- Built-in flow regulator maintains constant flow and pressure to the sensors regardless of inlet pressure
- Complete panel system allows for quick and easy installation



MFR #	Description	code	USD
3-4632-10	Chlorine Dioxide panel, 0 to 2 ppm/mg/l, no pH sensor	159 001 768	3,368.00
3-4632-11	Chlorine Dioxide panel, 0 to 2 ppm/mg/l, with pH sensor	159 001 769	3,817.00

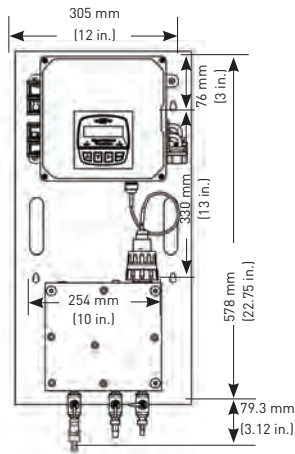

2630 Amperometric Chlorine Electrode

H



MFR #	Description	code	USD
3-2630-1	Free Chlorine electrode, 0 to 2 ppm (mg/l)	159 001 746 *	896.00
3-2630-2	Free Chlorine electrode, 0 to 5 ppm (mg/l)	159 001 662 *	896.00
3-2630-3	Free Chlorine electrode, 0 to 20 ppm (mg/l)	159 001 747 *	896.00

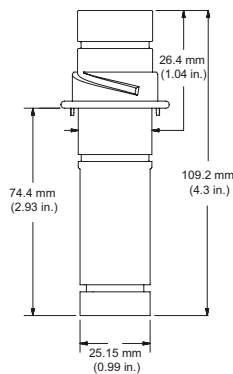

2632 Chlorine Dioxide Electrode

H



Chlorine:

- Embedded memory chip accessible via the Signet 8630 transmitter
- Quick assembly with Signet's patented DryLoc® connector
- Integrated temperature element for automatic temperature compensation
- Separate drive electronics (Signet 2650), for easy electrode replacement without running new cable

MFR #	Description	code	USD
3-2632-1	Chlorine Dioxide electrode, 0 to 2 ppm (mg/L)	159 001 767 *	903.00

2650 DryLoc® Amperometric Electronics

H



MFR #	Description	code	USD
3-2650-7	Amperometric in-line sensor electronics, digital (S ³ L), 4.6 m (15ft) cable	159 001 670	568.00

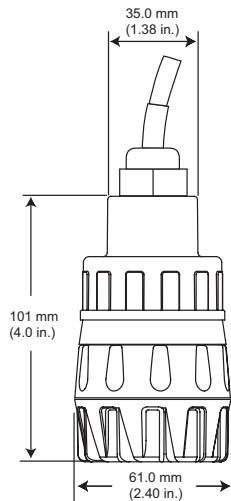

8630 Chlorine Transmitter

H



MFR #	Description	code	USD
3-8630-3P	Panel mount chlorine and pH transmitter	159 001 673	808.00

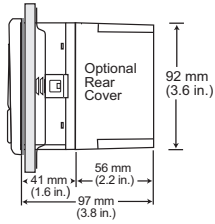
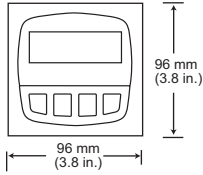

2750-7 pH Sensor Electronics

G



MFR #	Description	code	USD
3-2750-7	pH electronics, digital (S ³ L), 4.6 (15 ft) cable	159 001 671	428.00

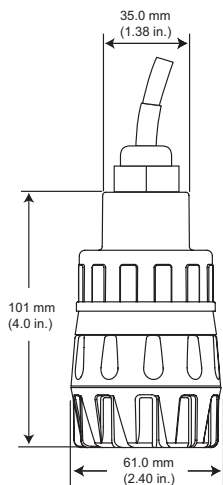

Chlorine Accessories and Replacement Parts

4630 Chlorine Analyzer System 4630 Chlorine Analyzer System Accessories and Replacement Parts

G

MFR #	Description	code	USD
3-2630-1	Free Chlorine electrode, 0 to 2 ppm (mg/l)	159 001 746 *	896.00
3-2630-2	Free Chlorine electrode, 0 to 5 ppm (mg/l)	159 001 662 *	896.00
3-2630-3	Free Chlorine electrode, 0 to 20 ppm (mg/l)	159 001 747 *	896.00
3-2724-00	pH sensor, flat glass, PT1000 temp element, 3/4 in. MNPT	159 001 545 *	324.00
3-2650-7	Amperometric in-line sensor electronics, digital (S ³ L), 4.6 m (15ft) cable	159 001 670	568.00
3-2750-7	pH electronics, digital (S ³ L), 4.6 (15ft) cable	159 001 671	428.00
3-8630-3P	Panel mount chlorine and pH transmitter	159 001 673	808.00
3-4630.390	Rebuild kit, O-rings, boots, screws, 1 filter screen	159 001 688	123.00
3-4630.391	Pressure regulator with 1 spare filter screen	159 001 689	150.00
3-4630.392	Acrylic flow cell complete with all components and connections	159 001 690	1,671.00
3-2630.391	Free Chlorine electrolyte, 30 ml	159 001 674	33.00
3-2630.392	Free Chlorine replacement membrane (1)	159 001 675	66.00
3-2630.394	Free Chlorine Replacement PTFE membrane (1)	159 310 164 *	102.00
3-2630.396	Free Chlorine replacement kit - (2) electrolyte and (2) membranes	159 001 676	184.00
3-2630.398	Free Chlorine Sensor maintenance kit - (2) electrolyte and (2) PTFE membranes, (2) silicone bands	159 310 166 *	304.00
3-0700.390	pH buffer kit (1 ea 4, 7, 10 powder form)	198 864 403 *	7.00
3822-7004	pH 4 buffer solution, 1 pt (473 ml)	159 001 581 *	25.00
3822-7007	pH 7 buffer solution, 1 pt (473 ml)	159 001 582 *	25.00
3822-7010	pH 10 buffer solution, 1 pt (473 ml)	159 001 583 *	25.00
3-2700.395	Calibration kit, 3 PP cups, 1 pt ea 4, 7 solutions	159 001 605 *	83.00

4632 Chlorine Dioxide Analyzer System

H

MFR #	Description	code	USD
3-2650-7	Amperometric in-line sensor electronics, digital (S ³ L), 4.6 m (15ft) cable	159 001 670	568.00
3-2724-00	pH Electrode, Flat, 3/5 in. NPT Thread	159 001 545 *	324.00
3-2632.391	Chlorine Dioxide electrode, 30 ml	159 310 160 *	34.00
3-2632.398	Chlorine Dioxide maintenance kit - (2) electrolyte, (2) PTFE membranes, (2) silicone bands and polishing paper	159 310 165 *	185.00
3-8630-3P	Panel mount chlorine and pH transmitter	159 001 673	808.00
3-2632-1	Chlorine Dioxide electrode, 0 to 2 pp, (mg/l)	159 001 767 *	903.00
3-2750-7	pH electronics, digital (S ³ L), 4.6 (15ft) cable	159 001 671	428.00
3-4630.390	Rebuild kit, O-rings, boots, screws, 1 filter screen	159 001 688	123.00
3-4630.391	Pressure regulator with 1 spare filter screen	159 001 689	150.00
3-4630.392	Acrylic flow cell complete with all components and connections	159 001 690	1,671.00
3-2630.394	Free Chlorine Replacement PTFE membrane (1)	159 310 164 *	102.00
3-4630.393	Flow Switch kit, Chlorine PP	159 310 162	252.00

2630 Amperometric Chlorine Electrode

H

MFR #	Description	code	USD
3-2630.391	Free Chlorine electrolyte, 30 ml	159 001 674	33.00
3-2630.392	Free Chlorine replacement membrane (1)	159 001 675	66.00
3-2630.394	Free Chlorine Replacement PTFE membrane (1)	159 310 164 *	102.00
3-2630.396	Free Chlorine replacement kit - (2) electrolyte and (2) membranes	159 001 676	184.00
3-2630.398	Free Chlorine Sensor maintenance kit - (2) electrolyte and (2) PTFE membranes, (2) silicone bands	159 310 166 *	304.00

8630 Chlorine Transmitter

G

MFR #	Description	code	USD
3-8050.395	Splashproof rear cover	159 000 186	60.00
3-0000.596	Heavy duty wall mnt bracket	159 000 641	74.00
3-5000.598	Mount bracket	198 840 225	39.00
3-8050.396	RC Filter Kit	159 000 617	25.00
3-9000.392	For rear cover (3 pc.)	159 000 368	61.00
3-9000.392-1	NPT (1 pc.)	159 000 839	25.00
3-9000.392-2	PG13.5 (1 pc.)	159 000 841	25.00

Turbidity

4150 Turbidimeter

H



Turbidity:

- Simple and easy one-unit installation with built-in pressure regulator
- EPA compliant per U.S. EPA 180.1 or ISO 7027
- Programmable 4 to 20 mA output
- Easy access for wiring and maintenance
- Ultrasonic cleaning option insures long and steady online measurement
- Compatibility: 8058 i-Go Signal Converter

MFR #	Description	code	USD
3-4150-1	White Light, 0 to 1000 NTU/FNU, no self cleaning	159 001 596	2,166.00
3-4150-2	Infrared, 0-1000 NTU/FNU, no self cleaning	159 001 597	2,467.00
3-4150-3	White Light, 0 to 100 NTU/FNU, with ultrasonic auto self cleaning	159 001 598	2,527.00
3-4150-4	Infrared, 0-100 NTU/FNU, with ultrasonic auto self cleaning	159 001 599	2,828.00
3-4150-5	White Light, 0 to 1000 NTU/FNU, with ultrasonic auto self cleaning	159 001 600	3,128.00
3-4150-6	Infrared, 0-1000 NTU/FNU, with ultrasonic auto self-cleaning	159 001 601	3,429.00

Turbidimeter Accessories and Replacement Parts Spare Parts for 4150

H

MFR #	Description	code	USD
3822-4001	Calibration kit, Turbidity, 100, 10 & 0.02 NTU/FNU	159 001 585 *	349.00
3822-4003	Calibration kit, Turbidity, 1000, 10 & 0.02 NTU/FNU	159 001 586 *	349.00
3-4150.380	Replacement Desiccant	159 001 588	55.00
3822-4002	Formazin Stock Kit	159 001 591 *	434.00
3822-4000	Formazin Stock Solution, 4000 NTU/FNU, 500 ml	159 001 592 *	67.00
4150-0007	Replacement Cuvette Set (3 glass cuvettes)	159 001 602	93.00
4150-0004	Replacement Cuvette with Ultrasonic Transducer	159 001 589	259.00
3-4150.386	O-ring for cuvette	159 001 652	28.00
3822-4007	IPC standard, 10 NTU nominal value	159 001 686	Call
4150-0001	Pressure Regulator	159 001 593	193.00
4150-0003	Stilling-Bubble Chamber	159 001 587	697.00
4150-0005	Tubing kit, 1 shutoff clamp, 1 back-pressure valve	159 001 595	205.00

Dissolved Oxygen

2610 Process Optical Dissolved Oxygen Sensor

H

Dissolved Oxygen:

- No membranes or filling solutions
- Optical DO measurement no flow requirements
- Rugged construction
- Calibration built into the measurement cap 2% of range 0 to 20 mg/l
- One year measurement cap life
- Flexible communications, 4 to 20 mA or Modbus (RS485)
- Measurement Range: 0 to 20 mg/L

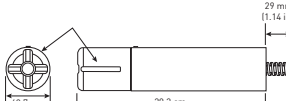

MFR #	Description	code	USD
3-2610-31	Optical Dissolved Oxygen Sensor (0 to 20 ppm) with Modbus, SDI, and 4 to 20 mA output	159 001 753 *	2,780.00
3-2610-41	Optical Dissolved Oxygen Sensor (0 to 20 ppm) with S ³ L, Modbus, and 4 to 20 mA output	159 001 754 *	2,673.00
3-2610.501	Dissolved Oxygen Threaded Pipe Adapter	159 500 413	85.00
3-2610.392	Replacement Optical Dissolved Oxygen Sensor Cap (0 to 20 ppm)	159 310 122	262.00

Flow

Paddlewheel Flow Sensors

Type 515

Type 515 Rotor-X

Standard Mount Paddlewheel

G



Flow:

- Operating range: 0.3 to 6 m/s, 1 to 20 ft/s
- Installs into pipe sizes: DN15 to DN900, 0.5 to 36 in
- Max Pressure rating: PP 12.5 bar @ 20 °C, 180 psi @ 68 °F
PVDF 14 bar @ 20 °C, 200 psi @ 68 °F
- Power source: Self powered
- Rotor: PVDF
- Compatibility: 5090, 8150, 8550, 8900, 9900, 9900-1BC
- *Only Signet installation fittings

MFR #	Body	Pin	Pipe Size [inch]	Sensor Type	code	USD
P51530-H0	PP	Hastelloy-C	0.5 - 4.0	-X0	198 801 659	389.00
P51530-P0	PP	Titanium	0.5 - 4.0	-X0	198 801 620	391.00
P51530-P1	PP	Titanium	5.0 - 8.0	-X1	198 801 621	406.00
P51530-P2	PP	Titanium	10.0 - 36.0	-X2	198 801 622	439.00
P51530-S0	PP	PVDF	0.5 - 4.0	-X0	198 801 661	435.00
P51530-T0	PVDF	PVDF	0.5 - 4.0	-X0	198 801 663	665.00
P51530-T1	PVDF	PVDF	5.0 - 8.0	-X1	198 801 664	724.00
P51530-V0	PVDF	Hastelloy-C	0.5 - 4.0	-X0	198 801 623	695.00
P51530-V1	PVDF	Hastelloy-C	5.0 - 8.0	-X1	198 801 624	721.00
P51530-V2	PVDF	Hastelloy-C	10.0 - 36.0	-X2	198 801 625	750.00

Type 515 Rotor-X

Integral Mount Paddlewheel (use with

3-8051 Accessory)

G



Flow:

- Highly chemical resistant materials
- Self powered, no power supply needed
- Rotor: PVDF

MFR #	Body	Pin	Pipe Size [inch]	DN-DN [mm]	Sensor Type	code	USD
3-8510-P0	PP	Titanium	0.5 - 4.0	15-100	-X0	198 864 504	314.00
3-8510-P1	PP	Titanium	5.0 - 8.0	125-200	-X1	198 864 505	355.00
3-8510-T0	PVDF	PVDF	0.5 - 4.0	15-100	-X0	159 000 622	634.00
3-8510-V0	PVDF	Hastelloy-C	0.5 - 4.0	15-100	-X0	198 864 506	625.00

Type 515 Rotor-X

Wet-Tap Mount Paddlewheel (use with

Type 3519 wet tap valve)

G



Flow:

- Operating range: 0.3 to 6 m/s, 1 to 20 ft/s
- Installs into pipe sizes: DN15 to DN900, 0.5 to 36 in
- Max Pressure rating: PP 12.5 bar @ 20 °C, 180 psi @ 68 °F
PVDF 14 bar @ 20 °C, 200 psi @ 68 °F
- Power source: Self powered
- Compatibility: 5090, 8150, 8550, 8900, 9900, 9900-1BC

MFR #	Pipe Size [inch]	DN-DN [mm]	code	USD
P51530-P3	0.5 - 4.0	15-100	198 840 310	608.00
P51530-P4	5.0 - 8.0	125-200	198 840 311	673.00
P51530-P5	10.0 - 36.0	250-900	198 840 312	722.00

Rotors and Rotor Kits 515

G

MFR #	For Type	Description	code	USD
M1538-2	515	Rotor, PVDF Black	198 801 181	57.00
M1538-4	515	Rotor, PTFE	198 820 018	65.00
P51550-3	515	Rotor and Pin, PVDF Natural	198 820 043	74.00
3-0515.322-1	515	Sleeved Rotor, PVDF Black	198 820 059	77.00
3-0515.322-2	515	Sleeved Rotor, PVDF Natural	198 820 060	80.00
3-0515.322-3	515	Sleeved Rotor, ETFE	198 820 017	93.00
M1546-1	515, 2536	Pin, Titanium	198 801 182	27.00
M1546-2	515, 2536	Pin, Hastelloy-C	198 801 183	73.00
M1546-3	515, 2536	Pin, Tantalum	198 820 014	148.00
M1546-4	515, 2536	Pin, Stainless Steel 316 (1.4401)	198 820 015	65.00
P51545	515, 2536	Pin, Ceramic	198 820 016	148.00



Type 2536 Type 2536 Rotor-X Standard Mount Paddlewheel

G

Flow:

- Operating range: 0.1 to 6 m/s, 0.3 to 20 ft/s
- Open collector output
- Installs into pipe sizes: DN15 to DN900, 0.5 to 36 in
- Max Pressure rating: PP 12.5 bar @ 20 °C, 180 psi @ 68 °F
PVDF 14 bar @ 20 °C, 200 psi @ 68 °F
- Rotor: PVDF
- Compatibility: 8550, 8900, 9900, 9900-1BC
- Power source: <20mA @ 3.3 to 24 VDC
- *Only Signet installation fittings

MFR #	Body	Pin	Pipe Size [inch]	Sensor Type	code	USD
3-2536-P0	PP	Titanium	0.5 - 4.0	-X0	198 840 143	423.00
3-2536-P1	PP	Titanium	5.0 - 8.0	-X1	198 840 144	448.00
3-2536-P2	PP	Titanium	10.0 - 36.0	-X2	198 840 145	471.00
3-2536-T0	PVDF	PVDF	0.5 - 4.0	-X0	198 840 149	753.00
3-2536-V0	PVDF	Hastelloy-C	0.5 - 4.0	-X0	198 840 146	729.00
3-2536-V1	PVDF	Hastelloy-C	5.0 - 8.0	-X1	198 840 147	753.00



Type 2536 Rotor-X Integral Mount Paddlewheel (use with 3-8051 Accessory)

G

Flow:

- Operating range: 0.1 to 6 m/s, 0.3 to 20 ft/s
- Installs into pipe sizes: DN15 to DN900, 0.5 to 36 in
- Max Pressure rating: PP 12.5 bar @ 20 °C, 180 psi @ 68 °F
PVDF 14 bar @ 20 °C, 200 psi @ 68 °F
- Power source: <20mA @ 3.3 to 24 VDC
- Compatibility: 8550, 8900, 9900, 9900-1BC
- *Only Signet installation fittings
- Rotor: PVDF
- Open collector output

MFR #	Body	Pin	Pipe Size [inch]	DN-DN [mm]	Sensor Type	code	USD
3-8512-P0	PP	Titanium	0.5 - 4.0	15-100	-X0	198 864 513	318.00
3-8512-P1	PP	Titanium	5.0 - 8.0	125-200	-X1	198 864 514	355.00
3-8512-T0	PVDF	PVDF	0.5 - 4.0	15-100	-X0	198 864 518	660.00
3-8512-V0	PVDF	Hastelloy-C	0.5 - 4.0	15-100	-X0	198 864 516	602.00



Type 2536 Rotor-X Wet-Tap Mount Paddlewheel (use with type 3519 wet tap valve)

G

Flow:

- Operating range: 0.1 to 6 m/s, 0.3 to 20 ft/s
- Installs into pipe sizes: DN15 to DN900, 0.5 to 36 in
- Max Pressure rating: PP 12.5 bar @ 20 °C, 180 psi @ 68 °F
PVDF 14 bar @ 20 °C, 200 psi @ 68 °F
- Power source: <20mA @ 3.3 to 24 VDC
- Compatibility: 8550, 8900, 9900, 9900-1BC
- *Only Signet installation fittings
- Rotor: PVDF
- Open collector output

MFR #	Body	Pin	Pipe Size [inch]	DN-DN [mm]	code	USD
3-2536-P3	PP	Titanium	0.5 - 4.0	15-100	159 000 758	647.00
3-2536-P4	PP	Titanium	5.0 - 8.0	125-200	159 000 759	707.00
3-2536-P5	PP	Titanium	10.0 - 36.0	250-900	159 000 760	753.00

Rotors and Rotor Kits 2536 and 2537

G

MFR #	Description	code	USD
3-2536.320-1	Rotor, PVDF Black	198 820 052	71.00
3-2536.320-3	Rotor, PTFE	159 000 273	79.00
3-2536.321	Rotor and Pin, PVDF Natural	198 820 054	91.00
3-2536.322-1	Sleeved Rotor, PVDF Black	198 820 056	96.00
3-2536.322-2	Sleeved Rotor, PVDF Natural	198 820 057	102.00
3-2536.322-3	Sleeved Rotor, PTFE	198 820 058	107.00
M1546-1	Pin, Titanium	198 801 182	27.00
M1546-2	Pin, Hastelloy-C	198 801 183	73.00
M1546-3	Pin, Tantalum	198 820 014	148.00
M1546-4	Pin, Stainless Steel 316 (1.4401)	198 820 015	65.00
P51545	Pin, Ceramic	198 820 016	148.00

Spare Parts 515/2536

G

MFR #	Description	code	USD	For Type
P31542	Sensor Cap, Red	198 801 630	16.00	515
P31934	Conduit Cap	159 000 466	16.00	515, 2536
P51589	Conduit Adapter Kit	159 000 476	62.00	515, 2536
3-8051	Integral Adapter	159 000 187	66.00	515, 2536
P31536	Sensor Plug, PP	198 840 201	65.00	515, 2536
5523-0222	Cable (2 Conductor, shield)	159 000 392	3.00	
3-8050.390-1	Retaining nut replacement kit, Valox K4530	159 001 702	26.00	
3-8050.390-3	Replacement nut replacement kit, NPT, PP	159 310 116	32.00	
3-8050.390-4	Replacement nut replacement kit, NPT, PVDF	159 310 117	52.00	
3-8051-1	Integral mounting kit, NPT, PP	159 001 755	76.00	
3-8051-2	Integral mounting kit, NPT, PVDF	159 001 756	96.00	

Sensor Plug 515/2536/2537

G

MFR #	For Type	Description	code	USD
P31536	515, 2536, 2537	Sensor Plug, PP	198 840 201	65.00

O-Rings 515/2536/2537

G

MFR #	For Type	Description	code	USD
1220-0021	515, 2536, 2537	O-ring, FPM (2 req'd per sensor)	198 801 000	4.00
1224-0021	515, 2536, 2537	O-ring, EPR (EPDM) (2 req'd per sensor)	198 820 006	9.00
1228-0021	515, 2536, 2537	O-ring, FFPM (2 req'd per sensor)	198 820 007	195.00



Type 2537 Rotor-X

G

Flow:

- Installs into pipe sizes: DN15 to DN200, 0.5 to 8 in
- Operating range: 0.1 to 6 m/s, 0.3 to 20 ft/s
- Outputs: Digital (S³L), 4 to 20 mA or multi-function
- Max Pressure rating: PP 12.5 bar @ 20 °C, 180 psi @ 68 °F
PVDF 14 bar @ 20 °C, 200 psi @ 68 °F
- Power source: Digital - 5 VDC nominal, Relay & 4-20 mA - 24 VDC nominal
- Compatibility: 8550, 8900, 9900, 9900-1BC
- Rotor: PVDF

MFR #	Output	Body	Pin	Pipe Size [inch]	Code	USD
3-2537-1C-P0	Pulse/Flow Switch, DCR, -P0, Integral Mount	PP	Titan.	0.5 - 4.0	159 001 291	600.00
3-2537-2C-P0	Pulse/Flow Switch, SSR, -P0, Integral Mount	PP	Titan.	0.5 - 4.0	159 001 292	600.00
3-2537-5C-P0	Digital (S ³ L) output, -P0, Integral Mount	PP	Titan.	0.5 - 4.0	159 001 295	628.00
3-2537-6C-P0	4-20 mA output, -P0, Integral Mount	PP	Titan.	0.5 - 4.0	159 001 296	659.00
3-2537-1C-P1	Pulse/Flow Switch, DCR, -P1, Integral Mount	PP	Titan.	5.0 - 8.0	159 001 303	628.00
3-2537-2C-P1	Pulse/Flow Switch, SSR, -P1, Integral Mount	PP	Titan.	5.0 - 8.0	159 001 304	628.00
3-2537-5C-P1	Digital (S ³ L) output, -P1, Integral Mount	PP	Titan.	5.0 - 8.0	159 001 307	659.00
3-2537-6C-P1	4-20 mA output, -P1, Integral Mount	PP	Titan.	5.0 - 8.0	159 001 308	687.00
3-2537-1C-T0	Pulse/Flow Switch, DCR, -T0, Integral Mount	PVDF	PVDF	0.5 - 4.0	159 001 315	716.00
3-2537-2C-T0	Pulse/Flow Switch, SSR, -T0, Integral Mount	PVDF	PVDF	0.5 - 4.0	159 001 316	716.00
3-2537-5C-T0	Digital (S ³ L) output, -T0, Integral Mount	PVDF	PVDF	0.5 - 4.0	159 001 319	751.00
3-2537-6C-T0	4-20 mA output, -T0, Integral Mount	PVDF	PVDF	0.5 - 4.0	159 001 320	785.00



Type 525 Metalex (use with Metalex Weld-On Mini-Tap, Socket Weld Mini-Tap)

G

Flow:

- Installs into pipe sizes: 0.5 to 12 in, DN15 to DN300
- Operating range: 1.6 to 20 ft/s, 0.5 to 6 m/s
- Max Pressure rating: Socket weld or weld on fittings 103 bar, 1500 psi (@ safety factor 1.5)
- Power source: Self powered
- Compatibility: 8150, 8550, 8900, 9900, 9900-1BC

MFR #	Pin	Pipe Size [inch]	DN-DN [mm]	code	USD
P525-1	Tungsten Carbide	0.5 - 1	15 - 25	198 801 494	634.00
P525-2	Tungsten Carbide	1.25 - 12	32 - 300	198 801 495	634.00
P525-1S	316 Stainless Steel	0.5 - 1	15 - 25	159 000 963	611.00
P525-2S	316 Stainless Steel	1.25 - 12	32 - 300	159 000 964	611.00

Rotor Kit, Pin, Cable, Conduit Adapter for 525

G

MFR #	Description	code	USD	For Type
P52509	Rotor kit (with stainless pin)	198 801 501	61.00	525
P52509-2	Rotor kit (with tungsten carbide pin)	159 000 480	88.00	525
P52504-1	Rotor pin, Stainless steel 316 (1.4401)	198 801 500	20.00	525
P52504-2	Rotor pin, Tungsten Carbide	198 820 023	65.00	525
P52618	Gasket	159 000 493	10.00	525
P52503	Bearing, carbon fiber reinforced PTFE	198 820 013	10.00	525
P52527	Retainers, Stainless steel	159 000 481	10.00	525, 2540
P52628	Fitting cap kit (cap and gasket)	159 000 504	88.00	525
P51589	Conduit Adapter Kit	159 000 476	62.00	515, 2356
5523-3222	Cable (per foot) 2 cond. w/shield, 22 AWG	159 000 393	3.00	525

Type 3519 Flow Wet-Tap Valve

G

Flow:

- Installs into pipe sizes: DN15 to DN900, 0.5 to 36 in
- Material: PVC body, seals FPM or EPDM
- Max Pressure rating: 7 bar @ 20 °C, (100 psi @ 68 °F)



MFR #	Description	Pipe Size [inch]	DN-DN [mm]	code	USD
3-3519	Wet-Tap Valve only			159 000 757	627.00
3519/515-P3	Valve with Model 515	0.5 - 4.0	15 - 100	159 000 819	1,090.00
3519/515-P4	Valve with Model 515	5.0 - 8.0	125 - 200	159 000 820	1,144.00
3519/515-P5	Valve with Model 515	10.0 - 36.0	250 - 900	159 000 821	1,199.00
3519/2536-P3	Valve with Model 2536	0.5 - 4.0	15 - 100	159 000 822	1,220.00
3519/2536-P4	Valve with Model 2536	5.0 - 8.0	125 - 200	159 000 823	1,274.00
3519/2536-P5	Valve with Model 2536	10.0 - 36.0	250 - 900	159 000 824	1,329.00



Type 2540

Type 2540 Stainless Steel Standard

G



Flow:

- *Recommended 198 820 008 (3-1500.663) Hot Tap installation tool (sold separately)
- Installs into pipe sizes: DN40 to DN600, 1.5 to 24 in
- Operating range: 0.1 to 6 m/s, 0.3 to 20 ft/s
- Max Pressure rating: 17 bar @ 100 °C, 250 psi @ 212 °F
Optional EPDM: 17 bar @ 82 °C, 250 psi @ 180 °F
- Power source: 5 to 24 VDC, 1.5mA max
- Compatibility: 8550, 8900, 9900, 9900-1BC

MFR #	Mounting	Rotor Pin	code	USD
3-2540-1	1.5 in. NPT thread	Tungsten Carb.	198 840 035	668.00
3-2540-2	1.5 in. ISO thread	Tungsten Carb.	198 840 036	668.00
3-2540-1S	1.5 in. NPT thread	Stainless Steel	159 001 501	780.00
3-2540-2S	1.5 in. ISO thread	Stainless Steel	159 001 502	780.00



Type 2540 Stainless Steel Hot Tap

G

Flow:

- Installs into pipe sizes: DN40 to DN 900, 1.5 in. to 36 in.
- Operating range: 0.1 to 6 m/s, 0.3 to 20 ft/s
- Max Pressure rating: 17 bar @ 100 °C, 250 psi @ 212 °F
Optional EPDM: 17 bar @ 82 °C, 250 psi @ 180 °F
- Power source: 5 to 24 VDC, 1.5mA max
- Compatibility: 8550, 8900, 9900, 9900-1BC
- *Recommended 198 820 008 (3-1500.663) Hot Tap installation tool (sold separately)

MFR #	Mounting	Rotor Pin	code	USD
3-2540-3	1.5 in. NPT thread	Tungsten Carb.	198 840 037	934.00
3-2540-4	1.5 in. ISO thread	Tungsten Carb.	198 840 038	934.00
3-2540-3S	1.5 in. NPT thread	Stainless Steel	159 001 503	1,033.00
3-2540-4S	1.5 in. ISO thread	Stainless Steel	159 001 504	1,033.00

Rotor Kit, O-ring, Cable for 2540 Hot-Tap

G

MFR #	Description	For Type	code	USD
3-1500.663	Hot-Tap Install. Tool	2540	198 820 008	544.00
1220-0021	O-ring, FPM (2 req'd per sensor)	515, 2536, 2537	198 801 000	4.00
1224-0021	O-ring, EPR (EPDM) (2 req'd per sensor)	515, 2536, 2537	198 820 006	9.00
1228-0021	O-ring, FPM (2 req'd per sensor)	515, 2536, 2537	198 820 007	195.00
3-2540.320	Rotor Kit/(old)	2540	198 820 040	81.00
3-2540.321	Rotor Kit, Tungsten Carbide Pin	2540	159 000 623	114.00
3-2540.520	Bearing, Fluoroloy B®/PTFE	2540	159 000 648	6.00
P52527	Retainers, Stainless steel	525, 2540	159 000 481	10.00
3-2541.260-1	Standard module	2540	159 000 849	327.00
3-2541.260-2	Hot-Tap module	2540	159 000 850	406.00
P51589	Conduit Adapter Kit	515, 2536	159 000 476	62.00
P31934	Conduit Cap	515, 2536	159 000 466	16.00
3-2540.322	Rotor kit, Stainless steel pin and rotor	525	159 000 864	130.00
P52504-3	Rotor pin, Tungsten Carbide		159 000 866	16.00
P52504-4	Rotor pin, 316 SS		159 000 867	13.00
P52503	Bearing, carbon reinforced PTFE		198 820 013	10.00

Spare Parts for 2540

G

MFR #	Description	code	USD
3-1500.663	Hot-Tap Install. Tool	198 820 008	544.00
1220-0021	O-ring, FPM (2 req'd per sensor)	198 801 000	4.00
1224-0021	O-ring, EPR (EPDM) (2 req'd per sensor)	198 820 006	9.00
1228-0021	O-ring, FPM (2 req'd per sensor)	198 820 007	195.00
3-2540.320	Rotor Kit/(old)	198 820 040	81.00
3-2540.321	Rotor Kit, Tungsten Carbide Pin	159 000 623	114.00
3-2540.322	Rotor kit, Stainless steel pin and rotor	159 000 864	130.00
P52504-3	Rotor pin, Tungsten Carbide	159 000 866	16.00
P52504-4	Rotor pin, 316 SS	159 000 867	13.00
P52503	Bearing, carbon reinforced PTFE	198 820 013	10.00
P52527	Retainers, Stainless steel	159 000 481	10.00
3-2541.260-1	Standard module	159 000 849	327.00
3-2541.260-2	Hot-Tap module	159 000 850	406.00
5523-0222	Cable (2 Conductor, shield)	159 000 392	3.00
P51589	Conduit Adapter Kit	159 000 476	62.00
P31934	Conduit Cap	159 000 466	16.00

Replacement Cable 22 AWG for Type 2540

G

MFR #	Description	code	USD
5523-0322	Cable, 3cond. plus shield, 22 AWG, black/red	159 000 761	3.00

Turbine Flow Sensors

Type 2100

G



Flow:

- Installs into pipe sizes: 0.5 in, DN15 Hose size: DN8, 1/4 in., DN10, 3/8 in., DN15, 0.5 in.
- Operating range 0.38 to 38 lpm, 0.8 to 10 gpm
- Max Pressure rating: 16 bar @ 20 °C, 232 psi @ 68 °F
- Power source: 5 to 24 VDC, 1.5mA max
- Compatibility: 8550, 8900, 9900, 9900-1BC
- *End connector kits must be ordered separately. See accessories
- *-H version can be used with flare fitting. Flow range: 3 - 27 lpm

	MFR #	Description	Flow Range	code	USD
*	3-2100-1L	FPM o-ring	0.38-3.8 lpm (0.10-1 gpm)	159 000 001	303.00
*	3-2100-2L	EPDM o-ring	0.38-3.8 lpm (0.10-1 gpm)	159 000 003	303.00
*	3-2100-1H	FPM o-ring	3.0-38.0 lpm (0.8-10 gpm)	159 000 002	303.00
*	3-2100-2H	EPDM o-ring	3.0-38.0 lpm (0.8-10 gpm)	159 000 004	303.00

End fittings for 2100

G

MFR #	Description	Material	Size	code	USD
3-2100-31	Hose barb connector kit	PVDF	1/2"	159 000 005	38.00
3-2100-32	Hose barb connector kit	PVDF	3/8"	159 000 006	38.00
3-2100-33	Hose barb connector kit	PVDF	1/4"	159 000 007	38.00
3-2100-34	Fusion socket-connector kit	PVDF	DN15 1/2"	159 000 008	38.00
3-2100-35	Butt Fusion / IR connector kit	PVDF	DN15 1/2"	159 000 009	38.00
3-2100-36	Metric socket connector kit	PVC	1/2"	159 000 010	12.00
3-2100-37	SCH 80 socket-connector kit	PVC	1/2"	159 000 011	12.00
3-2100-38	NPT threaded socket connector kit	PVC	1/2"	159 000 012	14.00

Spare Parts for 2100

G

MFR #	Description	For Type	code	USD
1220-0018	O-rings FPM (2 required per sensor)	2100	159 000 019	4.00
1224-0018	O-rings EPDM (2 required per sensor)	2100	159 000 020	9.00
3-8050-1	Universal Mount Junction Box	8000 series	159 000 753	106.00

In-line Rotor Flow Sensors

Type 2000 Micro-Flow

G



Flow:

- Installs into pipe sizes: 0.25 NPT or ISO7/1-R1/4 Threads
- Operating range: 0.11 to 12.11 lpm, 0.03 to 3.2 U.S. gpm
- Max Pressure rating: 0 °C to 80 °C 5.5 bar, 32 °F to 176 °F at 80 psi max
- Power source: 5 to 24 VDC @ 10 mA
- Compatibility: 8550, 8900, 9900, 9900-1BC

MFR #	Description	Flow Range [l/min]	code	USD
3-2000-11	0.25 NPT threads	0 - 3	198 822 000	427.00
3-2000-12	ISO 7/1-R1/4 threads	0 - 3	198 822 001	427.00
3-2000-21	0.25 NPT threads	1 - 12	198 822 002	427.00
3-2000-22	ISO 7/1-R1/4 threads	1 - 12	198 822 003	427.00

Spare Parts for 2000

G

MFR #	Description	For Type	code	USD
3-2000.390	Replacement rotor kit	2000	159 000 248	47.00
1220-0029	Cover O-ring	2000	198 820 049	3.00
2450-0620	Cover screw	2000	198 820 051	4.00
5523-0222	Cable (2 Conductor, shield)		159 000 392	3.00
3-8050-1	Universal Mount Junction Box	8000 series	159 000 753	106.00



Type 2507 Mini-Flow

G

Flow:

- Installs into pipe sizes: G 1/4 in, 1/4 NPT
- Operating range: 400 to 12,000 ml/m (0.1 to 3.2 U.S. gpm)
- Max Pressure rating: 5.5 bar @ 24 °C, 80 psi @ 75 °F
- Power source: 5 to 24 VDC @ 10 mA
- Compatibility: 8550, 8900, 9900, 9900-1BC

MFR #	Description	Flow Range [l/min]	code	USD
	1mm insert (available through Georg Fischer DZS only)	0.1 - 2.0	198 801 731	Call
3-2507.100-2V	2mm insert	0.4 - 2.8	198 801 732	909.00
3-2507.100-3V	3 mm insert	0.7- 4.2	198 801 733	909.00
3-2507.100-4V	4 mm insert	1.3 - 6.0	198 801 734	909.00
3-2507.100-6V	6 mm inlet, no insert	3.2 - 12.0	198 801 736	909.00

Spare Parts for 2507

G

MFR #	Description	code	USD
3-2507.080-2	Rotor	198 801 550	137.00
3-2507.080-3	Quad Ring	198 801 547	127.00
3-2507.080-5	DIN Connector	198 801 508	25.00
3-2507.081-2	2 mm Insert	198 801 502	39.00
3-2507.081-3	3 mm Insert	198 801 503	39.00
3-2507.081-4	4 mm Insert	198 801 558	39.00
5523-0222	Cable (2 Conductor, shield)	159 000 392	3.00

Insertion Magmeter Type 2551



Type 2551 Magmeter; Blind Version Frequency or Digital (S³L) output

G

Flow:

- Installs into pipe sizes: DN15 to DN900, 0.5 to 36 in
- Operating range: 0.05 to 10 m/s, 0.15 to 33 ft/s
- Max Pressure rating: PP 10.3 bar @ 25 °C, 150 psi @ 77 °F
- Power Source: Frequency: 5 to 24 VDC, 15 mA max.
Digital (S³L): 5 to 6.5 VDC, 15 mA max.
- Compatibility: 8550, 8900, 9900, 9900-1BC
- *Only Signet installation fittings

MFR #	Body	Electrode	Pipe Size [inch]	Sensor Type	Code	USD
3-2551-P0-11	PP	316L SS	0.5 - 4.0	-X0	159 001 105	1,033.00
3-2551-P1-11	PP	316L SS	5.0 - 8.0	-X1	159 001 106	1,063.00
3-2551-P2-11	PP	316L SS	10.0 - 36.0	-X2	159 001 107	1,478.00
3-2551-T0-11	PVDF	Titanium	0.5 - 4.0	-X0	159 001 108	1,478.00
3-2551-T1-11	PVDF	Titanium	5.0 - 8.0	-X1	159 001 109	1,507.00
3-2551-T2-11	PVDF	Titanium	10.0 - 36.0	-X2	159 001 448	1,924.00
3-2551-V0-11	PVDF	Hastelloy-C	0.5 - 4.0	-X0	159 001 257	1,402.00
3-2551-V1-11	PVDF	Hastelloy-C	5.0 - 8.0	-X1	159 001 258	1,998.00
3-2551-V2-11	PVDF	Hastelloy-C	10.0 - 36.0	-X2	159 001 450	1,924.00



Type 2551 Magmeter, Blind Version

G

Flow:

- Installs into pipe sizes: DN15 to DN900, 0.5 to 36 in
- Operating range: 0.05 to 10 m/s, 0.15 to 33 ft/s
- Max Pressure rating: PP 10.3 bar @ 25 °C, 150 psi @ 77 °F
- Power source: 4 to 20 mA: 21.6 to 26.4 VDC, 21.1mA max
- *Only Signet installation fittings

MFR #	Body	Electrode	Pipe Size [inch]	Sensor Type	Code	USD
3-2551-P0-12	PP	316L SS	0.5 - 4.0	-X0	159 001 110	1,033.00
3-2551-P1-12	PP	316L SS	5.0 - 8.0	-X1	159 001 111	1,063.00
3-2551-P2-12	PP	316L SS	10.0 - 36.0	-X2	159 001 112	1,589.00
3-2551-T0-12	PVDF	Titanium	0.5 - 4.0	-X0	159 001 113	1,478.00
3-2551-T1-12	PVDF	Titanium	5.0 - 8.0	-X1	159 001 114	1,507.00
3-2551-T2-12	PVDF	Titanium	10.0 - 36.0	-X2	159 001 449	2,034.00
3-2551-V0-12	PVDF	Hastelloy-C	0.5 - 4.0	-X0	159 001 259	1,402.00
3-2551-V1-12	PVDF	Hastelloy-C	5.0 - 8.0	-X1	159 001 260	1,432.00
3-2551-V2-12	PVDF	Hastelloy-C	10.0 - 36.0	-X2	159 001 451	2,034.00



Type 2551 Magmeter; Display Version with relays

G

Flow:

- Installs into pipe sizes: DN15 to DN900, 0.5 to 36 in
- Operating range: 0.05 to 10 m/s, 0.15 to 33 ft/s
- Max Pressure rating: PP 10.3 bar @ 25 °C, 150 psi @ 77 °F
- Power source: 4 to 20 mA, 21.6 to 26.4 VDC, 22.1 mA max
Aux Power for relays, 9 to 24 VDC, 0.4A max
- *Only Signet installation fittings

MFR #	Body	Electrode	Pipe Size [inch]	Sensor Type	Code	USD
3-2551-P0-22	PP	316L SS	1 - 4	-X0	159 001 273	1,959.00
3-2551-P1-22	PP	316L SS	5 - 8	-X1	159 001 274	1,989.00
3-2551-P2-22	PP	316L SS	10 - 36	-X2	159 001 438	2,525.00
3-2551-T0-22	PVDF	Titanium	1 - 4	-X0	159 001 439	2,525.00
3-2551-T1-22	PVDF	Titanium	5 - 8	-X1	159 001 440 *	2,554.00
3-2551-T2-22	PVDF	Titanium	10 - 36	-X2	159 001 455	2,969.00
3-2551-V0-22	PVDF	Hastelloy-C	1 - 4	-X0	159 001 275	2,332.00
3-2551-V1-22	PVDF	Hastelloy-C	5 - 8	-X1	159 001 276	2,362.00
3-2551-V2-22	PVDF	Hastelloy-C	10 - 36	-X2	159 001 457	2,969.00



Type 2551 Magmeter; Display Version no relays

G

Flow:

- Installs into pipe sizes: DN15 to DN900, 0.5 to 36 in
- Operating range: 0.05 to 10 m/s, 0.15 to 33 ft/s
- Max Pressure rating: PP 10.3 bar @ 25 °C, 150 psi @ 77 °F
- Power source: 4 to 20 mA: 21.6 to 26.4 VDC, 21.1mA max
- *Only Signet installation fittings

MFR #	Body	Electrode	Pipe Size [inch]	Sensor Type	Code	USD
3-2551-P0-42	PP	316L SS	0.5 - 4.0	-X0	159 001 279	1,626.00
3-2551-P1-42	PP	316L SS	5.0 - 8.0	-X1	159 001 280	1,656.00
3-2551-P2-42	PP	316L SS	10.0 - 36.0	-X2	159 001 441	2,071.00
3-2551-T0-42	PVDF	Titanium	0.5 - 4.0	-X0	159 001 442	2,071.00
3-2551-T1-42	PVDF	Titanium	5.0 - 8.0	-X1	159 001 443	2,101.00

table continued next page

^ = 40% Restock Charge

* = Non-Cancelable/Non-Returnable

MFR #	Body	Electrode	Pipe Size [inch]	Sensor Type	Code	USD
3-2551-T2-42	PVDF	Titanium	10.0 - 36.0	-X2	159 001 461	2,516.00
3-2551-V0-42	PVDF	Hastelloy-C	0.5 - 4.0	-X0	159 001 281	1,998.00
3-2551-V1-42	PVDF	Hastelloy-C	5.0 - 8.0	-X1	159 001 282	2,028.00
3-2551-V2-42	PVDF	Hastelloy-C	10.0 - 36.0	-X2	159 001 463	2,516.00

Type 2551 Magmeter, Display Version no Relays Frequency or Digital (S³L) output

G



Flow:

- Installs into pipe sizes: DN15 to DN900, 0.5 to 36 in
- Operating range: 0.05 to 10 m/s, 0.15 to 33 ft/s
- Max Pressure rating: PP 10.3 bar @ 25 °C, 150 psi @ 77 °F
- Power Source: Frequency: 5 to 24 VDC, 15 mA max.
Digital (S³L): 5 to 6.5 VDC, 15 mA max.
- Compatibility: 8550, 8900, 9900, 9900-1BC
- *Only Signet installation fittings

MFR #	Body	Electrode	Pipe Size [inch]	Sensor Type	Code	USD
3-2551-P0-41	PP	316L SS	0.5 - 4.0	-X0	159 001 261	1,515.00
3-2551-P1-41	PP	316L SS	5.0 - 8.0	-X1	159 001 262	1,545.00
3-2551-P2-41	PP	316L SS	10.0 - 36.0	-X2	159 001 432	1,959.00
3-2551-T0-41	PVDF	Titanium	0.5 - 4.0	-X0	159 001 433	1,959.00
3-2551-T1-41	PVDF	Titanium	5.0 - 8.0	-X1	159 001 434	1,989.00
3-2551-T2-41	PVDF	Titanium	10.0 - 36.0	-X2	159 001 460 *	2,405.00
3-2551-V0-41	PVDF	Hastelloy-C	0.5 - 4.0	-X0	159 001 263	1,886.00
3-2551-V1-41	PVDF	Hastelloy-C	5.0 - 8.0	-X1	159 001 264 *	1,917.00
3-2551-V2-41	PVDF	Hastelloy-C	10.0 - 36.0	-X2	159 001 462	2,405.00

Type 2551 Magmeter; Display Version with relays Frequency or Digital (S³L) output

G



Flow:

- Installs into pipe sizes: DN15 to DN900, 0.5 to 36 in
- Operating range: 0.05 to 10 m/s, 0.15 to 33 ft/s
- Max Pressure rating: PP 10.3 bar @ 25 °C, 150 psi @ 77 °F
- Power Source: Frequency: 5 to 24 VDC, 15 mA max.
Digital (S³L): 5 to 6.5 VDC, 15 mA max.
- Compatibility: 8550, 8900, 9900, 9900-1BC
- *Only Signet installation fittings

MFR #	Body	Electrode	Pipe Size [inch]	Sensor Type	Code	USD
3-2551-P0-21	PP	316L SS	0.5 - 4.0	-X0	159 001 267	1,849.00
3-2551-P1-21	PP	316L SS	5.0 - 8.0	-X1	159 001 268	1,878.00
3-2551-P2-21	PP	316L SS	10.0 - 36.0	-X2	159 001 435	2,413.00
3-2551-T0-21	PVDF	Titanium	0.5 - 4.0	-X0	159 001 436	2,413.00
3-2551-T2-21	PVDF	Titanium	5.0 - 8.0	-X1	159 001 437 *	2,443.00
3-2551-T2-21	PVDF	Titanium	10.0 - 36.0	-X2	159 001 454 *	2,859.00
3-2551-V0-21	PVDF	Hastelloy-C	0.5 - 4.0	-X0	159 001 269	2,222.00
3-2551-V1-21	PVDF	Hastelloy-C	5.0 - 8.0	-X1	159 001 270 *	2,251.00
3-2551-V2-21	PVDF	Hastelloy-C	10.0 - 36.0	-X2	159 001 456	2,859.00

Spare Parts for 2551

G

MFR #	Description	Code	USD
3-2551-P0	PP/316L SS, DN15 to DN100 (½ to 4 in.) pipe	159 001 211	609.00
3-2551-P1	PP/316L SS, DN125 to DN200 (5 to 8 in.) pipe	159 001 212	613.00
3-2551-P2	PP/316L SS, DN250 to DN900 (10 to 36 in.) pipe	159 001 444	996.00
3-2551-T0	PVDF/Titanium, DN15 to DN100 (½ to 4 in.) pipe	159 001 213	996.00
3-2551-T1	PVDF/Titanium, DN125 to DN200 (5 to 8 in.) pipe	159 001 214	1,025.00
3-2551-T2	PVDF/Titanium, DN250 to DN900 (10 to 36 in.) pipe	159 001 445	1,441.00
3-2551-V0	PVDF/Hastelloy-C, DN15 to DN100 (½ to 4 in.) pipe	159 001 376	1,149.00
3-2551-V1	PVDF/Hastelloy-C, DN125 to DN200 (5 to 8 in.) pipe	159 001 377	850.00
3-2551-V2	PVDF/Hastelloy-C, DN250 to DN900 (10 to 36 in.) pipe	159 001 446	1,515.00
3-2551-11	Magmeter electronics, frequency or digital (S ³ L) output	159 001 215	486.00
3-2551-12	Magmeter electronics, 4 to 20 mA output	159 001 216	482.00
1220-0021	O-ring, FPM (2 req'd per sensor)	198 801 000	4.00
1224-0021	O-ring, EPR (EPDM) (2 req'd per sensor)	198 820 006	9.00
1228-0021	O-ring, FFPM (2 req'd per sensor)	198 820 007	195.00
3-0250	USB to Digital (S ³ L) Configuration/Diagnostic Tool	159 001 538	251.00
3-2551-21	Electronics only, display w/relays	159 001 372	1,418.00
3-2551-22	Electronics only, display w/relays/4-20mA	159 001 373	1,531.00
3-2551-41	Electronics only, display w/freq or dig	159 001 374	966.00
3-2551-42	Electronics only, display w/4-20mA	159 001 375	1,078.00
3-8551.521	Clear plastic cap for display	159 001 378	Call
1222-0042	O-ring for clear plastic cap, EPR (EPDM)	159 001 379	7.00
3-8050.390-1	Retaining nut replacement kit, Valox K4530	159 001 702	26.00
3-8050.390-3	Replacement nut replacement kit, NPT, PP	159 310 116	32.00
3-8050.390-4	Replacement nut replacement kit, NPT, PVDF	159 310 117	52.00

Type 2552

Type 2552 Magmeter Current output (4 to 20 mA)

G



Flow:

- Installs into pipe sizes: 2 to 102in, DN50 to DN250
- Operating range: 0.05 to 10 m/s, 0.15 to 33 ft/s
- Max Pressure rating: PP 10.3 bar @ 25 °C, 150 psi @ 77 °F
- Power source: 4 to 20 mA: 21.6 to 26.4 VDC, 21.1 mA max

MFR #	Mounting	Connection	Code	USD
3-2552-21-A-12	9.4 in. depth	1 1/4 in. NPT	159 001 514	2,141.00
3-2552-21-B-12	9.4 in. depth	1 1/4 in. NPT	159 001 516	2,141.00
3-2552-22-A-12	9.4 in. depth	1 1/4 in. ISO	159 001 518	2,141.00
3-2552-22-B-12	9.4 in. depth	1 1/4 in. ISO	159 001 520	2,141.00
3-2552-33-A-12	14.8 in. depth	1 1/2 in. NPT	159 001 525	3,581.00
3-2552-33-B-12	14.8 in. depth	1 1/2 in. NPT	159 001 527	3,581.00
3-2552-34-A-12	14.8 in. depth	1 1/2 in. ISO	159 001 526	3,581.00
3-2552-34-B-12	14.8 in. depth	1 1/2 in. ISO	159 001 528 *	3,581.00



Type 2552 Magmeter Frequency or Digital (S³L) output

Flow:

- Installs into pipe sizes: 2 to 102 in., DN50 to DN250
- Operating range: 0.05 to 10 m/s, 0.15 to 33 ft/s
- Max Pressure rating: PP 10.3 bar @ 25 °C, 150 psi @ 77 °F
- Power source: 5 to 26.4 VDC, 15 mA max
- Compatibility: 8550, 8900, 9900, 9900-1BC

MFR #	Mounting	Connection	Code	USD
3-2552-21-A-11	9.4 in. depth	1 1/4 in. NPT	159 001 513	2,000.00
3-2552-21-B-11	9.4 in. depth	1 1/4 in. NPT	159 001 515	2,000.00
3-2552-22-A-11	9.4 in. depth	1 1/4 in. ISO	159 001 517	2,000.00
3-2552-22-B-11	9.4 in. depth	1 1/4 in. ISO	159 001 519	2,000.00
3-2552-33-A-11	14.8 in. depth	1 1/2 in. NPT	159 001 521	3,445.00
3-2552-33-B-11	14.8 in. depth	1 1/2 in. NPT	159 001 523	3,445.00
3-2552-34-A-11	14.8 in. depth	1 1/2 in. ISO	159 001 522	3,445.00
3-2552-34-B-11	14.8 in. depth	1 1/2 in. ISO	159 001 524	3,445.00

Spare Parts for 2552

G

MFR #	Description	Code	USD
2120-1512	1½ x 1¼ in. NPT adapter - 316 SS	159 001 425	55.00
2120-2012	2 x 1¼ in. NPT adapter - 316 SS	159 001 426	55.00
3-2552.392	1¼ in. NPT SS ball valve & nipple kit	159 001 530	535.00
3-2552.393	1¼ in. NPT brass ball valve & nipple kit	159 001 531	268.00
3-2552.394	1½ in. NPT conduit adapter for -2 units	159 001 532	74.00
4301-2125	1¼ in. NPT valve - brass	159 001 533	220.00
4301-3125	1¼ in. NPT valve - SS	159 001 387	486.00
5541-4184	4-conductor, 22 AWG, wtr-tight cntr, 4 m (13 ft)	159 001 388	134.00
5541-4186	4-conductor, 22 AWG, wtr-tight cntr, 6 m (19.5 ft)	159 001 389	178.00
Special Order	4-conductor, 22 AWG, wtr-tight cntr	Special Order	Call
3-0250	USB to Digital (S ³ L) Configuration/Diagnostic Tool	159 001 538	251.00

O-Rings and Gaskets

G

MFR #	Description	Code	USD	For Type
1220-0018	O-rings FPM (2 required per sensor)	159 000 019	4.00	2100
1220-0021	O-ring, FPM (2 req'd per sensor)	198 801 000	4.00	515, 2536, 2537
1220-0029	Cover O-ring	198 820 049	3.00	2000
1224-0018	O-rings EPDM (2 required per sensor)	159 000 020	9.00	2100
1224-0021	O-ring, EPR (EPDM) (2 req'd per sensor)	198 820 006	9.00	515, 2536, 2537
1228-0021	O-ring, FPM (2 req'd per sensor)	198 820 007	195.00	515, 2536, 2537
3-2507.080-3	Quad Ring	198 801 547	127.00	525
P52618	Gasket	159 000 493	10.00	

Miscellaneous

G

MFR #	Description	Code	USD	For Type
3-8050	Universal Mount Kit	159 000 184	66.00	8000 series
P31520-1V	Pipe Adapter Insert, PVDF	159 000 460 *	165.00	5 in. to 8 in. pipe fittings
P31520-2P	Pipe Adapter Insert, PVC	159 000 461 *	349.00	5 in. to 8 in. pipe fittings
P31536	Sensor Plug, PP	198 840 201	65.00	515, 2536
P31542	Sensor Cap, Red	198 801 630	16.00	515
P31542-3	Sensor Cap, Blue	159 000 464	16.00	2536
P31671-1	Pipe Adapter Insert, PVDF 1.5 in.	159 000 465	Call	1 .5 in. pipe fittings
P31934	Conduit Cap	159 000 466	16.00	515, 2536
2450-0620	Cover screw	198 820 051	4.00	2000
3-2541.260-1	Standard module	159 000 849	327.00	2540
3-2541.260-2	Hot-Tap module	159 000 850	406.00	2540
P52527	Retainers, Stainless steel	159 000 481	10.00	525, 2540
P52628	Fitting cap kit (cap and gasket)	159 000 504	88.00	525
5523-0322	Cable, 3cond. plus shield, 22 AWG, black/red	159 000 761	3.00	
5523-3222	Cable (per foot) 2 cond. w/shield, 22 AWG	159 000 393	3.00	525
3-8051	Integral Adapter	159 000 187	66.00	515, 2536

Ultrasonic flow

Portaflow 330/220 “clamp-on” portable flowmeter

H



Model:

- Includes transducer guide rail and all mounting hardware
- Carrying case, cables, manual and other ancillary equipment
- Portaflow 330 comes with built-in data logger

d-d [mm]	330 A+B Part No.	USD	220 A Part No.	USD
13 - 2000	159 300 001	8,795.00	159 300 002	4,283.00
	220 B Part No.	USD		
	159 300 003	5,092.00		



Ultraflo 3000/4000 Ultrasonic flow transmitter

H

Model:

- Includes transducer guide rail and all mounting hardware
- Enclosure rating IP65
- Ultraflo 4000 comes with a built-in data logger

For type B please state with your order: - Cable length: 5 or 10 meter - Liquid temperature °C: - Liquid type: - Pipe size (d): - Pipe wall thickness (mm):

d-d [mm]	Voltage	3000 A Part No.	USD	
13 - 115	230V AC	159 300 004	4,051.00	
50 - 2000	24 V DC	159 300 005	4,051.00	
3000 B Part No.	USD	4000 A Part No.	USD	
159 300 006	4,167.00	159 300 008	4,862.00	
159 300 007	4,167.00	159 300 009	4,862.00	
4000 B Part No.	USD			
159 300 010	4,977.00			
159 300 011	4,977.00			



Ultrasonic thickness gauge

H

Part No.	USD	
159 300 012	771.00	



U1000 compact "clamp-on" flow sensor display version 4-20 mA and pulse output

Model:

- Principle: non-contact ultrasonic transit time
- Pipe size [d]: 1" - 4"
- Pipe materials: Plastic and steel
- Output: 4-20 mA, 4-wire, Pulse 200Hz max.
- Integrated display and programming buttons
- Supply power: 12-24 V AC/DC

MFR #	Measuring range	code	USD
U1000-1	0.1 - 10 m/s, 0.3-33 FPS	159 300 085	1,867.00

pH/ORP Preamplifiers

Type 2750 pH/ORP Sensor Electronics

pH/ORP:

G



- Connection: Durable DryLoc® with fold plated connections
- Compatible Sensors: 2724 - 2726, 2734 - 2736, 2756 - 2757 Wet-Tap, 2764 - 2767, 2774 - 2777
- Compatible Instruments: Signet 8900 or 9900
- Additional Features: Options for (S³L) and 4 - 20 mA outputs
- Mounting styles: In-line integral mount and submersion



MFR #	Mounting	Connection	Code	USD
3-2750-2	In-line with EasyCal	DryLoc	159 000 745	493.00
3-2750-1	In-line	DryLoc	159 000 744	449.00
3-2750-3	NPT, submersible	DryLoc	159 000 746	425.00
3-2750-4	ISO, submersible	DryLoc	159 000 842	425.00

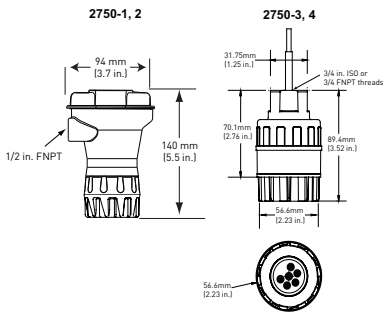

Type 2760 pH/ORP Preamp

G

pH/ORP:



- Compatible Instruments: Signet 8750
- Connection: Durable DryLoc® with fold plated connections
- Mounting styles: In-line integral mount and submersion
- Compatible sensors: 2724 - 2726, 2735, 2756 - 2757 Wet-Tap, 2764 - 2767, 2774 - 2777



MFR #	Description	Mounting	Connection	Code	USD
3-2760-1	Preamplifier	NPT, submersible	DryLoc	159 000 939	282.00
3-2760-2	Preamplifier	ISO, submersible	DryLoc	159 000 940	282.00
3-2760-3	Connector	NPT, submersible	DryLoc	159 000 941 *	219.00
3-2760-4	Connector	ISO, submersible	DryLoc	159 000 942 *	219.00
3-2760-11	Preamplifier	NPT, in-line	DryLoc	159 001 367	282.00
3-2760-21	Preamplifier	ISO, in-line	DryLoc	159 001 368	282.00
3-2760-31	Connector	NPT, in-line	DryLoc	159 001 369 *	219.00
3-2760-41	Connector	ISO, in-line	DryLoc	159 001 370 *	219.00

Type 2721 Remote pH/ORP Preamplifier

G



pH/ORP:

- Input Power: ± 4.5 to ± 8 VDC dual supply (provided by Signet pH/ORP instruments)
- Material: Housing low density polyethylene
- Compatible Instruments: Signet 8750

MFR #	Description	Mounting	Connection	Code	USD	For Type
3-2721	Preamplifier	Remote mount	Twist Lock	198 864 610	155.00	8750

Electrodes

Type 2724/2726 DryLoc pH/ORP Electrodes (Non returnable)

G



pH/ORP:

- Wetted Materials: Ryton, UHMW polyethylene, FPM, glass
- Connection: Durable DryLoc® with fold plated connections
- Compatible Preamp/Sensor Electronics: 2750 and 2760
- Compatible Instruments: Use the 2760 preamplifier with the Signet 8750; Use the 2750 sensor electronics with the Signet 8900 or the 9900 Transmitter
- Additional Features: HF and LC options available
- In-line Mounting styles: Standard 3/4 inch or ISO threaded fittings
- Submersible mounting: Available using the back of the preamplifier or sensor electronics
- Applications: Water treatment, water quality monitoring, etc.

MFR #	Electrode	Style	Temperature Compensation	Process Connection	Code	USD
3-2724-00	pH	Flat	PT1000	3/4 in. MNPT, thread	159 001 545 *	324.00
3-2724-01	pH	Flat	PT1000	ISO 7/1-R 3/4 thread	159 001 546 *	324.00
3-2724-10	pH	Flat	3K	3/4 in. MNPT, thread	159 001 547 *	324.00
3-2724-11	pH	Flat	3K	ISO 7/1-R 3/4 thread	159 001 548 *	324.00
3-2725-60	ORP	Flat		3/4 in. MNPT, thread	159 001 561 *	350.00
3-2725-61	ORP	Flat		ISO 7/1-R 3/4 thread	159 001 562 *	350.00
3-2726-00	pH	Bulb	PT1000	3/4 in. MNPT, thread	159 001 553 *	275.00
3-2726-01	pH	Bulb	PT1000	ISO 7/1-R 3/4 thread	159 001 554 *	275.00
3-2726-10	pH	Bulb	3K	3/4 in. MNPT, thread	159 001 555 *	275.00
3-2726-11	pH	Bulb	3K	ISO 7/1-R 3/4 thread	159 001 556 *	275.00
3-2726-HF-00	pH	Bulb, HF resist	PT1000	3/4 in. MNPT, thread	159 001 549 *	397.00
3-2726-HF-01	pH	Bulb, HF resist	PT1000	ISO 7/1-R 3/4 thread	159 001 550 *	397.00
3-2726-HF-10	pH	Bulb, HF resist	3K	3/4 in. MNPT, thread	159 001 551 *	397.00
3-2726-HF-11	pH	Bulb, HF resist	3K	ISO 7/1-R 3/4 thread	159 001 552 *	397.00
3-2726-LC-00	pH	Bulb, Low Conductivity	PT1000	3/4 in. MNPT, thread	159 001 557 *	324.00
3-2726-LC-01	pH	Bulb, Low Conductivity	PT1000	ISO 7/1-R 3/4 thread	159 001 558 *	324.00
3-2726-LC-10	pH	Bulb, Low Conductivity	3K	3/4 in. MNPT, thread	159 001 559 *	324.00
3-2726-LC-11	pH	Bulb, Low Conductivity	3K	ISO 7/1-R 3/4 thread	159 001 560 *	324.00
3-2724-HF-10	pH	Flat, HF resistant	3K	3/4 in. NPT, thread	159 001 771	447.00
3-2724-HF-11	pH	Flat, pH resistant	3K	ISO 7/1-R 3/4 thread	159 001 772	447.00

Type 2734/2736 DryLoc pH/ORP

G

Electrodes



pH/ORP:

- Patented reference design for exceptional performance
- Special design allows for installation at any angle, even inverted or horizontal
- Ryton® (PPS) body and PTFE junction for broad range of chemical compatibility
- Patented DryLoc® connector with gold plated contacts
- Quick temperature response

MFR #	Electrode	Style	Temperature Compensation	Process Connection	Code	USD
3-2734-00	pH	Flat	PT1000	3/4 in. NPT, thread	159 001 774 *	482.00
3-2734-01	pH	Flat	PT1000	ISO 7/1-R 3/4 thread	159 001 775 *	482.00
3-2734-HF-00	pH	Flat, HF resist	PT1000	3/4 in. NPT, thread	159 001 776 *	539.00
3-2734-HF-01	pH	Flat, HF resist	PT1000	ISO 7/1-R 3/4 thread	159 001 777 *	539.00
3-2736-00	pH	Bulb	PT1000	3/4 in. NPT, thread	159 001 778 *	453.00
3-2736-01	pH	Bulb	PT1000	ISO 7/1-R 3/4 thread	159 001 779 *	453.00
3-2736-HF-00	pH	Bulb, HF resist	PT1000	3/4 in. NPT, thread	159 001 780 *	539.00
3-2736-HF-01	pH	Bulb, HF resist	PT1000	ISO 7/1-R 3/4 thread	159 001 781 *	539.00
3-2735-60	ORP	Flat, 10K		3/4 in. NPT, thread	159 001 782 *	510.00
3-2735-61	ORP	Flat, 10K		ISO 7/1-R 3/4 thread	159 001 783 *	510.00

Type 2756-WT Wet-Tap DryLoc pH Electrodes

G



	MFR #	Style	Compatible Pre-amplifier	Code	USD
*	3-2756-WT	Bulb, Wet-Tap	2750 DryLoc	159 000 834 *	379.00
*	3-2756-WT-1	Bulb, Wet-Tap	2760 DryLoc	159 001 383 *	379.00
*	3-2756-WTP	Bulb, Plastic Wet-Tap	2750 DryLoc	159 001 390 *	379.00
*	3-2756-WTP-1	Bulb, Plastic Wet-Tap	2760 DryLoc	159 001 384 *	379.00



Type 2757-WT Wet-Tap DryLoc ORP Electrodes

G

	MFR #	Style	Compatible Preamplifier	Code	USD
*	3-2757-WT	Bulb, Wet-Tap	2750, 2760 DryLoc	159 000 835 *	423.00
*	3-2757-WTP	Bulb, Plastic Wet-Tap	2750, 2760 DryLoc	159 001 391 *	423.00



Type 2764/2766 DryLoc pH Electrodes

G

pH/ORP:

- Wetted Materials: Ryton, PTFE, FPM, carbon graphite, glass
- Connection: Durable DryLoc® with fold plated connections
- Compatible Preamp/Sensor Electronics: 2750 and 2760
- Compatible Instruments: Use the 2760 preamplifier with the Signet 8750; Use the 2750 sensor electronics with the Signet 8900 or the 9900 Transmitter
- Additional Features: Differential reference for additional protection in harsh chemicals; also quick temperature response
- In-line Mounting styles: Use the sensors 1 inch thread to mount to any in-line tee
- Submersible mounting: Available using the back of the preamplifier or sensor electronics
- Applications: Water treatment, water quality monitoring, scrubbers, heavy metal removal, harsh chemicals, etc.

	MFR #	Style	Compatible Preamplifier	Mounting	Code	USD
*	3-2764-1	Flat	2760 DryLoc	with threaded connection	159 000 943 *	526.00
*	3-2764-2	Flat	2750 DryLoc	with threaded connection	159 000 944 *	538.00
*	3-2764-3	Flat	2750, 2760 DryLoc	with threaded connection	159 000 945 *	526.00
*	3-2766-1	Bulb	2760 DryLoc	with threaded connection	159 000 949 *	496.00
*	3-2766-2	Bulb	2750 DryLoc	with threaded connection	159 000 950 *	508.00
*	3-2766-3	Bulb	2750, 2760 DryLoc	with threaded connection	159 000 951	496.00

Type 2765/2767 DryLoc ORP Electrodes

G



pH/ORP:

- Wetted Materials: Ryton, PTFE, FPM, carbon graphite, glass
- Connection: Durable DryLoc® with fold plated connections
- Compatible Preamp/Sensor Electronics: 2750 and 2760
- Compatible Instruments: Use the 2760 preamplifier with the Signet 8750; Use the 2750 sensor electronics with the Signet 8900 or the 9900 Transmitter
- Additional Features: Differential reference for additional protection in harsh chemicals; also quick temperature response
- In-line Mounting styles: Use the sensors 1 inch thread to mount to any in-line tee
- Submersible mounting: Available using the back of the preamplifier or sensor electronics
- Applications: Water treatment, water quality monitoring, scrubbers, heavy metal removal, harsh chemicals, etc.

	MFR #	Style	Compatible Preamplifier	Mounting	Code	USD
*	3-2765-1	Flat	2750, 2760 DryLoc	with threaded connection	159 000 946 *	565.00
*	3-2765-2	Flat	2750, 2760 DryLoc	with threaded connection	159 000 947 *	578.00
*	3-2765-3	Flat	2750, 2760 DryLoc	with threaded connection	159 000 948 *	565.00
*	3-2767-1	Bulb	2750, 2760 DryLoc	with threaded connection	159 000 952 *	536.00
*	3-2767-2	Bulb	2750, 2760 DryLoc	with threaded connection	159 000 953 *	547.00
*	3-2767-3	Bulb	2750, 2760 DryLoc	with threaded connection	159 000 954 *	536.00

Type 2774/2776 DryLoc pH Electrodes

G



pH/ORP:

- Wetted Materials: Ryton, PTFE, FPM, glass
- Connection: Durable DryLoc® with fold plated connections
- Compatible Preamp/Sensor Electronics: 2750 and 2760
- Compatible Instruments: Use the 2760 preamplifier with the Signet 8750; Use the 2750 sensor electronics with the Signet 8900 or the 9900 Transmitter
- Additional Features: Quick temperature response and can be mounted upside-down
- In-line Mounting styles: Standard 3/4 inch or ISO threaded fittings
- Submersible mounting: Available using the back of the preamplifier or sensor electronics
- Applications: Water treatment, water quality monitoring, some harsh chemicals

	MFR #	Style	Compatible Preamplifier	Mounting	Code	USD
*	3-2774	Flat	2760 DryLoc	with threaded connection	159 000 955 *	450.00
*	3-2774-1	Flat	2750 DryLoc	with threaded connection	159 000 956 *	450.00
*	3-2776	Bulb	2760 DryLoc	with threaded connection	159 000 959 *	406.00
*	3-2776-1	Bulb	2750 DryLoc	with threaded connection	159 000 960 *	406.00



Type 2775/2777 DryLoc ORP Electrodes

G

pH/ORP:

- Wetted Materials: Ryton, PTFE, FPM, glass
- Connection: Durable DryLoc® with fold plated connections
- Compatible Preamp/Sensor Electronics: 2750 and 2760
- Compatible Instruments: Use the 2760 preamplifier with the Signet 8750; Use the 2750 sensor electronics with the Signet 8900 or the 9900 Transmitter
- Additional Features: Quick temperature response and can be mounted upside-down
- In-line Mounting styles: Use the sensors 3/4 inch thread to mount to any in-line tee
- Submersible mounting: Available using the back of the preamplifier or sensor electronics
- Applications: Water treatment, water quality monitoring, some harsh chemicals

	MFR #	Style	Compatible Preamplifier	Mounting	Code	USD
*	3-2775	Flat	2750, 2760 DryLoc	with threaded connection	159 000 957 *	473.00
*	3-2775-1	Flat	2750, 2760 DryLoc	with threaded connection	159 000 958 *	473.00
*	3-2777	Bulb	2750, 2760 DryLoc	with threaded connection	159 000 961 *	426.00
*	3-2777-1	Bulb	2750, 2760 DryLoc	with threaded connection	159 000 962 *	426.00



Type 3719 pH/ORP Wet-Tap Assembly

G

pH/ORP:

- Wetted Materials: CPVC, FPM
- Connection: 1.5 or 2 inch NPT or ISO Process Threads
- 2756 & 2757 Wet-Tap series electrodes
- Applications: Water treatment, water quality monitoring, etc.

MFR #	Style	Mounting	Code	USD
3-3719-11	Wet-Tap assembly	1.5 inch NPT	159 000 804	935.00
3-3719-12	Wet-Tap assembly	1.5 inch ISO	159 000 806	935.00
3-3719-21	Wet-Tap assembly	2 inch NPT	159 000 805	981.00
3-3719-22	Wet-Tap assembly	2 inch ISO	159 000 807	981.00

Conductivity/Resistivity

Electrodes

Type 2818 Conductivity/Resistivity Electrode

G



MFR #	Cell Constant [cm-1]	Electrode	Mounting	Code	USD
3-2818-1	0.01	316 SST	3/4 inch	159 001 718	446.00

Type 2819 Conductivity/Resistivity Electrode

G



Conductivity/Resistivity:

- Wetted Materials: 316 SST or Titanium
- Process Connection Choices: 3/4 inch threads for In-line or Submersion, 1.5 inch Sanitary Tri-clamp flange and 2 inch Sanitary Tri-clamp flange
- Cell constants and corresponding measuring ranges: 0.01 cm-1 / 0.55 to 100 μ S (18.3 m Ω to 10 K Ω) 0.1 cm-1 / 1 to 1000 μ S (1 m Ω to 1 K Ω) 1.0 cm-1 / 10 to 10,000 μ S (5 to 5,000 ppm) 10.0 cm-1 / 100 to 200,000 μ S (50 to 100,000 ppm) 20.0 cm-1 / 200 to 400,000 μ S (100 to 200,000 ppm)
- Compatible Instruments: Signet Instrument Types: 8850, 8860 8900 or the 9900 with the 2850 Sensor Electronics
- Thread styles are reversible threads or fixed threads

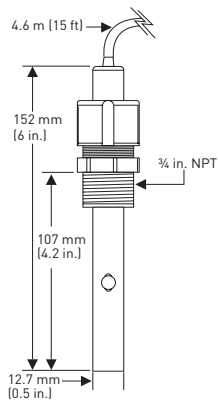

MFR #	Cell Constant [cm-1]	Electrode	Process Connection	Code	USD
3-2819-1	0.01	316 SST	Threaded	198 844 010	392.00
3-2819-1C	0.01	316 SST	Threaded	159 000 651	454.00
3-2819-S1	0.01	316 SST	1.5 inch flange	159 000 085	826.00
3-2819-S1C	0.01	316 SST	1.5 inch flange	159 000 087	900.00
3-2819-S2	0.01	316 SST	2 inch flange	159 000 086	975.00
3-2819-S2C	0.01	316 SST	2 inch flange	159 000 088	1,036.00
3-2819-T1	0.01	Titanium	1.5 inch flange	159 000 081	1,155.00
3-2819-T1C	0.01	Titanium	1.5 inch flange	159 000 083	1,215.00
3-2819-T2	0.01	Titanium	2 inch flange	159 000 082	1,306.00
3-2819-T2C	0.01	Titanium	2 inch flange	159 000 084	1,366.00

Type 2820 Conductivity/Resistivity Electrode

Conductivity/Resistivity:

- Wetted Materials: 316 SST or Titanium
- Process Connection Choices: 3/4 inch threads for In-line or Submersion, 1.5 inch Sanitary Tri-clamp flange and 2 inch Sanitary Tri-clamp flange
- Cell constants and corresponding measuring ranges: 0.01 cm⁻¹ / 0.55 to 100 μS (18.3 mΩ to 10 KΩ) 0.1 cm⁻¹ / 1 to 1000 μS (1 mΩ to 1 KΩ) 1.0 cm⁻¹ / 10 to 10,000 μS (5 to 5,000 ppm) 10.0 cm⁻¹ / 100 to 200,000 μS (50 to 100,000 ppm) 20.0 cm⁻¹ / 200 to 400,000 μS (100 to 200,000 ppm)
- Compatible Instruments: Signet Instrument Types: 8850, 8860 8900 or the 9900 with the 2850 Sensor Electronics
- Thread styles are reversible threads or fixed threads

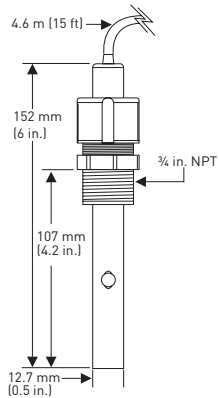

MFR #	Cell Constant [cm ⁻¹]	Electrode	Process Connection	Code	USD
3-2820-1	0.10	316 SST	Threaded	198 844 000	390.00
3-2820-1C	0.10	316 SST	Threaded	159 000 654	460.00
3-2820-S1	0.10	316 SST	1.5 inch flange	159 000 089	785.00
3-2820-S1C	0.10	316 SST	1.5 inch flange	159 000 091	857.00
3-2820-S2	0.10	316 SST	2 inch flange	159 000 090	929.00
3-2820-S2C	0.10	316 SST	2 inch flange	159 000 092	986.00
3-2820-T1	0.10	Titanium	1.5 inch flange	159 000 624	1,099.00
3-2820-T1C	0.10	Titanium	1.5 inch flange	159 000 655	1,158.00
3-2820-T2	0.10	Titanium	2 inch flange	159 000 625	1,243.00
3-2820-T2C	0.10	Titanium	2 inch flange	159 000 656	1,300.00

Type 2821 Conductivity/Resistivity Electrode

G



Conductivity/Resistivity:

- Wetted Materials: 316 SST or Titanium
- Process Connection Choices: 3/4 inch threads for In-line or Submersion, 1.5 inch Sanitary Tri-clamp flange and 2 inch Sanitary Tri-clamp flange
- Cell constants and corresponding measuring ranges: 0.01 cm-1 / 0.55 to 100 μ S (18.3 m Ω to 10 K Ω) 0.1 cm-1 / 1 to 1000 μ S (1 m Ω to 1 K Ω) 1.0 cm-1 / 10 to 10,000 μ S (5 to 5,000 ppm) 10.0 cm-1 / 100 to 200,000 μ S (50 to 100,000 ppm) 20.0 cm-1 / 200 to 400,000 μ S (100 to 200,000 ppm)
- Compatible Instruments: Signet Instrument Types: 8850, 8860 8900 or the 9900 with the 2850 Sensor Electronics
- Thread styles are reversible threads or fixed threads

MFR #	Cell Constant [cm-1]	Electrode	Process Connection	Code	USD
3-2821-1	1	316 SST	Threaded	198 844 001	390.00
3-2821-1C	1	316 SST	Threaded	159 000 650	460.00
3-2821-S1	1	316 SST	Threaded	159 000 093	785.00
3-2821-S1C	1	316 SST	Threaded	159 000 095	857.00
3-2821-S2	1	316 SST	Threaded	159 000 094	929.00
3-2821-S2C	1	316 SST	Threaded	159 000 096	986.00
3-2821-T1	1	Titanium	1.5 inch flange	159 000 626	1,099.00
3-2821-T1C	1	Titanium	1.5 inch flange	159 000 652	1,158.00
3-2821-T2	1	Titanium	1.5 inch flange	159 000 627	1,243.00
3-2821-T2C	1	Titanium	1.5 inch flange	159 000 653	1,300.00

Type 2822/2823 Conductivity/Resistivity Electrode

G

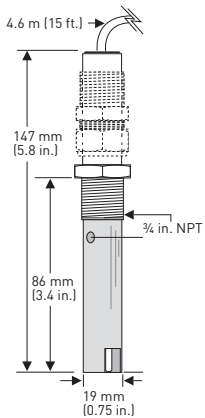

Conductivity/Resistivity:

- Wetted Materials: 316 SST or Titanium
- Process Connection Choices: 3/4 inch threads for In-line or Submersion, 1.5 inch Sanitary Tri-clamp flange and 2 inch Sanitary Tri-clamp flange
- Cell constants and corresponding measuring ranges: 0.01 cm-1 / 0.55 to 100 μ S (18.3 m Ω to 10 K Ω) 0.1 cm-1 / 1 to 1000 μ S (1 m Ω to 1 K Ω) 1.0 cm-1 / 10 to 10,000 μ S (5 to 5,000 ppm) 10.0 cm-1 / 100 to 200,000 μ S (50 to 100,000 ppm) 20.0 cm-1 / 200 to 400,000 μ S (100 to 200,000 ppm)
- Compatible Instruments: Signet Instrument Types: 8850, 8860 8900 or the 9900 with the 2850 Sensor Electronics
- Additional Features: (2823) Thread is reversible for submersion mounting

MFR #	Cell Constant [cm-1]	Electrode	Code	USD
3-2822-1	10	316 SST	198 844 002	652.00
3-2823-1	20	316 SST	198 844 003	784.00



Type 2839-2842 Conductivity Electrodes Dual-threaded

G

Conductivity/Resistivity:

- Wetted Materials: 316 SST and PEEK
- Process Connection Choices: 3/4 inch or ISO 7/1-R 3/4 threads for In-line or Submersion
- Cell constants and corresponding measuring ranges: 0.01 cm-1 / 0.055 to 100 μ S (18.3 m Ω to 10 K Ω) 0.1 cm-1 / 1 to 1000 μ S (1 m Ω to 1 K Ω) 1.0 cm-1 / 10 to 10,000 μ S (5 to 5,000 ppm) 10.0 cm-1 / 100 to 200,000 μ S (50 to 100,000 ppm)
- Compatible Instruments: Signet Instrument Types: 8850, 8860 8900 or the 9900 with the 2850 Sensor Electronics
- Additional Features: Short sensor bodies allow for insertion in-to smaller pipes
- Thread style is fixed NPT or R $\frac{3}{4}$

MFR #	Cell Constant [cm-1]	Thread Size	Code	USD
3-2839-1	0.01	3/4 inch NPT	159 000 921	336.00
3-2839-1D	0.01	ISO 7/1-R 3/4	159 000 923	336.00
3-2840-1	0.10	3/4 inch NPT	159 000 786	336.00
3-2840-1D	0.10	ISO 7/1-R 3/4	159 000 788	336.00
3-2841-1	1.00	3/4 inch NPT	159 000 790	336.00
3-2841-1D	1.00	ISO 7/1-R 3/4	159 000 792	336.00
3-2842-1	10.00	3/4 inch NPT	159 000 794	465.00
3-2842-1D	10.00	ISO 7/1-R 3/4	159 000 796	465.00



Type 2850 Conductivity/Resistivity Sensor Electronics

G

Conductivity/Resistivity:

- Accepts any cell constant
- Compatible with all Signet Conductivity Sensors
- Output choices include Digital (S³L) for use with the Signet 8900 of 4 to 20mA
- Compatible with Signet Instrument Type 8900 or instruments accepting a 4 to 20mA output
- Single or dual input available for remote mount version (S³L) only

MFR #	Mounting	Output	Code	USD
3-2850-51	3/4 inch FNPT	Digital (S ³ L), one input	159 001 398	377.00
3-2850-52	3/4 inch FNPT	4 - 20mA, one input	159 001 399	526.00
3-2850-61	Universal Mount	Digital (S ³ L), one input	159 001 400	377.00
3-2850-62	Universal Mount	4 - 20mA, one input	159 001 401	526.00
3-2850-63	Universal Mount	Digital (S ³ L), one or two inputs	159 001 402	643.00



Type 2850 Conductivity/Resistivity Integral Systems

G

Conductivity/Resistivity:

- Certificate of calibration supplied with all sensors
- Custom cell constant programmed into the electronics
- Dual channel unit available for low cost installation with Signet 8900 Multi-Parameter Controller
- EasyCal with automatic test solution recognition
- Additional Features: Output choices are digital (S³L) for use with the Signet 8900, 9900 or 4 to 20 mA
- Extends the distance between the measuring point and the 9900 Transmitter to 120 m (400 ft)

MFR #	Mounting	Cell Constant [cm-1]	Output	Code	USD
3-2850-51-39	In-line, 3/4 inch NPT	0.01	Digital (S ³ L)	159 001 339	712.00
3-2850-51-40	In-line, 3/4 inch NPT	0.10	Digital (S ³ L)	159 001 340	712.00
3-2850-51-41	In-line, 3/4 inch NPT	1.00	Digital (S ³ L)	159 001 341	712.00
3-2850-51-42	In-line, 3/4 inch NPT	10.00	Digital (S ³ L)	159 001 342	839.00
3-2850-51-39D	In-line, 3/4 ISO	0.01	Digital (S ³ L)	159 001 343	712.00
3-2850-51-40D	In-line, 3/4 ISO	0.10	Digital (S ³ L)	159 001 344	712.00
3-2850-51-41D	In-line, 3/4 ISO	1.00	Digital (S ³ L)	159 001 345	712.00
3-2850-51-42D	In-line, 3/4 ISO	10.00	Digital (S ³ L)	159 001 346	839.00
3-2850-52-39	In-line, 3/4 inch NPT	0.01	4 - 20 mA	159 001 347	861.00
3-2850-52-40	In-line, 3/4 inch NPT	0.10	4 - 20 mA	159 001 348	861.00
3-2850-52-41	In-line, 3/4 inch NPT	1.00	4 - 20 mA	159 001 349	861.00
3-2850-52-42	In-line, 3/4 inch NPT	10.00	4 - 20 mA	159 001 350	991.00
3-2850-52-39D	In-line, 3/4 ISO	0.01	4 - 20 mA	159 001 351	861.00
3-2850-52-40D	In-line, 3/4 ISO	0.10	4 - 20 mA	159 001 352	861.00
3-2850-52-41D	In-line, 3/4 ISO	1.00	4 - 20 mA	159 001 353	861.00
3-2850-52-42D	In-line, 3/4 ISO	10.00	4 - 20 mA	159 001 354	991.00

Temperature, Pressure, Level Submersible Hydrostatic Pressure Sensor



Type 2250 For Level and Depth Control 1/2 inch union connector

G

Temperature/Pressure:

- Cable Length: 10 m (32.8 ft)
- Operating Temperature: ** 15° to 85°C (5° to 185 °F)
- Operating Pressures:** -XU Ultra Low: 0 to 0.7 bar (0 to 10 psi)
-XL Low: 0 to 3.4 bar (0 to 50 psi)
- Compatibility: 8450, 8900 and 9900

MFR #	Output	Maximum Operation	Code	USD
3-2250-11U	Digital (S ³ L)	0.7 bar (10 psi); 7.03 m (23 ft)	159 001 242	764.00
3-2250-11L	Digital (S ³ L)	3.4 bar (50 psi); 35.15 m (115 ft)	159 001 241	764.00
3-2250-21U	4-20 mA	0.7 bar (10 psi); 7.03 m (23 ft)	159 001 248	880.00
3-2250-21L	4-20 mA	3.4 bar (50 psi); 35.15 m (115 ft)	159 001 247	880.00
3-2250-11U-1	Digital (S ³ L)	0.7 bar (10 psi); 7.03 m (23 ft)	159 001 478	764.00
3-2250-11L-1	Digital (S ³ L)	3.4 bar (50 psi); 35.15 m (115 ft)	159 001 479	764.00
3-2250-21U-1	4-20 mA	0.7 bar (10 psi); 7.03 m (23 ft)	159 001 482	880.00
3-2250-21L-1	4-20 mA	3.4 bar (50 psi); 35.15 m (115 ft)	159 001 483	880.00

Temperature/Pressure Sensors



Type 2350 Temperature Sensor

G

Temperature/Pressure:

- Wetted Materials: PDVF
- Additional features: Platinum RTD in extended tip for quick response
- In-line Mounting styles: 3/4 inch NPT
- Submersible mounting: 3/4 inch NPT
- Operating Temperature:** In-line: -10 ° to 100 °C (14 to 212 °F)
Submersible: -10° to 85°C (14 ° to 185 °F)
- Operating Pressures:** 0 to 16 bar (0 to 232 psi)
- Compatibility: 8350, 8900 or 9900
- **check operating temperature/pressure graphs in catalog for derating information

MFR #	Output	Cable Length	Code	USD
3-2350-1	Digital (S ³ L)	4.6m (15 ft)	159 000 021	313.00
3-2350-2	4-20 mA	4.6m (15 ft)	159 000 920	412.00



Type 2450 Pressure Sensor 1/2 inch male union

Temperature/Pressure:

- Wetted Materials: PVDF, ceramic, FPM
- 4 to 20 mA or digital (S³L) output
- In-line Mounting styles: 1/2 inch male union
- Operating Temperature: ** 15° to 85°C (5° to 185°F)
- Operating Pressures:**-XU Ultra Low: 0 to 0.7 bar (0 to 10 psi)
-XL Low: 0 to 3.4 bar (0 to 50 psi)-XH High: 0 to 17 bar (0 to 250 psi)
- Compatibility: 8450, 8900 and 9900
- *Level ranges calculated using specific gravity of water.
Maximum ranges may vary for other liquids
- **check operating temperature/pressure graphs in catalog for derating information

MFR #	Output	Maximum Operation	Cable Length	Code	USD
3-2450-3U	Digital (S ³ L)	0.7 bar (10 psi)	4.6m (15 ft)	159 000 683	526.00
3-2450-3L	Digital (S ³ L)	3.4 bar (50 psi)	4.6m (15 ft)	159 000 682	526.00
3-2450-3H	Digital (S ³ L)	17 bar (250 psi)	4.6m (15 ft)	159 000 681	526.00
3-2450-7U	4-20 mA	0.7 bar (10 psi)	4.6m (15 ft)	159 000 906	638.00
3-2450-7L	4-20 mA	3.4 bar (50 psi)	4.6m (15 ft)	159 000 908	638.00
3-2450-7H	4-20 mA	17 bar (250 psi)	4.6m (15 ft)	159 000 910	638.00

Other Products

Analytical Sensor Accessories and Replacement Part

pH/ORP Electrode Mounting

G

MFR #	Description	Description	For Type	Code	USD
P31515-0P200		PVC Pipe Adapter, 1.25 in. o.d.	2724, 2725, 2726	159 000 630 *	48.00
P31515-0C200	PVC-C Pipe Adapter, 1.25 in. o.d.	CPVC Pipe Adapter, 1.25 in. o.d.	2724, 2725, 2726	159 000 631 *	55.00
P31515-0V200	PVDF Pipe Adapter, 1.25 in. o.d.	PVDF Pipe Adapter, 1.25 in. o.d.	2724, 2725, 2726	159 000 459 *	96.00
P31542		Sensor Cap, Blue	515	198 801 630	16.00
P31542-3		Sensor Cap, Blue	2536	159 000 464	16.00

pH/ORP Miscellaneous

G

MFR #	Description	Code	USD
1220-0021	O-ring, FPM (2 req'd per sensor)	198 801 000	4.00
1224-0021	O-ring, EPR (EPDM) (2 req'd per sensor)	198 820 006	9.00
1228-0021	O-ring, FFPM (2 req'd per sensor)	198 820 007	195.00
5523-0624	Cable, 24 AWG, 6-conductor	159 000 636	3.00
3-2721	Preamplifier	198 864 610	155.00
3864-0001	Replacement Salt Bridge	159 001 007 *	60.00
3864-0002	Replacement Reference	159 001 008 *	39.00
2120-0015	PVC-C Adapter,	159 001 009	144.00
2122-0015	316 SS (1 .4401) Adapter,	159 001 010	295.00
3-2700.395	Calibration kit, 3 PP cups, 1 pt ea 4, 7 solu	159 001 605 *	83.00
3822-7115	20 gm bottle Quinhydrone for ORP calibration	159 001 606 *	108.00
3-2759	Connects directly to instrument	159 000 762	449.00
3-2759.391	Use with DryLoc preamplifiers	159 000 764	97.00
3-0700.390	pH buffer kit (1 ea 4, 7, 10 powder form)	198 864 403 *	7.00
3822-7004	pH 4 buffer solution, 1 pt (473 ml)	159 001 581 *	25.00
3822-7007	pH 7 buffer solution, 1 pt (473 ml)	159 001 582 *	25.00
3822-7010	pH 10 buffer solution, 1 pt (473 ml)	159 001 583 *	25.00
5523-0322	Cable, 3cond. plus shield, 22 AWG, black/red	159 000 761	3.00
3-8050.390-1	Retaining nut replacement kit, Valox K4530	159 001 702	26.00
0297-0072	72 hour heat pack	159 802 027	5.00

Wet-Tap Replacement Parts

G

MFR #	Description	For Type	Code	USD
1220-0114	O-ring, FPM	3719	159 000 854	4.00
3-3719.390	Locking Shroud	3719	159 000 855	215.00
1220-9458	O-ring, FPM	3719	159 000 927	7.00

Miscellaneous

G

MFR #	Description	Code	USD
3-2820.390	3/4 in. NPT fitting, 316SS	198 840 223	220.00
3-2820.391	Cable (2 Conductors, shield)	198 840 221	63.00
3-2820.392	1/2 in. NPT fitting, 316SS	198 840 222	220.00
3-2842.390	2842 Replacement Insulator	159 000 925	93.00
3-8050-2	Universal Junction Box with EasyCal	159 000 754	140.00
3-8052-2	3/4 in. NPT Junction Box with EasyCal	159 000 756	140.00
6205-0002	DIN Rail (1 m length)	159 000 858	28.00
6205-0003	End Clips for DIN Rail	159 000 859	6.00
5523-0222	Cable (2 Conductor, shield)	159 000 392	3.00
3-8050-1	Universal Mount Junction Box	159 000 753	106.00
3-8050.390-1	Retaining nut replacement kit, Valox K4530	159 001 702	26.00
5523-0322	Cable, 3cond. plus shield, 22 AWG, black/red	159 000 761	3.00
3-2850-61	Universal junction box, conductivity electrodes, digital (S ³ L) output	159 001 400	377.00
3-2850-62	Universal junction box, conductivity electrodes, 4 to 20 output	159 001 401	526.00



Universal In-line Sensor Adapter

Description	Code	USD
Universal In-Line Sensor Adapter	150 300 300	165.00

Buffer Solutions for pH/ORP



Buffer Solutions

G

pH/ORP:

- NIST Traceable
- Temperature compensated values
- Liquid or powder versions
- Kits available for easy use
- Easily identifiable color coded buffer solutions

MFR #	Description	Code	USD
3822-7004	pH 4 buffer solution, 1 pt (473 ml)	159 001 581 *	25.00
3822-7007	pH 7 buffer solution, 1 pt (473 ml)	159 001 582 *	25.00
3822-7010	pH 10 buffer solution, 1 pt (473 ml)	159 001 583 *	25.00
3-0700.390	pH buffer kit (1 ea 4, 7, 10 powder form)	198 864 403 *	7.00
3-2700.395	Calibration kit, 3 PP cups, 1 pt ea 4, 7 solu	159 001 605 *	83.00
3822-7115	20 gm bottle Quinhydrone for ORP calibration	159 001 606 *	108.00

pH/ORP System Tester



Type 2759 pH/ORP System Tester

G

pH/ORP:

- Connects to any Signet pH/ORP instrument
- Compatible with 2750 and 2760 Preamplifiers
- Additional Features: Battery powered millivolt generator
- Simulated pH or ORP values
- Verifies system functionality

MFR #	Description	Compatible Preamplifier	Code	USD
3-2759	Connects directly to instrument	n/a	159 000 762	449.00
3-2759.391	Use with DryLoc preamplifiers	2750, 2760 DryLoc	159 000 764	97.00

Conductivity/Resistivity Tools

Conductivity/Resistivity Tools

G



Conductivity/Resistivity:

- NIST traceable units
- Available in five different values
- Simulates various values to validate or calibrate instruments and sensor electronics
- 2850 tools are temperature compensated to 25 C for various conductivity or resistive values
- Verifies electronics independent of electrode
- Compatible with all Signet Conductivity/Resistivity instruments

MFR #	Input Simulated	Code	USD
3-2850.101-1	1.0 μ S	159 001 392	107.00
3-2850.101-2	2.5 μ S	159 001 393	107.00
3-2850.101-3	10.0 μ S	159 001 394	107.00
3-2850.101-4	18.2 M Ω	159 001 395	107.00
3-2850.101-5	10 M Ω	159 001 396	107.00



3-0250 Blind Sensor Configuration/ Diagnostic Tool

G

- User-Friendly Interface
- Monitor mV readings in pH/ORP sensors
- Configure all blind sensors
- Monitor sensor data or log sensor data to a file
- Multi-Language software

MFR #	Description	Code	USD
3-0250	USB to Digital (S ³ L) Configuration/Diagnostic Tool	159 001 538	251.00



3-0251 Configuration Tool

G

- Configure settings such as instrument type, units and modify labels from the computer
- Back up and restore 9900 Transmitter configurations to a computer file
- Compatible with 9900 Transmitter
- Use a single file to clone multiple 9900 Transmitters
- Red and blue LED indicators for data and power

MFR #	Description	Code	USD
3-0251	PC COMM configuration tool	159 001 734	256.00

Switching Power Supplies

7310 Switching Power Supplies

G



- Universal A/C input/full range
- Protections: Short circuit/Overload/Over-voltage
- Cooling by free air convection
- Install on DIN rail TS-35/7.5 or 15
- NEC class 2 / LPS compliant
- Built-in DC OK active signal
- LED indicator for power on

MFR #	Input Simulated	Code	USD
7310-1024	24 VDC Power Supply, 10W, 0.42 A	159 873 004	108.00
7310-2024	24 VDC Power Supply, 24W, 1.0 A	159 873 005	146.00
7310-4024	24 VDC Power Supply, 40W, 1.7 A	159 873 006	170.00
7310-6024	24 VDC Power Supply, 60W, 2.5 A	159 873 007	256.00
7310-7024	24 VDC Power Supply, 96W, 4.0 A	159 873 008	329.00

Relay

8059 External Relay Modules

G



Instruments:

- Relay Outputs: 2 or 4 external contact relays. SPDT
250VAC/30VDC/5A
- Operating Temperature: -10 °C to 55 °C (14 °F to 131 °F)
- Relative Humidity: 0 to 90% (non-condensing)
- Pass-through Output: S³L signals can be passed through this unit
- Material: Enclosure: Noryl® UL 94 V-O
- Compatible Instruments: 8900 (S³L Instruments only)

MFR #	Description	Code	USD
3-8059-4	Four external dry-contact relays	159 000 772	469.00
3-8059-4AC	Four external dry-contact relays with power supply	159 000 773	597.00

Installation and Weld-on Fittings

Plastic Installation Fittings



PVC TEES SCH 80 - Fitting only

G

Type	Size	L [inch]	H [inch]	i.d [inch]	Sensor Type	Code No.	USD
MPV8T005F	0.50	3.75	3.50	0.85	Flow -X0, pH -XX	159 001 614	123.00
MPV8T007F	0.75	3.75	3.70	1.06	Flow -X0, pH -XX	159 001 615	123.00
MPV8T010F	1.00	4.30	4.00	1.33	Flow -X0, pH -XX	159 001 616	123.00
MPV8T012F	1.25	4.40	4.30	1.67	Flow -X0, pH -XX	159 001 617	137.00
MPV8T015F	1.50	5.00	4.60	1.91	Flow -X0, pH -XX	159 001 618	144.00
MPV8T020F	2.00	5.50	5.00	2.40	Flow -X0, pH -XX	159 001 619	160.00

PVC TEES SCH 80 - with pipe

G

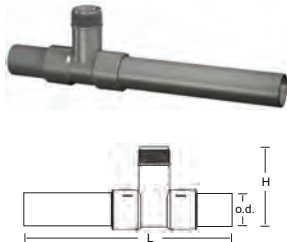

Type	Size	L [inch]	H [inch]	o.d [inch]	Sensor Type	Code No.	USD
MPV8T005	0.50	14.00	3.50	0.84	Flow -X0, pH -XX	159 001 623	208.00
MPV8T007	0.75	14.00	3.70	1.05	Flow -X0, pH -XX	159 001 624	208.00
MPV8T010	1.00	17.00	4.00	1.32	Flow -X0, pH -XX	159 001 625	216.00
MPV8T012	1.25	20.00	4.30	1.66	Flow -X0, pH -XX	159 001 626	230.00
MPV8T015	1.50	24.00	4.60	1.90	Flow -X0, pH -XX	159 001 627	230.00
MPV8T020	2.00	26.50	5.02	2.38	Flow -X0, pH -XX	159 001 628	245.00

PVC TEES SCH 80 - 2.5–4 inch with pipe

G



Type	Size	L [inch]	H [inch]	o.d [inch]	Sensor Type	Code No.	USD
PV8T025	2.50	24.00	5.40	2.88	Flow -X0, pH -XX	198 801 573	259.00
PV8T030	3.00	24.00	6.00	3.50	Flow -X0, pH -XX	198 801 416	280.00
PV8T040	4.00	24.00	7.00	4.50	Flow -X0, pH -XX	198 801 436	310.00

PVC Clamp-on Saddles SCH 80

- Mounts on PVC pipe
- C - Clearance dimension
- EPDM O-ring

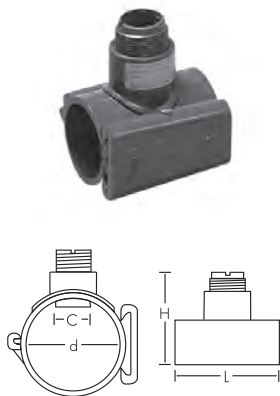

Type	Size [inch]	L [inch]	H [inch]	d [inch]	C [inch]	Sensor Type	Code No.	USD
PV8S020	2.00	4.00	5.00	2.375	1.43	Flow -X0, pH -XX	159 000 637	166.00
PV8S025	2.50	4.75	5.40	2.875	1.43	Flow -X0, pH -XX	159 000 638	166.00
PV8S030	3.00	5.00	6.00	3.500	1.43	Flow -X0, pH -XX	198 150 577	195.00
PV8S040	4.00	5.00	7.10	4.500	1.43	Flow -X0	198 150 578	230.00
PV8S060	6.00	5.00	10.0	6.625	2.25	Flow -X1	198 150 579	280.00
PV8S080	8.00	5.00	11.50	8.625	2.25	Flow -X1	159 000 639	345.00

PVC Glue-on Saddle

G

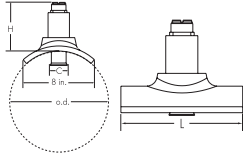

Type	Size [inch]	W [inch]	H [inch]	o.d [inch]	C [inch]	Sensor Type	Code No.	USD
PV8S100	10	9.00	5.43	10.75	2.25	Flow -X2	159 000 695	461.00
PV8S120	12	9.00	5.15	12.75	2.25	Flow -X2	159 000 696	461.00

CPVC TEES SCH 80 - Fitting only

G

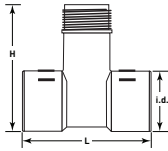

Type	Size	L [inch]	H [inch]	i.d [inch]	Sensor Type	Code No.	USD
MCPV8T005F	0.50	3.75	3.50	0.08	Flow -X0, pH -XX	159 001 632	144.00
MCPV8T007F	0.75	3.75	3.70	1.06	Flow -X0, pH -XX	159 001 633	144.00
MCPV8T010F	1.00	4.30	4.00	1.33	Flow -X0, pH -XX	159 001 634	144.00
MCPV8T012F	1.25	4.40	4.30	1.67	Flow -X0, pH -XX	159 001 635	168.00
MCPV8T015F	1.50	5.00	4.60	1.91	Flow -X0, pH -XX	159 001 636	177.00
MCPV8T020F	2.00	5.50	5.00	2.40	Flow -X0, pH -XX	159 001 637	187.00

CPVC TEES SCH 80 - with pipe*

G

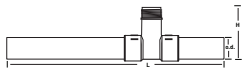

Type	Size	L [inch]	H [inch]	o.d [inch]	Sensor Type	Code No.	USD
MCPV8T005	0.50	14.00	3.50	0.84	Flow -X0, pH -XX	159 001 641	208.00
MCPV8T007	0.75	14.00	3.70	1.05	Flow -X0, pH -XX	159 001 642	208.00
MCPV8T010	1.00	17.00	4.00	1.32	Flow -X0, pH -XX	159 001 643	208.00
MCPV8T012	1.25	20.00	4.30	1.66	Flow -X0, pH -XX	159 001 644	221.00
MCPV8T015	1.50	24.00	4.60	1.90	Flow -X0, pH -XX	159 001 645	230.00
MCPV8T020	2.00	26.50	5.02	2.38	Flow -X0, pH -XX	159 001 646	252.00

Fiberglass Glue-on Tees

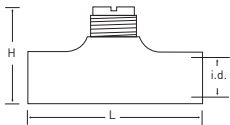

- PVDF insert - all sizes
- PTFE tape wetted material. Consult factory for available options.

Type	Size [inch]	L [inch]	H [inch]	i.d [inch]	Sensor Type	Code No.	USD
FPT015	1.50	5.50	4.70	1.92	Flow -X0, pH -XX	159 000 446 *	412.00
FPT020	2.00	7.70	8.00	2.38	Flow -X0, pH -XX	159 000 447 *	456.00

Plastic Installation Fittings (metric)

BSP PVC Tee Fittings

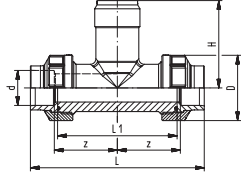

- FPM O-ring
- These fittings are only available from your local Georg Fischer sales office

Type	d [inch]	d [mm]	Sensor Type	L [mm]	L1 [mm]	H [mm]	FPM Code No.	USD
PVAT005	½	20	Flow -X0, pH -XX	131	90	76	721 310 336	Call
PVAT007	¾	25	Flow -X0, pH -XX	147	100	78	721 310 337	Call
PVAT010	1	32	Flow -X0, pH -XX	164	110	81	721 310 338	Call
PVAT012	1¼	40	Flow -X0, pH -XX	171	110	85	721 310 339	Call
PVAT015	1½	50	Flow -X0, pH -XX	188	120	89	721 310 340	Call
PVAT020	2	63	Flow -X0, pH -XX	211	130	95	721 310 341	Call

Type	EPDM Code No.	USD
PVAT005	721 310 306	Call
PVAT007	721 310 307	Call
PVAT010	721 310 308	Call
PVAT012	721 310 309	Call
PVAT015	721 310 310	Call
PVAT020	721 310 311	Call

BSP PVC Clamp-on Saddle

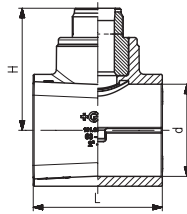

- EPDM Gasket
- These fittings are only available from your local Georg Fischer sales office

Type	d [mm]	Size [inch]	D [mm]	H [mm]	H1 [mm]	L [mm]	Part No.	USD
PVAS030	90	3	39	105	225	105	198 150 550	Call
PVAS040	110	4	39	114	264	105	198 150 551	Call
PVAS060	160	6	39	156	339	120	198 150 554	Call

Metric PVC-U Tee

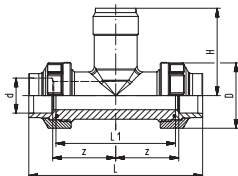

- FPM O-ring
- These fittings are only available from your local Georg Fischer sales office

Type	d [inch]	DN [mm]	Sensor Type	L [mm]	L1 [mm]	H [mm]	FPM Code No.	USD
PVMT005	20	15	Flow -X0, pH -XX	128	90	76	721 310 036	Call
PVMT007	25	20	Flow -X0, pH -XX	144	100	78	721 310 037	Call
PVMT010	32	25	Flow -X0, pH -XX	160	110	81	721 310 038	Call
PVMT012	40	32	Flow -X0, pH -XX	168	110	85	721 310 039	Call
PVMT015	50	40	Flow -X0, pH -XX	188	120	89	721 310 040	Call
PVMT020	63	50	Flow -X0, pH -XX	212	130	95	721 310 041	Call

EPDM Code No.	USD
721 310 006	Call
721 310 007	Call
721 310 008	Call
721 310 009	Call
721 310 010	Call
721 310 011	Call

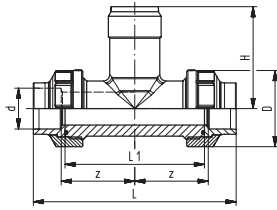
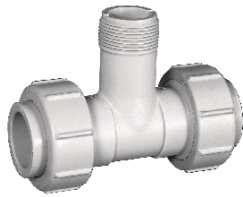

Metric PP Union Tee

G

- Socket fusion equipment is required to install PVDF and PP union tees.
- FPM O-ring

Type	d [mm]	DN [mm]	Sensor Type	FPM Code No.	USD
PPMT005	20	15	Flow -X0, pH -XX	727 310 036	213.00
PPMT007	25	20	Flow -X0, pH -XX	727 310 037	213.00
PPMT010	32	25	Flow -X0, pH -XX	727 310 038	229.00
PPMT012	40	32	Flow -X0, pH -XX	727 310 039	267.00
PPMT015	50	40	Flow -X0, pH -XX	727 310 040	311.00
PPMT020	63	50	Flow -X0, pH -XX	727 310 041	379.00

EPDM Code No.	USD	L [mm]	L1 [mm]	H [mm]
727 310 006	Call	128	90	76
727 310 007	Call	142	100	78
727 310 008	Call	156	110	81
727 310 009	Call	160	110	85
727 310 010	Call	176	120	89
727 310 011	Call	194	130	95

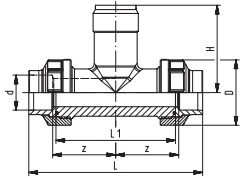

Instrument Installation Fitting Type 310 (FPM black) PN 16, Standard PVDF

G

Range of use:

- Compatible Signet pH/ORP sensors: models 2724, 2725, 2726
- Compatible Signet flow sensors: models 2551, 2537, 515, 8510, 2536, 8512

Model:

- Union end with fusion socket PVDF
- Material: PVDF
- Threaded outlet 1 1/4" NPSM
- Supplied with o-rings

Attention:

- Sensor length depends on installation fitting

d [mm]	PN [bar]	Part No.	USD	SP	L1 [mm]	D [mm]	H [mm]	L [mm]	z [mm]	Sensor Type
20	16	735 310 036	303.00	0	90	45	76	128	50	Flow -X0, pH -XX
25	16	735 310 037	303.00	1	100	55	78	142	55	Flow -X0, pH -XX
32	16	735 310 038	333.00	0	110	62	81	156	60	Flow -X0, pH -XX
40	16	735 310 039	364.00	1	110	75	85	160	60	Flow -X0, pH -XX
50	16	735 310 040	402.00	0	120	84	89	176	65	Flow -X0, pH -XX
63	16	735 310 041	464.00	1	130	101	95	194	70	Flow -X0, pH -XX

Instrumentation Installation Fitting Type 311, Standard PP



Model:

- Material: PP-H
- Threaded outlet 1 ¼" NPSM
- Suitable for backing flanges metric and inch
- Suitable for SDR 11 - SDR 17.6
- Delivered with profile O-ring

Attention:

- Sensor length depends on installation fitting

Range of use:

- Compatible Signet flow sensors: models 2551, 2537, 515, 8510, 2536, 8512

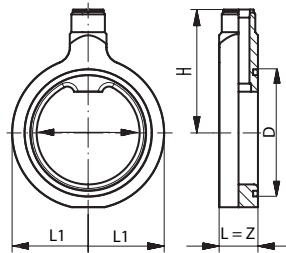

d [mm]	d [inch]	PN [bar]	DN [mm]	EPDM Part No.	USD	EPDM Part No.	USD
75	2½	16	65	727 311 012	572.00	727 311 042	630.00
90	3	16	80	727 311 013	583.00	727 311 043	641.00
110	4	16	100	727 311 014	620.00	727 311 044	681.00
125		16	100	727 311 015	Call	727 311 045	Call
140	5	16	125	727 311 016	680.00	727 311 046	749.00
160	6	16	150	727 311 017	748.00	727 311 047	748.00
180		16	150	727 311 018	Call	727 311 048	Call
200	8	16	200	727 311 019	Call	727 311 049	Call
225	8	16	200	727 311 020	967.00	727 311 050	967.00
250	10	16	250	727 311 021	Call	727 311 051	Call
280	10	16	250	727 311 022	1,145.00	727 311 052	1,145.00
315	12	16	300	727 311 023	1,251.00	727 311 053	1,251.00

d [mm]	D [mm]	L1 [mm]	L [mm]	H [mm]	Sensor Type
75	88	61	48	133	Flow X1
90	102	69	48	140	Flow X1
110	132	79	48	149	Flow X1
125	132	79	48	144	Flow X1
140	157	94	48	149	Flow X1
160	182	106	48	156	Flow X1
180	182	106	48	163	Flow X1
200	236	134	48	170	Flow X1
225	236	134	48	178	Flow X1
250	289	160	48	263	Flow X2
280	289	160	48	273	Flow X2
315	329	185	48	285	Flow X2

Instrument Installation Fitting Type 311 (FPM black), Standard PVDF



Range of use:

- Compatible Signet flow sensors: models 2551, 2537, 515, 8510, 2536, 8512

Attention:

- Sensor length depends on installation fitting

Model:

- Material: PVDF
- Threaded outlet 1 1/4" NPSM
- Suitable for backing flanges metric and inch
- Delivered with profile O-ring

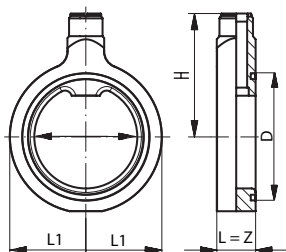

d [inch]	DN [mm]	PN [bar]	d [mm]	Part No.	USD
2 1/2	65	10 - 16	75	735 311 042	1,132.00
3	80	10 - 16	90	735 311 043	1,215.00
4	100	10 - 16	110	735 311 044	1,330.00
	100	10 - 16	125	735 311 045	Call
5	125	10 - 16	140	735 311 046	1,534.00
6	150	10 - 16	160	735 311 047	1,728.00
8	200	10 - 16	200	735 311 049	Call
8	200	10 - 16	225	735 311 050	2,702.00

d [inch]	DN [mm]	Sensor Type	D [mm]	H [mm]	L [mm]	L1 [mm]
2 1/2	65	Flow X1	88	135	48	61
3	80	Flow X1	102	141	48	69
4	100	Flow X1	132	152	48	79
	100	Flow X1	132	147	48	79
5	125	Flow X1	157	153	48	94
6	150	Flow X1	482	161	48	106
8	200	Flow X1	236	175	48	134
8	200	Flow X1	236	185	48	134

Metal Fittings

Carbon Steel Threaded Tees with NPT Thread



- PVDF insert - all sizes
- For use with SCH 40 metal pipe (ASTM)
- PTFE tape wetted material. Consult factory for available options.

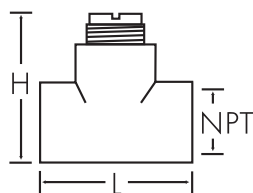

Type	Size [inch]	L [inch]	H [inch]	Sensor Type	Part No.	USD
CS4T005	0.50	3.60	4.00	Flow -X0, pH -XX	198 801 459	334.00
CS4T007	0.75	3.60	4.20	Flow -X0, pH -XX	198 801 460	334.00
CS4T010	1.00	3.60	4.20	Flow -X0, pH -XX	198 801 461	334.00
CS4T012	1.25	3.80	4.50	Flow -X0, pH -XX	198 801 462	176.00
CS4T015	1.50	4.10	4.80	Flow -X0, pH -XX	198 801 419	261.00
CS4T020	2.00	4.90	5.30	Flow -X0, pH -XX	198 801 463	329.00

Copper Sweat-on Tee with PVDF Insert

G

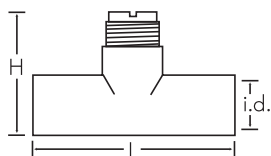

- No insert up to 1 in., over 1 in. - PVDF insert
- For use with copper pipe (SCH K)
- PTFE tape wetted material. Consult factory for available options.

Type	Size [inch]	L [inch]	H [inch]	i.d. [inch]	Sensor Type	Part No.	USD
CUKT005	0.50	3.15	3.57	0.62	Flow -X0, pH -XX	198 801 687	316.00
CUKT007	0.75	2.96	3.52	0.87	Flow -X0, pH -XX	198 801 688	316.00
CUKT010	1.00	3.23	3.80	1.12	Flow -X0, pH -XX	198 801 689	316.00
CUKT012	1.25	4.16	4.12	1.38	Flow -X0, pH -XX	198 801 690	233.00
CUKT015	1.50	4.43	4.34	1.63	Flow -X0, pH -XX	198 801 691	260.00
CUKT020	2.00	5.31	4.86	2.11	Flow -X0, pH -XX	198 801 418	390.00

Galvanized Iron Threaded Tee with NPT Threads and PVDF Insert

G

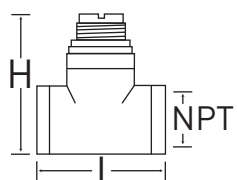

- PVDF insert - all sizes
- For use with SCH 40 metal pipe (ASTM)
- PTFE tape wetted material. Consult factory for available options.

Type	Size [inch]	NPT	L [inch]	H [inch]	Sensor Type	Part No.	USD
IR4T010	1.00	1.00	3.40	4.10	Flow -X0, pH -XX	198 801 421	133.00
IR4T012	1.25	1.25	3.56	4.34	Flow -X0, pH -XX	198 801 422	133.00
IR4T015	1.50	1.50	3.75	4.67	Flow -X0, pH -XX	198 801 423	133.00
IR4T020	2.00	2.00	3.90	5.05	Flow -X0, pH -XX	198 801 424	133.00

316 SS (1.4401) Threaded Tees with NPT Threads with PVDF Insert

G



- For use with SCH 40 metal pipe (ASTM)
- PTFE tape wetted material. Consult factory for available options.
- PVDF insert - all sizes

Type	Size [inch]	L [inch]	H [inch]	Sensor Type	Part No.	USD
CR4T005	0.50	3.60	4.00	Flow -X0, pH -XX	198 801 554	467.00
CR4T007	0.75	3.60	4.20	Flow -X0, pH -XX	198 801 555	467.00
CR4T010	1.00	3.60	4.20	Flow -X0, pH -XX	198 801 556	467.00
CR4T012	1.25	3.80	4.50	Flow -X0, pH -XX	198 801 783	261.00
CR4T015	1.50	4.10	4.80	Flow -X0, pH -XX	198 801 784	270.00
CR4T020	2.00	4.90	5.30	Flow -X0, pH -XX	198 801 785	334.00

Brass Threaded Tee with NPT Threads and PVDF Insert

G

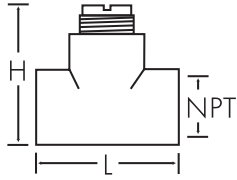

- PVDF insert - all sizes
- For use with SCH 40 metal pipe (ASTM)
- PTFE tape wetted material. Consult factory for available options.

Type	Size [inch]	NPT	L [inch]	H [inch]	Sensor Type	Part No.	USD
BR4T010	1.00	1.00	3.36	4.09	Flow -X0, pH -XX	198 801 770	179.00
BR4T012	1.25	1.25	3.42	4.42	Flow -X0, pH -XX	198 801 771	140.00
BR4T015	1.50	1.50	3.46	4.70	Flow -X0, pH -XX	198 801 772	169.00
BR4T020	2.00	2.00	3.68	5.19	Flow -X0, pH -XX	198 801 773	213.00

Carbon Steel Weld-on Weldolets with PVDF Insert

G

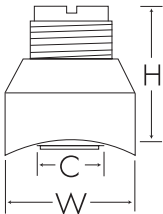

- For use with SCH 40 metal pipe (ASTM)
- PTFE tape wetted material. Consult factory for available options.
- C - Clearance dimension
- Up to 8 in. - PVDF insert, over 8 in. - PVC insert

Type	Size [inch]	H [inch]	W [inch]	C [inch]	Sensor Type	Part No.	USD
CS4W025	2.50	2.48	2.60	1.31	Flow -X0, pH -XX	198 801 464	167.00
CS4W030	3.00	2.47	2.60	1.31	Flow -X0, pH -XX	198 801 557	167.00
CS4W040	4.00	2.45	2.60	1.31	Flow -X0, pH -XX	198 801 552	167.00
CS4W050	5.00	3.24	3.50	2.10	Flow -X1	198 801 465	219.00
CS4W060	6.00	3.11	3.50	2.10	Flow -X1	198 801 553	219.00
CS4W080	8.00	2.88	3.50	2.10	Flow -X1	198 801 574	219.00
CS4W100	10.00	5.63	3.50	2.10	Flow -X2	198 801 575	510.00
CS4W120	12.00	5.40	3.50	2.10	Flow -X2	198 801 576	510.00

Brass Brazolet with PVDF insert

G

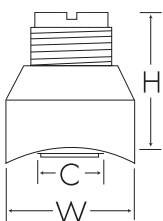

- C - Clearance dimension
- PTFE tape wetted material. Consult factory for available options.
- Up to 8 in. - PVDF insert, over 8 in. - PVC insert

Type	Size [inch]	W [inch]	H [inch]	C [inch]	Sensor Type	Part No.	USD
BR4B025	2.50	2.50	2.48	1.31	Flow -X0, pH -XX	198 801 794	410.00
BR4B030	3.00	2.50	2.47	1.31	Flow -X0, pH -XX	198 801 795	410.00
BR4B040	4.00	2.50	2.45	1.31	Flow -X0, pH -XX	198 801 796	410.00
BR4B050	5.00	3.50	3.24	2.10	Flow -X1	198 801 797	565.00
BR4B060	6.00	3.50	3.11	2.10	Flow -X1	198 801 798	565.00
BR4B080	8.00	3.50	2.88	2.10	Flow -X1	198 801 799	565.00
BR4B100	10.00	3.50	5.63	2.10	Flow -X2	198 801 800 *	848.00
BR4B120	12.00	3.50	5.40	2.10	Flow -X2	198 801 801 *	848.00

316 SS (1.4401) Weldolets with PVDF Insert

G



- C - Clearance dimension
- Up to 8 in. - PVDF insert, over 8 in. - PVC insert
- For use with SCH 40 metal pipe (ASTM)
- PTFE tape wetted material. Consult factory for available options.

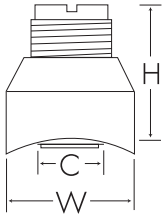

Type	Size [inch]	W [inch]	H [inch]	C [inch]	Part No.	USD
CR4W025	2.50	2.50	2.48	1.31	198 801 786	568.00
CR4W030	3.00	2.50	2.47	1.31	198 801 787	568.00
CR4W040	4.00	2.50	2.45	1.31	198 801 788	568.00
CR4W050	5.00	3.50	3.24	2.10	198 801 789	597.00
CR4W060	6.00	3.50	3.11	2.10	198 801 790	597.00
CR4W080	8.00	3.50	2.88	2.10	198 801 791	597.00
CR4W100	10.00	3.50	5.63	2.10	198 801 792	882.00
CR4W120	12.00	3.50	5.40	2.10	198 801 793	882.00

Iron Strap-on Saddle

G



- Up to 8 in. - PVDF insert, over 8 in. - PVC insert
- C - Clearance dimension
- Buna Nitrile O-ring
- For use with SCH 80 & 40 metal pipe (ASTM)
- PTFE tape wetted material. Consult factory for available options.

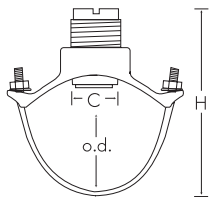

Type	Size [inch]	H [inch]	o.d. min [inch]	o.d. max [inch]	C [inch]	Sensor Type	Part No.	USD
IR8S020	2.00	5.50	2.35	2.56	1.44	Flow -X0, pH -XX	198 801 425	167.00
IR8S025	2.50	5.50	2.44	2.91	1.44	Flow -X0, pH -XX	198 801 426	229.00
IR8S030	3.00	6.50	2.97	3.54	1.44	Flow -X0, pH -XX	198 801 427	229.00
IR8S040	4.00	7.50	4.40	4.55	1.44	Flow -X0, pH -XX	198 801 420	229.00
IR8S050	5.00	9.00	5.00	5.63	2.25	Flow -X1	198 801 429	290.00
IR8S060	6.00	10.50	5.94	6.70	2.25	Flow -X1	198 801 430	305.00
R8S080	8.00	12.00	7.69	8.72	2.25	Flow -X1	198 801 431	335.00
IR8S100	10.00	18.00	10.64	12.12	2.25	Flow -X2	198 801 432	605.00
IR8S120	12.00	20.00	12.62	14.32	2.25	Flow -X2	198 801 433	605.00

Metalex Weld-on Mini-Tap (1.4401)

G



- For use with SS pipe
- Gasket Klinger C4401 Thermoseal



Type	DN [mm]	Size [inch]	for sensor	Part No.	USD	W [inch]	H [inch]	C [inch]
P526-2012	32	1.25	P525-2, 2S	159 000 494	355.00	1.66	2.25	1.26
P526-2015	40	1.50	P525-2, 2S	198 840 506	355.00	1.66	2.20	1.26
P526-2020	50	2.00	P525-2, 2S	159 000 495	355.00	1.66	2.17	1.26
P526-2025	65	2.50	P525-2, 2S	159 000 496	355.00	1.66	2.10	1.26
P526-2030	80	3.00	P525-2, 2S	159 000 497	355.00	1.66	2.00	1.26
P526-2040	100	4.00	P525-2, 2S	159 000 498	355.00	1.66	1.95	1.26
P526-2050	125	5.00	P525-2, 2S	159 000 499	355.00	1.66	1.83	1.26
P526-2060	150	6.00	P525-2, 2S	159 000 500	355.00	1.66	1.75	1.26
P526-2080	200	8.00	P525-2, 2S	159 000 501	355.00	1.66	1.56	1.26
P526-2100	250	10.00	P525-2, 2S	159 000 502	355.00	1.66	1.35	1.26
P526-2120	300	12.00	P525-2, 2S	159 000 503	355.00	1.66	1.15	1.26

Metalex Socket Weld Mini-Tap (1.4401)

G



- For use with SS pipe

For Type	DN [inch]	Size [inch]	for sensor	Part No.	USD	L [inch]	W [inch]	H [inch]	i.d [inch]
P526-2005	15	0.50	P525-1, 1S	198 840 501	447.00	2	2.4	3	0.85
P526-2007	20	0.75	P525-1, 1S	198 840 502	447.00	2	2.4	3	1.06
P526-2010	25	1.00	P525-1, 1S	198 840 503	515.00	2	2.4	3	1.33

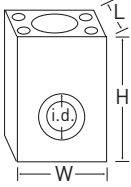

Electrofusion Fittings

Transition Saddles for Stainless Steel 1¼ Outlet



Size	L [inch]	H [inch]	Sensor Type	Part No.	USD
2.0	3.60	3.18	2552-2	10004673	156.00
3.0	4.60	3.18	2552-2	10004686	156.00
4.0	6.26	3.80	2552-2	10004700	156.00
6.0	8.68	4.96	2552-2	10004717	156.00
8.0	5.92	2.96	2552-2	10004740	Call

Transition Saddles for Stainless Steel 1½ Outlet



Size	L [inch]	H [inch]	Sensor Type	Part No.	USD
2.0	3.60	3.18	2552-3, 2540-XX, 3719-11	10004676	156.00
3.0	4.60	3.18	2552-3, 2540-XX, 3719-11	10004689	156.00
4.0	6.26	3.80	2552-3, 2540-XX, 3719-11	10004703	156.00
6.0	8.68	4.96	2552-3, 2540-XX, 3719-11	10004720	156.00
8.0	5.92	2.96	2552-3, 2540-XX, 3719-11	10004743	156.00

PE Socket Fusion X Threaded Transition Fitting



Size [inch]	Process Connection	Sensor Type	Part No.	USD
10	1.25	2552	10013433	212.00
12	1.50	2552	10013434	212.00



General Terms and Conditions of Sale

Always check for the most current General Terms and Conditions and Warranty Statement at www.gfpiping.com under "Price Lists."

GF Piping Systems USA Terms and Conditions (Rev. 03/2013) supersede all previous Terms and Conditions for Georg Fischer LLC, Georg Fischer Sloane LLC, and Georg Fischer Harvel LLC.

It is the responsibility of the Distributor, Dealer, or Agent to provide a current copy of these Terms and Conditions to the Consumers of Georg Fischer Piping products.

Acceptance of Terms and Conditions

Acceptance by Customer of GF Piping Systems USA, (hereinafter "Seller") offer of Products for sale is hereby expressly conditioned upon Customer's acceptance of these General Terms and Conditions of Sale and these General Terms and Conditions of Sale will be deemed accepted, as written, despite any language in Customer's purchase order and/or other documentation which is either conflicting or supplemental, unless promptly after this offer, Customer specifically advises Seller of each term and condition not so accepted and Seller accepts Customer's conflicting and/or supplemental term(s) in writing.

Order Acceptance

Seller reserves the right to accept or reject any order. Possession of a price list by Customer does not constitute an offer to sell.

Credit Approval and Minimum Order Charge

Customer credit approval is required prior to any shipment.

The minimum order is \$100 net.

List Price, Discount or Freight Charges

List prices, discount, and freight terms are subject to change without notice. All prices are F.O.B. Seller's factory or authorized warehouse at Seller's discretion.

Payment Terms

2% 15 days, net 30, from date the invoice is issued unless otherwise stated in a specific quotation. No unauthorized deductions allowed, such as deductions for pending Return Material Transactions that are subject to review. Seller reserves the right to apply a finance charge to the balance of any past-due invoice (over 30 days from date of invoice) at a rate of 1.5% per month, 18% per annum. Payment terms on fusion machine rentals net 30; see rental agreement for more details.

Taxes

Seller charges Customer for all sales, excise and other taxes and governmental charges Seller is required to collect from Customer. Customers claiming exemption must furnish documentation required by law which is satisfactory to Seller to permit Seller to refrain from collecting such charges.

WARRANTY AND LIMITATIONS

Seller's Products are carefully inspected for manufacturing defects; however, it is not always possible to detect hidden defects.

Seller warrants that its products shall conform to the description of such products as provided to Customer by Seller through Seller's catalog, analytical data or other literature. **THIS WARRANTY IS EXCLUSIVE, AND SELLER MAKES NO OTHER WARRANTY, EXPRESS OR IMPLIED, INCLUDING ANY IMPLIED WARRANTY OF MERCHANTABILITY OR FITNESS FOR ANY PARTICULAR PURPOSE OR COURSE OF DEALING OR USAGE OF TRADE – WHICH ARE HEREBY DISCLAIMED.** Seller's warranties made in connection with this sale shall not be effective if Seller has determined, in its sole discretion, that Customer has misused the products in any manner, has failed to use the products in accordance with industry standards and practices, or has failed to use the products in accordance with instructions, if any, furnished by Seller. **Seller does not warrant any Products obtained through an unauthorized Distributor, Dealer, or Agent.**

LIMITATIONS OF REMEDY

Seller's sole and exclusive liability and Customer's exclusive remedy with respect to products proved to Seller's satisfaction to be defective or nonconforming shall be repair or replacement of such products without charge or refund of the purchase price, in Seller's sole discretion, upon the return of such products in accordance with Seller's instructions. **SELLER SHALL NOT IN ANY EVENT BE LIABLE FOR INCIDENTAL, CONSEQUENTIAL OR SPECIAL DAMAGES OF ANY KIND RESULTING FROM ANY USE OR FAILURE OF THE PRODUCTS, EVEN IF SELLER HAS BEEN ADVISED OF THE POSSIBILITY OF SUCH DAMAGE INCLUDING, WITHOUT LIMITATION, LIABILITY FOR LOSS OF USE, LOSS OF WORK IN PROGRESS, DOWN TIME, LOSS OF REVENUE OR PROFITS, FAILURE TO REALIZE SAVINGS, LOSS OF PRODUCTS OF CUSTOMER OR OTHER USE OR ANY LIABILITY OF CUSTOMER TO A THIRD PARTY ON ACCOUNT OF SUCH LOSS, OR FOR ANY LABOR OR ANY OTHER EXPENSE, DAMAGE OR LOSS OCCASIONED BY SUCH PRODUCT INCLUDING PERSONAL INJURY OR PROPERTY DAMAGE.** Any and all claims of Customer against Seller must be brought within one (1) year of Seller's tender of delivery, regardless of their nature.

Order Changes or Cancellations

Cancellation or modifications of orders may be possible only with prior written consent from Seller. Since all orders are individually entered for processing immediately upon receipt, Seller reserves the right to charge back to the Customer costs incurred from either order cancellation or order modification. Seller also reserves the right to consider all order additions as new orders and subject to all terms and conditions.

Seller will not cancel orders for custom or non-cancelable products if Seller has already produced the product or incurred expenses toward producing the product at the time the Customer seeks to cancel.

Delivery

Seller disclaims liability for consequential damages from late deliveries unless seller assumes liability for such damages in writing when the order is placed. Further, Seller disclaims liability where delivery delays caused by strike, differences with workmen, or causes beyond Seller's control, including but not limited to fires, floods, accidents, government actions, shortages of labor, raw materials, production facilities, or transportation. Where delivery delays are caused by labor problems, Seller is not obligated to seek or obtain any settlement which, in Seller's judgment, is not in Seller's best interest.

Standard Packaging

Seller will accept orders from Customer exclusively in multiples of the standard packaging quantity or boxed quantity. Seller reserves the right to reject any order that is not a standard packaging or boxed quantity of a Product.

Freight

Continental US – Full freight will be paid on the following orders:

1. Pipe \$7,500 net or greater in one of the following categories:

- | | | |
|--------------------|--|------------------------------------|
| a. PPro-Seal | f. PVC and CPVC, including shapes and rods | j. LXT |
| b. Contain-It | g. PVC and CPVC, metric | k. Blazemaster |
| c. Fuseal (1½"-6") | h. Duct | l. PE 100 |
| d. SYGEF | i. CTS | m. COOL-FIT ABS |
| e. PROGEF | | n. COOL-FIT ABS Plus Pre-insulated |

Combination of products from one shipping point to meet freight allowance is at the sole discretion of the seller.

2. Fittings, Valves, & Actuation \$1,500 net or greater

Freight allowed orders will be sent by a designated carrier of Seller's choice. Additional charges will be invoiced to Customer for special handling and air freight when requested. Standard Pipe lengths require long truck beds for shipping and may be shipped separately from valves and/or fittings purchased on the same order. Valves and/or fittings will be shipped using practical shipping methods.

Freight will not be paid on the following orders:

- | | |
|--|--|
| 1. Signet Product | 6. Fuseal Large Diameter: 8", 10", 12" Pipe and Fittings |
| 2. Custom Products | 7. COOL-FIT ABS Lite Pipe |
| 3. Heat Exchangers | 8. Double-See |
| 4. PVC and CPVC Fabricated Fittings 14" and larger | 9. International Orders |
| 5. Fuseal Squared, Tanks and Accessories, and Special Fabrications | 10. Fusion Machines and Accessories |

Unless otherwise specified, shipments are surface, prepaid and added to invoice.

Mode of Shipment and Packaging

Seller reserves the right to ship orders in the most economical manner, as long as the product is shipped on or before the promised ship date. If product ships after the promised ship date, Seller may automatically adjust the shipping method to help improve delivery of the delayed shipment, at no additional cost.

If Seller pays freight, Seller may hold shipment until all items become available. Customer bears extra cost of non-standard packaging or handling requested by Customer.

Transfer of Ownership

All products are FOB Seller's facility and title of merchandise transfers when product is loaded onto carrier. Claims for damaged merchandise should be made to carrier by Customer.

Assignment. Customer may not assign its rights under or interest in any purchase order without the prior written consent of Seller. These terms and conditions of sale shall be binding upon and inure to the benefit of Customer and Seller, their successors and permitted assigns.

Technical Documentation and Intellectual Property. Unless specified otherwise, technical documents such as drawings, descriptions, illustrations and the like, constitute only an approximate guide. Seller reserves the right to make any changes considered necessary. Seller expressly reserves any and all intellectual property rights therein.

Non-Conforming Shipments

Customer must notify Seller in writing within 7 days after receipt of shipments not conforming with Customer's order, stating specifically Customer's claim of non-conformity, or Customer is deemed to accept the shipment as is. If Seller is satisfied the shipment is non-conforming, Seller will (i) credit Customer for the price of defective goods or goods shipped but not ordered (including allocated outbound and return freight) upon return of goods; (ii) promptly ship omitted items waiving Seller's new order charges. Customer is required to make timely payment to Seller of any amount which is undisputed or not subject to such claims.

Return of Goods for Credit

Seller accepts returns of certain Engineered Piping Products, Valve and Actuation Products, Signet Instrumentation Products, Waste and Containment Products, and Vinyl Piping Products for a standard restock charge of 25%. Pipe is not returnable. Products denoted with a caret (^) symbol in front of the part number in the current Master Distributor Price List have a 40% restock and products denoted with an asterisk (*) symbol are non-cancelable/non-returnable. Only products purchased within the past twelve (12) months, in original "like new" packaging (full carton quantities), of current design, and listed in the current Master Distributor Price List shall be considered for returns. All products qualifying for return are subject to review for marketability (quantities in question in relationship to historical stock movement) before issuance of a Return Material Authorization (RMA) number. Returns due to Seller's product warranty or order entry/shipping error will not be charged a restock fee.

Product for credit consideration should be returned to Seller's originating location. All returns are subject to inspection upon receipt. No credit will be issued until the returned material has been inspected, accepted, and processed. Customers will be contacted if quantity differences and/or non-acceptable material are found during inspection. Any credit issued will reflect only quantities actually received and accepted by Seller.

Disposition (return to Customer or scrap) of returned product not accepted back by Seller must be provided by Customer within 10 business days, otherwise it will be subject to disposal. All material returns must be accompanied by a valid Return Material Authorization (RMA) number. RMA numbers may be obtained from the Customer Service Department. When requesting a RMA, the original purchase order number and date of purchase must be provided.

All material returns must be received within thirty (30) days of the RMA issuance.

All material returns must be shipped freight prepaid. No collect shipments will be accepted by Seller. Restock charges and prepaid freight do not apply to warranty defective merchandise or returns due to Seller order entry or shipping errors.

Return of Goods for Warranty Evaluation

When requesting a RMA for material evaluation, Customer must first complete and submit a Material Safety Disclosure sheet and Request For Evaluation form obtained from Customer Service. Material arriving to Seller without a valid RMA number will be returned to the customer/distributor, freight collect. RMA numbers must be clearly referenced on all shipping documents and shipping containers.

GF Piping Systems

GF Piping Systems

9271 Jeronimo Road, Irvine, CA 92618

Tel. (714) 731-8800, Toll Free (800) 854-4090, Fax (714) 731-6201

e-mail: us.ps@georgfischer.com

www.gfpiping.com

