

# HP OfficeJet 4650 All-in-One Printer



## Made for your busy mobile lifestyle

Accomplish next-level productivity with the easiest way to print from your smartphone or tablet.<sup>1</sup> Fly through tasks with an Instant Ink ready all-in-one with fax, automatic document feeder, and wireless<sup>2</sup> – and save up to 70% on ink.<sup>3</sup>



### Highlights

- **Print Speed:** Up to 9.5 ppm ISO black (A4); Up to 6.8 ppm ISO colour (A4)
- **Paper Handling:** 100-sheet input tray, 35-sheet Automatic Document Feeder (ADF), 25-sheet output tray
- **Connectivity:** Standard 1 Hi-Speed USB 2.0; 1 Wi-Fi 802.11n
- **Fax Capability:** Yes

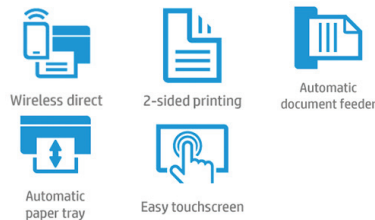

### Affordable at-home printing with HP Instant Ink

- Save up to 70% on ink<sup>3</sup> and never run out of ink. Original HP ink. Ordered by your printer, delivered to your door.<sup>4</sup>
- Print colour, black & white, and photos – your cost is the same.
- Ink cartridges and delivery costs included in your monthly plan price.
- No annual fee – change or cancel plans online anytime without penalty.<sup>5</sup>

### Easy printing from mobile devices

- Your device, your choice. Easily print documents and photos from a variety of smartphones and tablets.<sup>1</sup>
- Start printing and get connected quickly with easy setup from your smartphone, tablet, or PC.<sup>6</sup>
- Connect your smartphone or tablet directly to your printer – and easily print without accessing a network.<sup>2</sup>
- Print remotely without worries. The auto-deploying output tray keeps your pages from landing on the floor.

### Productivity for home and work

- Take charge of your tasks with the easy-to-use 5.5 cm (2.2-inch) display – simply touch and go.
- Use the 35-page automatic document feeder to quickly tackle multipage jobs. Automatic two-sided printing saves paper.
- Print borderless, lab-quality photos and laser-quality documents right in your home.
- Manage printing tasks and scan on the go with the free HP All-in-One Printer Remote mobile app.<sup>7</sup>

### Perfect for your home – and home office

- Save your space with a sleek all-in-one designed to fit where you need it.
- Print in any room you choose – without causing disruptions – using the optional quiet mode.

## Technical specifications

<b>Functions</b>	Print, copy, scan, fax
<b>Print speed</b>	Up to 9.5 ppm ISO black (A4); Up to 6.8 ppm ISO colour (A4) First page out: As fast as 18 sec black (A4, ready); As fast as 20 sec colour (A4, ready)
<b>Print resolution</b>	Up to 1200 x 1200 rendered dpi (when printing from a computer) black; Up to 4800 x 1200 optimised dpi colour (when printing from a computer on selected HP photo papers and 1200 input dpi)
<b>Print technology</b>	HP Thermal Inkjet
<b>Print Area</b>	Print margins: Top: 3.0 mm; Bottom: 3.0 mm; Left: 3.0 mm; Right: 3.0 mm; Maximum print area: 215.9 x 355.6 mm
<b>Print languages</b>	HP PCL 3 GUI
<b>Print capabilities</b>	Borderless printing: Yes (up to 216 x 297 mm)
<b>Print cartridges number</b>	2 (1 each black, tri-colour)
<b>Mobile printing capability</b>	HP ePrint; Apple AirPrint™; Mopria™-certified; Wireless Direct Printing
<b>Monthly duty cycle</b>	Up to 1,200 pages (A4); Recommended monthly page volume: 100 to 400 (print); 20 to 100 (scan)
<b>Automatic paper sensor</b>	Yes
<b>Processor speed</b>	360 MHz
<b>Display</b>	5.5 cm (2.2") Hi-Res Mono LCD
<b>Multitasking supported</b>	No
<b>Wireless Capability</b>	Yes, built-in Wi-Fi 802.11b/g/n
<b>Connectivity</b>	Standard 1 Hi-Speed USB 2.0; 1 Wi-Fi 802.11n
<b>Network Capabilities</b>	Yes, via built-in wireless 802.11b/g/n
<b>Memory</b>	Standard 64 MB DDR1; Maximum 64 MB DDR1
<b>Memory card compatibility</b>	None
<b>Copier settings</b>	Start Black Copy; Start Colour Copy; Number of Copies; 2-sided; Paper Type; Resize; ID Card Copy; Lighter/Darker; Maximum number of copies: Up to 20 copies; Copy resolution: 600 x 300 dpi; Copy resolution, color text and graphics: 600 x 300 dpi; Copier resize: 25 to 400%
<b>Copy speed</b>	Up to 7.5 cpm black ISO (A4); Up to 4 cpm colour ISO (A4)
<b>Scanner specifications</b>	Scanner type: Flatbed, ADF; Scan technology: CIS; Scan input modes: Front-panel scan, copy, HP Scan software; Twain version: Version 2.1; Scan size maximum (flatbed, ADF): 216 x 297 mm; Optical scan resolution: 1200 ppi
<b>Scan file format</b>	TIFF, JPEG, PNG, BMP, PDF, RTF, TXT
<b>Scan speed</b>	4 ppm colour, 8 ppm monochrome (A4); Duplex: ADF does not support duplex scanning
<b>Scannable area</b>	Maximum media size: 216 x 297 mm
<b>Bit depth/ Greyscale levels</b>	24-bit/ 256
<b>Digital sending</b>	Standard: Scan to file (PDF or JPG); Scan to email (PDF or JPG); Everyday Scan (scan to PDF)
<b>Fax</b>	Yes, colour
<b>Fax specifications</b>	Fax memory: Up to 99 pages; Fax resolution: Standard: 1200 x 1200 dpi; Quick dialing: Up to 50 numbers; Fax speed: 4 sec per page
<b>Media types</b>	Plain paper, photo paper, brochure paper
<b>Media sizes</b>	Supported A4; A5; B5; DL; C6; A6; Custom: 76.2 x 127 to 215 x 355 mm (simplex); 76.2 x 140 to 215 x 309 mm (duplex)
<b>Media Handling</b>	Input capacity: Up to 100 sheets; Up to 40 cards cards; Up to 30 sheets photo paper Output capacity: Up to 25 sheets, Up to 5 envelopes Maximum: Up to 25 sheets Duplex printing: Automatic (standard) ADF: Standard, 35 sheets
<b>Paper weight</b>	Supported: 64 to 90 g/m <sup>2</sup> ; Recommended: A4: 75 to 90 g/m <sup>2</sup> ; HP envelopes: 75 to 90 g/m <sup>2</sup> ; HP cards: up to 200 g/m <sup>2</sup> ; HP Premium Plus Photo Paper: up to 300 g/m <sup>2</sup>

<b>What's in the box</b>	<b>K9V85B:</b> HP OfficeJet 4650 All-in-One Printer; HP 302 Setup Black Ink Cartridge (~155 pages); HP 302 Setup Tri-color Ink Cartridge (~100 pages); Software CD; Setup Flyer; Power cord; Print Guide; Phone cord; [For ink volume and page yield information, visit <a href="http://www.hp.com/go/learnaboutsupplies">http://www.hp.com/go/learnaboutsupplies</a> ]
<b>Supplies</b>	<b>CHP210</b> HP Printing Paper-500 sht/A4/210 x 297 mm <b>CHP710</b> HP All-in-One Printing Paper-500 sht/A4/210 x 297 mm <b>F6U65AE</b> HP 302 Tri-color Original Ink Cartridge ~165 pages <b>F6U66AE</b> HP 302 Black Original Ink Cartridge ~190 pages <b>F6U67AE</b> HP 302XL High Yield Tri-color Original Ink Cartridge ~330 pages <b>F6U68AE</b> HP 302XL High Yield Black Original Ink Cartridge ~480 pages <b>Q6593A</b> HP Professional Matt Inkjet Paper-200 sht/A4/210 x 297 mm
<b>Compatible operating systems</b>	Windows 10, Windows 8.1, Windows 8, Windows 7, Windows Vista; OS X v10.8 Mountain Lion, OS X v10.9 Mavericks, OS X v10.10 Yosemite
<b>Minimum system requirements</b>	Windows: Windows 10, 8.1, 8, 7: 32-bit or 64-bit, 2 GB available hard disk space, CD-ROM/DVD drive or Internet connection, USB port, Internet Explorer; Windows Vista: 2 GB available hard disk space, CD-ROM/DVD drive or Internet connection, USB port, Internet Explorer 8 Mac: Apple® OS X Yosemite (v10.10), OS X Mavericks (v10.9), OS X Mountain Lion (v10.8); 1 GB available hard disk space, Internet, USB
<b>Software included</b>	HP Printer Software, HP Update, OCR, HP Photo Creations
<b>Printer dimensions (W x D x H)</b>	Minimum: 445 x 369 x 190 mm; Maximum: 445 x 564 x 198 mm
<b>Package dimensions (W x D x H)</b>	485 x 231 x 445 mm
<b>Printer Weight</b>	6.55 kg
<b>Package weight</b>	7.78 kg
<b>Operating environment</b>	Temperature: 5 to 40°C, Humidity: 20% to 80% RH non-condensing
<b>Storage</b>	Temperature: -40 to 60°C, Humidity: 20% to 80% RH non-condensing
<b>Acoustics</b>	Acoustic power emissions: Print colour, simplex, normal mode, A4 paper: 6.1 B(A); Print mono, simplex, normal mode, A4 paper: 6.4 B(A); Print colour, simplex, quiet mode, A4 paper: 5.5 B(A); Print mono, simplex, quiet mode, A4 paper: 5.7 B(A); Acoustic pressure emissions: 48 dB(A) colour; 50 dB(A) monochrome
<b>Power</b>	Requirements: Input voltage: 100 to 240 VAC (+/- 10%), 50/60 Hz (+/- 3 Hz), 0.7 A Consumption: Up to 15 watts (printing), 12 watts (copy), 3.45 watts (ready), 0.65 watts (sleep), 0.15 watts (off) Power supply type: Built-in power supply
<b>Certifications</b>	CISPR 22:2008/EN 55022:2010 (Class B); CISPR 24:2010/EN 55024:2010; EN 301 489-1 v1.9.2:2011; EN 301 489-17 v2.2.1:2012; EN 61000-3-2:2006 +A1:2009 +A2:2009; EN 61000-3-3:2008; EMC Directive 2004/108/EC with CE Marking (Europe) Energy Star Qualified: Yes
<b>Country of origin</b>	Made in Thailand
<b>Warranty</b>	One-year commercial hardware warranty, 24-hour, 7 days a week Web support
<b>Service and support</b>	<b>UG195E</b> HP 3 year Care Pack with Standard Exchange for Officejet Printers <b>UG071E</b> HP 3 year Care Pack with Next Day Exchange for Officejet Printers <b>UG244E</b> HP 3 year Care Pack with Return to Depot Support for Officejet Printers (UG195E: all EMEA countries, except ME, Africa, South Africa, Israel, Turkey, UG071E: Austria, Belgium, Denmark, Finland, France, Germany, Ireland, Italy, Netherlands, Norway, Portugal, Spain, Sweden, Switzerland, UK, Czech, Greece, Hungary, Poland, Slovakia, UG244E: ME, Africa, South Africa, Israel, Turkey)

## Footnotes

<sup>1</sup> In comparison to the majority of consumer/home office inkjet all-in-one printers < £200 as of Nov 2014 based on market share as reported by IDC. App download required for printer setup. HP ePrint account registration may be required. Wireless operations are compatible with 2.4 GHz operations only. See [hp.com/go/mobileprinting](http://hp.com/go/mobileprinting) for more details.; <sup>2</sup> Mobile device needs to be connected directly to the Wi-Fi Direct signal of a Wi-Fi Direct-supported AIO or printer prior to printing. Depending on mobile device, a free app or driver may also be required. For details, see [hp.com/go/mobileprinting](http://hp.com/go/mobileprinting).; <sup>3</sup> Savings based on HP Instant Ink service 300 page plan savings of up to 80% (savings for 100 page plan up to 75% and 50 page plan up to 70%), based on 12 months and use of all pages in plan without purchase of additional sets of pages compared to an average cost per page (CPP) to print ISO/IEC 24711 pages on a selection of colour inkjet printers less than £200 using standard capacity cartridges as reported by IDC in Q2 2015. Survey based upon indicative manufacturers' supplies pricing as reported by GfK as of June 2015 and page yield listed on original manufacturer website as of October 2015. For further details please refer to [hp.com/go/ukcompare](http://hp.com/go/ukcompare). All prices include VAT. ISO yield based on continuous printing in default mode. Actual savings may vary depending on number of pages actually printed per month and content of pages printed. For more information on ISO standards: [hp.com/go/pageyield](http://hp.com/go/pageyield).; <sup>4</sup> Ordered by your printer when needed subject to customer internet connection. Availability may vary in exceptional circumstances. Express deliveries available via Support Services at [hp.com/go/instantinksupport](http://hp.com/go/instantinksupport) or by calling 0207 660 0596 if you use more ink than anticipated.; <sup>5</sup> Change or cancel your plan at anytime online. If you decide to cancel your HP Instant Ink plan you can go back to using HP original Standard or XL cartridges. Plan upgrades are effective immediately and the charges will be applied retrospectively or in the next billing cycle, depending on user choice. Plan downgrades and cancellations are effective after the last day of the current billing period. For full details go to [instantink.hpconnect.com/uk/en/terms](http://instantink.hpconnect.com/uk/en/terms).; <sup>6</sup> Requires HP All-in-One Printer Remote mobile app download and is compatible with iPhone® 4 and later, iPad® fourth generation, iPad mini™, iPad Air®, iPod®, and mobile devices using Android™ 4.0.3 or later. For a full list of supported operating systems, see [hp.com/go/mobileprinting](http://hp.com/go/mobileprinting).; <sup>7</sup> Compatible with iPhone® 4 and later, iPad® fourth generation, iPad mini™, iPad Air®, iPod® 5G using iOS 7 or later, and mobile devices using Android™ 4.0.3 or later. Features controlled may vary by mobile device operating system. For mobile scanning, device camera requires 5 megapixels or greater with autofocus capability.



<http://www.hp.com/uk>

The product could differ from the images shown. © Copyright 2016 HP Development Company, L.P. The information contained herein is subject to change without notice. The only warranties for HP products and services are set forth in the express warranty statements accompanying such products and services. Nothing herein should be construed as constituting an additional warranty. HP shall not be liable for technical or editorial errors or omissions contained herein.

