

- > Port size: 3/4" ... 1 1/2" (ISO G/ PTF)
- > Olympian Plus plug in system
- > Effective liquid removal and positive solid particle filtration
- > Large filter element area provides minimum pressure drop



**Technical features**

**Medium:**  
Compressed air only

**Maximum operating pressure:**  
17 bar (246 psi)

**Filter element:**  
40 µm (standard), 5 µm optional

**Port sizes:**  
3/4", 1", 1 1/4" or 1 1/2"

**Flow:**  
See table below

**Drain:**  
Manual or automatic

**Automatic drain conditions:**  
Pressure to close drain:  
> 0,3 bar (4.3 psi)  
Pressure to open drain:  
< 0,2 bar (2.9 psi)  
Minimum air flow to close drain:  
0,6 dm³/s (1.3 scfm)

**Service life indicator:**  
Available on request

**Bowl size:**  
1 litre (34 fluid oz optional)

**Ambient/Media temperature:**  
-20° ... +80°C (-4° ... +176°F)  
Air supply must be dry enough to avoid ice formation at temperatures below +2°C (+35°F).

**Materials:**  
Body, yoke and bowl: Aluminium  
Liquid level indicator: Pyrex  
Element: Sintered plastic  
Elastomers: NBR

**Technical data - standard models**

Symbol	Port size	Size	Drain	Filter element (µm)	Flow *1) (dm³/s)	Weight (kg)	Model
	3/4"	—	Automatic	40	160	2,45	F68E-6GN-AU3 F68E-6AN-AU3
	1"	Basic	Automatic	40	190	2,33	F68E-8GN-AU3 F68E-8AN-AU3
	1 1/4"	—	Automatic	40	200	2,43	F68E-AGN-AU3 F68E-AAN-AU3
	1 1/2"	—	Automatic	40	200	2,30	F68E-BGN-AU3 F68E-BAN-AU3
	Without yoke	—	Automatic	40			F68E-NNN-AU3 F68E-NNN-AU3
	3/4"	—	Automatic	5	160	2,45	F68E-6GN-AU1 F68E-6AN-AU1
	1"	Basic	Automatic	5	190	2,33	F68E-8GN-AU1 F68E-8AN-AU1
	1 1/4"	—	Automatic	5	200	2,43	F68E-AGN-AU1 F68E-AAN-AU1
	1 1/2"	—	Automatic	5	200	2,30	F68E-BGN-AU1 F68E-BAN-AU1
	Without yoke	—	Automatic	5			F68E-NNN-AU1 F68E-NNN-AU1

\* Typical flow with inlet pressure 6,3 bar (91 psi) set pressure and 0,5 bar (7 psi) drop from set.

**Option selector**

F68★-★-★-★-★-★

<b>Version</b>	Substitute	←	→	<b>Element</b>	Substitute
Long bowl (1 litre)	E			5 µm	1
Standard bowl (0,5 litre)	G			40 µm (standard)	3
<b>Port size</b>	Substitute	←	→	<b>Bowl</b>	Substitute
3/4"	6			0,5 l wi h liquid level indicator	R
1"	8			1 l wi h liquid level indicator (standard)	U *1)
1 1/4"	A			0,5 l no liquid level indicator	M
1 1/2"	B			1 l no liquid level indicator	C *1)
Without yoke	N			<b>Drain</b>	Substitute
<b>Thread</b>	Substitute	←	→	Automatic (standard)	A
NPT	A			Closed bowl	E
ISO G parallel (standard)	G			Manual-plastic handle	M
Without yoke (standard)	N			Manual-quarter turn	Q
<b>Service life indicator</b>	Substitute	←	→	Manual-metal handle	D
Without (standard)	N				
Mechanical	D				
Electrical	E				

\*1 ) Units with 1 litre bowl are available only with 'E' version only; therefore substitute E at the 4th digit and U or C at the 9th position.





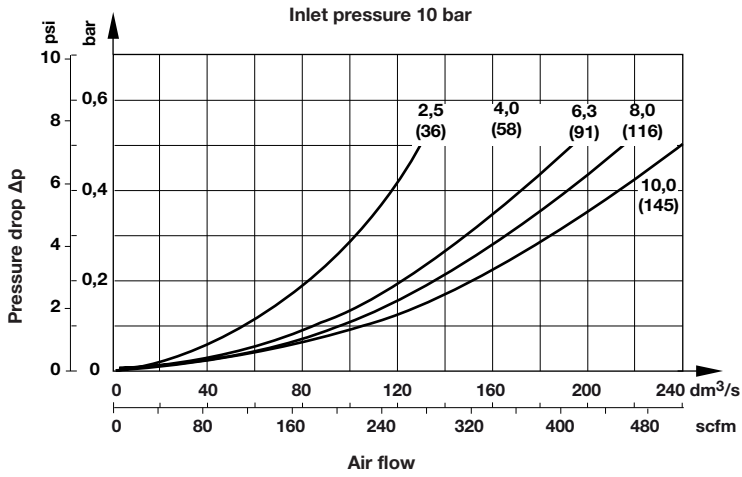

### Flow characteristics



Port size 1", 40 µm element,  
Inlet pressure: 6,3 bar (91 psi)





**Accessories, service kit and gauges**

**Accessories**

	Single yoke	Double yoke	End connector kit	Single yoke non threads	3/2 Shut-off valve Threaded inlet only	Threaded outlet only	Bracket mounting
							
<b>Thread</b>	<b>5</b>	<b>5</b>	<b>2</b>	<b>5</b>	<b>8</b>	<b>8</b>	<b>1</b>
G3/4	Y68A-6GN-N1N	Y68A-6GN-N2N	5524-55	74785-98	T68H-6GB-B2N	T68H-6GC-B2N	18-001-979
G1	Y68A-8GN-N1N	Y68A-8GN-N2N	5524-52		T68H-8GB-B2N	T68H-8GC-B2N	18-001-979
G1 1/4	Y68A-AGN-N1N	Y68A-AGN-N2N	5523-52		T68H-AGB-B2N	T68H-AGC-B2N	18-001-978
G1 1/2	Y68A-BGN-N1N	Y68A-BGN-N2N	5523-93		T68H-BGB-B2N	T68H-BGC-B2N	18-001-972
3/4 PTF	Y68A-6AN-N1N	Y68A-6AN-N2N	5524-53		T68H-6AB-B2N	T68H-6AC-B2N	18-001-979
1 PTF	Y68A-8AN-N1N	Y68A-8AN-N2N	5524-50		T68H-8AB-B2N	T68H-8AC-B2N	18-001-979
1 1/4 PTF	Y68A-AAN-N1N	Y68A-AAN-N2N	5523-50		T68H-AAB-B2N	T68H-AAC-B2N	18-001-978
1 1/2 PTF	Y68A-BAN-N1N	Y68A-BAN-N2N	5523-95		T68H-BAB-B2N	T68H-BAC-B2N	18-001-972

Nut	Porting block
	
<b>4</b>	
5520-89	18-026-986 (G1/4 & G1/2)
	18-026-983 (1/4 & 1/2 NPT)

**Service kit**

Service kit manual drain	Service kit automatic drain
	
F68G-KITM05 (5 µm)	F68G-KITA05 (5 µm)
F68G-KITM40 (40 µm)	F68G-KITA40 (40 µm)

**Dimensions**

Dimensions in mm  
 Projection/First angle

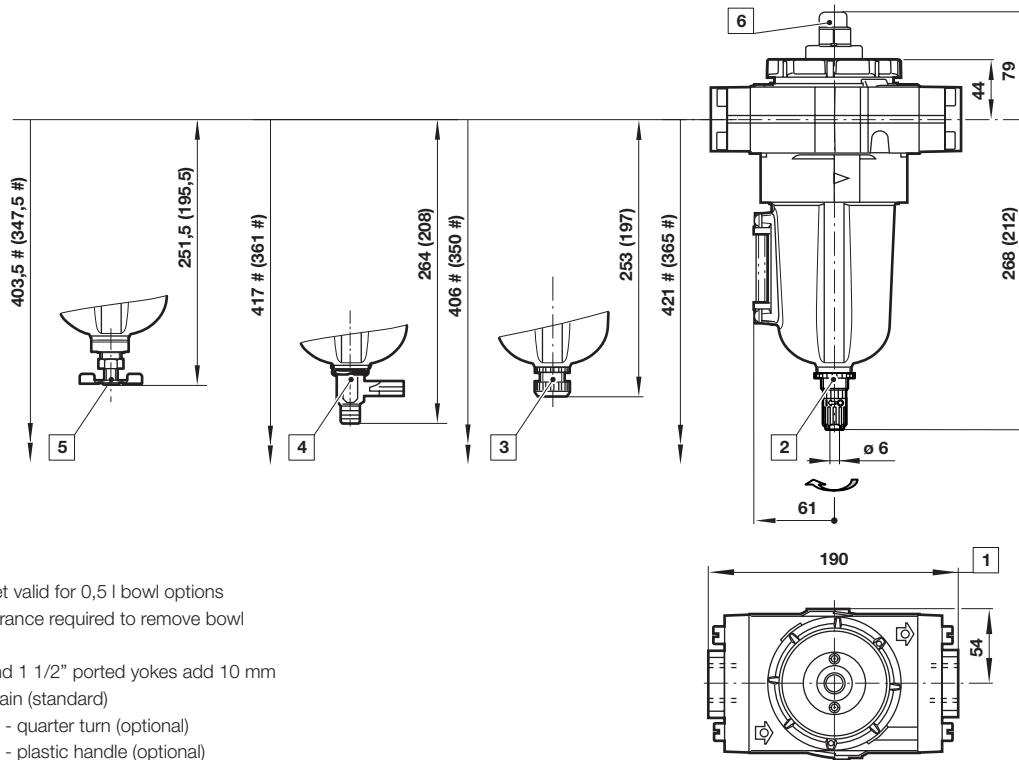

Values in bracket valid for 0,5 l bowl options  
 # Minimum clearance required to remove bowl

- 1 For 1 1/4" and 1 1/2" ported yokes add 10 mm
- 2 Automatic drain (standard)
- 3 Manual drain - quarter turn (optional)
- 4 Manual drain - plastic handle (optional)
- 5 Manual drain - metal handle (optional)
- 6 Service life indicator (optional)

**Single yoke with bracket**

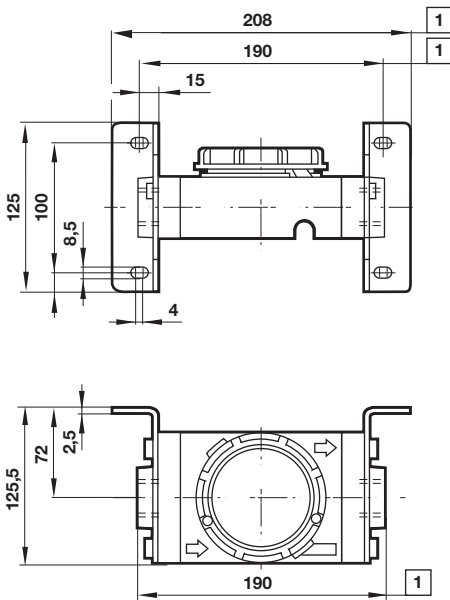

1 For 1 1/4" and 1 1/2" ported yokes add 10 mm

**Double yoke with bracket**

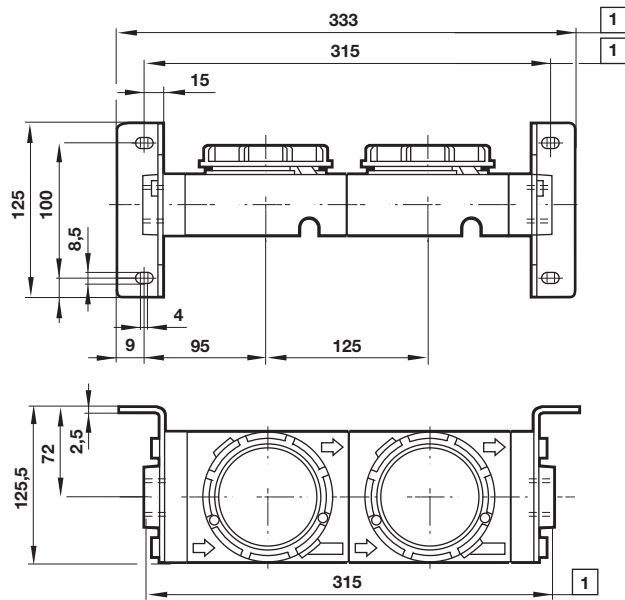

1 For 1 1/4" and 1 1/2" ported yokes add 10 mm

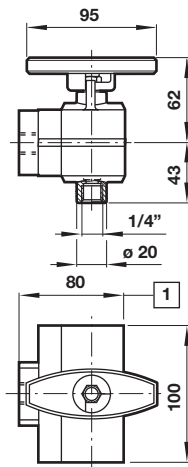
**3/2 Shut-off valve**

**1** For 1 1/2" ported yokes add 5 mm

**Porting block**

Dimensions in mm  
Projection/First angle

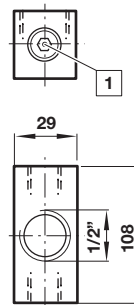

**1** Two additional plugged G1/4 ports

**Warning**

These products are intended for use in industrial compressed air systems only. Do not use these products where pressures and temperatures can exceed those listed under

»**Technical features/data**«.

Before using these products with fluids other than those specified, for non-industrial applications, life-support systems or other applications not within published specifications, consult IMI NORGREN.

Through misuse, age, or malfunction, components used in fluid power systems can fail in various modes.

The system designer is warned to consider the failure modes of all component parts used in fluid power systems and to provide adequate safeguards to prevent personal injury or damage to equipment in the event of such failure.

System designers must provide a warning to end users in the system instructional manual if protection against a failure mode cannot be adequately provided.

System designers and end users are cautioned to review specific warnings found in instruction sheets packed and shipped with these products.