

Multiple socket outlet modular MEDX ZPA



Modular. Individual. Unique.

The multiple socket outlet MEDX ZPA offers customized solution for your system. This multiple socket outlet fits in terms of load and place ideal for changing circumstances. The unique construction allows an customised manufacturing, without renouncing important features. Each module has an additional potential equalization and two fuse-links. Your electrical system is optimally protected against failure.

A further advantage is the additional potential equalization on the housing so that the multiple socket outlet multiple socket outlet can be used simultaneously as a local ZPA distributor.

Advantages:

- VDE power sockets with VDE seal of approval
- Each power socket redundantly-fused
- 2.5 mm² thick cable with anti-kink protection
- Safety lock for preventing accidental modification of the electrical system
- TÜV tested for use with anaesthesia equipment

Perfektion durch Vielfalt.

Secure Systems: The multiple socket outlet MEDX ZPA impresses with its versatility and can perfectly be adapted to your system. According to the modular principle, up to 8 modules can be manufactured to a multiple socket outlet with a power cable of three or five meters. Each module is equipped with a single Guard KIT, to prevent accidental changes of the electrical system.

The modular multiple socket outlet concept offers a cost-effective solution that allows to procure only the required number of socket outlets.

Subsequent extensions of your electrical system do not require a new multiple socket outlet. The missing module can be extended by us.

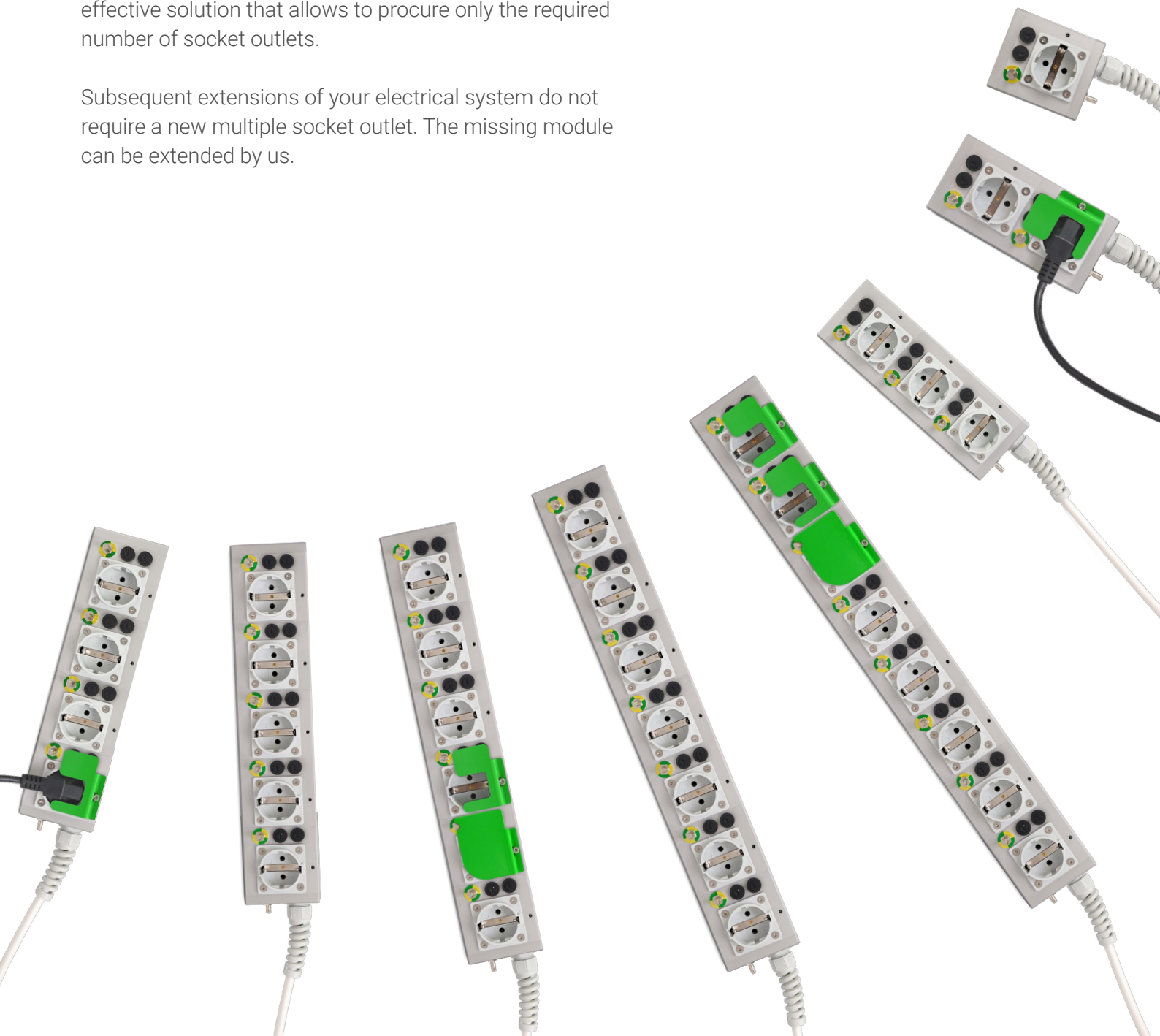

Features



Modular – as required available with 1 up to 8 socket outlets. Inclusive additional potential equalization for each socket insert.



2 fuses per socket insert for immediate detection of failures. Replaceable during operation.



Safety locks for preventing modifications of the electrical system.



Additional potential equalization on the case, and 11 mm thick power cable with 2.5 mm² single lines and kink protection on the housing.

Options



Circuit breaker module
Resettable thermal protection, 14 A,
Art. No. 2012264



Circuit breaker module
Switchable thermal protection with push buttons, 14 A
Art. No. 2012258

Technical data

MEDX ZPA

Fuse protection power socket insert	2 microfuses, each 5x 20 mm (DIN EN 60127-2/VDE 0820-2)
ZPA (PE) connector	according to DIN 42801
Cable length	3 m 5 m
Number of modules min	1
Number of modules max	8
Total load each sockets	max. 2000 W
Total load multiple socket outlet	3600 W max. 3000 W max. when using modules with thermal circuit breaker
Dimensions per modul (LDH)	90x 78x 60 mm
Case	Anodized aluminum
Standards	IEC 60601-1:2005 + A1:2012 IEC 60601-1:2005 + A1:2012/AMD1:2012 ISO 80601-2-13:2011/AMD1:2005
Delivery per modul	1x individual multiple socket outlet *, 1x MEDX ZPA single guard kit green, 1x tee-handled socket wrench

*Production according to customer requirements - not independently changeable.

Patent pending.

Accessories

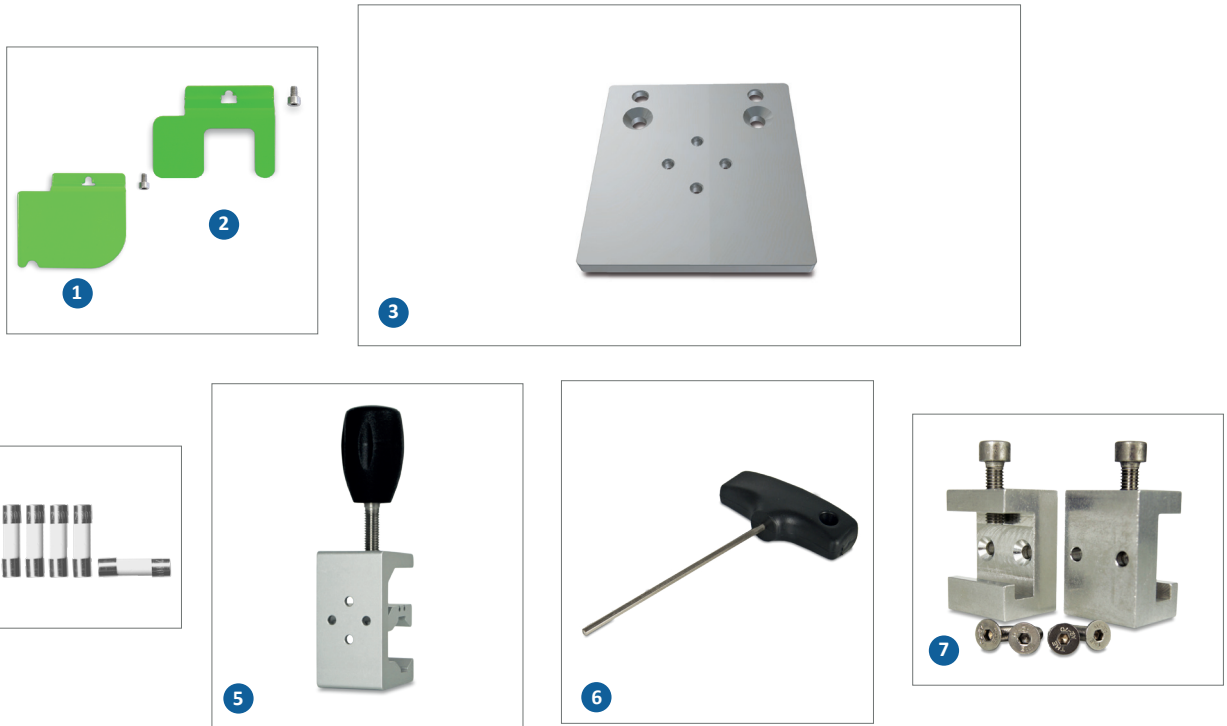

Safety locks

To prevent accidental pulling out or adding of SCHUKO plugs.

- 1 MEDX green cap kit, covers 1 power socket
Order number: 2011449
- 2 MEDX green removal protection kit, covers: 1 power socket
1 ea. per modul in the scope of delivery of the MEDX ZPA.
Order number: 2011468

Pipe mounting

Clamp for a standard < 40mm. This clamp can be connected to the mounting bracket. Mounting diameter max. 40mm. In combination with mounting plate (order number 2011574).

- 5 Pipe mounting for 1-3 Module. A second pipe mounting is recommended for 4 or more modules.
Order number: 2006327

Mounting plate

Universal mounting plate for wall mount or with additional accessories on standard rails or poles.

- 3 A second mounting plate is recommended for 2 or more modules
Order number: 20115

Tee-handled socket wrench

For the easy loosening and attachment of the guard bracket on the MEDX ZPA multiple socket outlet.

- 6 1 ea. in the scope of delivery of the MEDX ZPA.
Order number: 2007233

Set microfuse MEDX/MED5

Set of 10 microfuses. Accessory for the multiple sockets MEDX and MED5 ZPA.

- 4 Tripping characteristic: slow blow -T-, Fuse construction: ceramic tube with extinguishing medium
Order number: 2012267

Standard rails clips (2 ea.)

2 standard rails clips for mounting the multiple socket outlet to standard rails. In combination with mounting plate (order number 2011574).

- 7 A second mounting plate is recommended for 2 or more modules
Order number: 2007208