

ER collet system of VERTEX is made of special elastic steel material under excellent heat treatment and precise grinding process, so it has precise accuracy, powerful clamping ability, and is durable. This collet can clamp for a specific standard size and its next size, (Refer to the data sheet on page 2). It can be widely used for boring, milling, drilling and tapping as well as for grinding operation, and is available for all sizes.

ER COLLET DIMENSIONS

TYPE	A	B
ER-8	8.5	13.5
ER-11	11.5	18
ER-16	17	27
ER-20	21	31
ER-25	26	35
ER-32	33	40
ER-40	41	46
ER-50	52	60

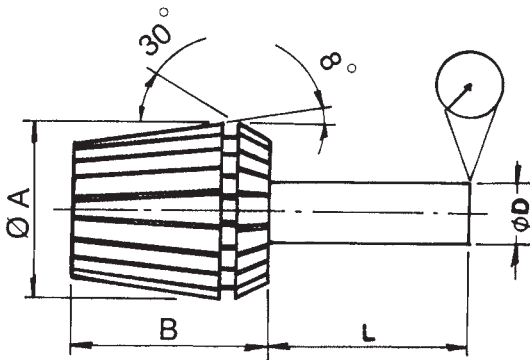

L mm	D mm	DIN6343 Standard precision	VERTEX Standard precision	A Grade Optional
6	1.0-1.4	0.02	0.015	0.01
10	1.5-2.9	0.02	0.015	0.01
16	3.0-5.9	0.02	0.015	0.01
25	6.0-9.9	0.02	0.015	0.01
40	10.0-17.9	0.03	0.02	0.01
50	18.0-26.9	0.03	0.02	0.01
60	27.0-34.9	0.03	0.02	0.01

THE HIGH PRECISION OF A GRADE IS AVAILABLE

double-taper chuck

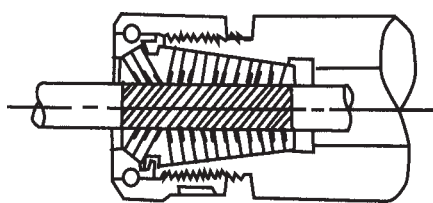

single-taper chuck

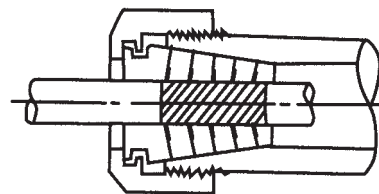

POWERFUL CLAMPING STRENGTH

The handle of the drill with double-taper chuck is longer than that with single-taper (grinding spring) collet. The clamping strength will be more powerful, if a screw-driver fastened by steel ball is adopted.

Mounting instructions for ER collets DIN 6499-A and DIN 6499-B

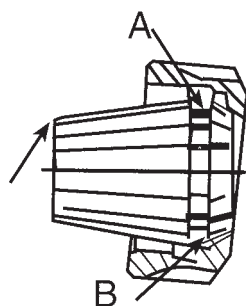

A - Place collet inside nut and rotate the nut to engage with the extractor spiral in collet groove.

B - Only then mount nut and collet together into the collet holder or machine spindle.

Note: Never use a 12-11mm collet to clamp a 12.2mm diameter, but rather use a 13-12mm collet.



ER Spring Collet Chuck System



STANDARD PRECISION TYPE

DIN 6499



ER COLLET SET WITH CLAMPING RANGE

TYPE	ER-8			ER-11			ER-16			ER-20		
COMPLET SET	9PCS/SET			7PCS/SET			10PCS/SET			12PCS/SET		
FULL SET	ORDER NO.	CAP. mm Ø	CODE NO.	ORDER NO.	CAP. mm Ø	CODE NO.	ORDER NO.	CAP. mm Ø	CODE NO.	ORDER NO.	CAP. mm Ø	CODE NO.
	V08000	0.5-5.0	3001-101	V11000	0.5-7.0	3002-101	V16000	0.5-10.0	3003-101	V20000	1-13	3004-101
INDIVIDUAL UNIT	V08010	1.0-0.5	3001-001	V11010	1.0-0.5	3002-001	V16010	1.0-0.5	3003-001	V20020	2-1	3004-001
	V08015	1.5-1.0	3001-002	V11020	2.0-1.5	3002-002	V16020	2.0-1.0	3003-002	V20030	3-2	3004-002
	V08020	2.0-1.5	3001-003	V11030	3.0-2.5	3002-003	V16030	3.0-2.0	3003-003	V20040	4-3	3004-003
	V08025	2.5-2.0	3001-004	V11040	4.0-3.5	3002-004	V16040	4.0-3.0	3003-004	V20050	5-4	3004-004
	V08030	3.0-2.5	3001-005	V11050	5.0-4.5	3002-005	V16050	5.0-4.0	3003-005	V20060	6-5	3004-005
	V08035	3.5-3.0	3001-006	V11060	6.0-5.5	3002-006	V16060	6.0-5.0	3003-006	V20070	7-6	3004-006
	V08040	4.0-3.5	3001-007	V11070	7.0-6.5	3002-007	V16070	7.0-6.0	3003-007	V20080	8-7	3004-007
	V08045	4.5-4.0	3001-008	V11015	1.5	3002-008	V16080	8.0-7.0	3003-008	V20090	9-8	3004-008
	V08050	5.0-4.5	3001-009	V11025	2.5	3002-009	V16090	9.0-8.0	3003-009	V20100	10-9	3004-009
				V11035	3.5	3002-010	V16100	10.0-9.0	3003-010	V20110	11-10	3004-010
				V11045	4.5	3002-011	V16015	1.5	3003-011	V20120	12-11	3004-011
				V11055	5.5	3002-012	V16025	2.5	3003-012	V20130	13-12	3004-012
				V11065	6.5	3002-013	V16035	3.5	3003-013	V20010	1.0	3004-013
							V16045	4.5	3003-014	V20025	2.5	3004-014
							V16055	5.5	3003-015	V20035	3.5	3004-015
							V16065	6.5	3003-016	V20045	4.5	3004-016
							V16075	7.5	3003-017	V20055	5.5	3004-017
							V16085	8.5	3003-018	V20065	6.5	3004-018
							V16095	9.5	3003-019	V20075	7.5	3004-019
									V20085	8.5	3004-020	
									V20095	9.5	3004-021	
									V20105	10.5	3004-022	
									V20115	11.5	3004-023	
									V20125	12.5	3004-024	
	Note: APPROXIMATE FOR EACH		WEIGHT (kgs)									
	ER-8		0.001									
	ER-11		0.02									
	ER-16		0.04									
	ER-20		0.05									
	ER-25		0.07									
	ER-32		0.15									
	ER-40		0.28									
	ER-50		0.54									



ER Spring Collet Chuck System



STANDARD PRECISION TYPE

DIN 6499



ER COLLET SET WITH CLAMPING RANGE

ER-25			ER-32			ER-40			ER-50		
15PCS/SET			18PCS/SET			23PCS/SET			12PCS/SET		
ORDER NO.	CAP. mm Ø	CODE NO.	ORDER NO.	CAP. mm Ø	CODE NO.	ORDER NO.	CAP. mm Ø	CODE NO.	ORDER NO.	CAP. mm Ø	CODE NO.
V25000	1-16	3005-101	V32000	2-20	3006-101	V40000	3-26	3007-101	V50000	10-34	3008-101
V25020	2-1	3005-001	V32030	3-2	3006-001	V40040	4-3	3007-001	V50120	12-10	3008-001
V25030	3-2	3005-002	V32040	4-3	3006-002	V40050	5-4	3007-002	V50140	14-12	3008-002
V25040	4-3	3005-003	V32050	5-4	3006-003	V40060	6-5	3007-003	V50160	16-14	3008-003
V25050	5-4	3005-004	V32060	6-5	3006-004	V40070	7-6	3007-004	V50180	18-16	3008-004
V25060	6-5	3005-005	V32070	7-6	3006-005	V40080	8-7	3007-005	V50200	20-18	3008-005
V25070	7-6	3005-006	V32080	8-7	3006-006	V40090	9-8	3007-006	V50220	22-20	3008-006
V25080	8-7	3005-007	V32090	9-8	3006-007	V40100	10-9	3007-007	V50240	24-22	3008-007
V25090	9-8	3005-008	V32100	10-9	3006-008	V40110	11-10	3007-008	V50260	26-24	3008-008
V25100	10-9	3005-009	V32110	11-10	3006-009	V40120	12-11	3007-009	V50280	28-26	3008-009
V25110	11-10	3005-010	V32120	12-11	3006-010	V40130	13-12	3007-010	V50300	30-28	3008-010
V25120	12-11	3005-011	V32130	13-12	3006-011	V40140	14-13	3007-011	V50320	32-30	3008-011
V25130	13-12	3005-012	V32140	14-13	3006-012	V40150	15-14	3007-012	V50340	34-32	3008-012
V25140	14-13	3005-013	V32150	15-14	3006-013	V40160	16-15	3007-013			
V25150	15-14	3005-014	V32160	16-15	3006-014	V40170	17-16	3007-014			
V25160	16-15	3005-015	V32170	17-16	3006-015	V40180	18-17	3007-015			
			V32180	18-17	3006-016	V40190	19-18	3007-016			
			V32190	19-18	3006-017	V40200	20-19	3007-017			
			V32200	20-19	3006-018	V40210	21-20	3007-018			
						V40220	22-21	3007-019			
						V40230	23-22	3007-020			
						V40240	24-23	3007-021			
						V40250	25-24	3007-022			
						V40260	26-25	3007-023			



ER Spring Collet Chuck System



SUPER ULTRA PRECISION TYPE

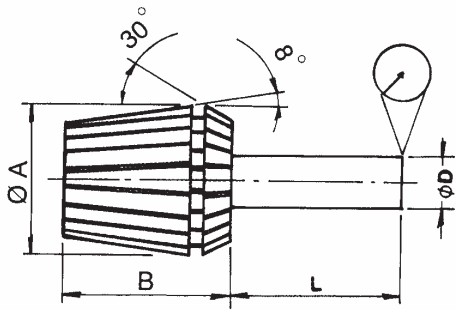

DIMENSIONS

TYPE	D	H
ER08	8.5	13.5
ER11	11.5	18
ER16	17	27
ER20	21	31
ER25	26	35
ER32	33	40
ER40	41	46
ER50	52	60

S GRADE Accuracy

L(mm)	øD(mm)	Ultra Precision(MM)
6	1.0-1.4	0.01
10	1.5-2.9	0.01
16	3.0-5.9	0.01
25	6.0-9.9	0.01
40	10.0-17.9	0.01
50	18.0-26.9	0.01
60	27.0-34.9	0.01

TYPE	ER-8			ER-11			ER-16			ER-20		
COMPLET SET	9PCS/SET			7PCS/SET			10PCS/SET			12PCS/SET		
FULL SET	ORDER NO.	CAP. mm Ø	CODE NO.	ORDER NO.	CAP. mm Ø	CODE NO.	ORDER NO.	CAP. mm Ø	CODE NO.	ORDER NO.	CAP. mm Ø	CODE NO.
	V08000S	0.5-5.0	3000-001	V11000S	0.5-7.0	3000-002	V16000S	0.5-10.0	3000-003	V20000S	1-13	3000-004
INDIVIDUAL UNIT	V08010S	1.0-0.5	3000-010	V11010S	1.0-0.5	3000-020	V16010S	1.0-0.5	3000-040	V20020S	2-1	3000-060
	V08015S	1.5-1.0	3000-011	V11020S	2.0-1.5	3000-021	V16020S	2.0-1.0	3000-041	V20030S	3-2	3000-061
	V08020S	2.0-1.5	3000-012	V11030S	3.0-2.5	3000-022	V16030S	3.0-2.0	3000-042	V20040S	4-3	3000-062
	V08025S	2.5-2.0	3000-013	V11040S	4.0-3.5	3000-023	V16040S	4.0-3.0	3000-043	V20050S	5-4	3000-063
	V08030S	3.0-2.5	3000-014	V11050S	5.0-4.5	3000-024	V16050S	5.0-4.0	3000-044	V20060S	6-5	3000-064
	V08035S	3.5-3.0	3000-015	V11060S	6.0-5.5	3000-025	V16060S	6.0-5.0	3000-045	V20070S	7-6	3000-065
	V08040S	4.0-3.5	3000-016	V11070S	7.0-6.5	3000-026	V16070S	7.0-6.0	3000-046	V20080S	8-7	3000-066
	V08045S	4.5-4.0	3000-017	V11015S	1.5	3000-027	V16080S	8.0-7.0	3000-047	V20090S	9-8	3000-067
	V08050S	5.0-4.5	3000-018	V11025S	2.5	3000-028	V16090S	9.0-8.0	3000-048	V20100S	10-9	3000-068
				V11035S	3.5	3000-029	V16100S	10.0-9.0	3000-049	V20110S	11-10	3000-069
				V11045S	4.5	3000-030	V16015S	1.5	3000-050	V20120S	12-11	3000-070
				V11055S	5.5	3000-031	V16025S	2.5	3000-051	V20130S	13-12	3000-071
				V11065S	6.5	3000-032	V16035S	3.5	3000-052	V20010S	1.0	3000-072
							V16045S	4.5	3000-053	V20025S	2.5	3000-073
							V16055S	5.5	3000-054	V20035S	3.5	3000-074
							V16065S	6.5	3000-055	V20045S	4.5	3000-075
							V16075S	7.5	3000-056	V20055S	5.5	3000-076
							V16085S	8.5	3000-057	V20065S	6.5	3000-077
							V16095S	9.5	3000-058	V20075S	7.5	3000-078
										V20085S	8.5	3000-079
									V20095S	9.5	3000-080	
									V20105S	10.5	3000-081	
									V20115S	11.5	3000-082	
									V20125S	12.5	3000-083	



ER Spring Collet Chuck System



SUPER ULTRA PRECISION TYPE

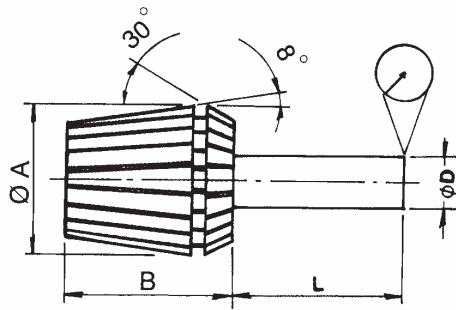

DIMENSIONS

TYPE	D	H
ER08	8.5	13.5
ER11	11.5	18
ER16	17	27
ER20	21	31
ER25	26	35
ER32	33	40
ER40	41	46
ER50	52	60

S GRADE Accuracy

L(mm)	øD(mm)	Ultra Precision(MM)
6	1.0-1.4	0.01
10	1.5-2.9	0.01
16	3.0-5.9	0.01
25	6.0-9.9	0.01
40	10.0-17.9	0.01
50	18.0-26.9	0.01
60	27.0-34.9	0.01



ER-25			ER-32			ER-40			ER-50		
15PCS/SET			18PCS/SET			23PCS/SET			12PCS/SET		
ORDER NO.	CAP. mm Ø	CODE NO.	ORDER NO.	CAP. mm Ø	CODE NO.	ORDER NO.	CAP. mm Ø	CODE NO.	ORDER NO.	CAP. mm Ø	CODE NO.
V25000S	1-16	3000-005	V32000S	2-20	3000-006	V40000S	3-26	3000-007	V50000S	10-34	3000-008
V25020S	2-1	3000-090	V32030S	3-2	3000-110	V40040S	4-3	3000-130	V50120S	12-10	3000-160
V25030S	3-2	3000-091	V32040S	4-3	3000-111	V40050S	5-4	3000-131	V50140S	14-12	3000-161
V25040S	4-3	3000-092	V32050S	5-4	3000-112	V40060S	6-5	3000-132	V50160S	16-14	3000-162
V25050S	5-4	3000-093	V32060S	6-5	3000-113	V40070S	7-6	3000-133	V50180S	18-16	3000-163
V25060S	6-5	3000-094	V32070S	7-6	3000-114	V40080S	8-7	3000-134	V50200S	20-18	3000-164
V25070S	7-6	3000-095	V32080S	8-7	3000-115	V40090S	9-8	3000-135	V50220S	22-20	3000-165
V25080S	8-7	3000-096	V32090S	9-8	3000-116	V40100S	10-9	3000-136	V50240S	24-22	3000-166
V25090S	9-8	3000-097	V32100S	10-9	3000-117	V40110S	11-10	3000-137	V50260S	26-24	3000-167
V25100S	10-9	3000-098	V32110S	11-10	3000-118	V40120S	12-11	3000-138	V50280S	28-26	3000-168
V25110S	11-10	3000-099	V32120S	12-11	3000-119	V40130S	13-12	3000-139	V50300S	30-28	3000-169
V25120S	12-11	3000-100	V32130S	13-12	3000-120	V40140S	14-13	3000-140	V50320S	32-30	3000-170
V25130S	13-12	3000-101	V32140S	14-13	3000-121	V40150S	15-14	3000-141	V50340S	34-32	3000-171
V25140S	14-13	3000-102	V32150S	15-14	3000-122	V40160S	16-15	3000-142			
V25150S	15-14	3000-103	V32160S	16-15	3000-123	V40170S	17-16	3000-143			
V25160S	16-15	3000-104	V32170S	17-16	3000-124	V40180S	18-17	3000-144			
			V32180S	18-17	3000-125	V40190S	19-18	3000-145			
			V32190S	19-18	3000-126	V40200S	20-19	3000-146			
			V32200S	20-19	3000-127	V40210S	21-20	3000-147			
						V40220S	22-21	3000-148			
						V40230S	23-22	3000-149			
						V40240S	24-23	3000-150			
						V40250S	25-24	3000-151			
						V40260S	26-25	3000-152			



COLLET KITS STANDARD TYPE

ORDER NO.	TYPE	COLLET SIZE INSIDE DIA.	PCS/SET	KGS/PACKING	CODE NO.
V-08000	ER-8	1+0.5-5mm(1,1.5,2,2.5,3,3.5,4,4.5,5mm)	9PCS	0.8(C)	3001-101
V-11000	ER-11	1-7mm(1,2,3,4,5,6,7mm)	7PCS	0.3(C)	3002-101
V-11013		1+0.5-7mm(1,1.5,2,2.5,3,3.5,4,4.5,5,5.5,6,6.5,7mm)	13PCS	0.3(C)	3002-102
V-16000	ER-16	1-10mm(1,2,3,4,5,6,7,8,9,10mm)	10PCS	0.7(C)	3003-101
V-16008		3-10mm(3,4,5,6,7,8,9,10mm)	8PCS	0.6(C)	3003-102
V-20000	ER-20	2-13mm(2,3,4,5,6,7,8,9,10,11,12,13mm)	12PCS	0.9(C)	3004-101
V-20008		4-13mm(4,5,6,7,8,9,10,11,12,13mm)	10PCS	0.8(C)	3004-102
V-25000	ER-25	2-16mm(2,3,4,5,6,7,8,9,10,11,12,13,14,15,16mm)	15PCS	1.3(W)	3005-101
V-25008		4-16mm(4,5,6,7,8,9,10,11,12,13,14,15,16mm)	13PCS	1.0(W)	3005-102
V-25009		6,8,10,12,16mm	5PCS	0.4(C)	3005-103
V-25010		4,6,8,10,12,14,16mm	7PCS	0.35(C)	3005-104
V-32000	ER-32	3-20mm(3,4,5,6,7,8,9,10,11,12,13,14,15,16,17,18,19,20mm)	18PCS	3.3(P)	3006-101
V-32008		4,5,6,8,10,12,13,15,16,18,20mm	11PCS	2.8(C)	3006-102
V-32009		6,8,10,12,16,20mm	6PCS	0.9(C)	3006-103
V-40000	ER-40	4-26mm(4,5,6,7,8,9,10,11,12,13,14,15,16,17,18,19,20,21,22,23,24,25,26mm)	23PCS	6.5(P)	3007-101
V-40008		4,5,6,8,10,12,13,15,16,18,20,21,22,25,26mm	15PCS	4.2(P)	3007-102
V-40009		6,8,10,12,16,20,25mm	7PCS	2.0(P)	3007-103
V-50000	ER-50	12,14,16,18,20,22,24,26,28,30,32,34mm	12PCS	6.5(W)	3008-101



Coolant Collet

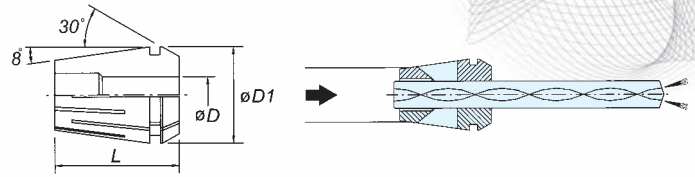

☐ THE SLOT WITH RUBBER FOR WATER RESIST. THE OTHER ARE BY UNTHROUGH SLOT TYPE FOR WATER RESIST.

TYPE:ER-16

ORDER NO.	CAP.mmØ	CODE NO.
V16040L	4.0-3.0	3000-200
V16050L	5.0-4.0	3000-201
V16060L	6.0-5.0	3000-202
V16070L	7.0-6.0	3000-203
V16080L	8.0-7.0	3000-204
V16090L	9.0-8.0	3000-205
V16100L	10.0-9.0	3000-206

TYPE:ER-20

ORDER NO.	CAP.mmØ	CODE NO.
V20040L	4-3	3000-210
V20050L	5-4	3000-211
V20060L	6-5	3000-212
V20070L	7-6	3000-213
V20080L	8-7	3000-214
V20090L	9-8	3000-215
V20100L	10-9	3000-216
V20110L	11-10	3000-217
V20120L	12-11	3000-218
V20130L	13-12	3000-219

TYPE:ER-25

ORDER NO.	CAP.mmØ	CODE NO.
V25040L	4-3	3000-221
V25050L	5-4	3000-222
V25060L	6-5	3000-223
V25070L	7-6	3000-224
V25080L	8-7	3000-225
V25090L	9-8	3000-226
V25100L	10-9	3000-227
V25110L	11-10	3000-228
V25120L	12-11	3000-229
V25130L	13-12	3000-230
V25140L	14-13	3000-231
V25150L	15-14	3000-232
V25160L	16-15	3000-233

TYPE:ER-32

ORDER NO.	CAP.mmØ	CODE NO.
V32040L	4-3	3000-240
V32050L	5-4	3000-241
V32060L	6-5	3000-242
V32070L	7-6	3000-243
V32080L	8-7	3000-244
V32090L	9-8	3000-245
V32100L	10-9	3000-246
V32110L	11-10	3000-247
V32120L	12-11	3000-248
V32130L	13-12	3000-249
V32140L	14-13	3000-250
V32150L	15-14	3000-251
V32160L	16-15	3000-252
V32170L	17-16	3000-253
V32180L	18-17	3000-254
V32190L	19-18	3000-255
V32200L	20-19	3000-256

TYPE:ER-40

ORDER NO.	CAP.mmØ	CODE NO.
V40040L	4-3	3000-260
V40050L	5-4	3000-261
V40060L	6-5	3000-262
V40070L	7-6	3000-263
V40080L	8-7	3000-264
V40090L	9-8	3000-265
V40100L	10-9	3000-266
V40110L	11-10	3000-267
V40120L	12-11	3000-268
V40130L	13-12	3000-269
V40140L	14-13	3000-270
V40150L	15-14	3000-271
V40160L	16-15	3000-272
V40170L	17-16	3000-273
V40180L	18-17	3000-274
V40190L	19-18	3000-275
V40200L	20-19	3000-276
V40210L	21-20	3000-277
V40220L	22-21	3000-278
V40230L	23-22	3000-279
V40240L	24-23	3000-280
V40250L	25-24	3000-281
V40260L	26-25	3000-282

NEW

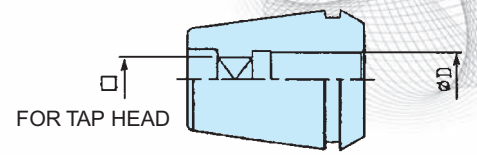

øD mm	□ mm	TAP SIZE		ER16GB	ER20GB	ER25GB	ER32GB	ER40GB
		DIN	JIS	ORDER NO.	ORDER NO.	ORDER NO.	ORDER NO.	ORDER NO.
				CODE NO.	CODE NO.	CODE NO.	CODE NO.	CODE NO.
4.5	3.4	M6		GB160450	GB200450	GB250450	GB320450	
				3000-400	3000-420	3000-440	3000-460	
5	4		M4	GB160500	GB200500	GB250500	GB320500	
				3000-401	3000-421	3000-441	3000-461	
5.5	4.5		M5	GB160550	GB200550	GB250550	GB320500	
				3000-402	3000-422	3000-442	3000-462	
6	4.5		M6 1/4U	GB160600	GB200600	GB250600	GB320600	GB400600
				3000-403	3000-423	3000-443	3000-463	3000-490
6	4.9	M8		GB160601	GB200601	GB250601	GB320601	GB400601
				3000-404	3000-424	3000-444	3000-464	3000-491
6.1	5		5/16U	GB160610	GB200610	GB250610	GB320610	GB400610
				3000-405	3000-425	3000-445	3000-465	3000-492
6.2	5		M8	GB160620	GB200620	GB250620	GB320620	GB400620
				3000-406	3000-426	3000-446	3000-466	3000-493
7	5.5	M10	M10 3/8U	GB160700	GB200700	GB250700	GB320700	GB400700
				3000-407	3000-427	3000-447	3000-467	3000-494
8	6.2		7/16U	GB160800	GB200800	GB250800	GB320800	GB400800
				3000-408	3000-428	3000-448	3000-468	3000-495
8.5	6.5		M12		GB200850	GB250850	GB320850	GB400850
					3000-429	3000-449	3000-469	3000-496
9	7.1	M12	1/2U		GB200900	GB250900	GB320900	GB400900
					3000-430	3000-450	3000-470	3000-497
10	8				GB201000	GB251000	GB321000	GB401000
					3000-431	3000-451	3000-471	3000-498
10.5	8		M14 9/16U			GB251050	GB321050	GB401050
						3000-452	3000-472	3000-499
11	9	M14				GB251100	GB321100	GB401100
						3000-453	3000-473	3000-500
12	9	M16	5/8U			GB251200	GB321200	GB401200
						3000-454	3000-474	3000-501
12.5	10		M16			GB251250	GB321250	GB401250
						3000-455	3000-475	3000-502
14	11	M18	M18 3/4U				GB321400	GB401400
							3000-476	3000-503
15	12		M20				GB321500	GB401500
							3000-477	3000-504
16	12	M20					GB321600	GB401600
							3000-478	3000-505
17	13		M22 7/8U				GB321700	GB401700
							3000-479	3000-506
18	14.5	M22						GB401800
								3000-507
19	15		M24					GB401900
								3000-508
20	15		M27 1"U					GB402000
								3000-509
20	16	M27						GB402001
								3000-510
22	18	M30						GB402200
								3000-511



ER Spring Collet Chuck System



VERTEX

Collet Chuck Kit With ISO Taper Shank

DIN 2080/ISO SHANK
DIN 6499

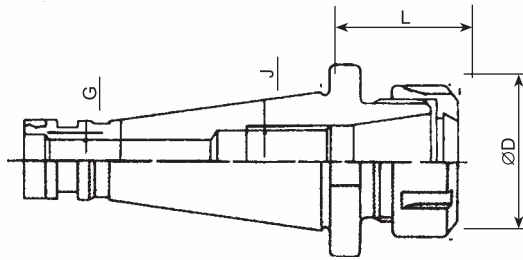

ORDER NO.	TAPER	COLLET TYPE	L	D	G	WEIGHT KGS	CODE NO.
V-101	NT-30	ER-32	55	50	1/2"-12W, M12X1.75P (USA 1/2"-UNC13)	0.7	3020-301
V-102		ER-40	70	63		1.1	3020-302
V-103	NT-40	ER-32	50	60	5/8"-11W or M16X2.0P	1.1	3021-301
V-104		ER-40	60	63		1.3	3021-302
V-105		ER-50	80	78		2	3021-303
V-106	NT-50	ER-32	60	50	1"-8W or M24X3.0P	3.1	3022-301
V-107		ER-40	65	63		3.4	3022-302
V-108		ER-50	65	78		4	3022-303
※ V-109	NT-30	ER-25	55	42	1/2"-12W, M12X1.75P	0.7	3020-303
※ V-110	NT-40	ER-25	50	42	5/8"-11W, M16X2.0P	1.1	3023-304



Collet Chuck kit With ISO Taper Shank

Including shank, full set of collets, wrench and case.

Caution:

Please notify the taper size, collte type, set range, and set numbers when ordering.

ORDER NO.	TAPER	COLLET TYPE	SET RANGE	SET PCS	WEIGHT KGS	CODE NO.
V-201	NT-30	ER-32	3-20	18	4.2	3020-401
V-202			4-20	11	3.2	3020-402
V-203			6-20	6	2.8	3020-403
V-204	NT-30	ER-40	4-26	23	7.3	3020-404
V-205			4-26	15	6	3020-405
V-206			6-25	7	4.6	3020-406
V-207	NT-40	ER-32	3-20	18	4.8	3021-401
V-208			4-20	11	3.8	3021-402
V-209			6-20	6	3.4	3021-403
V-210	NT-40	ER-40	4-26	23	8.2	3021-404
V-211			4-26	15	6.9	3021-405
V-212			6-25	7	5.2	3021-406
V-213	NT-40	ER-50	12-34	12	10	3021-407
V-214	NT-50	ER-32	3-20	18	6.4	3022-401
V-215			4-20	11	5.4	3022-402
V-216			6-20	6	5.5	3022-403
V-217	NT-50	ER-40	4-26	23	9.8	3022-404
V-218			4-26	15	8.5	3022-405
V-219			6-25	7	7	3022-406
V-220	NT-50	ER-50	12-34	12	11	3022-407
※ V-223	NT-30	ER-25	2-16	7	2.8	3020-407
※ V-224			4-16	15	2.4	3020-408
※ V-225	NT-40	ER-25	2-16	7	3.3	3021-409
※ V-226			4-16	15	3.0	3021-410



DIN 6388 Collet For Milling Chuck



COLLET DIN 6388, TYPE A

DIN 6388 #16,#25,#32 SERIES

COLLET MUST BE ASSEMBLED INTO THE CLAMPING NUT BEFORE INSERTING INTO THE CHUCK

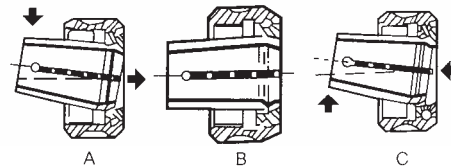
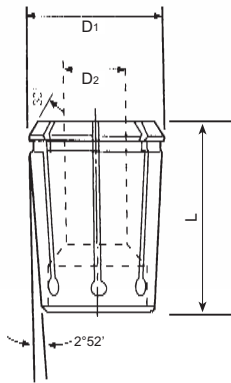

METRIC

ORDER NO.	D1	L	D2(MM)
OZ-16-□	25.5	40	2, 3, 4, 5, 6, 7, 8, 9, 10, 11, 12, 13, 14, 15, 16
OZ-25-□	35.05	52	3, 4, 5, 6, 7, 8, 9, 10, 11, 12, 13, 14, 15, 16, 18, 20, 25
OZ-32-□	44	60	6, 8, 10, 12, 16, 20, 25, 32

INCH

ORDER NO.	D1	L	D2(INCH)
OZ-25-□	35.05	52	1/8", 3/16", 1/4", 5/16", 3/8", 7/16", 1/2", 9/16", 5/8", 11/16", 3/4", 13/16", 7/8", 15/16", 1"
OZ-32-□	43.7	60	1/4", 5/16", 3/8", 7/16", 1/2", 9/16", 5/8", 11/16", 3/4", 13/16", 7/8", 15/16", 1", 1 1/8", 1 1/4"

■ RANGE SIZE:3-25(1/8"-1")

OZ-25 ■ D:35.05 ■ L:52 ■ TAPER:1:10 ■ WEIGHT:0.18KGS

ORDER NO.	MM SIZE	CODE NO.
OZ-2503	3.0	3100-101
OZ-2504	4.0	3100-102
OZ-2505	5.0	3100-103
OZ-2506	6.0	3100-104
OZ-2507	7.0	3100-105
OZ-2508	8.0	3100-106
OZ-2509	9.0	3100-107
OZ-2510	10	3100-108
OZ-2511	11	3100-109
OZ-2512	12	3100-110
OZ-2513	13	3100-111
OZ-2514	14	3100-112
OZ-2515	15	3100-113
OZ-2516	16	3100-114
OZ-2517	17	3100-115
OZ-2518	18	3100-116
OZ-2519	19	3100-117
OZ-2520	20	3100-118
OZ-2521	21	3100-119
OZ-2522	22	3100-120
OZ-2523	23	3100-121
OZ-2524	24	3100-122
OZ-2525	25	3100-123

ORDER NO.	INCH SIZE	CODE NO.
OZ-2526	1/8"	3100-124
OZ-2527	3/16"	3100-125
OZ-2528	1/4"	3100-126
OZ-2529	5/16"	3100-127
OZ-2530	3/8"	3100-128
OZ-2531	7/16"	3100-129
OZ-2532	1/2"	3100-130
OZ-2533	9/16"	3100-131
OZ-2534	5/8"	3100-132
OZ-2535	11/16"	3100-133
OZ-2536	3/4"	3100-134
OZ-2537	13/16"	3100-135
OZ-2538	7/8"	3100-136
OZ-2539	15/16"	3100-137
OZ-2540	1"	3100-138



DIN 6388 Collet For Milling Chuck



COLLET DIN 6388, TYPE A

DIN 6388 #16,#25,#32 SERIES

COLLET MUST BE ASSEMBLED INTO THE CLAMPING NUT BEFORE INSERTING INTO THE CHUCK



DIN6388 32# ■ RANGE SIZE:6-32(1/4"-1 1/4")
 OZ-32 ■ D:43.7 ■ L:60 ■ TAPER:1:10
 ■ WEIGHT:0.25KGS

ORDER NO.	MM SIZE	CODE NO.
OZ-3206	6.0	3100-201
OZ-3207	7.0	3100-202
OZ-3208	8.0	3100-203
OZ-3209	9.0	3100-204
OZ-3210	10	3100-205
OZ-3211	11	3100-206
OZ-3212	12	3100-207
OZ-3213	13	3100-208
OZ-3214	14	3100-209
OZ-3215	15	3100-210
OZ-3216	16	3100-211
OZ-3217	17	3100-212
OZ-3218	18	3100-213
OZ-3219	19	3100-214
OZ-3220	20	3100-215
OZ-3221	21	3100-216
OZ-3222	22	3100-217
OZ-3223	23	3100-218
OZ-3224	24	3100-219
OZ-3225	25	3100-220
OZ-3226	26	3100-221
OZ-3227	27	3100-222
OZ-3228	28	3100-223
OZ-3229	29	3100-224
OZ-3230	30	3100-225
OZ-3231	31	3100-226
OZ-3232	32	3100-227

ORDER NO.	INCH SIZE	CODE NO.
OZ-3233	1/4"	3100-228
OZ-3234	5/16"	3100-229
OZ-3235	3/8"	3100-230
OZ-3236	7/16"	3100-231
OZ-3237	1/2"	3100-232
OZ-3238	9/16"	3100-233
OZ-3239	5/8"	3100-234
OZ-3240	11/16"	3100-235
OZ-3241	3/4"	3100-236
OZ-3242	13/16"	3100-237
OZ-3243	7/8"	3100-238
OZ-3244	15/16"	3100-239
OZ-3245	1"	3100-240
OZ-3246	1-1/8"	3100-241
OZ-3247	1-1/4"	3100-242



■ DIN 6388 16#
 ■ OZ-16 COLLET

ORDER NO.	MM SIZE	CODE NO.
OZ-1602	2.0	3100-001
OZ-1603	3.0	3100-002
OZ-1604	4.0	3100-003
OZ-1605	5.0	3100-004
OZ-1606	6.0	3100-005
OZ-1607	7.0	3100-006
OZ-1608	8.0	3100-007
OZ-1609	9.0	3100-008
OZ-1610	10	3100-009
OZ-1611	11	3100-010
OZ-1612	12	3100-011
OZ-1613	13	3100-012
OZ-1614	14	3100-013
OZ-1615	15	3100-014
OZ-1616	16	3100-015



DIN 6388 Nuts & Wrench

BALL BEARING, NUTS FOR COLLETS DIN6388, TYPE A

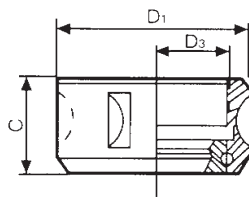

ORDER NO.	C	D1	D3	COLLETS	WEIGHT kgs	CODE NO.
OZ-25N	30	60	M48X2	OZ-25	0.3	3100-301
OZ-32N	33	72	M60X2.5	OZ-32	0.7	3100-302

Unit:mm

WRENCH FOR COLLETS DIN6388 TYPE A



ORDER NO.	D1	COLLETS	WEIGHT kgs	CODE NO.
OZ-25W	60	OZ-25	0.35	3100-310
OZ-32W	72	OZ-32	0.4	3100-311

Unit:mm

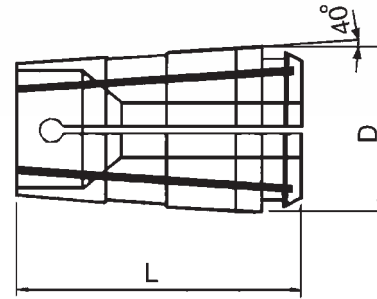

■ RANGE SIZE: 1/8"-63/64"

TG-100 ■ D:35 ■ L:61 ■ TAPER:4 ■ WEIGHT:0.2KGS

ORDER NO.	INCH	CODE NO.
TG10-01	1/8"	3204-001
TG10-02	3/6"	3204-002
TG10-03	1/4"	3204-003
TG10-04	5/16"	3204-004
TG10-05	3/8"	3204-005
TG10-06	7/16"	3204-006
TG10-07	1/2"	3204-007
TG10-08	9/16"	3204-008
TG10-09	5/8"	3204-009
TG10-10	11/16"	3204-010
TG10-11	3/4"	3204-011
TG10-12	13/16"	3204-012
TG10-13	7/8"	3204-013
TG10-14	15/16"	3204-014
TG10-15	1"	3204-015
TG10-16	5/32"	3204-016
TG10-17	7/32"	3204-017
TG10-18	9/32"	3204-018
TG10-19	11/32"	3204-019
TG10-20	13/32"	3204-020
TG10-21	15/32"	3204-021
TG10-22	17/32"	3204-022
TG10-23	19/32"	3204-023
TG10-24	21/32"	3204-024
TG10-25	23/32"	3204-025
TG10-26	25/32"	3204-026
TG10-27	27/32"	3204-027
TG10-28	29/32"	3204-028
TG10-29	31/32"	3204-029

ORDER NO.	INCH	CODE NO.
TG10-30	9/64"	3204-030
TG10-31	11/64"	3204-031
TG10-32	13/64"	3204-032
TG10-33	15/64"	3204-033
TG10-34	17/64"	3204-034
TG10-35	19/64"	3204-035
TG10-36	21/64"	3204-036
TG10-37	23/64"	3204-037
TG10-38	25/64"	3204-038
TG10-39	27/64"	3204-039
TG10-40	29/64"	3204-040
TG10-41	31/64"	3204-041
TG10-42	33/64"	3204-042
TG10-43	35/64"	3204-043
TG10-44	37/64"	3204-044
TG10-45	39/64"	3204-045
TG10-46	41/64"	3204-046
TG10-47	43/64"	3204-047
TG10-48	45/64"	3204-048
TG10-49	47/64"	3204-049
TG10-50	49/64"	3204-050
TG10-51	51/64"	3204-051
TG10-52	53/64"	3204-052
TG10-53	55/64"	3204-053
TG10-54	57/64"	3204-054
TG10-55	59/64"	3204-055
TG10-56	61/64"	3204-056
TG10-57	63/64"	3204-057



5C Collet System

5C RANGE



VERTEX

mm



5C Collet

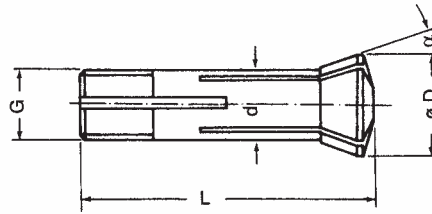

- L:87 ■ D:37.5 ■ d:31.75 ■ Accuracy: ±0.02mm
- α:10° ■ WEIGHT:0.21KGS ■ Hardness: HRC47°

ORDER NO.	Q'TY	RANGE SIZE
5C-□	1 PC	∅ 3, 4, 5, 6, 7, 8, 9, 10, 11, 12, 13, 14, 15, 16, 17, 18, 19, 20, 21, 22, 23, 24, 25MM
5C-□	1 PC	∅ 1/8", 3/16", 1/4", 5/16", 3/8", 7/16", 1/2", 9/16", 5/8", 11/16", 3/4", 13/16", 7/8", 15/16", 1"

COMPLETE SET AVAILABLE SIZE

ORDER NO.	Q'TY	RANGE SIZE	PACKING	WEIGHT KGS	CODE NO.
VE-102	7PCS	6, 8, 10, 12, 16, 20, 25	CARTON	1.5	3205-100
VE-102I	7PCS	1/4", 5/16", 3/8", 1/2", 5/8", 3/4", 1"	CARTON	1.5	3205-101

ORDER NO.	d	CODE NO.
5C-3	3	3205-001
5C-4	4	3205-002
5C-5	5	3205-003
5C-6	6	3205-004
5C-7	7	3205-005
5C-8	8	3205-006
5C-9	9	3205-007
5C-10	10	3205-008
5C-11	11	3205-009
5C-12	12	3205-010
5C-13	13	3205-011
5C-14	14	3205-012
5C-15	15	3205-013
5C-16	16	3205-014
5C-17	17	3205-015
5C-18	18	3205-016
5C-19	19	3205-017
5C-20	20	3205-018
5C-21	21	3205-019
5C-22	22	3205-020
5C-23	23	3205-021
5C-24	24	3205-022
5C-25	25	3205-023

inch

ORDER NO.	d	CODE NO.
5C-1/8	1/8"	3205-024
5C-3/16	3/16"	3205-025
5C-1/4	1/4"	3205-026
5C-5/16	5/16"	3205-027
5C-3/8	3/8"	3205-028
5C-7/16	7/16"	3205-029
5C-1/2	1/2"	3205-030
5C-9/16	9/16"	3205-031
5C-5/8	5/8"	3205-032
5C-11/16	11/16"	3205-033
5C-3/4	3/4"	3205-034
5C-13/16	13/16"	3205-035
5C-7/8	7/8"	3205-036
5C-15/16	15/16"	3205-037
5C-1	1"	3205-038



EMERGENCY TYPE SOFT COLLET

ORDER NO.	MATERIAL	kgs	CODE NO.
VE-5CS	STEEL		3205-201
VE-5CB	BRASS	0.35	3205-202
VE-5CN	NYLON		3205-203



R8 Collet System



R8 Collet

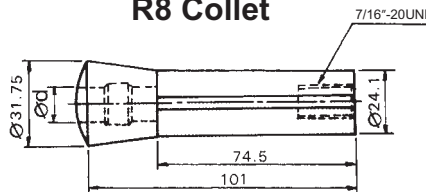

- L:105 ■ D:31.75 ■ d:24.1 ■ Accuracy: ±0.02mm
- G:7/16"-20UNF ■ α:8°30' ■ WEIGHT:0.21KGS ■ Hardness: HRC47°

ORDER NO.	Q'TY	RANGE SIZE
R8-□	1 PC	∅ 3, 4, 5, 6, 7, 8, 9, 10, 11, 12, 13, 14, 15, 16, 17, 18, 19, 20 MM
R8-□	1 PC	∅ 1/8", 3/16", 1/4", 5/16", 3/8", 7/16", 1/2", 9/16", 5/8", 11/16", 3/4"

COMPLETE SET AVAILABLE SIZE

ORDER NO.	Q'TY	RANGE SIZE	WEIGHT KGS	CODE NO.
VE-110	6PCS	6, 8, 10, 12, 16, 20 MM	1.5	3206-100
VE-114	7PCS	6, 8, 10, 12, 14, 16, 20 MM	1.5	3206-101

EMERGENCY TYPE SOFT COLLET

ORDER NO.	Q'TY	RANGE SIZE	WEIGHT KGS	CODE NO.
VE-109I	5PCS	1/4", 3/8", 1/2", 5/8", 3/4",	1.1	3206-102
VE-110I	6PCS	1/4", 5/16", 3/8", 1/2", 5/8", 3/4"	1.5	3206-103
VE-114I	7PCS	3/16", 1/4", 5/16", 3/8", 1/2", 5/8", 3/4"	1.5	3206-104

mm

ORDER NO.	d	CODE NO.
R8-3	3	3206-001
R8-4	4	3206-002
R8-5	5	3206-003
R8-6	6	3206-004
R8-7	7	3206-005
R8-8	8	3206-006
R8-9	9	3206-007
R8-10	10	3206-008
R8-11	11	3206-009
R8-12	12	3206-010
R8-13	13	3206-011
R8-14	14	3206-012
R8-15	15	3206-013
R8-16	16	3206-014
R8-17	17	3206-015
R8-18	18	3206-016
R8-19	19	3206-017
R8-20	20	3206-018

inch

ORDER NO.	d	CODE NO.
R8-1/8	1/8"	3206-019
R8-3/16	3/16"	3206-020
R8-1/4	1/4"	3206-021
R8-5/16	5/16"	3206-022
R8-3/8	3/8"	3206-023
R8-7/16	7/16"	3206-024
R8-1/2	1/2"	3206-025
R8-9/16	9/16"	3206-026
R8-5/8	5/8"	3206-027
R8-11/16	11/16"	3206-028
R8-3/4	3/4"	3206-029



U2 Collet System



VERTEX

NO.1 U2 COLLET RANGE SIZE 3~16mm

NO.2 U2 COLLET RANGE SIZE 18~25mm

NO.1



■ L:120 ■ D:28 ■ d:20 ■ G:2.0P ■ Accuracy: ±0.02mm
■ α:17°30' ■ WEIGHT:0.18KGS ■ Hardness: HRC47°

ORDER NO.	Q'TY	RANGE SIZE
VE-U2-□	1 PC	NO.1 Ø 1.5, 2, 3, 4, 5, 6, 7, 8, 9, 10, 11, 12, 13, 14, 15, 16 NO.2 Ø 18, 20, 25MM
VE-U2-□	1 PC	Ø 1/8", 3/16", 1/4", 5/16", 3/8", 1/2", 5/8"

NO.2

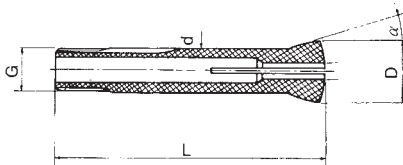

mm			mm			inch		
ORDER NO.	d	CODE NO.	ORDER NO.	d	CODE NO.	ORDER NO.	d	CODE NO.
VE-U2-1.5	1.5	3207-026	VE-U2-10	10	3207-008	VE-U2-1/8	1/8"	3207-018
VE-U2-2	2	3207-027	VE-U2-11	11	3207-009	VE-U2-3/16	3/16"	3207-019
VE-U2-3	3	3207-001	VE-U2-12	12	3207-010	VE-U2-1/4	1/4"	3207-020
VE-U2-4	4	3207-002	VE-U2-13	13	3207-011	VE-U2-5/16	5/16"	3207-021
VE-U2-5	5	3207-003	VE-U2-14	14	3207-012	VE-U2-3/8	3/8"	3207-022
VE-U2-6	6	3207-004	VE-U2-15	15	3207-013	VE-U2-1/2	1/2"	3207-023
VE-U2-7	7	3207-005	VE-U2-16	16	3207-014	VE-U2-5/8	5/8"	3207-024
VE-U2-8	8	3207-006	VE-U2-18	18	3207-015			
VE-U2-9	9	3207-007	VE-U2-20	20	3207-016			
			VE-U2-25	25	3207-017			



MT3 Collet System

■ D:24.1 ■ L:87 ■ WEIGHT:0.18KGS
■ DRAW BAR SIZE: G1.M12X1.75P
G2.M10X1.5P
G3.1/2"-12
G4.3/8"-16



ORDER NO.	Q'TY	RANGE SIZE	DRAW BAR SIZE
MT3-□	1 PC	Ø 4, 6, 8, 10, 12, 16, 20MM	G1,G2
MT3-□	1 PC	Ø 1/8", 1/4", 3/8", 1/2", 5/8", 3/4"	G3,G4

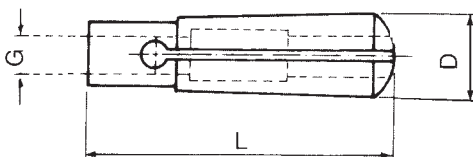

mm			inch		
ORDER NO.	d	CODE NO.	ORDER NO.	d	CODE NO.
MT3-4	4	3208-100	MT3-1/8	1/8"	3208-107
MT3-6	6	3208-101	MT3-1/4	1/4"	3208-108
MT3-8	8	3208-102	MT3-3/8	3/8"	3208-109
MT3-10	10	3208-103	MT3-1/2	1/2"	3208-110
MT3-12	12	3208-104	MT3-5/8	5/8"	3208-111
MT3-16	16	3208-105	MT3-3/4	3/4"	3208-112
MT3-20	20	3208-106			



R8

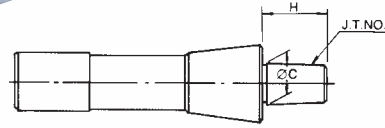
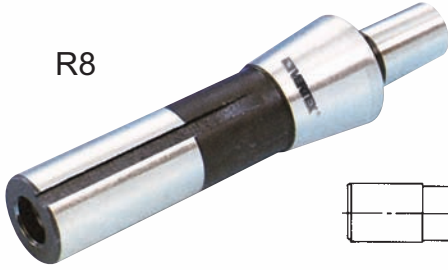

ORDER NO.	TAPER	JT NO.	C	H	WEIGHT (kg)	CODE NO.
VJ-121	R8	JT1	9.754	18	0.5	3209-001
VJ-122		JT2	13.94	20	0.5	3209-002
VJ-123		JT6	17.17	26	0.5	3209-003
VJ-124		B16	15.733	24	0.5	3209-004

MT3.4.5

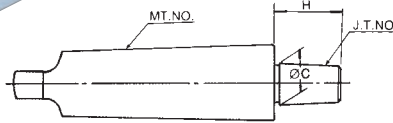

ORDER NO.	TAPER	JT NO.	C	H	WEIGHT (kg)	CODE NO.
VJ-131	MT3	JT6	17.17	26	0.4	3209-030
VJ-132	MT4	JT6	17.17	26	0.7	3209-031
VJ-133	MT5	JT6	17.17	26	1.6	3209-032
VJ-134	MT3	B16	15.733	24	0.3	3209-033

C20.25.32

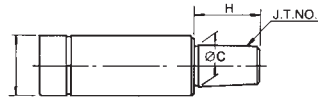

ORDER NO.	TAPER	JT NO.	C	H	WEIGHT (kg)	CODE NO.
VJ-141	C20	JT6	17.17	26	0.2	3209-060
VJ-142	C25	JT6	17.17	26	0.3	3209-061
VJ-143	C32	JT6	17.17	26	0.5	3209-062



Morse Taper Sleeve

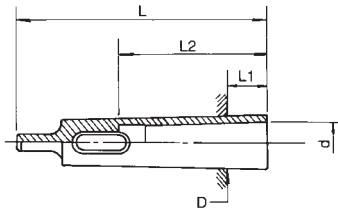

ORDER NO.	I.D.xO.D.	D	d	L	l1	l2	WEIGHT (kg)	CODE NO.
VQ-101	MT2xMT3	23.825	17.780	112	18	67	0.2	3210-001
VQ-102	MT2xMT4	31.267	17.780	124	6.5	67	0.5	3210-002
VQ-103	MT2xMT5	44.399	17.780	156	6.5	67	1.4	3210-003
VQ-105	MT3xMT4	31.267	23.825	140	22.5	84	0.4	3210-005
VQ-106	MT3xMT5	44.399	23.825	156	6.5	84	1.3	3210-006
VQ-107	MT3xMT6	63.348	23.825	218	8	84	4	3210-007
VQ-108	MT4xMT5	44.399	31.267	171	21.5	107	1	3210-008
VQ-109	MT4xMT6	63.348	31.267	218	8	107	3.7	3210-009
VQ-110	MT5xMT6	63.348	44.399	218	8	133	2.9	3210-010



R8 With Morse Taper Sleeve

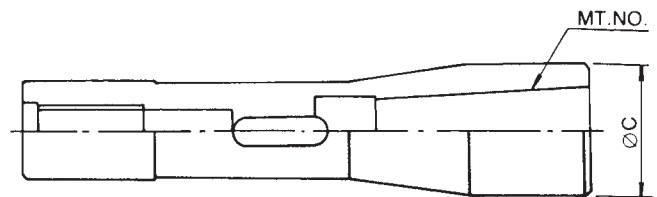

ORDER NO.	SHANK	SIZE	MT NO.	WEIGHT (kg)	CODE NO.
VQ-122	R8	R8-MT2	MT2	0.4	3211-001
VQ-123	R8	R8-MT3	MT3	0.5	3211-002



Small Collet Of Slim Collet Chuck



DC Collet System

- Below $\phi 6$ can clamp any shank.
- DC6 series : for clamping drills, reamers and taps.
- DC6-E series:for clamping end mills.
- Runout : below 0.005mm. (length 4D)

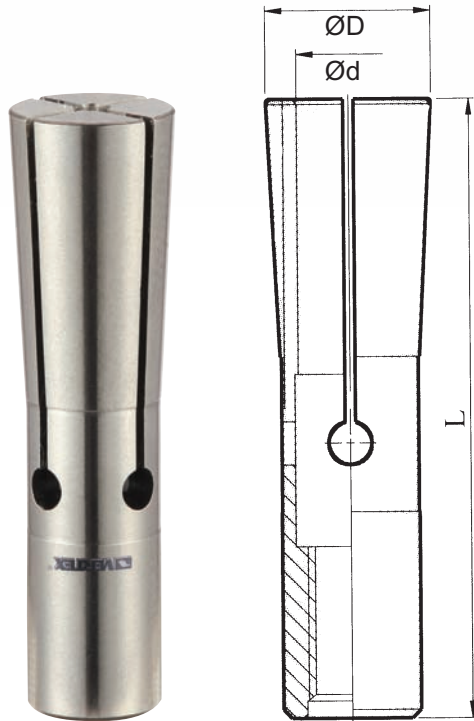

ORDER NO.	ØD	L	Range(d)	WEIGHT(kg)	CODE NO.
DC6-2	9.8	36	1.75-2.00	0.05	3218-056
DC6-2.25	9.8	36	2.00-2.25	0.05	3218-057
DC6-2.5	9.8	36	2.25-2.50	0.05	3218-058
DC6-2.75	9.8	36	2.50-2.75	0.05	3218-059
DC6-3	9.8	36	2.75-3.00	0.05	3218-065
DC6-3.25	9.8	36	3.00-3.25	0.05	3218-066
DC6-3.5	9.8	36	3.25-3.50	0.05	3218-067
DC6-3.75	9.8	36	3.50-3.75	0.05	3218-068
DC6-4	9.8	36	3.75-4.00	0.05	3218-069
DC6-4.25	9.8	36	4.00-4.25	0.05	3218-070
DC6-4.5	9.8	36	4.25-4.50	0.05	3218-071
DC6-4.75	9.8	36	4.50-4.75	0.05	3218-072
DC6-5	9.8	36	4.75-5.00	0.05	3218-073
DC6-5.25	9.8	36	5.00-5.25	0.05	3218-074
DC6-5.5	9.8	36	5.25-5.50	0.05	3218-075
DC6-5.75	9.8	36	5.50-5.75	0.05	3218-076
DC6-6	9.8	36	5.75-6.00	0.05	3218-077



Collet For End Mill Shank

DC Collet System

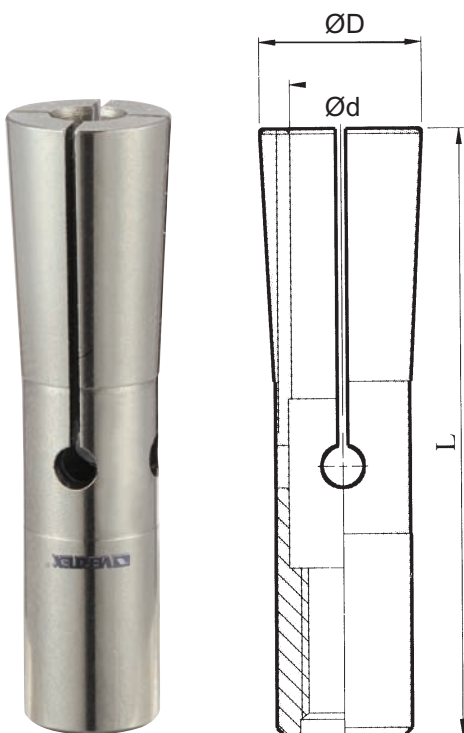

ORDER NO.	Ød	ØD	L	WEIGHT(kg)	CODE NO.
DC6-3E	3	9.6	36	0.05	3218-078
DC6-4E	4	9.6	36	0.05	3218-079
DC6-6E	6	9.6	36	0.05	3218-081



UC COLLET CHUCK

For clamping HSC(High speed cutting) tools on machining centers.

Maximum speed:15,000 R.P.M.

High accuracy:0.005mm T.I.R

Features

Taper of UC spring collet is 1/120, self-locked function makes high gripping power to prevent slip-out of the cutting tools.

UC spring collet chucks are made by high alloy steel and cast hardened up to HRC59° and ground to ultra precision.

UC spring collets are slit with a patented slotted-design for increasing gripping power and accuracy. (PAT.103654)

NEW



UC

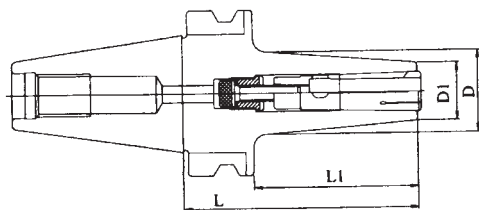

ORDER NO.	L	L1	D	D1	Collets	WEIGHT (kgs)	CODE NO.
BT30-UC10-70	70	48	30	22	UC10	0.7	3218-001
BT40-UC10-90	90	63	32	22	UC10	1.4	3218-002
BT40-UC16-90	90	63	40	30	UC16	1.5	3218-003
BT50-UC10-110	110	72	36	22	UC10	4.1	3218-004
BT50-UC16-120	120	82	42	30	UC16	4.5	3218-005

STRAIGHT SHANK UC CHUCK

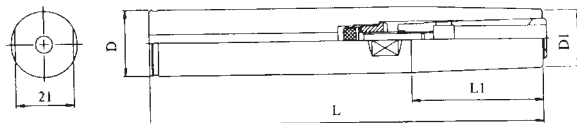

ORDER NO.	L	L1	D	D1	Collets	WEIGHT (kg)	CODE NO.
C25-UC10-150	150	50	25	22	UC10	0.5	3218-030
C25-UC10-200	200	50	25	22	UC10	0.7	3218-031

UC SPRING COLLETS

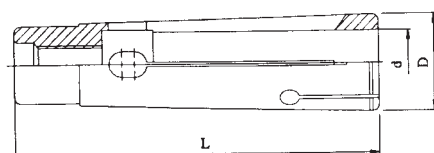

ORDER NO.	d	D	L	WEIGHT(kg)	CODE NO.
UC10-6	6	15	56.5	0.054	3218-060
UC10-8	8			0.047	3218-061
UC10-10	10			0.039	3218-062
UC16-10	10	21	67	0.104	3218-090
UC16-12	12			0.104	3218-091
UC16-14	14			0.069	3218-092
UC16-16	16			0.089	3218-093

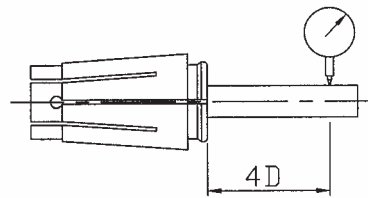

TYPE	D	L
SK6	10.5	25
SK10	15.5	30.5
SK16	24.5	45
SK20	29.5	50
SK25	35.5	57

THE GRIPPING RANGE OF DIA. BELOW 3MM IS 0.25MM
 THE GRIPPING RANGE OF DIA. OVER 3MM IS 0.5MM
 THE RUNOUT OF A COLLET IS 10 μ .

TYPE:SK6

ORDER NO.	ØD	CAP. mmØ	CODE NO.
SK0601A	2	2-1.75	3218-400
SK0602A	2.5	2.5-2.25	3218-401
SK0603A	3	3-2.75	3218-402
SK0604A	3.5	3.5-3	3218-403
SK0605A	4	4-3.5	3218-404
SK0606A	4.5	4.5-4	3218-405
SK0607A	5	5-4.5	3218-406
SK0608A	5.5	5.5-5	3218-407
SK0609A	6	6-5.5	3218-408

TYPE:SK16

ORDER NO.	ØD	CAP. mmØ	CODE NO.
SK1601A	3	3-2.75	3218-430
SK1602A	3.175	3.175-2.7	3218-431
SK1603A	3.5	3.5-3	3218-432
SK1604A	4	4-3.5	3218-433
SK1605A	4.5	4.5-4	3218-434
SK1606A	5	5-4.5	3218-435
SK1607A	5.5	5.5-5	3218-436
SK1608A	6	6-5.5	3218-437
SK1609A	3.5	6.5-6	3218-438
SK1610A	7	7-6.5	3218-439
SK1611A	7.5	7.5-7	3218-440
SK1612A	8	8-7.5	3218-441
SK1613A	8.5	8.5-8	3218-442
SK1614A	9	9-8.5	3218-443
SK1615A	9.5	9.5-9	3218-444
SK1616A	10	10-9.5	3218-445
SK1617A	10.5	10.5-10	3218-446
SK1618A	11	11-10.5	3218-447
SK1619A	11.5	11.5-11	3218-448
SK1620A	12	12-11.5	3218-449
SK1621A	12.5	12.5-12	3218-450
SK1622A	13	13-12.5	3218-451
SK1623A	13.5	13.5-13	3218-452
SK1624A	14	14-13.5	3218-453
SK1625A	14.5	14.5-14	3218-454
SK1626A	15	15-14.5	3218-455
SK1627A	15.5	15.5-15	3218-456
SK1628A	16	16-15.5	3218-457

TYPE:SK10

ORDER NO.	ØD	CAP. mmØ	CODE NO.
SK1001A	2	2-1.75	3218-411
SK1002A	2.5	2.5-2.25	3218-412
SK1003A	3	3-2.75	3218-413
SK1004A	3.175	3.175-2.7	3218-414
SK1005A	3.5	3.5-3	3218-415
SK1006A	4	4-3.5	3218-416
SK1007A	4.5	4.5-4	3218-417
SK1008A	5	5-4.5	3218-418
SK1009A	5.5	5.5-5	3218-419
SK1010A	6	6-5.5	3218-420
SK1011A	6.5	6.5-6	3218-421
SK1012A	7	7-6.5	3218-422
SK1013A	7.5	7.5-7	3218-423
SK1014A	8	8-7.5	3218-424
SK1015A	8.5	8.5-8	3218-425
SK1016A	9	9-8.5	3218-426
SK1017A	9.5	9.5-9	3218-427
SK1018A	10	10-9.5	3218-428

TYPE:SK25

ORDER NO.	ØD	CAP. mmØ	CODE NO.
SK2501A	6	6-5.5	3218-470
SK2502A	8	8-7.5	3218-471
SK2503A	10	10-9.5	3218-472
SK2504A	12	12-11.5	3218-473
SK2505A	14	14-13.5	3218-474
SK2506A	16	16-15.5	3218-475
SK2507A	18	18-17.5	3218-476
SK2508A	20	20-19.5	3218-477
SK2509A	22	22-21.5	3218-478
SK2510A	24	24-23.5	3218-479
SK2511A	25	25-24.5	3218-480
SK2512A	25.4	25.4-25	3218-481

TYPE:SK20

ORDER NO.	ØD	CAP. mmØ	CODE NO.
SK2001A	3	3-2.75	3218-460
SK2002A	4	4-3.5	3218-461
SK2003A	6	6-5.5	3218-462
SK2004A	8	8-7.5	3218-463
SK2005A	10	10-9.5	3218-464
SK2006A	12	12-11.5	3218-465
SK2007A	16	16-15.5	3218-466
SK2008A	20	20-19.5	3218-467

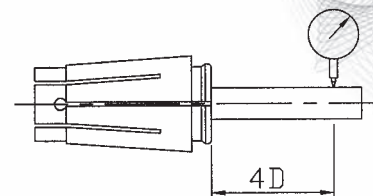

THE GRIPPING RANGE OF DIA. BELOW 3MM IS 0.25MM
 THE GRIPPING RANGE OF DIA. OVER 3MM IS 0.5MM
 THE RUNOUT OF AA COLLET IS 5μ.

TYPE:SK6

ORDER NO.	ØD	CAP. mmØ	CODE NO.
SK0601AA	2	2-1.75	3218-500
SK0602AA	2.5	2.5-2.25	3218-501
SK0603AA	3	3-2.75	3218-502
SK0604AA	3.5	3.5-3	3218-503
SK0605AA	4	4-3.5	3218-504
SK0606AA	4.5	4.5-4	3218-505
SK0607AA	5	5-4.5	3218-506
SK0608AA	5.5	5.5-5	3218-507
SK0609AA	6	6-5.5	3218-508

TYPE:SK16

ORDER NO.	ØD	CAP. mmØ	CODE NO.
SK1601AA	3	3-2.75	3218-530
SK1602AA	3.175	3.175-2.7	3218-531
SK1603AA	3.5	3.5-3	3218-532
SK1604AA	4	4-3.5	3218-533
SK1605AA	4.5	4.5-4	3218-534
SK1606AA	5	5-4.5	3218-535
SK1607AA	5.5	5.5-5	3218-536
SK1608AA	6	6-5.5	3218-537
SK1609AA	3.5	6.5-6	3218-538
SK1610AA	7	7-6.5	3218-539
SK1611AA	7.5	7.5-7	3218-540
SK1612AA	8	8-7.5	3218-541
SK1613AA	8.5	8.5-8	3218-542
SK1614AA	9	9-8.5	3218-543
SK1615AA	9.5	9.5-9	3218-544
SK1616AA	10	10-9.5	3218-545
SK1617AA	10.5	10.5-10	3218-546
SK1618AA	11	11-10.5	3218-547
SK1619AA	11.5	11.5-11	3218-548
SK1620AA	12	12-11.5	3218-549
SK1621AA	12.5	12.5-12	3218-550
SK1622AA	13	13-12.5	3218-551
SK1623AA	13.5	13.5-13	3218-552
SK1624AA	14	14-13.5	3218-553
SK1625AA	14.5	14.5-14	3218-554
SK1626AA	15	15-14.5	3218-555
SK1627AA	15.5	15.5-15	3218-556
SK1628AA	16	16-15.5	3218-557

TYPE:SK10

ORDER NO.	ØD	CAP. mmØ	CODE NO.
SK1001AA	2	2-1.75	3218-511
SK1002AA	2.5	2.5-2.25	3218-512
SK1003AA	3	3-2.75	3218-513
SK1004AA	3.175	3.175-2.7	3218-514
SK1005AA	3.5	3.5-3	3218-515
SK1006AA	4	4-3.5	3218-516
SK1007AA	4.5	4.5-4	3218-517
SK1008AA	5	5-4.5	3218-518
SK1009AA	5.5	5.5-5	3218-519
SK1010AA	6	6-5.5	3218-520
SK1011AA	6.5	6.5-6	3218-521
SK1012AA	7	7-6.5	3218-522
SK1013AA	7.5	7.5-7	3218-523
SK1014AA	8	8-7.5	3218-524
SK1015AA	8.5	8.5-8	3218-525
SK1016AA	9	9-8.5	3218-526
SK1017AA	9.5	9.5-9	3218-527
SK1018AA	10	10-9.5	3218-528

TYPE:SK25

ORDER NO.	ØD	CAP. mmØ	CODE NO.
SK2501AA	6	6-5.5	3218-570
SK2502AA	8	8-7.5	3218-571
SK2503AA	10	10-9.5	3218-572
SK2504AA	12	12-11.5	3218-573
SK2505AA	14	14-13.5	3218-574
SK2506AA	16	16-15.5	3218-575
SK2507AA	18	18-17.5	3218-576
SK2508AA	20	20-19.5	3218-577
SK2509AA	22	22-21.5	3218-578
SK2510AA	24	24-23.5	3218-579
SK2511AA	25	25-24.5	3218-580
SK2512AA	25.4	25.4-25	3218-581

TYPE:SK20

ORDER NO.	ØD	CAP. mmØ	CODE NO.
SK2001AA	3	3-2.75	3218-560
SK2002AA	4	4-3.5	3218-561
SK2003AA	6	6-5.5	3218-562
SK2004AA	8	8-7.5	3218-563
SK2005AA	10	10-9.5	3218-564
SK2006AA	12	12-11.5	3218-565
SK2007AA	16	16-15.5	3218-566
SK2008AA	20	20-19.5	3218-567