

Specifications

MultiXpress 6555/6545 series

Print	MultiXpress 6555N/NX	MultiXpress 6555NX	MultiXpress 6545N/NX	MultiXpress 6555NX
Speed *	Simplex : Up to 53 ppm in A4 (55 ppm in Letter) / Duplex : Up to 48 ipm in A4 (50 ipm in Letter)		Simplex : Up to 43 ppm in A4 (45 ppm in Letter) / Duplex : Up to 38 ipm in A4 (40 ipm in Letter)	
Resolution	1,200 x 1,200 dpi effective output			
First Print Out Time	Less than 8 seconds (From Ready mode)			
Emulation	PCL5e, PCL6, PostScript 3, TIFF, JPG, PDF v1.4			
Duplex Print	Standard			
Copy				
Speed **	Up to 53 cpm in A4 (55 cpm in Letter)		Up to 43 cpm in A4 (45 cpm in Letter)	
Resolution	600 x 600 dpi			
First Copy Out Time	Less than 5 seconds			
Zoom Rate	25 ~ 400% (platen), 25 ~ 200% (ADF)			
Multiple Copy	1~999 pages			
Duplex Copy	Built-in			
Copy Features	ID Copy, Clone Copy, N-up Copy, Poster Copy, Booklet	ID Copy, Clone Copy, Watermark Copy, Form Overlay Copy, Auto Crop Copy, N-up Copy, Poster Copy, Booklet		
Scan				
Compatibility	Twain standard, WIA standard			
Method	Colour Flatbed Scanner or DADF			
Resolution(Optical)	600 x 600 dpi			
Resolution(Enhanced)	4,800 x 4,800 dpi			
Scan to	HDD, USB, Email, Client, SMB, FTP			
FAX				
Compatibility	ITU-T G3			
Modem Speed	33.6 Kbps			
Resolution	Mono : 300 x 300 dpi / Colour : 200 x 200 dpi			
Memory	HDD Store			
Auto Dial	Speed dial : 200 Locations			
Fax Feature	On hook Dial, Auto Redial, Last Number Redial, Mail Box, Auto Reduction, Multi-send, Delayed Send, Fax forwarding (HDD / Email / Fax)			
Paper Handling				
Input Capacity and Types	520-sheet Cassette, 100-sheet Multi-Purpose Tray			
Output Capacity and Types	Up to 500-sheet Face Down			
Media Size	98 x 148 mm(3.85" x 5") ~ 215.9 x 356 mm (8.5" x 14")			
Media type	Plain, Thin, Envelopes, Labels, Card Stock, Bond, Archive, Punched, Pre-Printed, Recycled, Transparency, Letterhead, Thick, Coloured			
ADF Capacity	100-sheet DADF			
ADF Document Size	Width : 145 ~ 216mm (5.7"~8.5") / Length : 145 ~ 356mm (5.7" ~ 14.0") for Single page scan 145 ~ 400mm (5.7" ~ 15.7") for Multi pages scan			
General				
LCD	800 x 480 7" WVGA Colour Touch-Screen LCD			
Memory / Storage	256MB (Max. 512MB) / 80GB HDD			
OS Compatibility	Windows 2000/XP(32/64bit)/2003 Server(32/64bit)/Vista / 2008/ 7/ 2008 R2(64 only), Various Linux OS including Red Hat 8~9, Fedora Core 1~4, Mandrake 9.2~10.1 and SuSE 8.2~9.2 Mac OS 10.3~10.5, Citrix Presentation Server, Windows Terminal Services			
Interface	Hi-Speed USB 2.0, Ethernet 10/100/1000 base TX, USB host 2.0 (Scan to USB, USB print)			
Noise Level	Less than 55 dBA (Printing) / Less than 57 dBA (Copying) / Less than 37 dBA (Standby)			
Duty Cycle, monthly	Up to 250,000 pages		Up to 200,000 pages	
Dimension (W x D x H)	633 X 501 X 642 mm		641 x 494 x 607 mm (25.2" x 19.4" x 23.9")	
Warranty	44.85Kg (98.88lb)		48.2Kg (106.3lb)-with consumables	

* MultiXpress 6555/6545 series support open platform(XOA) for using 3rd party solutions.
Specifications are subject to change without notification.

Supplies and Options

Consumables	MultiXpress 6555N/NX	MultiXpress 6545N/NX
Yield ***	Toner : Average Cartridge Yield 25,000 standard pages. *** * Declared yield value in accordance with ISO/IEC 19752 Drum : 80,000 Pages (Ships with 25,000 page starter toner and 80,000 page drum)	
Type	2-piece Cartridge	
Model Code	Toner : SCX-D6555A, Drum : SCX-R6555A	
Options		
Options	256MB Memory: ML-MEM160, Optional Cassette Feeder(x3) : SCX-6555A, High Capacity Feeder : SCX-HCF100, Fax Kit: SCX-FAX210, Finisher: SCX-FIN11S, Staple Cartridge: SCX-STP000, Stand Short Type: SCX-DSK10S, Stand Tall Type: SCX-DSK10T, FDI Kit: SCX-KIT20F, 2 bin finisher : SCX-FIN20S, 4 bin MailBox : SCX-MBT40S	

* Print speed will be affected by Operating system used, computing performance, application software, connecting method, media type, media size and job complexity.
** Copy Speed is based on Single Document Multiple Copy.
*** Declared continuous cartridge yield value in accordance with ISO/IEC 19798.
Specifications are subject to change without notification.

2011. 11

Distributed by

Printing solutions
AS EASY AS



Maximized productivity
brings minimized cost



Samsung Monochrome Laser Copier MFPs
MultiXpress 6555/6545 series

Why Samsung?

With all the copiers and multifunction printers in the market, why choose Samsung?

Samsung is a world-renowned global company that regularly wins awards for reliability, design and innovative technology. It has the widest range of technologies and products, making it an expert in digital convergence. In the printing industry, Samsung is the fastest growing company, topping sales for many models.

Samsung has earned its reputation with award-winning excellence, based on performance, eco-friendliness and design innovation and for providing businesses with network and security solutions. Samsung products are reliable and deliver a high monthly duty cycle, keeping business productivity steady. In addition, they are reliable with low toner failure, and produce high quality colour prints which are more durable and last a long time without fading.

Samsung also acquired global recognition and certification for being environmentally responsible, in terms of production, post-consumer recycling and creating pollution-free work environment.

RANK	COMPANY
1	Coca-Cola
2	IBM
3	Microsoft
5	NOKIA
19	SAMSUNG
29	SONY
33	Canon
35	Nintendo
39	Deloitte

Unit : US\$ billion.
Source : Business Week / Interbrand

RANK	COMPANY
1	Apple
2	Google
3	TOYOTA
4	GE
5	Microsoft
8	P&G
9	SONY
12	IBM
22	3M
26	SAMSUNG

Source : Business Week April, 2008

The World's Most Admired Company



2006/2005	SCORE
1	General Electric 8.24
2	Siemens 7.19
3	Mitsubishi Electric Indl. 7.03
4	Samsung Electronics 6.79
5	Royal Philips Electronics 6.63
6	Sony 6.49
7	Hitachi 6.33



Why **MultiXpress**?

The **MultiXpress** 6555/6545 series is Samsung's innovative new copier MFP lineup, which is raising the bar for business imaging standards everywhere.

It outperforms competitors' MFPs with a wealth of advanced features included as standard and a well-earned reputation for total reliability. The **MultiXpress** 6555/6545 series will merge seamlessly with your existing business infrastructure via its integrated administrative and accounting solutions. With its unparalleled machine life, high quality black & white and colour output, and truly innovative features, it's no wonder the **MultiXpress** 6555/6545 series outshines everything in its class!



XOA (eXtensible Open Architecture)

* Only for 6555NX/6545NX

Overview

Multifunction peripherals are transitioning to software platforms from being network peripherals only used for printing, copying and scanning. XOA is a platform based on open standards and open interfaces. Solution partners and ISV developers can use the XOA to create custom applications that can be executed on the actual Samsung multifunction peripherals. XOA meets B2B's customization needs by providing a powerful SDK, differentiated Ecosystem and Partner program.



Solution Provider :



Delivery Type :

XOA SDK, downloadable from www.partnersamsung.com

Contact Information :

XOA_platform@samsung.com
www.partnersamsung.com

Special Features

- **Easy development**
 - Both Web services and java support
 - Rich documentation
 - Easy programming environment
 - Various sample codes
- **Full customization and extensibility**
 - Optimize OOB (Out of Box) features
 - Customizable OOB (Out of Box) applications
 - Personalized user experience
 - Customizable Web service (SOAP or REST)

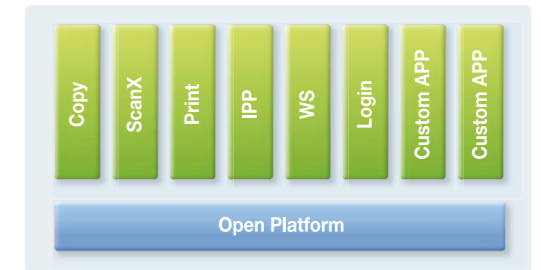

- **Easy Installation and management**
 - Plug & Play capabilities
 - Life cycle Management capabilities
- **Seamless host application development support**

Customer Workflow

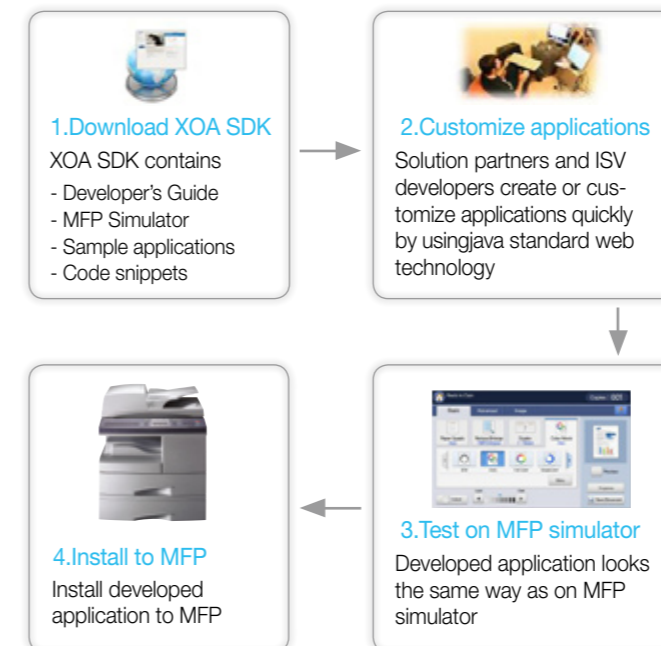

Operating System Requirements : Linux

Key Benefits

- **Response to customers' growing demand for solutions that leverage Samsung Multifunction peripherals**
 - Quick and rapid customization
 - Easy Integration with killer application
 - Limit own development efforts to "infrastructure" applications
- **Create added differentiation in a mature market**
 - Quick and - Feature-rich products
- **Boost customer loyalty**
 - Create great user experience

Samsung **MultiXpress** 6555/6545 series

imagine expanded productivity

Imagine a high-speed, high-end A4 DMFP that could centralize your printing workflow.

MultiXpress 6555/6545 series delivers fast printouts, but with full multifunction features like duplex and copying. And it features Samsung's document management solutions like SmarThru and SyncThru. With this digital solution at the centre of your business, you can eliminate your A3 DMFP and maximize your productivity. With Samsung **MultiXpress** 6555/6545 series, it's not that hard to imagine.



The most productive A4 DMFP

• Fast Copy

The **MultiXpress** 6555/6545 series produces 53ppm(6555N) & 43ppm(6545N) in black and white. Moreover, the **MultiXpress** 6555/6545 series performs nearly all the copy functions that are generally operated on A3 DMFP.



• Fast Print

Printing black-and-white document at 53 ppm(6555N, simplex) & 43 ppm(6545N, simplex) and 48ppm(6555N, duplex) & 38ppm(6545N, duplex) your workloads can be completed efficiently. The numerous standard printing features help you to print document more easily and efficiently

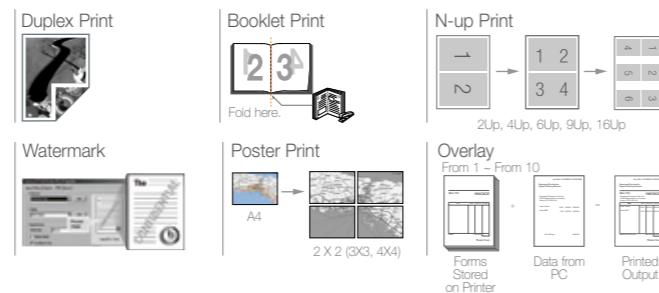

• Vivid Colour Scan & Network Scan

The **MultiXpress** 6555/6545 series's enhanced scanning resolution (4,800 x 4,800 dpi) and colour CCD method reproduce your document at its finest quality.

• Fast Fax (Option)

The optional fax kit offers speed dial up to 200 numbers, group dial up to 100 groups (up to 200 locations per group), duplex send and receive, fax-email and many other useful features. The duplex function enable the incoming fax be printed double-sided – save your printing cost!

• Less Space
Office space is also a big issue. In general, A3 DMFP occupies more office space. Typically, the footprint of a mono A3 capable device is much larger than that of an A4 device. **MultiXpress** 6555/6545 series's economical design takes up to 75% less space in your office than general A3 DMFPs so you have more room around you.

The Most Reliable Multifunction Center Maintains efficiency with Xpress reliability

Reliability is the word to describe **MultiXpress** 6555/6545 series. It offers all functions that business expect from a DMFP - the fastest printing, digital copy, scan and fax - at the same time increase business productivity with reliable performance, quality output and simple maintenance.

Reliable printers

We'll take the hassle away.

Samsung's leading edge printing technology will let you focus on your work whilst it delivers your documents time and time again. All of the printers within the **MultiXpress** 6555/6545 series provide unparalleled reliability with high monthly duty cycles (see table below). This is because Samsung has designed the machines to be less service dependent, providing fewer down time periods within its life-cycle along with less paper jams or mis-feeds.

In fact, we are confident that the only time you will open up your printer is to change the cartridge rather than to fix a paper jam.

Model	Max. Monthly Duty Cycle
6555N	250,000 prints
6545N	200,000 prints

Easy to Use

• Wide Touch Screen/UI Design

Samsung's exclusive 800 x 480 Colour wide LCD touch screen and intuitive UI design is very ergonomic and easy to use – no manual or training required!



• Convenient Installation



• Paper Handling

Adding optional paper trays to store up to 3,240 sheets of paper at one time, reduce the frequency to refill paper.

• Modular system

The modular design make it easy to replace consumables, adding accessory and/or upgrade package. For example, finisher or memory can be easily slotted onto the main device.

• Paper Jam

If and when a paper jam occurs the device indicates the problem area on the user display so you can simply, open the tray door to remove.

Wireless connectivity

For users who use multiple mobile devices, like smartphones or Tablet PCs the **MultiXpress** 6555/6545 series model delivers the ultimate flexibility. Saving time and hassle, Samsung Mobile Printing enables you to connect your mobile devices directly to your **MultiXpress** 6555/6545 series. There's no need to install a new driver or configure network settings, simply download the Samsung Mobile Printing application from the Samsung Web store, and once downloaded it will automatically detect compatible Samsung multifunctional printers. Giving you the flexibility to print files directly from your mobile device, without having to connect through a PC.





The Professional Solution Center Offers control with Xpress Customization

Powerful solution provides business professionalism to gain that winning edge. Samsung's **MultiXpress** provides high-speed printing and copying with customizable control to increase productivity and maintain economical running cost.

The most powerful solution center!

• Scan to Anywhere

The **MultiXpress** 6555/6545 series scans directly to email, FTP, SMB or the client. This offers a direct way to connect and distribute documents efficiently.

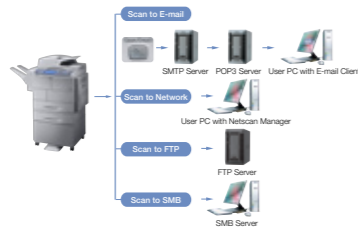

• Document Box

The **MultiXpress** 6555/6545 series includes an 160GB hard drive allowing it the capability of a Document Box function. Scanned information can be stored and managed. Data can then be printed, faxed, emailed or uploaded onto an FTP/SMB server direct from the printer.

• Standard Accounting

Standard accounting allows the administrator to manage the print usage for individual users. This function provides greater security and can help with restricting consumable usage by easy ID/PW based locking.

• SyncThru™ Admin 5

SyncThru™ Admin 5 service allows IT managers to easily manage and monitor all digital print devices on the network. Modification settings can easily provide a time and cost saving management tool.

• SyncThru™ Web Service

SyncThru™ Web Service is easily and remotely accessible through a web browser and provides administrators with the ability to change network and individual printer settings, upgrade firmware and view your network printer/MFP status.

• CounThru™ 2 Pro/Enterprise

CounThru™ is a server solution for Samsung Managed Print Services that offers visibility of networked devices for remote monitoring and management. It can also be used as a tool for accurate usage and billing information. CounThru™ supports a wide variety of network printers and MFP's so you can use this single tool to track them all.

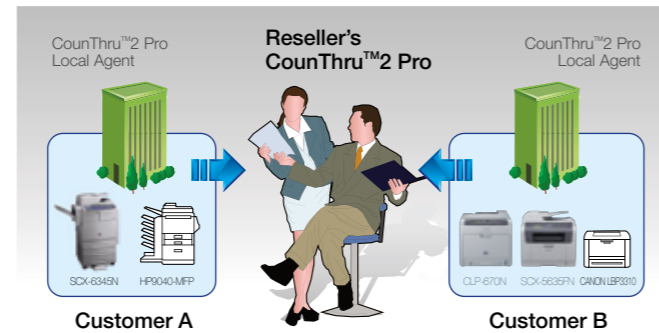

Keeping Your Office Environment Secure



When secure communications need to be considered, Samsung delivers the full coverage needed. The Samsung **MultiXpress** 6555/6545 series range offers convenient built-in security features to ensure protection against unauthorized users and network vulnerability. Users can benefit from the cost effectiveness and high level of security need to guarantee protection across the network, device and office environment.

• Samsung's Secure User Access

Samsung's Secure User Access protects unofficial users from accessing data through PIN and password authentication and can also be utilized to approve authorization and provide job accounting, meaning that you can manage and restrict the access to secure documents and files sent to your multifunction printer.

• Secure Data Functionality

As well as User Security, the Samsung 6555/6545 series range offers Secure Data Functionality. By offering the security options from encryption to HDD Image Overwrite users can securely store information on the device's hard disk drive, and by implementing an image overwrite function users can erase image data created during the copying, printing or scanning processes.

• Secure Networking Functionality

Secure Networking Functionality from SSL/TLS, SNMPv3, IPSec (IPv4, IPv6), and 802.1x (with EAP) makes access to the multifunction print features fast and secure, creating peace of mind for your office infrastructure.

• Secure Document Functionality

Alongside the data and network security, Samsung offers Secure Document Functionality to make document tagging i.e. watermarks and stamps, simple and easy, in order to provide high levels of security that are convenient and affordable.

• Secure Management

To ensure that all these security benefits are utilized to their highest levels Samsung offers a Secure Management system to provide logs, backup and email notification. This allows users to have an overall view of their secure documents even after they have been printed and stored.



Configuration	Option	Paper Capacity	
	1 Finisher + 1 SCF (Single Cassette Feeder) 520 sheets + HCF (High Capacity Feeder) 2.100 sheets	2,720 Sheets	
	1 Finisher + Max. 3 SCF (Single Cassette Feeder) 520 sheets x 3 + Short Stand	620 Sheets	
	1 Finisher + 1 SCF (Single Cassette Feeder) 520 sheets + Tall Stand	1,660 Sheets	