

HP Access Control Product Info



HP Access Control Professional

Overview

TARGET:

SMB & Enterprise customers interested in controlling printing costs and implementing advanced security and accounting controls

All-in-one bundle of pull printing, job accounting and rights management

Manage the Environment

- Take control of your print environment and increase visibility to information to manage costs
- Manage print costs with pull printing and rights management
- Keep print data secure while increasing user convenience and productivity.



HP Access Control Professional

A complete bundle of pull printing, job accounting and rights management

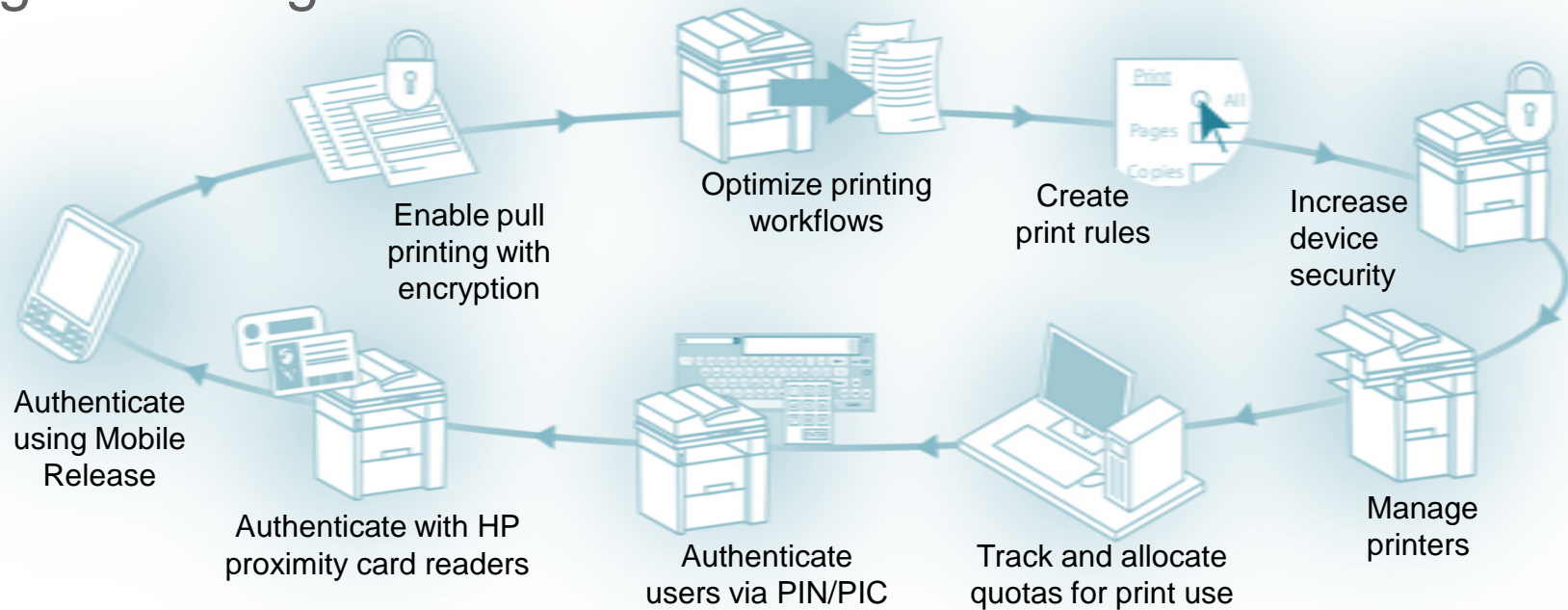

- With HP Access Control Professional, robust authentication and pull printing reduce the risks of unclaimed print jobs, sensitive documents left unattended, and frustrated users.
- Sophisticated job tracking helps you allocate printing costs and optimize device deployment.
- Intelligent management software and full reporting options can increase your control and insight into your printing environment.

HP Access Control

For customer who want to control printing costs and enhancing security.
Simplified with bundles & proximity card readers

SMB

HP Access Control Express

All-in-one bundle of pull print, job accounting and reporting

- Pull printing with mobile authentication
- Job accounting (without quotas)
- Reporting
- Bundled in a single package per device
- No options

SMB/Enterprise

HP Access Control Professional



All-in-one bundle of pull printing, job accounting and rights management

Same as Express, plus:

- Job accounting quotas
- Card authentication
- Print rules policy
- Rights management
- Bundled in a single package per device
- Proximity card reader optional

Enterprise

HP Access Control modular suite

A suite of modules for secure pull print, job accounting and rights management

Functionality as Pro bundle, plus:

- Secure pull print (enterprise) module
- Sold as individual modules

HP Access Control Bundle Comparison

| | HP AC Express | HP AC Professional | Modular Solutions |
|--------------------------------------|------------------------|--|------------------------------------|
| Authentication | | | |
| Mobile Release | ✓ | ✓ | |
| PIN & PIC | ✓ | ✓ | ✓ |
| Proximity Reader (CZ208A) | ✓ | ✓ | ✓ |
| Pull Printing | | | |
| Secure Pull Print Express | ✓ | ✓ | |
| Secure Pull Print | | | ✓ |
| Job Tracking and Reporting | | | Sold as per User |
| Job Tracking | Up to 30 Users | Up to 30 Users | ✓ |
| Job Accounting | No quota or allocation | ✓ | ✓ |
| Full Reporting (300+ reports) | ✓ | ✓ | ✓ |
| Policy | | | |
| IPM (Print Rules Policies) | | ✓ | ✓ |
| IRM (Walk-up Device Rights Policies) | | ✓ | ✓ |
| Other | | | |
| Encryption | | ✓ | ✓ |
| Add-on Modules | None Available | Common card reader Job Accounting User Pack | All Modules are sold independently |
| Price | | | |
| Per Device | \$199 | \$399 | Price per module |

HP Access Control Professional

Product Features

Secure Pull Printing Express — Empower mobile users and increase overall print efficiencies Allow users to dynamically print to the network and “pull” jobs to any solution-enabled HP device. Pull printing virtually eliminates unclaimed documents and increases the efficiency of mobile workers.

Secure Authentication—Quickly authenticate users at the device Protect your network print devices with robust authentication that include PIN, PIC, Smartcard, and Proximity card with features that integrate with your existing network credentials (i.e., LDAP, Active Directory). Increase document security by requiring user authentication prior to printing, copying, e-mailing or scanning at the device.

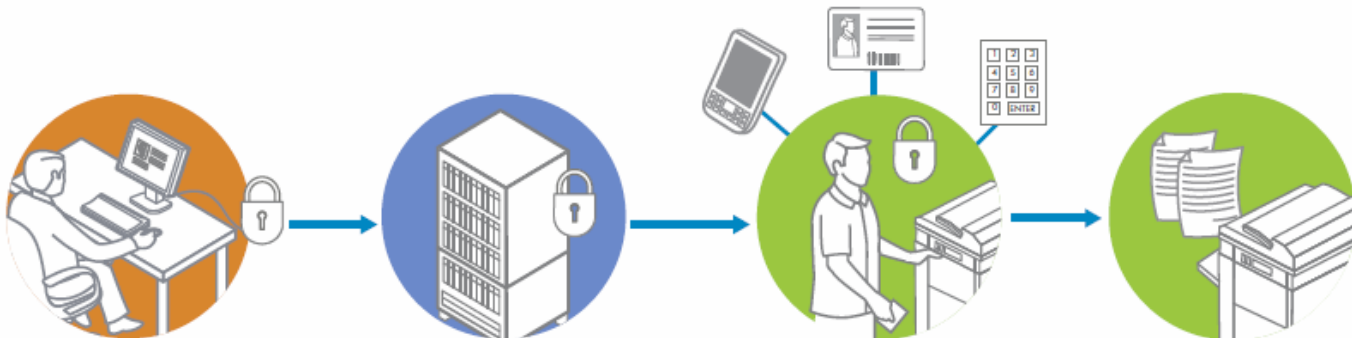

HP Access Control Professional

Product Features

Job Accounting—Audit and track print and copy use across the enterprise

Track the use of devices and supplies across the enterprise. Apply that information to allocate print costs, motivate employees to print smarter, and provide IT with the necessary data to forecast future print fleet use.

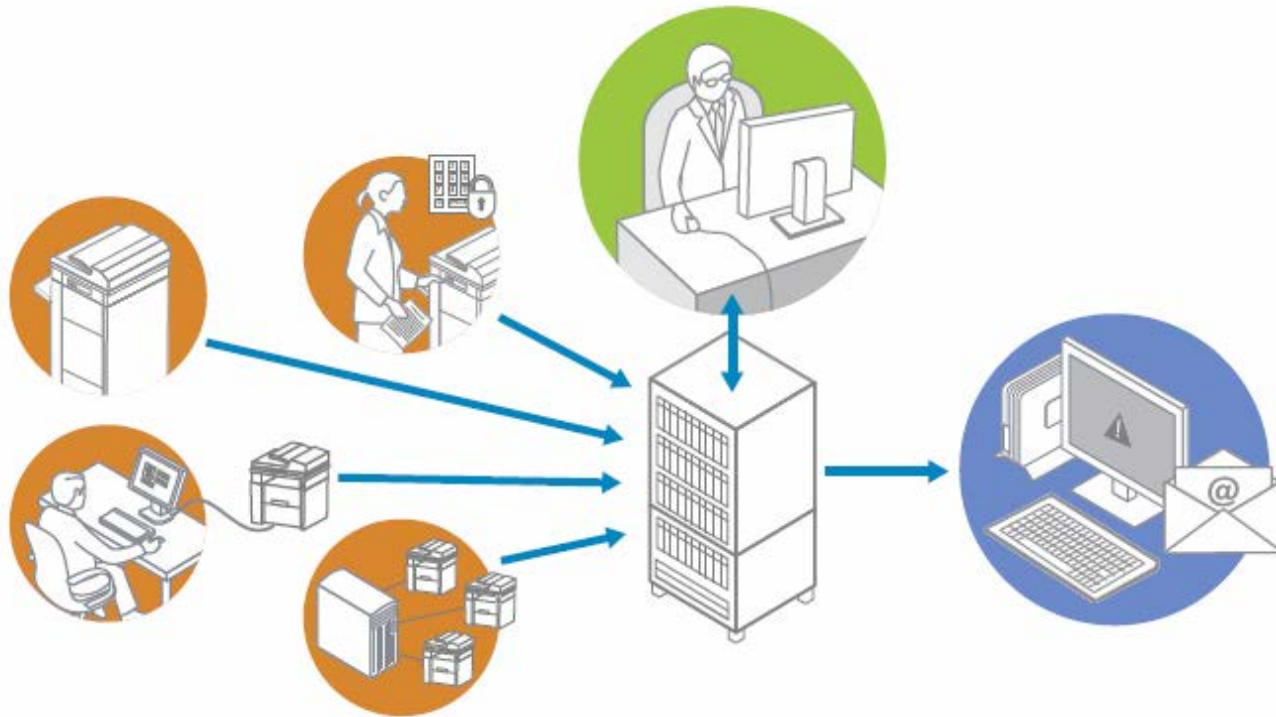

HP Access Control Professional

Product Features

Intelligent Print Management—Manage print output Create custom printing rules that enforce your enterprise's cost-cutting goals, compliance needs and green initiatives. Assign duplex (two-sided) printing as the default to save paper, restrict color printing to only those who need it, and balance device use with automatic job routing.

Intelligent Rights Management—Manage Device functions Create custom device user controls that enforce your enterprise's security needs, cost-cutting goals, and device usage. Assign specific function to individual users or groups that have the specific needs for faxing, copying or scanning. Know that you have the ability to limit unique functions based on specific user needs at the device.

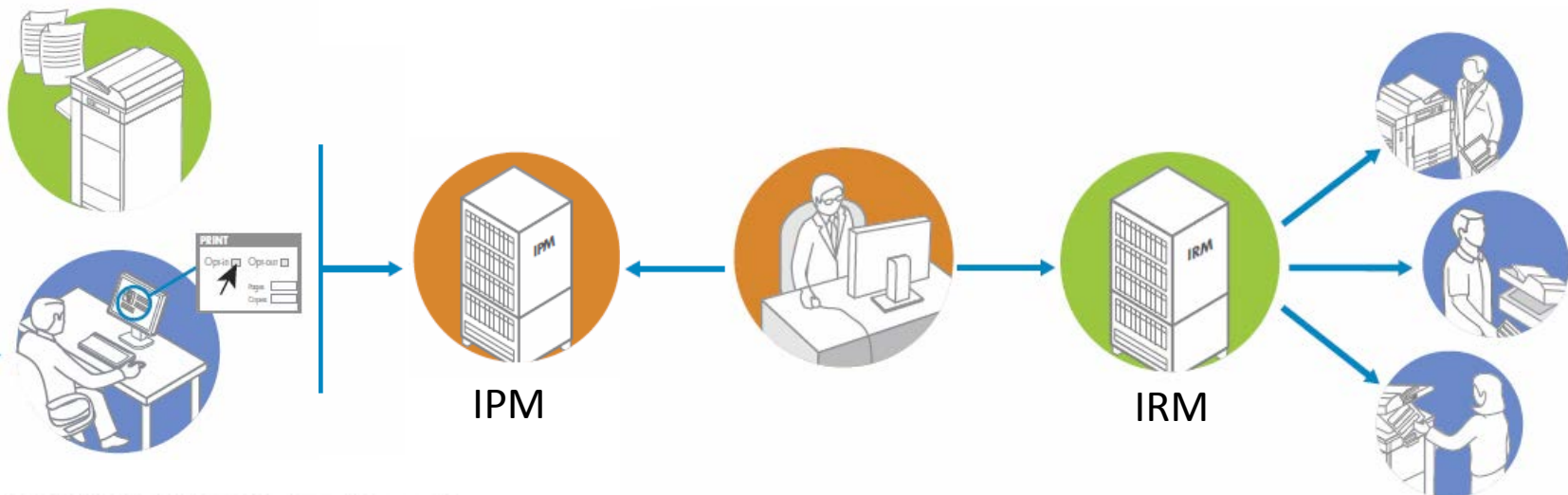

HP Access Control Mobile Release

Steps of mobile release

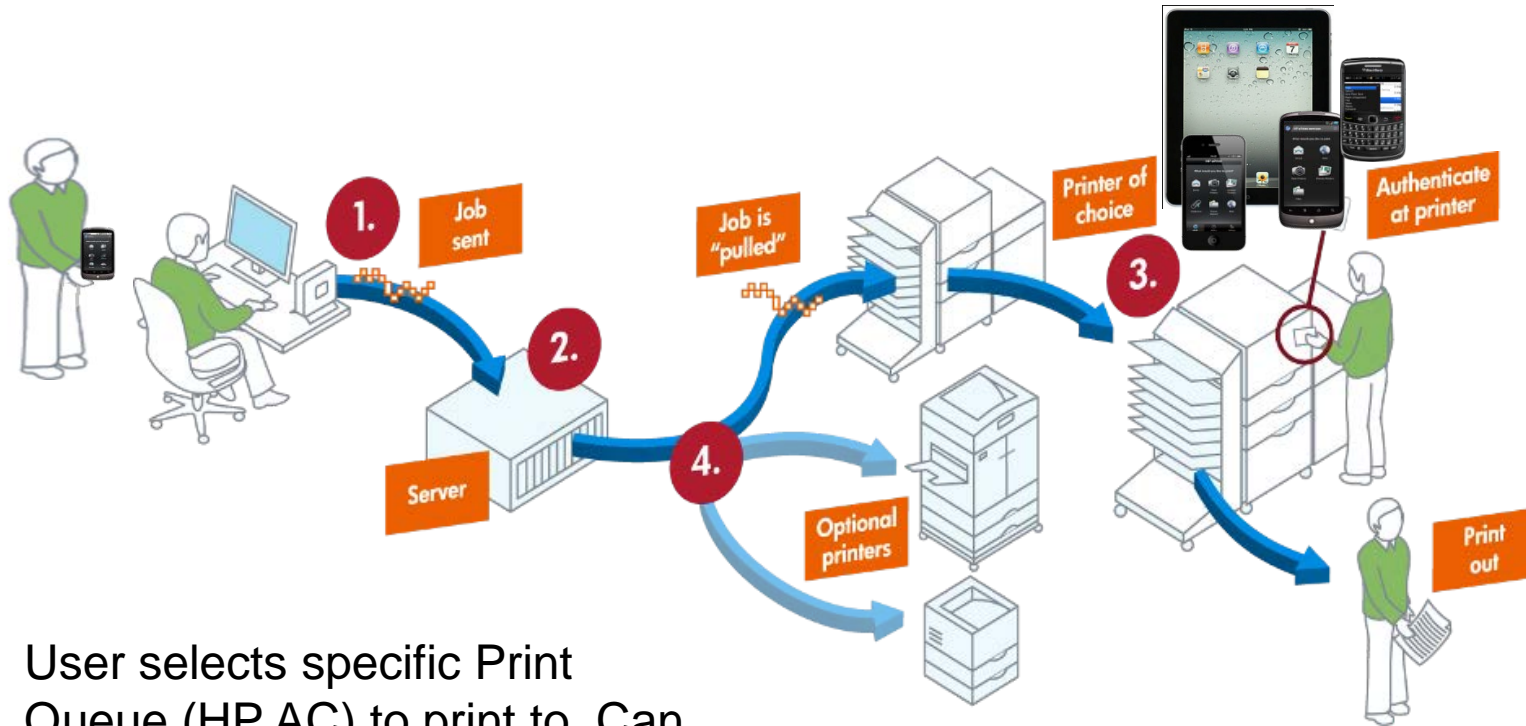

User selects specific Print Queue (HP AC) to print to. Can release print job at any HP AC enabled device.

Mobile release allows a customer to use their Smart device to authenticate, see their print jobs, select and release it.

HP Proximity Card Readers



HP Common USB Proximity Card Reader supports all protocols below

- Supports 2 different types of cards at one time, can support both frequencies at the same time
- Comes with multiple cables & HIP covers to go in HIP or use as an External reader



HP Common USB Proximity Card Reader – Supported Protocol/Configurations*

| | | |
|--|---------------------------------------|--|
| Awid | Cardax UID | CASI-RUSCO (GE Security & UTC) |
| Deister UID | ISO 14443A CSN | Advant CSN (Legic) |
| DESFire CSN | I-tag CSN (IBM) | MiFare CSN (Philips, NXP) |
| MiFare Ultralight CSN (Philips, NXP) | DIGITAG | EM/Marin EM 410x (RDR-6E8x Compatible) |
| EM/Marin EM 410x Alternate | GProx-II UID | HID iClass CSN |
| HID Prox | HiTag 1 and S Alternate | HiTag 1 & S (RDR-6H8x Compatible) |
| HiTag 2 Alternate | HiTag 2 Primary (RDR-6H8x Compatible) | Indala ASP 26 Bit |
| ISO 15693A CSN | etag CSN (Secura Key) | I-Code CSN (Philips, NXP) |
| my-d CSN (InP neon) | Tag-It CSN (Texas Instruments) | Indala ASP UID (Motorola) |
| Indala ASP+ UID (Motorola) | ioProx (Kantech) | Farpointe Data (Pyramid) NXT UID |
| Keri NXT UID | Pyramid (Farpointe Data) UID | Farpointe Data (Pyramid) NXT 26 Bit |
| Keri NXT 26 Bit | Pyramid (Farpointe Data) NXT 26 Bit | Keri UID (RDR-6K8x Compatible) |
| NexKey, Quadrakey, KeyMate, 2Smart Key (Honeywell) | Nexwatch (Honeywell) | Radio Key (Secura Key -02) (RDR-6Z8x Compatible) |
| ReadyKey PRO UID | Rosslare | Russwin UID |
| SecuraKey -01 | | |

*iClass and Legic supported by separate proximity card readers. Proximity card readers are available in USB or CF connections.



HP Access Control

HP device compatibility

- Mobile Release and Job Accounting Supports all printers/MFPs configured to work with server
- Pin Release from OXPd MFPs

Language localization

All User Interfaces translated in:

Dutch
 English
 Finnish
 French
 German
 Hungarian
 Italian
 Korean
 Portuguese (Brazil)

Simplified Chinese
 Spanish
 Swedish
 Traditional Chinese
 Turkish
 Polish
 Japanese
 Czech
 Slovak

| HP LASERJET PRINTERS | HP COLOR LASERJET PRINTERS | HP LASERJET MFP'S | HP COLOR LASERJET MFP'S |
|--|---|--|---|
|  P3015 |  CP3525 |  M3035 MFP |  CM3530 MFP |
|  P4014 |  CP4025 |  M4345 MFP |  CM4540 MFP |
|  P4015 |  CP4525 |  M4555 MFP |  CM6030 MFP |
|  P4515 |  CP5525 |  M5035 MFP |  CM6040 MFP |
|  5200 |  CP6015 |  M9040 MFP | |
|  9040 | |  M9050 MFP | |
|  9050 | | | |

Proximity Card Ordering information

- HP Common USB Proximity Card Reader (CZ208A)
- HP iClass USB Proximity Card Reader (CE931A)
- HP Legic USB Proximity Card Reader (CE983A)
- HP iClass CF Proximity Card Reader (BOD38A)
- HP Legic CF Proximity Card Reader (BOD39A)
- HP Common CF Proximity Card Reader (BOD40A)

