

File No.
DUPLICATE

T. 32. 20

County Blaine

STATE OF MONTANA
ADMINISTRATOR OF GROUNDWATER CODE
OFFICE OF STATE ENGINEER

JAN 6 1964

STATE ENGINEER

DECLARATION OF VESTED GROUNDWATER RIGHTS
(Under Chapter 237, Montana Session Laws, 1951)

North Fork School Dist. #61, of Chinook
(Name of Appropriator) (Address) (Town)

County of Blaine State of Montana
have appropriated groundwater according to the Montana laws in effect prior to Jan. 1, 1952, as follows:

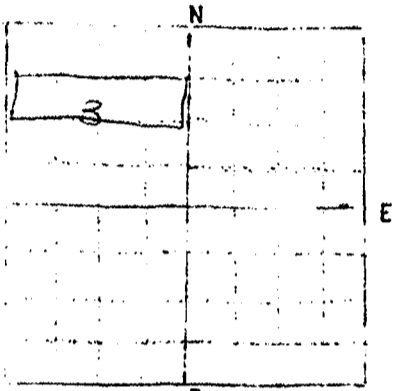

1/2 of NW 1/4

Sec. 3, T. 32, R. 20

Indicate point of appropriation
and place of use, if possible.

Each small square represents 5
acres.

2. The beneficial use on which the claim is based.....
School-house use

3. Date or approximate date of earliest beneficial use;
and how continuous the use has been.....
Not available

4. The amount of groundwater claimed (in miner's inches
or gallons per minute).....
2 gals. per Min.

5. If used for irrigation, give the acreage and descriptive
of the lands to which water has been applied and name
of the owner thereof.....
No

The means of withdrawing such water from the ground and
the location of each well or other means of withdrawal.....
Pressure pump

The date of commencement and completion of the construction of the well, wells, or
other works for withdrawal of groundwater.....

The depth of water table..... 165 ft.

So far as it may be available, the type, size and depth of each well or the general
specifications of any other works for the withdrawal of groundwater.....
6 in. steel casing

The estimated amount of groundwater withdrawn each year..... Continuous use

The log of formation encountered in the drilling of each well if available.....
Not available

Such other information of a similar nature as may be useful in carrying out the policy
of this act, including reference to book and page of any county record.....

Signature of Owner School Dist. 61
by Mrs. Herald Magda

Date.....

STATE OF MONTANA)
County of) ss.

..... having first been duly sworn, depose... and say
that ..he...of lawful age and.....the appropriator... and claimant... of the
order and water right mentioned in the foregoing declaration of vested groundwater
rights and the person... whose name... subscribed thereto, as the appropriator... and
claimant..., that ..he ... know... the contents of said foregoing notice and that the
matters and things therein stated are true.

21944

252105

STATE OF MONTANA
County of Blaine

FILED FOR RECORD THIS 31 DAY
OF December A. D. 1963
AT 4:55 O'CLOCK P. M.
Cora L. Neenan
COUNTY CLERK
C. L. Sheets
DEPUTY
FEB 2 1963

File No.

T. 37 R. 20

DUPLICATE

County Blaine

STATE OF MONTANA
ADMINISTRATOR OF GROUNDWATER CODE
OFFICE OF STATE ENGINEER

RECEIVED
SEP 5 1963

Declaration of Vested Groundwater Rights

(Under Chapter 237, Montana Session Laws, 1961)

STATE ENGINEER

E. L. Patchell
(Name of Appropriator)

of Chinook
(Address)

(Town)

County of Blaine

State of Montana

have appropriated groundwater according to the Montana laws in effect prior to January 1, 1962, as follows:

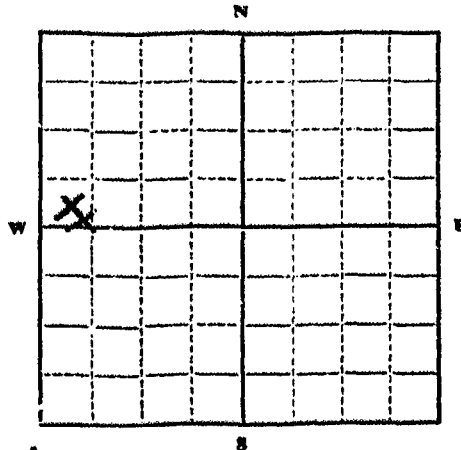

Sec. 4 T. 37 R. 20

Indicate point of appropriation and place of use, if possible. Each small square represents 10 acres.

2. The beneficial use on which the claim is based...
Household and stock water only.

3. Date or approximate date of earliest beneficial use; and how continuous the use has been...
1900 and continuously since.

4. The amount of groundwater claimed (in miner's inches or gallons per minute)...
adequate

5. If used for irrigation, give the acreage and description of the lands to which water has been applied and name of the owner thereof...
none

6. The means of withdrawing such water from the ground and the location of each well or other means of withdrawal...
electric shallow well pumps

7. The date of commencement and completion of the construction of the well, wells, or other works for withdrawal of groundwater...
1900 and was dug the second one was drilled in July 1949

8. The depth of water table...
no. 1 22 feet no. 2 65 feet drilled

9. So far as it may be available, the type, size and depth of each well or the general specifications of any other works for the withdrawal of groundwater...
none

10. The estimated amount of groundwater withdrawn each year...
Just as needed

11. The log of formations encountered in the drilling of each well if available...
Dirt gravel and clay

12. Such other information of a similar nature as may be useful in carrying out the policy of this act, including reference to book and page of any county record...

E. L. Patchell is ~~buying~~ buying this land on ~~Contract~~ for Deed from Mr. Bosch.

Signature of Owner Fred W. Bosch

Date Sept. 4, 1963

Three copies to be filed by the owner with the County Clerk and Recorder of the county in which the well is located.

Please answer all questions. If not applicable, so state, otherwise the form will be returned.

Original to the County Clerk and Recorder; duplicate to the State Engineer; Triplicate to the Montana Bureau of Mines and Geology, and Quadruplicate for the Appropriator.

5698

250295

STATE OF MONTANA
County of Blaine
FILED FOR RECORD THIS 1st DAY
OF Sept A. D. 1963
AT 11:00 O'CLOCK A. M.
Gene T. Munson
COUNTY CLERK
Esther Sheets
DEPUTY
FEE 1.00

RECORDS SECTION

RECEIVED

File No.

T. R.

DUPLICATE

DEC 29 1969

County Blaine

LOG

STATE OF MONTANA
ADMINISTRATOR OF GROUNDWATER CODE
OFFICE OF STATE ENGINEER

Notice of Completion of Groundwater
Appropriation by Means of Well

DEVELOPED AFTER JANUARY 1, 1962

(Under Chapter 237, Montana Session Laws, 1961)

Top of Ground
(Elev. above sea level.....)

0
5
25 sand & gravel
49
49
49 Bottom

Owner Richard L. ... Address ...

Driller ... Address ...

Date of Notice of appropriation of groundwater.....

Date well started 11-12-69 Date completed 11-15-69

Type of well ... Equipment used ...
(Dug, Driven, bored or drilled) (Churn drill, rotary or other)

Water use: Domestic Municipal Stock Irrigation
Industrial Drainage Other

Indicate on the diagram the character and thickness of the different strata met with in drilling, such as soil, clay, shale, gravel, rock or sand, etc. Show depth at which water is encountered, thickness and character of water-bearing strata and height to which the water rises in the well.

Size of Drilled Hole	Size and Weight of Casing	From (Feet)	To (Feet)	PERFORATIONS		
				Kind Size	From (Feet)	To (Feet)
4"	4" x 21 lb	0	49			

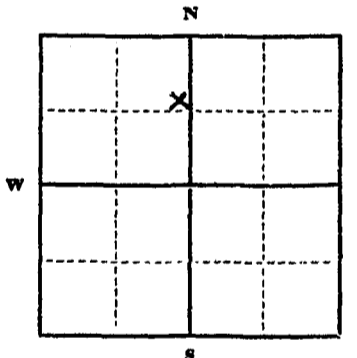

Static Water Level for non-flowing well 10 feet.

Shut-in Pressure for Flowing Well ---

Pumping Water Level 4.5 feet at 1.7 gal. per minute.

Discharge in gal. per min. of flowing well ---

How Tested ...

Length of Test ...

Remarks: (Gravel packing, cementing, packers, type of shutoff) ---

1/4 Sec. 4 T. 32 R. 20
Indicate location of well and place of use, if possible. Each small square represents 40 acres.

(Continue on reverse side)

USE—If used for irrigation, industrial, drainage or other. Explain, state number of acres and location or other data (i.e.: Lot, Block and Addition).

This form to be prepared by driller, and three copies to be filed by the owner with the County Clerk and Recorder in the county in which the well is located, tissue copy to be retained by driller.

Please answer all questions. If not applicable, so state, otherwise the form will be returned.

31
Driller's License Number

...
Driller's Signature

46006

264523

STATE OF MONTANA
County of Blaine
Filed for record this 23 ^{Day}
of December 1969
at 8:15 ^{A.M.}
Caro B. Messner
County Clerk

For 2⁰⁰ Deputy

File No. _____

T 32 R 20

DUPLICATE

County Blaine

STATE OF MONTANA
ADMINISTRATOR OF GROUNDWATER CODE
OFFICE OF STATE ENGINEER

RECEIVED
JAN 6 1964
STATE ENGINEER

Declaration of Vested Groundwater Rights

(Under Chapter 237, Montana Session Laws, 1961)

1. William Bilger, Jr. of Route 1 Chinook
(Name of Appropriator) (Address) (Town)
Blaine Montana
County of _____ State of _____
have appropriated groundwater according to the Montana laws in effect prior to January 1, 1962, as follows:

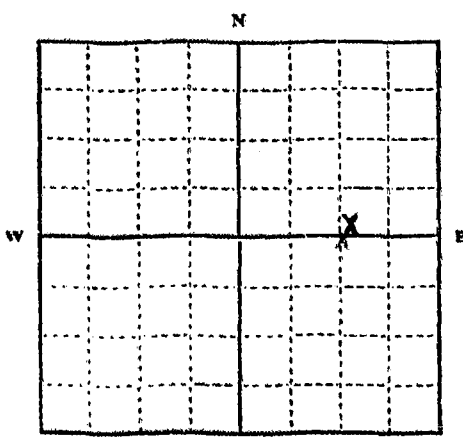

SE NE 4 32 20
1/4 Sec. T. R.

Indicate point of appropriation and place of use, if possible. Each small square represents 10 acres.

- 2. The beneficial use on which the claim is based Household and stock water
- 3. Date or approximate date of earliest beneficial use; and how continuous the use has been 1915 and used continuously since that date.
- 4. The amount of groundwater claimed (in miner's inches or gallons per minute) 10 gallons per minute
- 5. If used for irrigation, give the acreage and description of the lands to which water has been applied and name of the owner thereof Not applicable
- 6. The means of withdrawing such water from the ground and the location of each well or other means of withdrawal centrifugal pump. SE 1/4 of NE 1/4
- 7. The date of commencement and completion of the construction of the well, wells, or other works for withdrawal of groundwater July 9, 1919 and completed on July 25, 1919.
- 8. The depth of water table 35 feet
- 9. So far as it may be available, the type, size and depth of each well or the general specifications of any other works for the withdrawal of groundwater drilled well with 6" casing. 67 feet deep
- 10. The estimated amount of groundwater withdrawn each year 700,000 gallons
- 11. The log of formations encountered in the drilling of each well if available No log available
- 12. Such other information of a similar nature as may be useful in carrying out the policy of this act, including reference to book and page of any county record. Not applicable

Signature of Owner Wm A Bilger Jr.
Date December 30, 1963

Three copies to be filed by the owner with the County Clerk and Recorder of the county in which the well is located.

Please answer all questions. If not applicable, so state, otherwise the form will be returned.

Original to the County Clerk and Recorder; Duplicate to the State Engineer; Triplicate to the Montana Bureau of Mines and Geology, and Quadruplicate for the Appropriator.

21867

252024

STATE OF MONTANA
County of Blaine

FILED FOR RECORD THIS 30 DAY

OF December A. D. 1963

AT 2:36 O'CLOCK P M.

Carroll M. Mueser
COUNTY CLERK

2.00 DEPUTY

STATE OF MONTANA
ADMINISTRATOR OF GROUNDWATER CODE
MONTANA WATER RESOURCES BOARD

NOTICE OF COMPLETION OF GROUNDWATER
APPROPRIATION BY MEANS OF WELL

Developed after January 1, 1962

(Under Chapter 237 Montana Session Laws, 1961, as amended)

This form to be prepared by driller, and three copies to be filed by the owner with the County Clerk and Recorder in the county in which the well is located, last copy to be retained by driller.

Please answer all questions. If not applicable, so state, otherwise the form may be returned.

Owner William Bilguje

Address Channah
Mont.

Date well started 11/10/70

completed 11/14/70

Type of well drum and drilled
(Dug, driven, bored or drilled)

Equipment used Churn drill
(Churn drill, rotary or other)

Water Use: Domestic Municipal Stock Irrigation
Industrial Drainage Other * Garden/Lawn

*Describe _____

USE: If used for irrigation, industrial, drainage or other. Explain, state number of acres and location or other data (i.e. Lot, Block and Addition). _____

ESTIMATED ANNUAL WITHDRAWAL _____

Size of Drilled Hole	Size and Weight of Casing	From (Feet)	To (Feet)	PERFORATIONS		
				Kind	From (Feet)	To (Feet)
7"	7x26"	0	77			
6"	5x11"	45	130	1"	11"	130

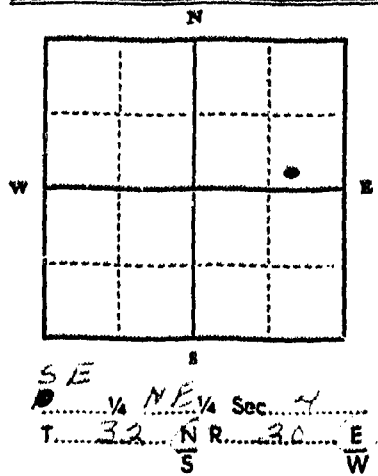

Static water level 4 ft.*
Pumping water level 130 ft.*
at 2.6 gallons per minute,
measured 2.5 minutes after pumping began.
*Measured from ground level.
Well developed by _____
for 2 hours.
Power _____ Pump _____ HP
Remarks: (Gravel packing, cementing, packers, type of shutoff) _____

INDICATE LOCATION OF WELL AND PLACE OF USE, IF POSSIBLE. EACH SMALL SQUARE REPRESENTS 40 ACRES.

Driller's Signature _____

Driller's Address _____

LICENSE NO. 31

DRILLER'S LOG

Indicate the character, color, thickness of strata such as soil, clay, sand, gravel, shale, sandstone, etc. Show depth at which water is found and height to which water rises in well.

Top of Ground		(Elev. above sea level)
From (Feet)	To (Feet)	
0	10	topsoil
10	71	clay with occasional gravel
71	101	gray shale
101	108	gray shale
108	111	gray shale
111	115	gray shale & water (39.2)
115	120	gray shale
120	127	gray shale & water
127	130	gray shale
130		bottom

Show exact depth of bottom

47887

RECEIVED

County Blaine

4

STATE OF MONTANA
ADMINISTRATOR OF GROUNDWATER CODE
MONTANA WATER RESOURCES BOARD

DEC 14 1970

DRILLER'S LOG

Indicate the character, color, thickness of strata such as soil, clay, sand, gravel, shale, sandstone, etc. Show depth at which water is found and height to which water rises in well.

NOTICE OF COMPLETION OF GROUNDWATER APPROPRIATION BY MEANS OF WELL

Developed after January 1, 1962

(Under Chapter 237 Montana Session Laws, 1961, as amended)

This form to be prepared by driller, and three copies to be filed by the owner with the County Clerk and Recorder in the county in which the well is located, last copy to be retained by driller.

Please answer all questions. If not applicable, so state, otherwise the form may be returned.

Owner William Bilgus
Address Chinook Mont.
Date well started 11/10/70
completed 11/14/70
Type of well driven and drilled
Equipment used Churn drill
Water Use: Domestic Municipal Stock Irrigation
Industrial Drainage Other * Garden/Lawn

For Administrator's Use
File 266251
December 11, 1970
11:30 A.M.
GW 1

*Describe
USE: If used for irrigation, industrial, drainage or other. Explain, state number of acres and location or other data (i.e. Lot, Block and Addition).

ESTIMATED ANNUAL WITHDRAWAL

Size of Drilled Hole	Size and Weight of Casing	From (Feet)	To (Feet)	PERFORATIONS		
				Kind Size	From (Feet)	To (Feet)
7"	7x26"	0	77			
6"	5 1/2 x 11	08	130	1/2 x 3/8	110	130

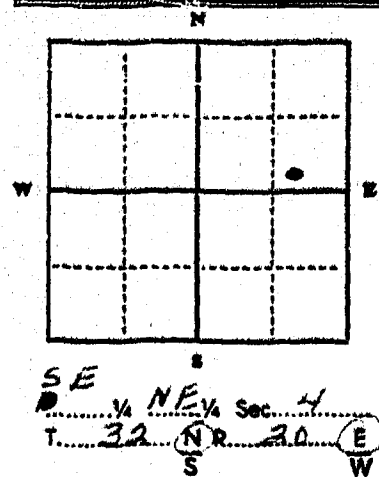

Static water level 4 ft.*
Pumping water level 1.90 ft.*
at 2.0 gallons per minute,
measured 2 minutes after pumping
began.
*Measured from ground level.
Well developed by churn
for 2 hours.
Power..... Pump..... HP
Remarks: (Gravel packing, cementing,
packers, type of shutoff)

INDICATE LOCATION OF WELL AND PLACE OF USE, IF POSSIBLE. EACH SMALL SQUARE REPRESENTS 40 ACRES.

Driller's Signature Leslie MacArthur
Driller's Address Chinook

LICENSE NO. 31

Top of Ground (Elev. above sea level)		
From (Feet)	To (Feet)	
0	11	topsoil
10	71	reddish brown sandstone
71	101	gray shale
101	108	gray sandstone
108	111	gray shale
111	115	gray shale with (3g. sh.)
115	125	gray shale
120	127	gray sandstone & water
127	130	gray shale
130		bottom

Show exact depth of bottom

47887

266257

STATE OF MONTANA }
County of Blaine }

Filed for record this 11 Day

of Dec A. D. 1972

at 11:30 o'clock A. M.

Caro L. Duquesne
County Clerk

Fee 2.00 Deputy

T. 32 R. 20

County *Blaine*

MONTANA BUREAU OF MINES AND GEOLOGY
Butte, Montana

RECEIVED
AUG 27 1961

WATER WELL LOG

STATE ENGINEER

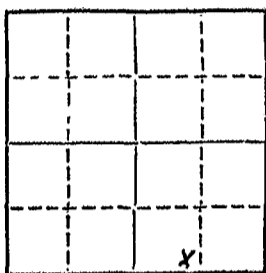

Owner *John H. Overcast* Address *Chinook*

Driller *Simpson Drilling Co* Address *Matta*

Date Started *August 25, 1961* Date Completed *Aug. 28*

Location: Sec. *5* T. *32* R. *20* 1/4 sec. *S.E.*

Type of well *Drilled* (Dug, driven, bored, or drilled) Equipment used *Churn drill* (Churn drill, rotary, other)

Water use: Domestic Municipal Stock Irrigation
Industrial Drainage Other: _____

Casing: *8* ft. to *115* ft. Type *Steel* Size *6"*

Casing: _____ ft. to _____ ft. Type _____ Size _____

Casing: _____ ft. to _____ ft. Type _____ Size _____

Perforated or Screened: Ft. *95* to ft. *115* Ft. _____ to ft. _____

Type of screen or perforations *1/4" holes drilled in casing*

Static Water level, for non-flowing well: *57* feet.

Shut-in pressure, for flowing well: _____ lb./sq. in. on: _____ (date)

Pumping water level: *73* feet at *16* gal. per min.

How tested: *Bailer*

Length of test: *1 hour*

Remarks: (Gravel packing, cementing, packers, type of shut-off, depth of shut-off)
Gravel packed 10-115 ft

(over)

STATE OF MONTANA
ADMINISTRATOR OF GROUNDWATER CODE
MONTANA WATER RESOURCES BOARD

NOTICE OF COMPLETION OF GROUNDWATER
APPROPRIATION BY MEANS OF WELL

Developed after January 1, 1962

(Under Chapter 237 Montana Session Laws, 1961, as amended)

This form to be prepared by driller, and three copies to be filed by the owner with the County Clerk and Recorder in the county in which the well is located, last copy to be retained by driller.

Please answer all questions. If not applicable, so state, otherwise the form may be returned.

Owner Howard Hermes

Address Chinook, Mt.

Date well started 10/12/71

completed 10/15/71

Type of well drilled

Equipment used Churn drill

Water Use: Domestic Municipal Stock Irrigation
Industrial Drainage Other * Garden/Lawn

*Describe _____
USE: If used for irrigation, industrial, drainage or other. Explain, state number of acres and location or other data (i.e. Lot, Block and Addition).

ESTIMATED ANNUAL WITHDRAWAL

Size of Drilled Hole	Size and Weight of Casing	From (Feet)	To (Feet)	PERFORATIONS		
				Kind Size	From (Feet)	To (Feet)
8 3/4	8 5/8	0	19			
7 3/4	6 5/8	10	122	1/4 x 2	102	122

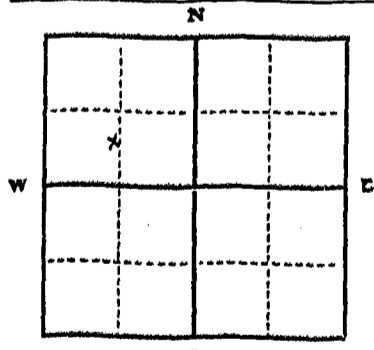

SW 1/4 NW 1/4 Sec. 8
T. 32 N. R. 20 E.

Static water level 30 ft.*
Pumping water level 122 ft.*
at 10 gallons per minute,
measured _____ minutes after pumping began.
*Measured from ground level
Well developed by bauling
for 2 hours.
Power etc Pump 1/2 HP
Remarks: (Gravel packing, cementing, packers, type of shutoff)

INDICATE LOCATION OF WELL AND PLACE OF USE, IF POSSIBLE. EACH SMALL SQUARE REPRESENTS 40 ACRES.

Driller's Signature Lester Wankuta

Driller's Address Chinook, Mt.

LICENSE NO. 31

DRILLER'S LOG

Indicate the character, color, thickness of strata such as soil, clay, sand, gravel, shale, sandstone, etc. Show depth at which water is found and height to which water rises in well.

Top of Ground (Elev. above sea level)		
From (Feet)	To (Feet)	
0	15	sand & shale
15	26	dark grey shale
26	46	grey shale
46	65	dark grey shale
65	80	grey shale
80	95	grey sandstone
95	100	light shale
100	105	shale
105	122	grey sandstone & water
	122	bottom

122 Show exact depth of bottom

269975

STATE OF MONTANA

County of Blaine

Filed for Record this 29 Day

of October 1974

At 1:12 P.M.

William J. DeMick
Clerk

Fee

RECORDED & INDEXED
MONTANA DEPARTMENT OF REVENUE
COUNTY OF BLAINE

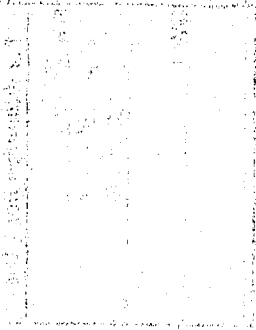

NOTARIAL PUBLIC
STATE OF MONTANA
My Commission Expires

A large grid area at the bottom of the page, likely for recording multiple entries or a ledger. The grid consists of approximately 10 columns and 20 rows of small squares.

File No.

DUPLICATE

T. 32 R. 20

County...

JUN 6 1964

STATE OF MONTANA
ADMINISTRATOR OF GROUNDWATER CODE
OFFICE OF STATE ENGINEER

Declaration of Vested Groundwater Rights

(Under Chapter 237, Montana Session Laws, 1961)

I, Herman Kethman, of Chinook, Montana
(Name of Appropriator) (Address) (Town)

County of Blaine State of Montana
have appropriated groundwater according to the Montana laws in effect prior to January 1, 1962, as follows:

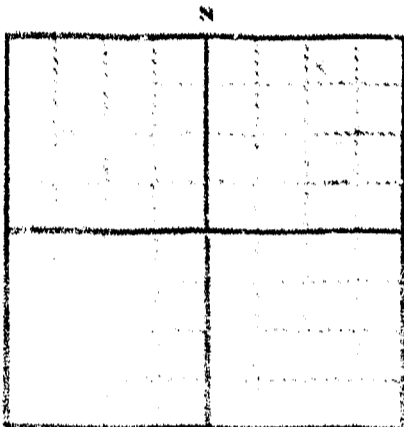

2. The beneficial use on which the claim is based. House

3. Date or approximate date of earliest beneficial use; and how continuous the use has been. 1938

4. The amount of groundwater claimed (in cubic feet or gallons per minute). 4 gal.

5. If used for irrigation, give the average and description of the lands to which water has been applied and name of the owner thereof. Law & Seed

6. The means of withdrawing such water from the ground and the location of such well or other means of withdrawal. Pump

[Handwritten notes and scribbles]

7. The date of commencement and completion of the construction of the well, wells or other means for withdrawal of groundwater.

8. The date of the first use of the well, wells or other means for withdrawal of groundwater.

9. The name of the person or persons who have constructed the well, wells or other means for withdrawal of groundwater.

10. The name of the person or persons who have used the well, wells or other means for withdrawal of groundwater.

11. The name of the person or persons who have owned the well, wells or other means for withdrawal of groundwater.

12. Any other information that the declarant deems material to the declaration of vested groundwater rights.

Herman Kethman
June 3, 1964

13. The name of the person or persons who have been in possession of the well, wells or other means for withdrawal of groundwater.

14. The name of the person or persons who have been in control of the well, wells or other means for withdrawal of groundwater.

15. The name of the person or persons who have been in charge of the well, wells or other means for withdrawal of groundwater.

File No.

T. 32 R. 20

DUPLICATE

County

JAN 6 1964

STATE OF MONTANA
ADMINISTRATOR OF GROUNDWATER CODE
OFFICE OF STATE ENGINEER

Declaration of Vested Groundwater Rights

(Under Chapter 237, Montana Session Laws, 1961)

1. Norman Nathman, of Shinook Montana
(Name of Appropriator) (Address) (Town)

County of Blaine State of Montana
have appropriated groundwater according to the Montana laws in effect prior to January 1, 1962, as follows:

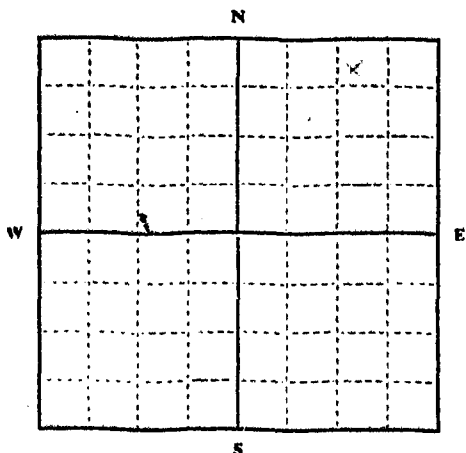

2. The beneficial use on which the claim is based House

3. Date or approximate date of earliest beneficial use; and how continuous the use has been 1938

4. The amount of groundwater claimed (in miner's inches or gallons per minute) 4 gal.

5. If used for irrigation, give the acreage and description of the lands to which water has been applied and name of the owner thereof Sawn & Trees

6. The means of withdrawing such water from the ground and the location of each well or other means of withdrawal Pump

7. The date of commencement and completion of the construction of the well, wells, or other works for withdrawal of groundwater 1938

8. The depth of water table 20 ft.

9. So far as it may be available, the type, size and depth of each well or the general specifications of any other works for the withdrawal of groundwater 110 ft deep 6 in 4 1/2 inch steel casing

10. The estimated amount of groundwater withdrawn each year 200,000

11. The log of formations encountered in the drilling of each well if available

12. Such other information of a similar nature as may be useful in carrying out the policy of this act, including reference to book and page of any county record

Signature of Owner Norman Nathman
Date Dec 31 1963

Three copies to be filed by the owner with the County Clerk and Recorder of the county in which the well is located.

Please answer all questions. If not applicable, so state, otherwise the form will be returned.

Original to the County Clerk and Recorder; Duplicate to the State Engineer; Triplicate to the Montana Bureau of Mines and Geology, and Quadruplicate for the Appropriator.

21913

252072

STATE OF MONTANA
County of Blaine

FILED FOR RECORD THIS 31 DAY

OF December A. D. 1963

AT 9:45 O'CLOCK AM.

Car L. Musgrave
COUNTY CLERK

2.00
FEE

DEPUTY

File No. GW 2

T. 32 R. 20 9

DUPLICATE

County Blaine

STATE OF MONTANA RECEIVED
ADMINISTRATOR OF GROUNDWATER CODE
OFFICE OF STATE ENGINEER DEC 23 1963

Top of Ground
(Elev. above sea level)

1 top soil
24 brown clay boulders
34 lite blue shale
35 rock
52 lite gray shale
53 tan shale
74 sandy lite gray shale
82 blue shale
102 sandstone

Notice of Completion of Groundwater Appropriation by Means of Well

(Under Chapter 237, Montana Session Laws, 1961)

Owner Kathman Bros. Address Chinook Montana

Driller Simpson Drilling Co. Address Malta, Montana

Date of Notice of appropriation of ground water _____

Date well started 12/4/63 Date Completed 12/7/63

Type of well drilled _____ Equipment used cable tools
(dug, driven, bored or _____
drilled) (Chain, drill, rotary or
other)

Water use: Domestic Municipal Stock Irrigation
Industrial Drainage Other

Indicate on the diagram the character and thickness of the different strata met with in drilling, such as soil, clay, shale, gravel, rock or sand, etc. Show depth at which water is encountered, thickness and character of water-bearing strata and height to which the water rises in the well.

Size of Drilled Hole	Size and Weight of Casing	From (Feet)	To (Feet)	PERFORATIONS		
				Kind Size	From (Feet)	To (Feet)
6"	5" 17 Lbs	18" AG	102	1/4	79	102

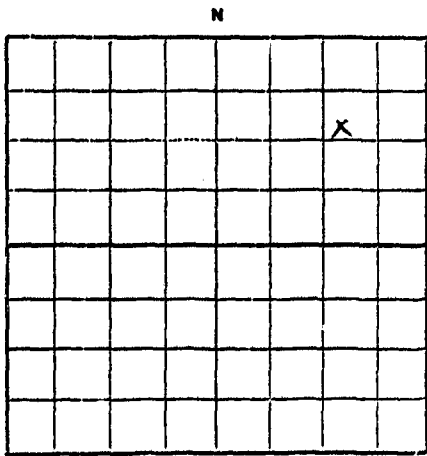

NE 1/4, NW 1/4 Sec. 9, T 32 R 20
Indicate location of well and place of use, if possible. Each small square represents 10 acres.

Static Water Level for non-flowing well 31 feet.

Shut-in Pressure for Flowing Well _____

Pumping Water Level 75 feet
at 7 gal. per minute.

Discharge in gal. per min. of flowing well _____

How Tested pumped

Length of Test 2 hours

Remarks: (Gravel packing, cementing, packers, type of shutoff, location of place of use of groundwater if not at well, and any other similar pertinent information, including number of acres irrigated, if used for irrigation) _____

15

Driller's License Number

Driller's Signature

This form to be prepared by driller, and three copies to be filed by the owner with the County Clerk and Recorder in the county in which the well is located.

Please answer all questions. If not applicable, so state, otherwise the form will be returned.

Original to the County Clerk and Recorder; duplicate to the State Engineer; Triplicate to the School of Mines and Quadruplicate for Appropriator.

11110

File No. GW2

T 32N R 20 9

DUPLICATE

County Blaine

STATE OF MONTANA RECEIVED
ADMINISTRATOR OF GROUNDWATER CODE
OFFICE OF STATE ENGINEER DEC 23 1963

Notice of Completion of Groundwater Appropriation by Means of Well

(Under Chapter 237, Montana Session Laws, 1961)

Top of Ground
(Elev. above sea level.....)

1 top soil
24 brown clay boulders
34 lite blue shale
35 rock
52 lite gray shale
53 tan shale
74 sandy lite gray shale
82 blue shale
102 sandstone

102

Show exact depth of bottom.

Owner Kathman Bros. Address Chiswick Montana

Driller Slipson Drilling Co. Address Malta, Montana

Date of Notice of appropriation of ground water _____

Date well started 12/4/63 Date Completed 12/7/63

Type of well drilled Equipment used 3 1/2" Jacobs
(dug, driven, bored or drilled) Churn, drill, rotary or other)

Water use: Domestic Municipal Stock Irrigation
Industrial Drainage Other

Indicate on the diagram the character and thickness of the different strata met with in drilling, such as soil, clay, shale, gravel, rock or sand, etc. Show depth at which water is encountered, thickness and character of water-bearing strata and height to which the water rises in the well.

Size of Drilled Hole	Size and Weight of Casing	From (Feet)	To (Feet)	PERFORATIONS		
				Size (Feet)	From (Feet)	To (Feet)
6"	5" 17 Lbs	18" 48	102	1/4"	7'	102'

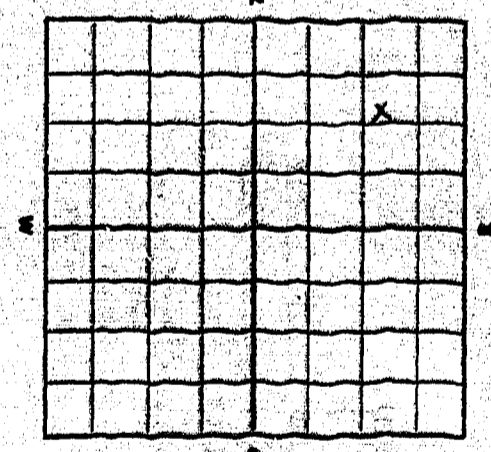

102' 10" Sec. 1, T. 32 N. R. 20 W.
Indicate location of well and place of use, if possible. Each small square represents 10 acres.

Static Water Level for non-flowing well _____ feet

Shut-in Pressure for Flowing Well _____ feet

Pumping Water Level 75 feet
at 7 gal. per minute.

Discharge in gal. per min. of flowing well _____

How Tested pumped

Length of Test 2 hours

Remarks: (Gravel packing, cementing, packers, type of shut-off, location of place of use of groundwater if not at well, and any other similar pertinent information, including number of acres irrigated, if used for irrigation) _____

25
Driller's License Number
Charles Jackson
Driller's Signature

This form to be prepared by driller, and three copies to be filed by the owner with the County Clerk and Recorder in the county in which the well is located.

Please answer all questions. If not applicable, so state, otherwise the form will be returned.

Original to the County Clerk and Recorder; duplicate to the State Engineer; Triplicate to the School of Mines and Quadruplicate for Appropriator.

251644
251644

STATE OF MONTANA
County of Blaine

FILED FOR RECORD THIS 12 DAY
OF December A. D. 1963
AT 11:00 O'CLOCK A M.

Cara L. Muagrose
COUNTY CLERK

FEB 20 DEPUTY

File No.

T. 32 R. 20

DUPLICATE

County

STATE OF MONTANA
ADMINISTRATOR OF GROUNDWATER CODE
OFFICE OF STATE ENGINEER

JUL 6 1964
ENGINEER

Declaration of Vested Groundwater Rights

(Under Chapter 237, Montana Session Laws, 1961)

I, John Nathan, of Chiswick,
(Name of Appropriator) (Address) Montana (Town)

County of State of
have appropriated groundwater according to the Montana laws in effect prior to January 1, 1962, as follows:

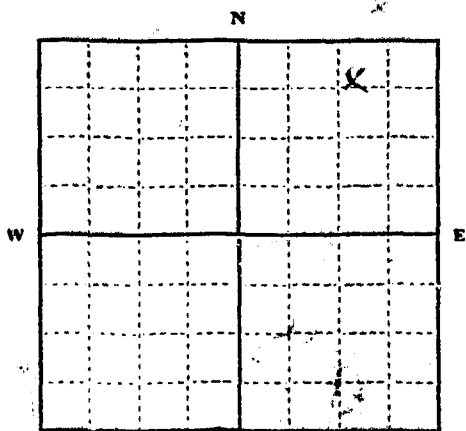

1/4 Sec. T. R.

Indicate point of appropriation and place of use, if possible. Each small square represents 10 acres.

2. The beneficial use on which the claim is based.....

3. Date or approximate date of earliest beneficial use; and how continuous the use has been.....

4. The amount of 5 gpm groundwater claimed (in miner's inches or gallons per minute).....

5. If used for irrigation, give the acreage and description of the lands to which water has been applied and name of the owner thereof
Lawn + trees

6. The means of withdrawing such water from the ground and the location of each well or other means of withdrawal.....

7. The date of commencement and completion of the construction of the well, wells, or other works for withdrawal of groundwater..... 1938

8. The depth of water table..... 25 ft

9. So far as it may be available, the type, size and depth of each well or the general specifications of any other works for the withdrawal of groundwater..... 10 ft deep
4 1/2 inch steel casing

10. The estimated amount of groundwater withdrawn each year..... 365,000

11. The log of formations encountered in the drilling of each well if available.....

12. Such other information of a similar nature as may be useful in carrying out the policy of this act, including reference to book and page of any county record.....

Signature of Owner John Nathan
Dec 21 1963

Date

Three copies to be filed by the owner with the County Clerk and Recorder of the county in which the well is located.

Please answer all questions. If not applicable, so state, otherwise the form will be returned.

Original to the County Clerk and Recorder; Duplicate to the State Engineer; Triplicate to the Montana Bureau of Mines and Geology, and Quadruplicate for the Appropriator.

21912

252071

STATE OF MONTANA
County of Blaine

FILED FOR RECORD THIS 31 DAY
OF December A. D. 19 63
AT 9:45 O'CLOCK A. M.

Cara L. Musgrave
COUNTY CLERK

FEE 2.00 DEPUTY

9 35 30

File No.
DUPLICATE

32 R 20
County Blaine

STATE OF MONTANA
ADMINISTRATOR OF GROUNDWATER CODE
OFFICE OF STATE ENGINEER

JAN 6 1968

DECLARATION OF VESTED GROUNDWATER RIGHTS
(Under Chapter 237, Montana Session Laws, 1951)

Rudolph C. Friede, of Rt. 1 Chisnook
(Name of Appropriator) (Address) (Town)

County of Blaine State of Montana
have appropriated groundwater according to the Montana laws in effect prior to Jan. 1, 1952, as follows:

10-32-20

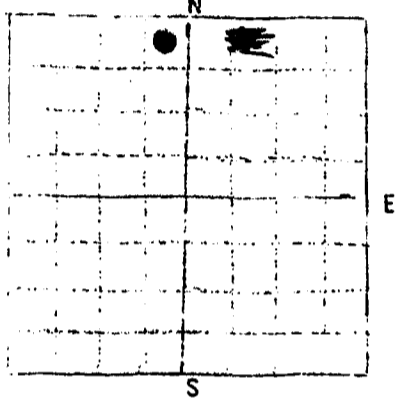

1/4 Sec. T. R.
indicate point of appropriation
and place of use, if possible.
Each small square represents 5
acres.

2. The beneficial use on which the claim is based.....
Stock & Farm

3. Date or approximate date of earliest beneficial use;
and how continuous the use has been.....
for 50 years (1913)

4. The amount of groundwater claimed (in miner's inches
or gallons per minute).....
20 gallons

5. If used for irrigation, give the acreage and description
of the lands to which water has been applied and name
of the owner thereof.....
None

The means of withdrawing such water from the ground and
the location of each well or other means of withdrawal
Pressure Pump

The date of commencement and completion of the construction of the well, wells, or
other works for withdrawal of groundwater.....
50 yrs ago (1913)

The depth of water table.....
10 ft.

So far as it may be available, the type, size and depth of each well or the general
specifications of any other works for the withdrawal of groundwater.....
2 1/2 ft. deep (dug well)
4 ft. across

The estimated amount of groundwater withdrawn each year.....
Continuous Use

The log of formation encountered in the drilling of each well if available.....
no information

Such other information of a similar nature as may be useful in carrying out the policy
of this act, including reference to book and page of any county record.....
None

STATE OF MONTANA)
County of) ss.

Signature of Owner.....

Rudolph C. Friede
of Blaine

Date Dec 28 1965

..... having first been duly sworn, depose and say
that ..he...of lawful age and.....the appropriator... and claimant... of the
order and water right mentioned in the foregoing declaration of vested groundwater
rights and the person... whose name... subscribed thereto, as the appropriator... and
claimant..., that ..he ... know... the contents of said foregoing notice and that the
matters and things therein stated are true.

252026

STATE OF MONTANA
County of Blaine

FILED FOR RECORD THIS 30 DAY
OF December A. D. 1963
AT 2:40 O'CLOCK P. M.

Cora L. Musgrave
COUNTY CLERK

20 DEPUTY
FEE

File No.

T. 32 R 20

DUPLICATE

County Blaine

STATE OF MONTANA
ADMINISTRATOR OF GROUNDWATER CODE
OFFICE OF STATE ENGINEER

RECEIVED
JAN 8 1964

Declaration of Vested Groundwater Rights

(Under Chapter 237, Montana Session Laws, 1961)

1. Chester D. Nicholson, of Chinook
(Name of Appropriator) (Address) (Town)

County of _____ State of _____
have appropriated groundwater according to the Montana laws in effect prior to January 1, 1962, as follows:

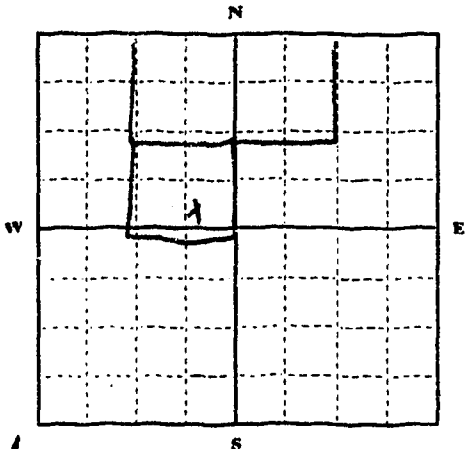

Sec 11 T 32 R 20

Indicate point of appropriation and place of use, if possible. Each small square represents 10 acres.

2. The beneficial use on which the claim is based Family & Livestock

3. Date or approximate date of earliest beneficial use; and how continuous the use has been 1925 Continuous

4. The amount of groundwater claimed (in miner's inches or gallons per minute) 800 L/Min

5. If used for irrigation, give the acreage and description of the lands to which water has been applied and name of the owner thereof

6. The means of withdrawing such water from the ground and the location of each well or other means of withdrawal Electric Pump

7. The date of commencement and completion of the construction of the well, wells, or other works for withdrawal of groundwater

8. The depth of water table 8 ft.

9. So far as it may be available, the type, size and depth of each well or the general specifications of any other works for the withdrawal of groundwater 4) Four Ft. Square Woodorr casing 16 ft deep.

10. The estimated amount of groundwater withdrawn each year 365,000

11. The log of formations encountered in the drilling of each well if available Not a drilled well. Shallow well.

12. Such other information of a similar nature as may be useful in carrying out the policy of this act, including reference to book and page of any county record

Signature of Owner Chester Nicholson
Date Dec 25, 1963

Three copies to be filed by the owner with the County Clerk and Recorder of the county in which the well is located.

Please answer all questions. If not applicable, so state, otherwise the form will be returned.

Original to the County Clerk and Recorder; Duplicate to the State Engineer; Triplicate to the Montana Bureau of Mines and Geology, and Quadruplicate for the Appropriator.

21804

251953

STATE OF MONTANA
County of Blaine

FILED FOR RECORD THIS 27 DAY
OF December A. D. 1963
AT 2:30 O'CLOCK P. M.

Carl R. Murgers
COUNTY CLERK
Evelyn Sheet
DEPUTY

FR. 27

14

File No.

T. 32 R. 20

DUPLICATE

County Blaine

STATE OF MONTANA
ADMINISTRATOR OF GROUNDWATER CODE
OFFICE OF STATE ENGINEER

RECEIVED
JAN 6 1964
STATE ENGINEER

Notice of Completion of Groundwater Appropriation
Without Well

(Under Chapter 237 Montana Session Laws, 1961)

Date of Appropriation of Groundwater 1912

Owner Lyzie Brunner Address Chinook Mont

Contractor (if any) none

Address of Contractor _____

Date Started _____ Date Completed _____

Describe means of obtaining groundwater without a well "as by sub-irrigation and other natural processes". Include depth to water when applicable.

water comes out of ground beside a rock spring is not opened up.

Quantity of water developed and used with explanation of method used to measure or estimate such amount. If use is intermittent

estimate approximate lengths of periods of use since 1912
use for stock water
summer months

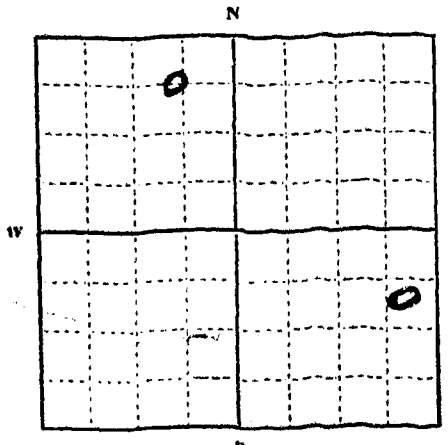

1/4 Sec. 4 T. 32 R. 20
Indicate point of appropriation and place of use, if possible.

Signature of Owner.....

Date Dec 26 1963

This form to be prepared by contractor (if any), otherwise by the owner.
Three copies of this notice are to be filed with the County Clerk and Recorder of the county in which the works are located.
Please answer all questions. If not applicable, so state, otherwise the form will be returned.
Original to the County Clerk and Recorder; duplicate to the State Engineer; Triplicate to the Montana Bureau of Mines and Geology and Quadruplicate for the Appropriator.

21836

251993

STATE OF MONTANA
County of Blaine

FILED FOR RECORD THIS 30 DAY
OF December A. D. 1963

AT 12:50 O'CLOCK P M.

Cora A. Murphy
COUNTY CLERK

Catherine Sheets
DEPUTY

FRR 2

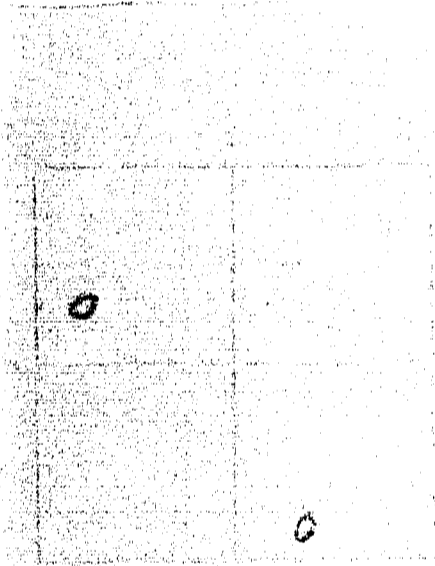

02125 41

[Faint, illegible handwritten text, possibly bleed-through from the reverse side of the page.]

File No.

T. 31 R. 20
County Blaine

DUPLICATE

STATE OF MONTANA
ADMINISTRATOR OF GROUNDWATER CODE
OFFICE OF STATE ENGINEER

RECEIVED

Declaration of Vested Groundwater Rights

(Under Chapter 237, Montana Session Laws, 1961)

STATE ENGINEER

1. CAROLYN VOGT, of CHIHOOK
(Name of Appropriator) (Address) (Town)
County of BLAINE State of MONTANA
have appropriated groundwater according to the Montana laws in effect prior to January 1, 1962, as follows:

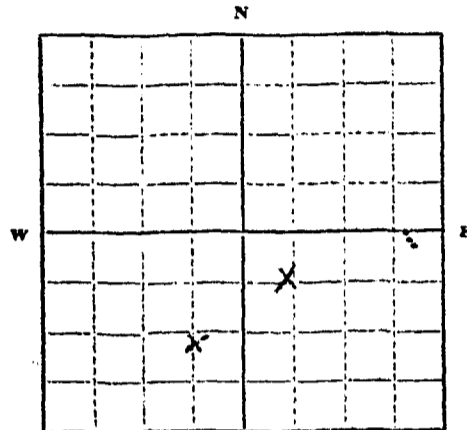

SE 1/4 SW 20-32-20
SW 1/4 NW Sec. 7 T21 R20

Indicate point of appropriation and place of use, if possible. Each small square represents 10 acres.

- The beneficial use on which the claim is based: STOCK + DOMESTIC
- Date or approximate date of earliest beneficial use; and how continuous the use has been: Feb. 1961 - 1954 - still continuous
- The amount of groundwater claimed (in miner's inches or gallons per minute): 16 gal - 6 to 7 20-32-20
- If used for irrigation, give the acreage and description of the lands to which water has been applied and name of the owner thereof: NO
- The means of withdrawing such water from the ground and the location of each well or other means of withdrawal: PUMP
- The date of commencement and completion of the construction of the well, wells, or other works for withdrawal of groundwater: Feb 1961 - 1954
- The depth of water table: 68 Feet - 100 ft (20-32-20)
- So far as it may be available, the type, size and depth of each well or the general specifications of any other works for the withdrawal of groundwater: 6" Steel casing - 4" galvanized submerged pump cyl pump (20-32-20)
- The estimated amount of groundwater withdrawn each year: 50,000 gal 10,000 (20-32-20)
- The log of formations encountered in the drilling of each well if available: Shale SAND (20-32-20)
- Such other information of a similar nature as may be useful in carrying out the policy of this act, including reference to book and page of any county record.

Signature of Owner: [Signature]
Date: Jan 20 1963

Three copies to be filed by the owner with the County Clerk and Recorder of the county in which the well is located.

Please answer all questions. If not applicable, so state, otherwise the form will be returned.

Original to the County Clerk and Recorder; duplicate to the State Engineer; Triplicate to the Montana Bureau of Mines and Geology, and Quadruplicate for the Appropriator.

Eng

249647

STATE OF MONTANA
County of Blaine

FILED FOR RECORD THIS 20 DAY
OF Jan A. D. 1963

AT 4:00 O'CLOCK P. M.

Egan L. Morrison
COUNTY CLERK

Esther
DEPUTY

FEE 2

32-20-25

File No.

T. 32 R. 20

DUPLICATE

County Blaine

STATE OF MONTANA
ADMINISTRATOR OF GROUNDWATER CODE
OFFICE OF STATE ENGINEER

RECEIVED
SEP 10 1963
STATE ENGINEER

Notice of Completion of Groundwater Appropriation by Means of Well

(Under Chapter 237, Montana Session Laws, 1961)

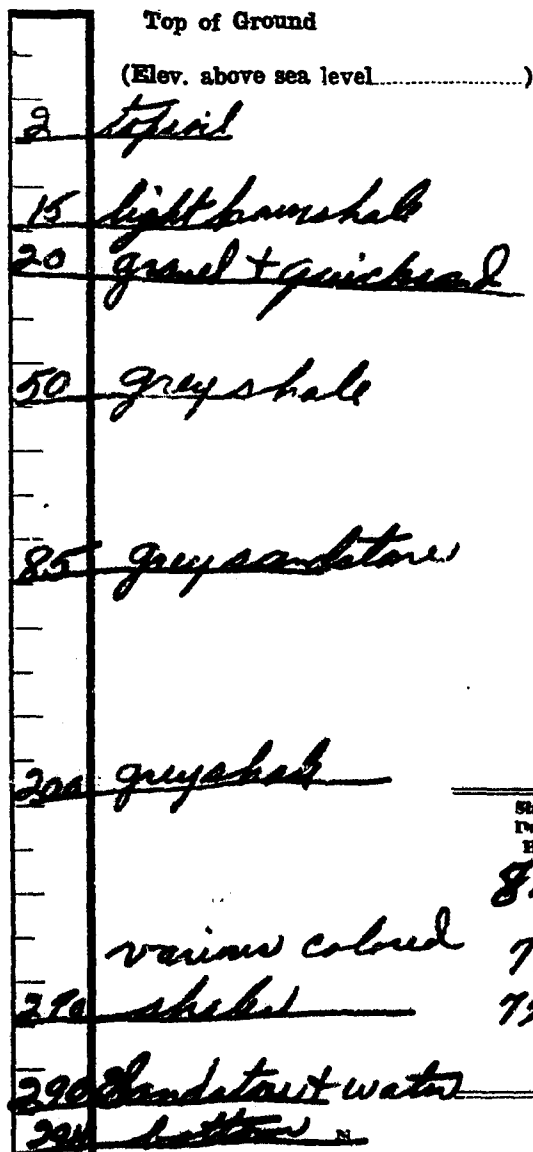

Owner John H. Hellman Address Chinook, Mont.
Driller Leota Wankuta Address Chinook, Mont.

Date of Notice of Appropriation of Groundwater

Date well started 8-28-63 Date Completed 9-5-63

Type of well drilled Equipment Used Churn Drill
(dug, driven, bored or drilled) (Churn, drill, rotary or other)

Water Use: Domestic Municipal Other Irrigation
Industrial Drainage Stock

Indicate on the diagram the character and thickness of the different strata met with in drilling, such as soil, clay, shale, gravel, rock or sand, etc. Show depth at which water is encountered, thickness and character of water-bearing strata and height to which water rises in the well.

Size of Drilled Hole	Size and Weight of Casing	From (Feet)	To (Feet)	PERFORATIONS		
				Kind Size	From (Feet)	To (Feet)
8 1/2"	8 5/8"	+1	234			
various colored	7 1/2"	6 5/8" X 12"	+2	0	1/4" X 2"	230 235
290 shale	7 1/2"	6 5/8" X 13"	0	294	1/4" X 2"	270 290

Static Water Level for non-flowing Well 150 feet.

Shut-in Pressure for Flowing Well

Pumping Water Level 290 feet at 4 gal. per minute.

Discharge in gal. per min. of flowing well

How Tested failer Length of Test 1 hr.

Remarks: (Gravel packing, cementing, packers, type of shutoff, location of place of use of groundwater if not at well, and any other similar pertinent information, including number of acres irrigated, if used for irrigation) Rubber

inner tube packer set in at 100 ft.

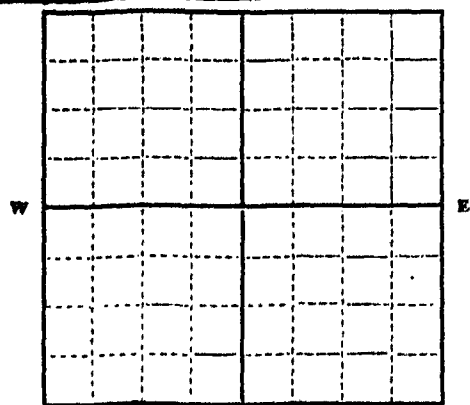

Sec. 1/4 Sec. 25 T. 2 R. 20
Indicate location of well and place of use, if possible. Each small square represents 10 acres.

Show exact depth of bottom.

31
Driller's License Number

Leota Wankuta
Driller's Signature

This form to be prepared by driller, and three copies to be filed by the owner with the County Clerk and Recorder in the county in which the well is located.

Please answer all questions. If not applicable, so state, otherwise the form will be returned.

Original to the County Clerk and Recorder; duplicate to the State Engineer; Triplicate to the Montana Bureau of Mines and Geology and Quadruplicate for the Appropriator.

250333

STATE OF MONTANA
County of Blaine

FILED FOR RECORD THIS 9 DAY

OF Sept A. D. 1963

AT 9:10 O'CLOCK P. M.

Cora L. Mangrove
COUNTY CLERK

Esther Sheets
DEPUTY

FR 7 30

RECORDED
INDEXED

Form No. 18
8-60

T. 2 R. 11

County Blaine

MONTANA BUREAU OF MINES AND GEOLOGY
Butte, Montana

RECEIVED

Water Well Log

STATE ENGINEER

2		

Owner A. J. Clark Address Blaine

Driller John W. Smith Address Blaine

Date Started 7/1/61 Date Completed 11/1/61

Location: Sec. 12 T. 2 R. 11 $\frac{1}{4}$ sec. NW 1/4 SW 1/4

Type of well drilled Equipment used Steam drill
(Dug, driven, bored, or drilled) (Churn, drill, rotary, other)

Water use: Domestic Municipal Stock Irrigation
Industrial Drainage Other _____

Casing: 0 ft. to 200 ft. Type Steel pipe Size 4" x 1/2"

Casing: _____ ft. to _____ ft. Type _____ Size _____

Casing: _____ ft. to _____ ft. Type _____ Size _____

Perforated or screened: Ft. _____ to ft. _____ . Ft. _____ to ft. _____

Type of screen or perforations 1/2" x 1/2"

Static water level, for non-flowing well: _____ feet.

Shut-in pressure, for flowing well: _____ lb./sq. in. on: _____ (date)

Pumping water level _____ feet at _____ gal. per min.

How tested: slug

Length of test 2 hours

Remarks: (Gravel packing, cementing, packers, type of shut-off, depth of shut-off)

(over)

Form No. 18
8-60

28

T. 3 R. 20
County Blaine

MONTANA BUREAU OF MINES AND GEOLOGY
Butte, Montana

RECEIVED
SEP 2 1961

Water Well Log

STATE ENGINEER

2		

Owner Richard Conrad Address Chinook
Driller Leslie Warkentin Address Chinook
Date Started 8/2/61 Date Completed 7/1/61
Location: Sec. 19 T. 22 R. 20 $\frac{1}{4}$ sec. NW 1/4 SW 1/4

Type of well drilled Equipment used Churn drill
(Dug, driven, bored, or drilled) (Churn, drill, rotary, other)

Water use: Domestic Municipal Stock Irrigation
Industrial Drainage Other _____

Casing: 0 ft. to 370 ft. Type 1 1/2 in. Size 1 1/2 in.

Casing: _____ ft. to _____ ft. Type _____ Size _____

Casing: _____ ft. to _____ ft. Type _____ Size _____

Perforated or screened: Ft. 300 to ft. 345. Ft. _____ to ft. _____

Type of screen or perforations 7/8 in. slots

Static water level, for non-flowing well: 150 feet.

Shut-in pressure, for flowing well: _____ lb./sq. in. on: _____ (date)

Pumping water level 340 feet at 4 gal. per min.

How tested: Stiles

Length of test 2 hours

Remarks: (Gravel packing, cementing, packers, type of shut-off, depth of shut-off)

(over)

STATE WATER CONSERVATION BOARD

NOV. 18 1965

Director _____
Deputy _____
Clerk _____
Supt. _____
Asst. Supt. _____
Asst. Dir. _____
Asst. Dir. _____
Asst. Dir. _____

RECEIVED BY THE CLERK OF THE BOARD OF WATER CONSERVATION

257222

STATE OF MONTANA
County of Blaine

FILED FOR RECORD THIS 17 DAY
OF November A. D. 1965
AT 3:00 O'CLOCK P. M.
Cara L. Musgrave
COUNTY CLERK

FRR 200 DEPUTY

T. 32 B. 20 33
County Blaine

RECEIVED

MONTANA BUREAU OF MINES AND GEOLOGY
Butte, Montana

STATE ENGINEER

WATER WELL LOG

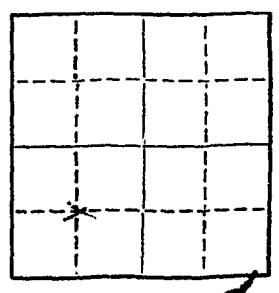

Owner Wallace Warburton Address Chiswick, Mont.
Driller Lester Warburton Address Chiswick, Mont.
Date Started 6/26/61 Date Completed 7/9/61
Location: Sec. 33 T. 32 R. 20 1/4 sec. SW/4

Type of well drilled Equipment used Churn drill
(Dug, driven, bored, or drilled) (Churn drill, rotary, other)

Water use: Domestic Municipal Stock Irrigation

Industrial Drainage Other: iron
Casing: 0 ft. to 371 ft. Type iron Size 6 3/8"

Casing: ft. to ft. Type Size

Casing: ft. to ft. Type Size

Perforated or Screened: Ft. to ft. Ft. to ft.

Type of screen or perforations none

Static Water level, for non-flowing well: 360 feet.

Shut-in pressure, for flowing well: lb./sq. in. on: (date)

Pumping water level: 410 feet at 10 gal. per min.

How tested: bailed

Length of test: 2 hours

Remarks: (Gravel packing, cementing, packers, type of shut-off, depth of shut-off)

(over)

5.E.7
File No.
DUPLICATE

T. 32 R. 20
County BLAINE

STATE OF MONTANA
ADMINISTRATOR OF GROUNDWATER CODE
OFFICE OF STATE ENGINEER

RECEIVED

APR 10 1963

Declaration of Vested Groundwater Rights
(Under Chapter 237, Montana Session Laws, 1961)

ASSISTANT
STATE ENGINEER

1. WALLACE WARBURTON of CHINOOK
(Name of Appropriator) (Address) (Town)
County of BLAINE State of MONTANA
have appropriated groundwater according to the Montana laws in effect prior to January 1, 1962, as follows:

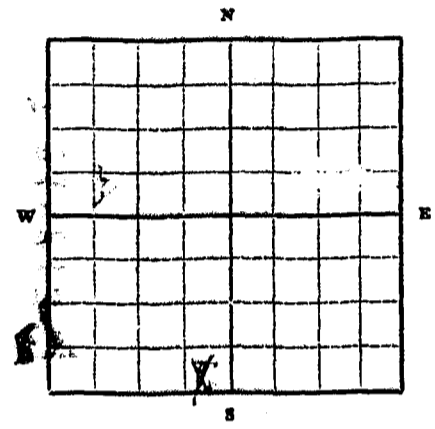

SE 1/4 Sec. 34 T. 32 R. 20
Indicate point of appropriation and place of use, if possible. Each small square represents 10 acres.

- The beneficial use on which the claim is based *House water and stock water*
- Date or approximate date of earliest beneficial use; and how continuous the use has been *1919. Has been used continuously since 1919*
- The amount of groundwater claimed (in miner's inches or gallons per minute) *300 gal per 24 hrs day*
- If used for irrigation, give the acreage and description of the lands to which water has been applied and name of the owner thereof
- The means of withdrawing such water from the ground and the location of each well or other means of withdrawal *pumped by hand pump or windmill*
- The date of commencement and completion of the construction of the well, wells, or other works for withdrawal of groundwater *during the year of 1919*
- The depth of water table *14 to 20 ft.*
- So far as it may be available, the type, size and depth of each well or the general specifications of any other works for the withdrawal of groundwater *depth 20 ft. 24 in. exhaust casing*
- The estimated amount of groundwater withdrawn each year *109,500 gal*
- The log of formations encountered in the drilling of each well if available *glaciated drift*
- Such other information of a similar nature as may be useful in carrying out the policy of this act, including reference to book and page of any county record.

Signature of Owner *Wallace Warburton*
Date *April 10 - 1963*

Three copies to be filed by the owner with the County Clerk and Recorder of the county in which the well is located.

Please answer all questions. If not applicable, so state, otherwise the form will be returned.

Original to the County Clerk and Recorder; duplicate to the State Engineer; Triplicate to the School of Mines and Quadruplicate for the Appropriator.

248815

STATE OF MONTANA
County of Blaine

FILED FOR RECORD THIS 17 DAY

OF April A. D. 1963

AT 9:55 O'CLOCK P. M.

Cora L. Thompson

COUNTY CLERK

Lois Ann Shute

DEPUTY

PER 100

County BLAINE

Twp. 32 NORTH Rge. 21 EAST

Sec.	Name of Appropriator	Type of Form	County File No.	Remarks
1	TOW, RICHARD	GW-2	270959	
1	FUNK, WALTER	GW-2	272281	
2	CHAPMAN, FRANCIS	WELL LOG	250788	
2	ANNIS, BRYCE			
3	NESSLAR, BROS.		251988	
5	SHAPLES, E. M.	WELL LOG		
5	STIRLAND, RULON G. & LOUISE		252026	} SAME FORM
5	" "		252026	
5	LUCKETT, E. W.	GW-2	246257	
5	JENSEN, KENNETH		252102	
5	BLATTER, KENNETH B.		251944	
5	BLATTER, KENNETH B.		251942	
5	FRIEDE, HERMAN		251914	
6	WARBURTON, WALLACE		251932	
6	HENDERSON, GREGORY J. &		272309	
6	HENDERSON, GREGORY J.		272310	
7	WARBURTON, WALLACE	GW-2	251933	
7	WARBURTON, WALLACE	GW-2	251934	
8	FRIEDE, HERMAN		251914	SEE SEC. 5
8	TILLEMAN, HENRY & IRMA		251840	
9	NESSLAR BROS		251988	SEE SEC. 3
9	DESLAY, GLENN	GW-2	245965	
9	HAMILTON, JOHN M.		251942	
9	HAMILTON, JOHN	GW-2	251263	
9	SCHWENKE, CHESTER		251818	
10	NESSLAR BROS		251988	SEE SEC. 3
10	CHAPMAN, FRANCIS	GW-2	270448	
11	MUSCROVE, ROBERT M.		249656	
12	POPPLER, CAROLINE		251645	
15	SCHWENKE, CHESTER		251818	SEE SEC. 9
17	TILLEMAN, HENRY & IRMA		251840	SEE SEC. 8
24	WILSON, GORDON C.	WELL LOG		

270959

STATE OF MONTANA }
County of Blaine }

Filed for record this 6 Day
of Feb A. D. 1923
At 4:30 O'Clock P.M.

Lucien J. DeBorja
County Clerk
Deputy

Fee _____

File No. _____

T. 22 R. 11

TRIPPLICATE

County Golden

LOG

STATE OF MONTANA
ADMINISTRATOR OF GROUNDWATER CODE
OFFICE OF STATE ENGINEER

Notice of Completion of Groundwater Appropriation by Means of Well

DEVELOPED AFTER JANUARY 1, 1962

(Under Chapter 237, Montana Session Laws, 1961)

0	Top of Ground
	(Elev. above sea level _____)
17	grey shale
20	yellow sandstone
35	clay + quartzite
50	grey soft brown sandstone
75	grey sandstone and
80	sandstone
115	grey shale
120	brown shale
145	grey sandstone + small amount of water
185	various colored shales
205	fine water 1/2 gal. 8 m.
215	various colored shales
225	small amount of water
235	light grey shale
254	brown shale + water 1/2 gal. 8 m.
280	light grey shale
300	1/2 gal. sandstone water
307	shale
307	bottom

Owner Walter Furd Address Zurich
 Driller Lester W. Wadsworth Address Chinook
 Date of Notice of appropriation of groundwater _____
 Date well started June 3, 1973 Date completed July 1, 1973
 Type of well drilled Equipment used Churn Drill
 (Dug, Driven, bored or drilled) (Churn drill, rotary or other)
 Water use: Domestic Municipal Stock Irrigation
 Industrial Drainage Other

Indicate on the diagram the character and thickness of the different strata met with in drilling, such as soil, clay, shale, gravel, rock or sand, etc. Show depth at which water is encountered, thickness and character of water-bearing strata and height to which the water rises in the well.

Depth (Feet)	Size of Drilled Hole	Size and Weight of Casing	From (Feet)	To (Feet)	PERFORATIONS		
					Kind Size	From (Feet)	To (Feet)
225	8 1/2"	8 5/8" x 25'	2	0			
235	8 1/2"	" "	0	84			
254	8 1/2"	" "	72	307	1 1/2"	215	218
						235	240
						255	260
						270	305

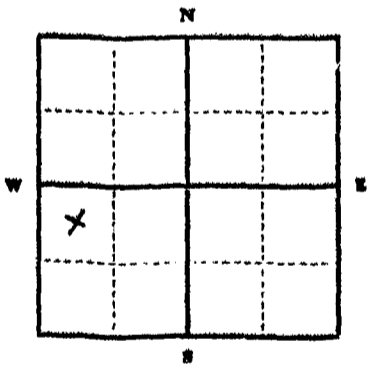

Static Water Level for non-flowing well 12 feet.
 Shut-in Pressure for Flowing Well _____
 Pumping Water Level 300 feet
 at 7 gal. per minute.
 Discharge in gal. per min. of flowing well _____
 How Tested static
 Length of Test 1 hr
 Remarks: (Gravel packing, cementing, packers, type of shutoff) none
Walter Furd
June 28, 1973

N. 14 Sec. 1 T. 22 R. 11
 Indicate location of well and place of use, if possible. Each small square represents 40 acres.

(Continue on reverse side)
 USE—If used for irrigation, industrial, drainage or other. Explain, state number of acres and location or other data (i.e.: Lot, Block and Addition).

This form to be prepared by driller, and three copies to be filed by the owner with the County Clerk and Recorder in the county in which the well is located, tissue copy to be retained by driller.

Please answer all questions. If not applicable, so state, otherwise the form will be returned.

31
 Driller's License Number
Lester W. Wadsworth
 Driller's Signature

54861

272281

open
W...

Jr

STATE OF MONTANA }
County of Blaine }

Filed for record this 28 Day
of June A. C. 19 29
At 9:35 O'Clock P. M.

[Signature]
County Clerk
Deputy
Fee 2.00

Form No. 18
8-60

T. 32 R. 21
County Blaine

MONTANA BUREAU OF MINES AND GEOLOGY
Butte, Montana

RECEIVED

WATER WELL LOG

STATE ENGINEER

x		

Owner Francis Chapman Address Arden
 Driller Billmeyer Address Highland
 Date Started Oct 21 Date Completed Nov 61
 Location: Sec. 2 T. 32 R. 21 $\frac{3}{4}$ SWSW sec. 2

Type of well drilled Equipment used Churn
(Dug, driven, bored, or drilled) (Churn, drill, rotary, other)

Water use: Domestic Municipal Stock Irrigation
 Industrial Drainage Other _____

Casing: Top ft. to 61' ft. Type New 1/2" well Size 1'

Casing: _____ ft. to _____ ft. Type _____ Size _____

Casing: _____ ft. to _____ ft. Type _____ Size _____

Perforated or Screened: Ft. _____ to ft. _____. Ft. _____ to ft. _____

Type of screen or perforations _____

Static Water level, for non-flowing well: 11 feet.

Shut-in pressure, for flowing well: _____ lb./sq. in. on: _____ (date)

Pumping water level 17 feet at 30 gal. per min.

How tested: Open

Length of test 1 hr

Remarks: (Gravel packing, cementing, packers, type of shut-off, depth of shut-off)

Bottom 7" casing full 1 well casing
very good well

(over)

File No. _____

T. 32 R. 21

DUPLICATE

County Blaine

STATE OF MONTANA
ADMINISTRATOR OF GROUNDWATER CODE
OFFICE OF STATE ENGINEER

RECEIVED
SEP 26 1963

Declaration of Vested Groundwater Rights

(Under Chapter 237, Montana Session Laws, 1961)

STATE ENGINEER

1. Bryce Annis of Chivook
(Name of Appropriator) (Address) (Town)
County of Blaine State of Montana
have appropriated groundwater according to the Montana laws in effect prior to January 1, 1962, as follows:

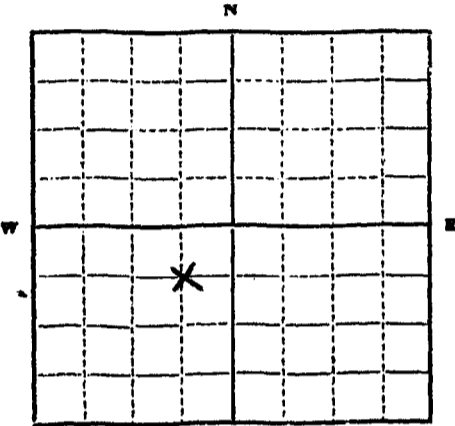

No. 1 Sec. 2 T. 32 R. 21

Indicate point of appropriation and place of use, if possible. Each small square represents 10 acres.

2. The beneficial use on which the claim is based.....

Domestic

3. Date or approximate date of earliest beneficial use; and how continuous the use has been.....

1960

4. The amount of groundwater claimed (in miner's inches or gallons per minute).....

approx 5 gal

5. If used for irrigation, give the acreage and description of the lands to which water has been applied and name of the owner thereof.....

NO

6. The means of withdrawing such water from the ground and the location of each well or other means of withdrawal.....

Hand pumps

7. The date of commencement and completion of the construction of the well, wells, or other works for withdrawal of groundwater.....

Spring of 1960

8. The depth of water table.....

approx 2 feet

9. So far as it may be available, the type, size and depth of each well or the general specifications of any other works for the withdrawal of groundwater.....

8" Pipe casing

10. The estimated amount of groundwater withdrawn each year.....

approx 12 thousand gallons

11. The log of formations encountered in the drilling of each well if available.....

Clay - Sand Bar.

12. Such other information of a similar nature as may be useful in carrying out the policy of this act, including reference to book and page of any county record.....

Signature of Owner Bryce Annis

Date Sept 25, 1963

Three copies to be filed by the owner with the County Clerk and Recorder of the county in which the well is located.

Please answer all questions. If not applicable, so state, otherwise the form will be returned.

Original to the County Clerk and Recorder; duplicate to the State Engineer; Triplicate to the Montana Bureau of Mines and Geology, and Quadruplicate for the Appropriator.

250488

STATE OF MONTANA
County of Blaine

FILED FOR RECORD THIS 25 DAY

OF September A. D. 1963

AT 9:30 O'CLOCK P. M.

Cory L. Muegler
COUNTY CLERK

Esther Shurt
DEPUTY

VER 20

3/10/9

File No.

T. 32 R. 21

DUPLICATE

County Blaine

STATE OF MONTANA
ADMINISTRATOR OF GROUNDWATER CODE
OFFICE OF STATE ENGINEER

Declaration of Vested Groundwater Rights

(Under Chapter 237, Montana Session Laws, 1961)

RECEIVED
JAN 10 1963
STATE ENGINEER

1. Hessler Bros., of Chiswick, Montana (Town)
(Name of Appropriator) (Address) (State)
County of Blaine State of Montana
have appropriated groundwater according to the Montana laws in effect prior to January 1, 1962, as follows:

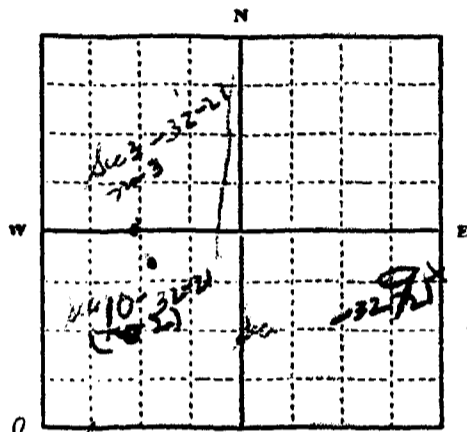

Indicate point of appropriation and place of use, if possible. Each small square represents 10 acres.
NE NE - 9

- 2. The beneficial use on which the claim is based Household and livestock water
- 3. Date or approximate date of earliest beneficial use; and how continuous the use has been March 1951
- The amount of groundwater claimed (in miner's inches or gallons per minute) 3 inches for each well
- 5. If used for irrigation, give the acreage and description of the lands to which water has been applied and name of the owner thereof Household and stock water only
- 6. The means of withdrawing such water from the ground and the location of each well or other means of withdrawal one well with pressure pump, other two with common pumps and jacks.
- 7. The date of commencement and completion of the construction of the well, wells, or other works for withdrawal of groundwater Wells drilled 1951 thru 1953. This is approximate
- 8. The depth of water table Ranges from 40 ft. to 105 ft. in the different wells
- 9. So far as it may be available, the type, size and depth of each well or the general specifications of any other works for the withdrawal of groundwater Well no. 1 85 ft. deep 6 inch casing, with common pump and jack. Well no. 2 216 ft deep with common pump and jack. Well no 3 196 ft deep with 5 inch casing and pressure pump
- 10. The estimated amount of groundwater withdrawn each year Have no idea but continuous use.
- 11. The log of formations encountered in the drilling of each well if available Not available
- 12. Such other information of a similar nature as may be useful in carrying out the policy of this act, including reference to book and page of any county record Have none.

Signature of Owner Frank J. Hessler
Date Dec. 28, 1963

Three copies to be filed by the owner with the County Clerk and Recorder of the county in which the well is located.
Please answer all questions. If not applicable, so state, otherwise the form will be returned.
Original to the County Clerk and Recorder; Duplicate to the State Engineer; Triplicate to the Montana Bureau of Mines and Geology, and Quadruplicate for the Appropriator.

21831

251988

STATE OF MONTANA
County of Blaine

FILED FOR RECORD THIS 30 DAY

OF December A. D. 19 63

AT 11:15 O'CLOCK A.M.

Cara L. Musgrave
COUNTY CLERK

FFR 2.00

DEPITY

T. 32 R. 21
County Elaine

MONTANA BUREAU OF MINES AND GEOLOGY
Butte, Montana

RECEIVED
FEB 2 1961

WATER WELL LOG

STATE ENGINEER

Owner E.M. Sharples Address Zurich

Driller Simpson Dr. Co Address Malta

Date Started Nov 16-1960 Date Completed Nov. 17

Location: Sec 5 T. 32 R. 21 1/4 sec. Lot 4

Type of well Drilled (Dug, driven, bored, or drilled) Equipment used Spuder (Churn drill, rotary, other)

Water use: Domestic Municipal Stock Irrigation
Industrial Drainage Other: _____

Casing: 0 ft. to 116 ft. Type threaded Size 4 H.W.I.D.

Casing: _____ ft. to _____ ft. Type _____ Size _____

Casing: _____ ft. to _____ ft. Type _____ Size _____

Perforated or Screened: Ft. _____ to ft. _____ Ft. _____ to ft. _____

Type of screen or perforations _____

Static Water level, for non-flowing well: 6 feet.

Shut-in pressure, for flowing well: _____ lb./sq. in. on: _____ (date)

Pumping water level 16 feet at 15 gal. per min.

How tested: Biler

Length of test 1 hour

Remarks: (Gravel packing, cementing, packers, type of shut-off, depth of shut-off)

(over)

File No.
DUPLICATE

T. 32 21

County **Blaine**

STATE OF MONTANA
ADMINISTRATOR OF GROUNDWATER CODE
OFFICE OF STATE ENGINEER

RECORDED
JAN 6 1964

DECLARATION OF VESTED GROUNDWATER RIGHTS
(Under Chapter 237, Montana Session Laws, 1951)

Rolan G and Louise Stirland of **Chinook**
(Name of Appropriator) (Address) (Town)

County of **Blaine** State of **Montana**
have appropriated groundwater according to the Montana laws in effect prior to Jan. 1,
1952, as follows:

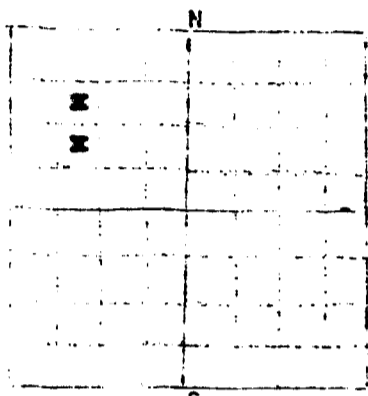

#1 **Blaine 5-32-21**
#2 **Blaine 5-32-21**

..... Sec. T. R.
indicate point of appropriation
and place of use, if possible.
Each small square represents 5
acres.

2. The beneficial use on which the claim is based.....
~~#1 - household and stock water~~ #2 - **stock water**

3. Date or approximate date of earliest beneficial use;
and how continuous the use has been.....
1963 possibly 8 years earlier

4. The amount of groundwater claimed (in miner's inches
or gallons per minute).....
10 million per minute at least

5. If used for irrigation, give the acreage and description
of the lands to which water has been applied and name
of the owner thereof.....

..... The means of withdrawing such water from the ground and
the location of each well or other means of withdrawal
..... **#1 pressure system** **#2 both electric**

..... The date of commencement and completion of the construction of the well, wells, or
other works for withdrawal of groundwater.....
same as 3.

..... The depth of water table..... **85 feet for both wells**

..... So far as it may be available, the type, size and depth of each well or the general
specifications of any other works for the withdrawal of groundwater.....
6 inch steel casing

..... The estimated amount of groundwater withdrawn each year..... **continuous use**

..... The log of formation encountered in the drilling of each well if available.....
sand

..... Such other information of a similar nature as may be useful in carrying out the policy
of this act, including reference to book and page of any county record.....

Signature of Owner **Rolan G Stirland**
Date..... **December 30, 1963**

STATE OF MONTANA) ss.
County of **Blaine**)
Rolan G. Stirland
..... having first been duly sworn, depose... and say;
that ..he.. **is** of lawful age and..... the appropriator... and claimant... of the
order and water right mentioned in the foregoing declaration of vested groundwater
rights and the person... whose name... **is** subscribed thereto, as the appropriator... and
claimant..., that ..he... know... the contents of said foregoing notice and that the
matters and things therein stated are true.

Lara L. Musgrave **21879**